

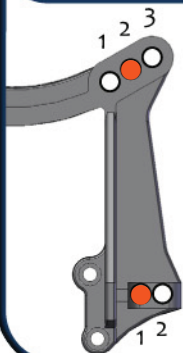

Driver: Cyril Baldini Date: July 2009
 Track / Event: Euros, Bilbao
 Layout: Open / Tight Surface: Smooth / Bumpy
 Grip: Low High Weather: Dry

Front Suspension



Ride Height: Arms Level

Camber: -1° Toe: 1°

Ackerman: Forward Back

Washers 4



Axle Height:
 High
 Med
 Low

Servo: Fwd Back

Axles: Trailing Inline

Caster Block:
 20° 25° 30°

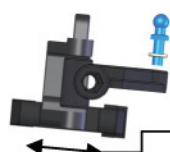

Washers 2

Position:
 Fwd Back

Shocks & Tires

Brand	Spring	Piston	Oil
Losi	Black	Red	40 Losi

Limiter - Top: 0 Bottom: 0

Shock Length: _____

Compressed Length: _____

Front Tire: Schumacher Yellow

Insert: _____

Rear Suspension



Ride Height: Arms level

Camber: -1°

Transmission Height: 0 mm

Washers -

Wing Height

E-Speed High
 OE-Speed Low

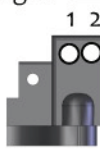

I M O



Anti-Squat: 4°

Sway Bar: 1.2mm

Arm Position:
 Back Mid Fwd

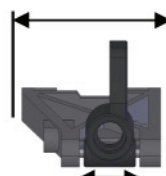

Hub Position:
 Back Mid Fwd

Shocks & Tires

Brand	Spring	Piston	Oil
Losi	Pink	Red	25 Losi

Limiter - Top: 0 Bottom: 0

Shock Length: _____

Compressed Length: _____

Rear Tire: Schuey Mini Pin Yellow

Insert: _____

Weight

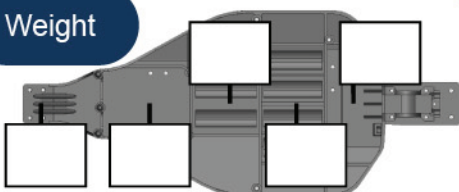

Total Weight: _____

F/R Bias: _____ / _____

Notes / Rants / Excuses

Wing: X6 no gurney but removed forward and low

Battery: _____ Motor: TPR 7.5T Gearing: 25 / 81