

Name: Stephen Smith Date: 03/11/15

City/Track: Maritime Racing

Event: Club Night

Conditions: ☒ Indoor ☐ Outdoor ☐ Dry ☐ Wet ☐ Blue Groove ☐ Hard Packed

Composition: ☐ Astroturf ☐ Clay ☒ Carpet ☐ Dirt ☐ Grass ☐ Other: Wood

Size: ☐ Open ☐ Medium ☒ Tight Traction: ☐ High ☒ Medium ☐ Low Surface: ☒ Smooth ☐ Medium ☒ Bumpy

Diff. Oil

Front: 15k Center: 150k Rear: 8k

Tire & Inserts

Front Tire: 2wd Mini Pin Rear Tire: Mini Pin 1 Yellow

Insert: 4wd Front Medium Medium Rear

Notes: outer and inner rows off fronts

Electronics

Motor: LRP X20 5.5 Spur/Pinion: Kit

Battery: Orion Shorty

Battery Position: Forward

ESC: LRP Flow Works Team

ESC settings: _____

Servo: Xpert Receiver: Sanwa

Front Suspension

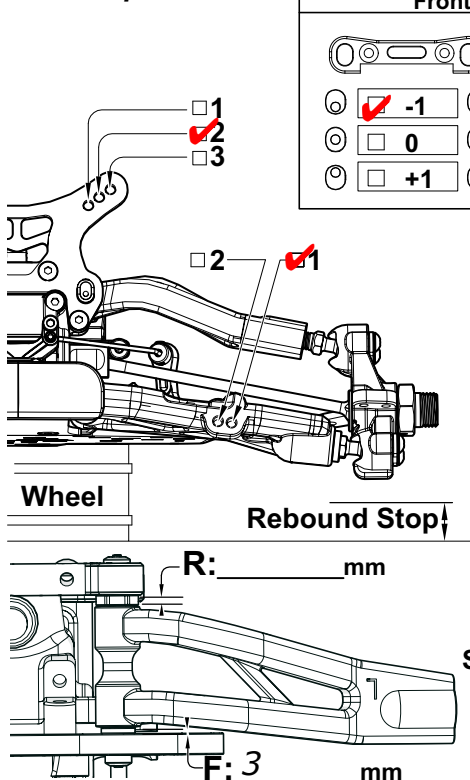

Front in-Board Toe

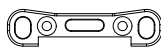
☒ -1
☐ 0
☐ +1

☒ -1
☐ 0
☐ +1

Front Shocks

Oil: 45wt

Piston: 2x1.4

Spring: AE Purple

Limiter: 0mm

Body: _____

Wing: YZ2

Notes: _____

Front Roll Center

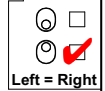
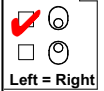

Track Width: _____

Caster: max +active

Camber: 2mm

Toe: 1

Rebound Stop: _____

Ride Height: 18mm

Sway Bar: 1.8

Steering Ackerman

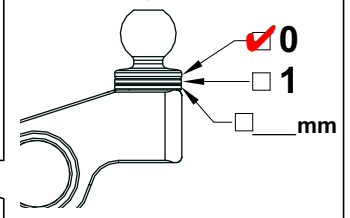

Sway Bar: 1.8

0 mm

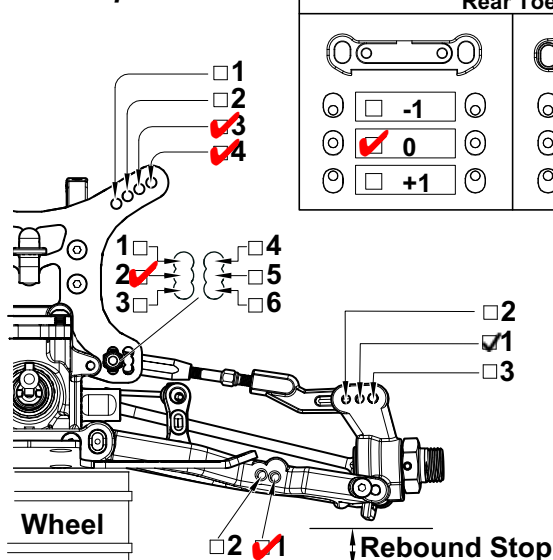
Rear Suspension

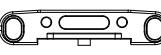

Rear Toe-In

☐ -1
☒ 0
☐ +1

☒ -1
☐ 0
☐ +1

Rear Shocks

Oil: 35wt

Piston: 2x1.5 + 2x1

Spring: AE Grey

Limiter: 2mm

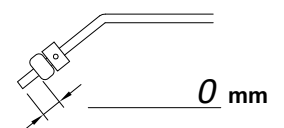
Sway Bar: 1.6

Track Width: _____

Camber: -2

Rebound Stop: _____

Ride Height: 18mm

Notes: _____

3mm removed from rear
arms. wheelbase 280mm
Shock tower hole 3
