

The Schumacher Racing team have developed this new "HD Topdeck Flex system". The Flex system is lightweight and it has increased structural rigidity front to back but retains it's flex in twist. It will improve the cars responsiveness in steering feel, and will help on tracks with large jumps.

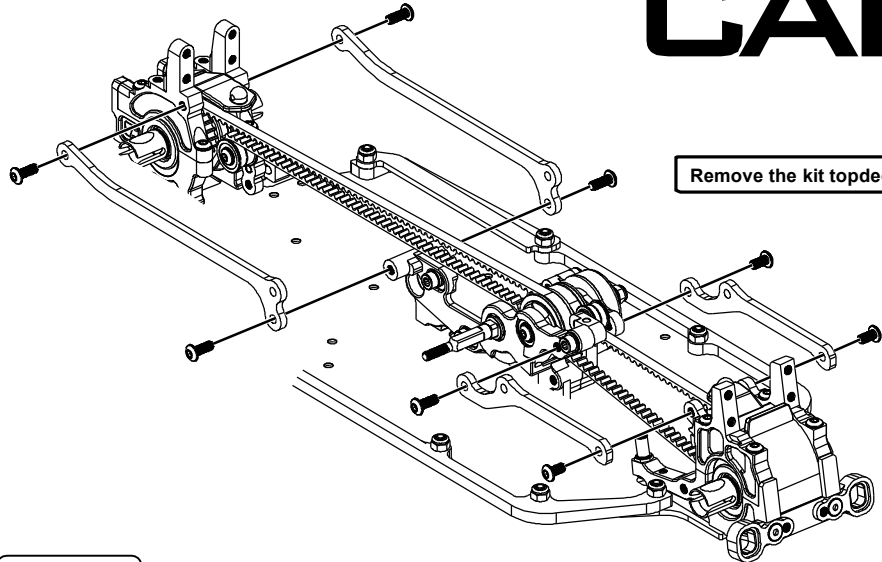

Remove the kit topdecks.

M3 Washer x 3

M3 x 12 x 1

Use the M3x12 Cap head screw and washers to fit the inserts.

Tighten the screw until the M3 thread insert is pulled into the carbon fibre part as shown.

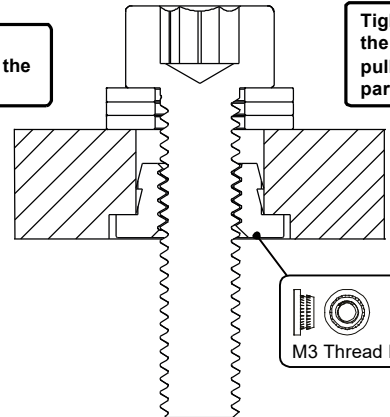
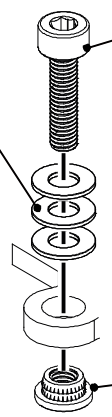

M3 Thread Insert

M3 Thread Insert x 8

Leave all screws loose for now

The inserts go into the counterbored side.

The pip faces the front of the car.

Use the kit screws for the front and rear topdecks.

Black 0.75 mm x 8

Now tighten all of the topdeck screws.

M3 x 8 x 8

