



Alloy Upper Transmission



- U7338 Dirt Covers 3pcs - L1/EVO
- U7342 Alloy LH Upper Rear Trans - L1/EVO
- U7343 Alloy RH Upper Rear Trans - L1/EVO
- U7348 Alloy LH Upper Front Trans - L1/EVO
- U7349 Alloy RH Upper Front Trans - L1/EVO

Wheel Nuts - M4 Serrated Flanged

- CR024 CORE RC - Serrated M4 Steel Wheel Nut pk4
- CR035 CORE RC - Serrated Alloy M4 Nuts; Blue - pk 4
- CR036 CORE RC - Serrated Alloy M4 Nuts; Violet - pk 4
- CR196 CORE RC - Serrated Alloy M4 Nuts - Black - pk4
- CR304 CORE RC - Serrated M4 Titanium Wheel Nut pk4
- U7400 Serrated M4 Low Profile Titanium Wheel Nut pk4

Big Bore Springs Front (Medium)

- CR177 CORE RC Big Bore Spring Tuning Set; Med 7prs
- CR179 Big Bore Spring; Med White - 2.8 pr
- CR180 Big Bore Spring; Med Red - 3.1 pr
- CR181 Big Bore Spring; Med Green - 3.4 pr
- CR182 Big Bore Spring; Med Blue - 3.7 pr **KB**
- CR183 Big Bore Spring; Med Black - 4.0 pr
- CR635 Big Bore Spring; Med Orange - 4.3 pr
- CR636 Big Bore Spring; Med Yellow - 4.6 pr

Big Bore Springs Rear (Long)

- CR178 CORE RC Big Bore Spring Tuning Set; Long 7prs
- CR184 Big Bore Spring; Long White - 1.8 pr
- CR185 Big Bore Spring; Long Red - 2.0 pr
- CR186 Big Bore Spring; Long Green - 2.2 pr **KB**
- CR187 Big Bore Spring; Long Blue - 2.4 pr
- CR188 Big Bore Spring; Long Black - 2.6 pr
- CR699 Big Bore Spring; Long Orange - 2.8 pr
- CR700 Big Bore Spring; Long Yellow - 3.0 pr
- CR808 High Response Spring; Long Red - 2.0 lb/in (pr)
- CR809 High Response Spring; Long Green - 2.2 lb/in (pr)
- CR810 High Response Spring; Long Blue - 2.4 lb/in (pr)
- CR811 High Response Spring; Long Black - 2.6 lb/in (pr)
- CR812 High Response Spring Tuning Set Long 4prs



- U4741 6mm Offset Servo Arms
- AX011 Aerox Alloy Servo 25T
- AX012 Aerox Alloy Servo 23T

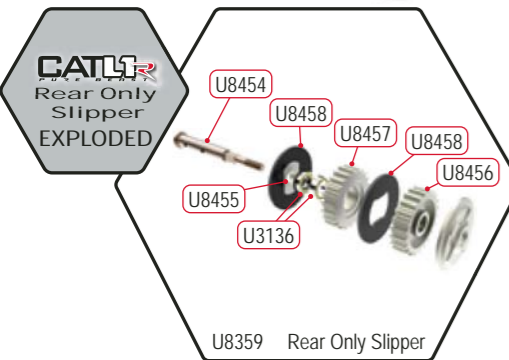
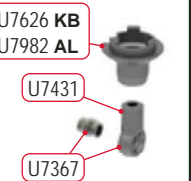
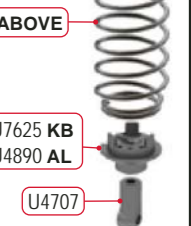
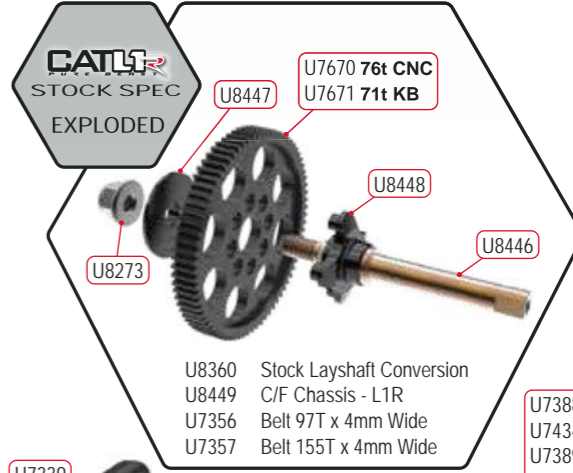
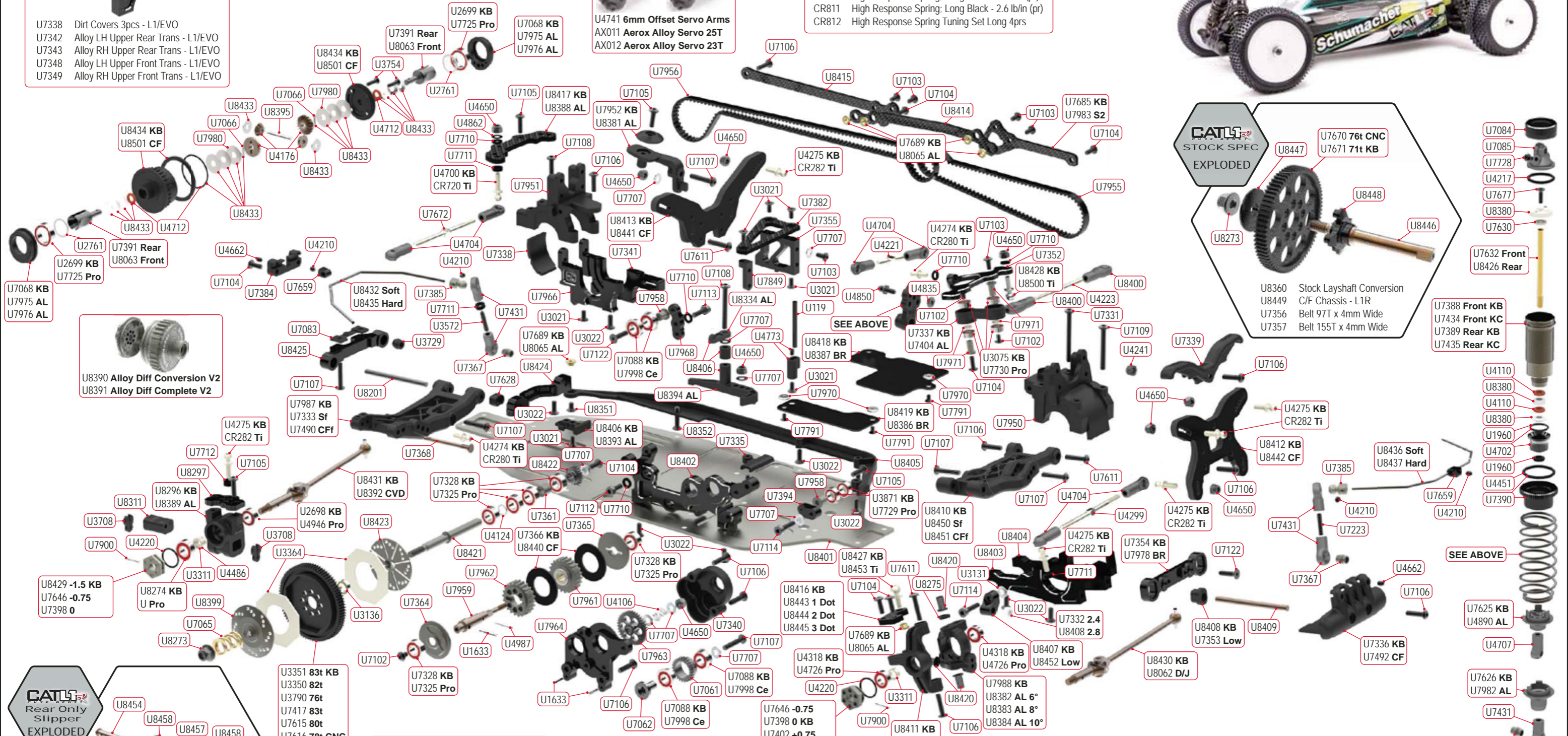

- Wheels**
- U4365 Wheel; Hex Rear - Black - Off Road - pr
 - U4366 Wheel; Hex Rear - White - Off Road - pr
 - U4495 Wheel; Hex Front - Black - 4wd - pr
 - U4496 Wheel; Hex Front - White - 4wd - pr
 - U7458 Wheel Front 4WD - Neon Yellow v2 - pr
 - U7459 Wheel Front 4WD - Neon Yellow v2 - 5pr
 - U7460 Wheel Rear Off-Road - Neon Yellow v2 - pr
 - U7461 Wheel Rear Off-Road - Neon Yellow v2 - 5pr
 - U7468 Wheel Front 4WD - White - 5pr
 - U7469 Wheel Rear Off-Road - White - 5pr

EXPLODED VIEW KEY:
KB = Kit Build, **AL** = Alloy, **BR** = Brass, **CF** = Carbon Fibre, **Cff** = Carbon Fibre Filled, **Ti** = Titanium, **S2** = S2 Material, **D/J** = Double Joint
KC = Kashima Coated, **Mf** = Medium Flex, **Sf** = Stiff Flex, **CNC** = Machined, **Pro** = Precision Bearing, **Ce** = Ceramic Bearing