



B2001 Ver. 2402

Driver: _____
 Date: _____
 Track: Hobby Action
 Event: _____

Track Condition
 Size: Open Mid Tight
 Traction: High Mid Low
 Condition: Smooth Bumpy Dry Wet
 Surface: Carpet Dirt Astroturf

Front Suspension

Ride Height: 18mm
 Camber: -1.5
 Toe: -1
 Anti-roll Bar: 1.0
 Front Bulkhead Spacer:
 Plastic mm / Brass mm
 Notes:

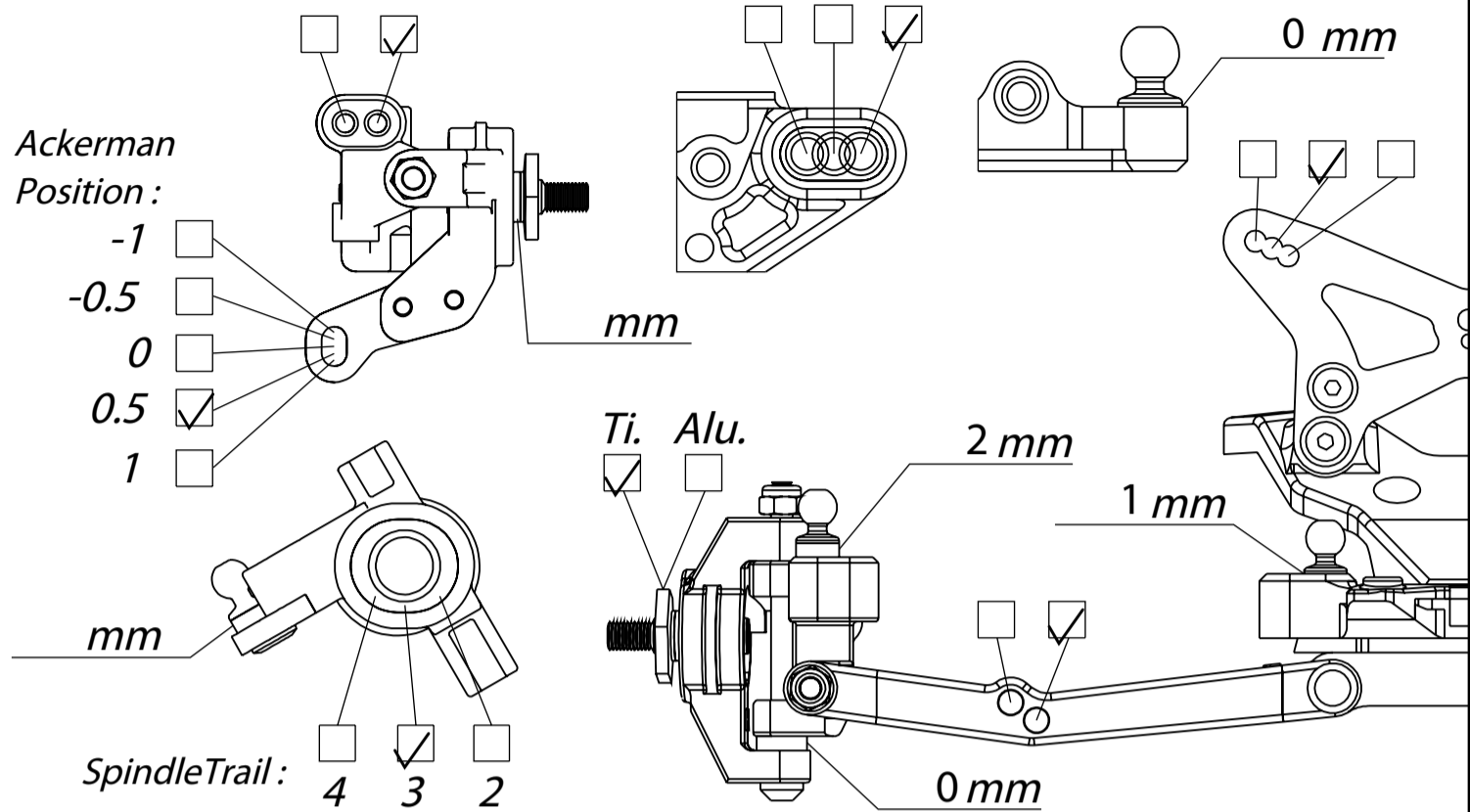

Rear Suspension

Ride Height: 18mm
 Camber: -1.5
 Anti-roll Bar: 0
 Arm Position: Fwd Back
 Hub Position: Fwd Mid Back
 Notes:

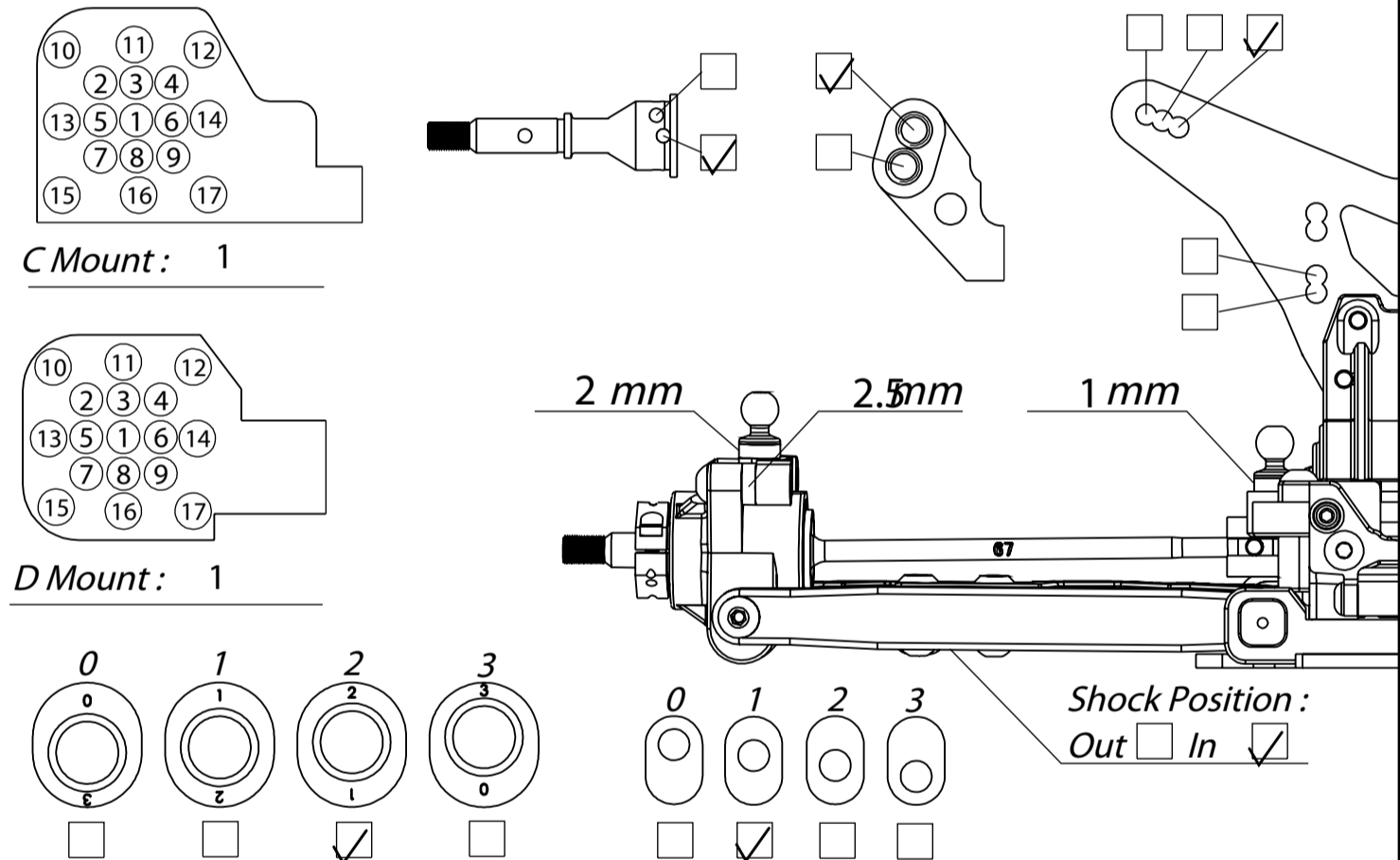

Shocks

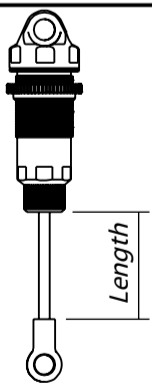

	Front		Rear		
Piston:	FP 2x1.6		FP 2x1.7 x1mm		
Oil:	FP3 50		3rd hole FP300		
Spring:					
Length:	23.5mm		29mm		
Limiters:	Int:	Ext:	Int:	Ext:	
Eyelet Length:	Std <input checked="" type="checkbox"/>	+2 <input type="checkbox"/>	Std <input checked="" type="checkbox"/>	+2 <input type="checkbox"/>	
Cup Offset:	Low <input type="checkbox"/>	Mid <input checked="" type="checkbox"/>	High <input type="checkbox"/>	Low <input checked="" type="checkbox"/>	Mid <input type="checkbox"/> High <input type="checkbox"/>

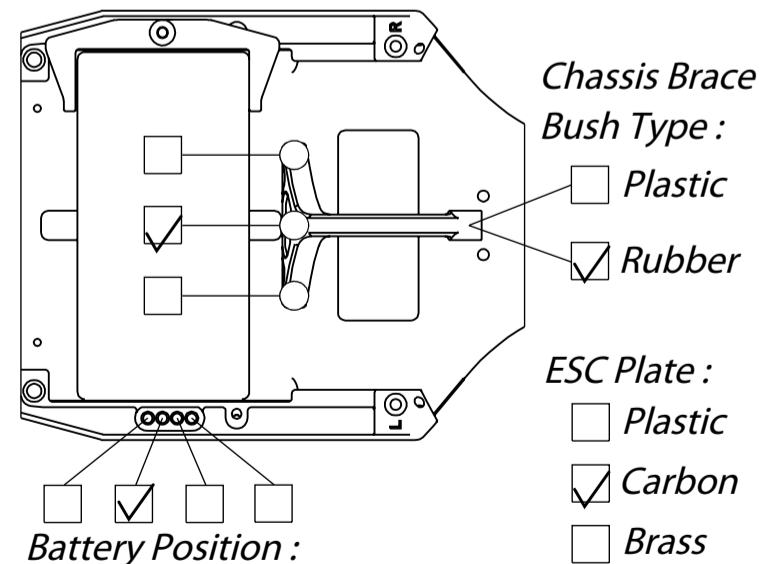

Electronics

Radio: _____
 Servo: _____
 ESC: _____
 Motor: _____
 Gearing: /
 Battery: / g
Weight
 Servo Weight: Yes No
 Battery Weight: 19g 37g

Differential

Gear Diff 2 Gear 4 Gear
 Ball Diff Setting: _____
 Oil: 10 K
 Friction O-ring: 2
 Tire Type: _____
 Compound: _____
 Inserts: _____
 Wheel: _____
 Additive: _____

Total Weight: _____ g

Body & Wing

Body: _____
 Rear Wing: _____
 Wing Angle: 0° 3° 6°
 Front Wing: _____ Low: High: