

Name: <u>Martin Sørli</u>		Date: <u>09.06.14</u>	Event: <u>Nordic Champs</u>
City: <u>Trelleborg</u>		Track: <u>Söderslätshallen</u>	
Track Conditions: <input checked="" type="checkbox"/> Indoor <input type="checkbox"/> Outdoor <input type="checkbox"/> Tight <input checked="" type="checkbox"/> Open <input checked="" type="checkbox"/> Smooth <input type="checkbox"/> Rough <input checked="" type="checkbox"/> Hard Packed <input type="checkbox"/> Loose/Loamy <input type="checkbox"/> Blue Groove <input checked="" type="checkbox"/> Dry <input type="checkbox"/> Wet <input type="checkbox"/> Dusty <input type="checkbox"/> Grass <input type="checkbox"/> Astro Turf <input checked="" type="checkbox"/> Low Bite <input type="checkbox"/> Med Bite <input type="checkbox"/> High Bite <input type="checkbox"/> Other _____			

Front Suspension

Toe: 0
 Ride Height: 19mm
 Camber: 1 deg
 Caster: ☐ 10° ☒ 15° ☐ 20°
 Sway Bar: _____
 Oil: 32,5
 Piston: 2x1.6mm
 Spring: ☐ Standard ☒ Low Freq. Color: Silver
 Shock Limiters: 2mm
 Shock Location: 2 - Outside
 Bump Steer Ball Stud: ☐ Standard ☒ Low Mount
 Bumper Steer Spacers: 3mm
 Camber Link: 2 - 2mm under outside ballstud
 Ackermann: B
 Notes: _____

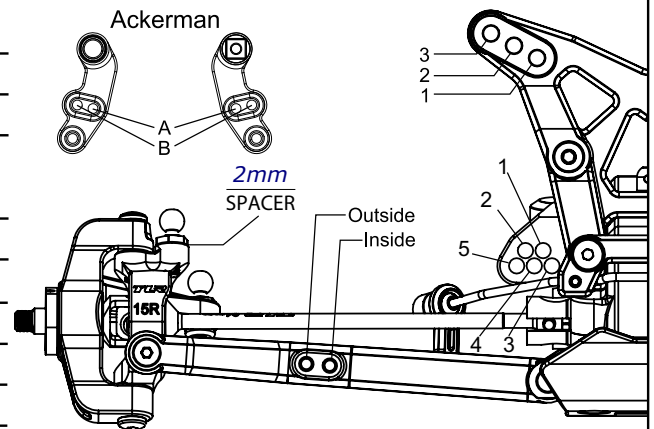

- ☒ TLR331012 Aluminum Servo Mount
- ☐ TLR334007 Aluminum Front Spindle
- ☒ TLR334009 Aluminum Steering Bellcrank

Rear Suspension

Toe: 3
 Anti-Squat: 1
 Roll Center: ☒ Low Roll Center (LRC) ☐ High Roll Center (HRC)
 Ride Height: 20mm
 Camber: 1 deg
 Rear Hub Spacing: middle
 Hex Width: std
 Sway Bar: Yellow
 Oil: 27,5
 Piston: 2x1.7mm
 Spring: ☐ Standard ☒ Low Freq. Color: White
 Shock Limiters: _____
 Camber Link: 2 - B
 Shock Locations: 3 - Inside
 Wing/Wickerbill: Cut by lowest line
 Battery Position: Shorty on left side.
 Notes: Mip CVDs. keeps the rear end flatter.

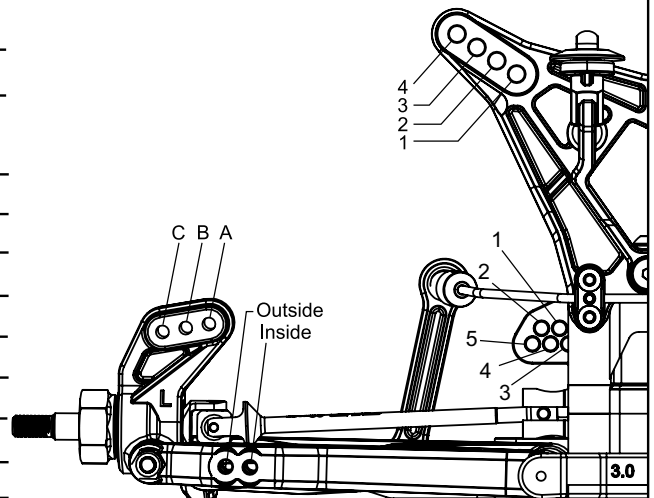

- ☐ TLR334008 Aluminum Rear Hub

Editable by Am0 at Petitr.com

Electronics

Radio: <u>Spektrum DX4R Pro</u>	Timing Advance: _____
Servo: <u>Spektrum S6090</u>	Throttle/Brake Expo: _____
ESC: <u>Absima Revenge CTS-10</u>	Servo Expo: _____
Initial Brake: _____	Throttle/Brake EPA: _____
Drag Brake: <u>0%</u>	Motor: <u>Absima Revenge CTM 7,5 turn</u>
Throttle Profile: <u>3</u>	Pinion: <u>22</u> Spur: <u>84</u>
	Battery: <u>Thunder Power 3800</u>

Tires

	Compound	Insert	Additive
Front: <u>Jconcepts Barcodes</u>	<u>Green</u>	<u>Standard</u>	_____
Rear: <u>Jconcepts Barcodes</u>	<u>Green</u>	<u>JC Dirttech</u>	_____
Notes: <u>Ran same set rears as I did on Saturdays 2wd race, fronts from friday practice. Just got better and better.</u>			
<u>The surface was polished and slippery, but eventually got more of a groove. Still super slippery though...</u>			