



NAME Leon McIntosh		DATE 2014-03-24	TRACK Shiverville Raceway
CITY Gainesville	COUNTRY USA		EVENT Supercup Rd. 3
TRACTION LEVEL <input type="radio"/> HIGH <input checked="" type="radio"/> MEDIUM <input type="radio"/> LOW		TRACK TYPE <input checked="" type="radio"/> OPEN <input type="radio"/> MEDIUM <input type="radio"/> TIGHT	TRACK SIZE <input type="radio"/> LARGE <input checked="" type="radio"/> MEDIUM <input type="radio"/> SMALL
CONDITIONS <input checked="" type="checkbox"/> WET <input type="checkbox"/> DUSTY <input type="checkbox"/> LOOMY <input type="checkbox"/> DRY <input checked="" type="checkbox"/> GROOVED <input type="checkbox"/> ROUGH		SURFACE <input type="checkbox"/> INDOORS <input type="checkbox"/> GRAVEL <input type="checkbox"/> CARPET <input checked="" type="checkbox"/> OUTDOORS <input type="checkbox"/> ASTRO <input type="checkbox"/> ASPHALT	

Front Suspension

Toe: 0*

Ride Height: 20 mm

Camber: -2*

Caster: ☐ 10° ☒ 15° ☐ 20°

Sway Bar: None

Oil: 35 wt.

Piston: 1.4 x 3

Spring: ☐ Standard ☒ Low Freq. Color: Silver

Shock Limiters: 2 mm

Shock Location: 2 - inside

Bump Steer Ball Stud: ☒ Standard ☐ Low Mount

Bumper Steer Spacers: 0

Camber Link: 1

Ackermann: A

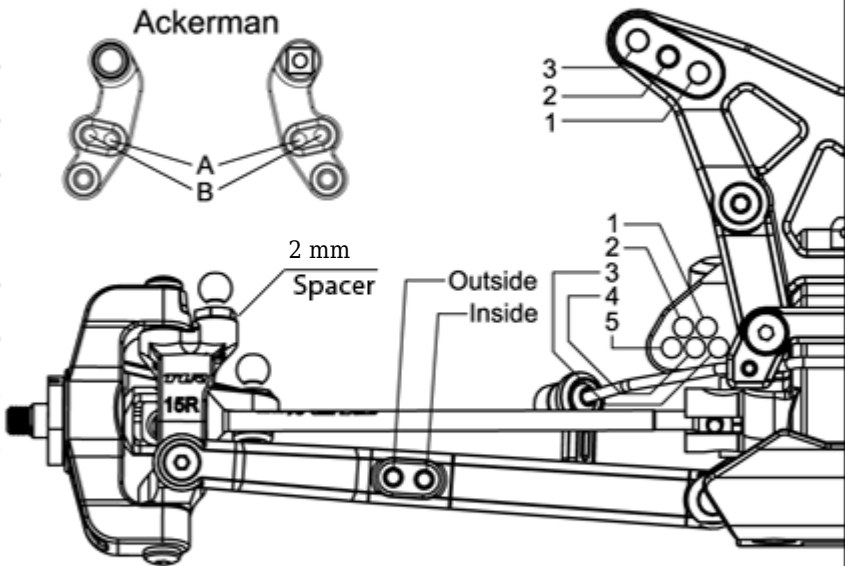

Notes: Front tires are crucial at this track

Rear Suspension

Toe: 3

Anti-Squat: 2*

Roll Center: ☒ Low Roll Center (LRC) ☐ High Roll Center (HRC)

Ride Height: 22 mm

Camber: -2*

Rear Hub Spacing: Forward 1 mm

Hex Width: Stock alum.

Sway Bar: Yellow

Oil: 32.5 wt.

Piston: 2 x 1.6

Spring: ☐ Standard ☒ Low Freq. Color: Yellow

Shock Limiters: 2 turns out on eyelet

Camber Link: 3 - B

Shock Locations: 2 - outside

Wing/Wickerbill: Stock 1/4" wicker

Battery Position: Back

Notes: Rear end was right

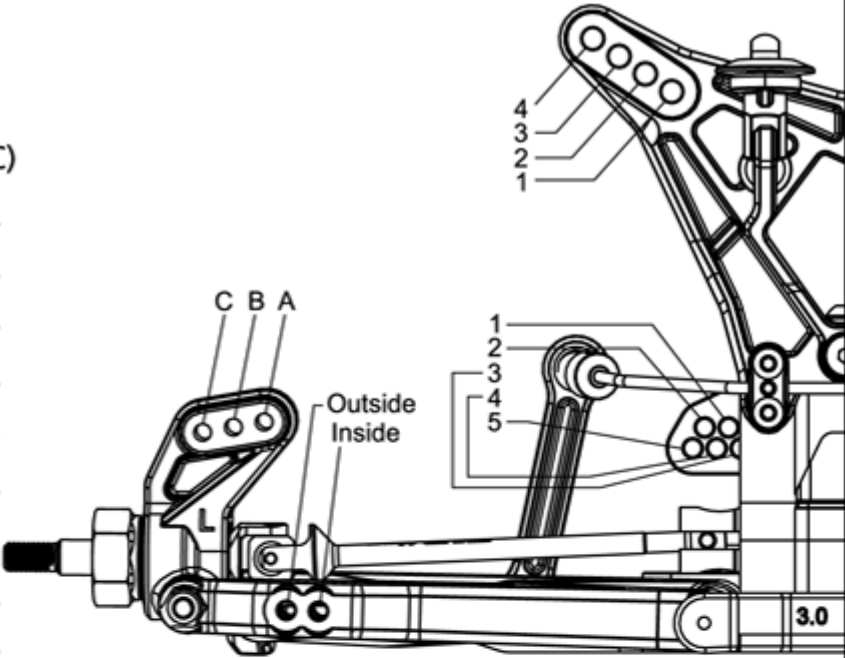

Electronics

Radio: Dx4r

Servo:

ESC: Hobbywing v3.1

Initial Brake:

Drag Brake:

Throttle Profile:

Timing Advance:

Throttle/Brake Expo: -25/0

Servo Expo:

Throttle/Brake EPA: 100/75

Motor: Orion 6.5 VST2

Pinion: 18 Spur:

Battery: Team zombie 6000

	Compound	Insert	Additive
Tires Front:	Proline Scrub M3	Cc	SK blue
Rear:	Proline Suburb M4	Cc	SK blue

Notes: Setup was good but my tire selection sucked in the main. At night and early morning need to go with M4s or MCs w/ shiver sauce