



NAME Leon McIntosh		DATE 2014-02-23	TRACK SCRC Raceway
CITY Cape Canaveral	COUNTRY USA		EVENT Chaos Rd. 2 warm up
TRACTION LEVEL <input type="radio"/> HIGH <input checked="" type="radio"/> MEDIUM <input type="radio"/> LOW		TRACK TYPE <input type="radio"/> OPEN <input checked="" type="radio"/> MEDIUM <input type="radio"/> TIGHT	TRACK SIZE <input type="radio"/> LARGE <input checked="" type="radio"/> MEDIUM <input type="radio"/> SMALL
CONDITIONS <input type="checkbox"/> WET <input checked="" type="checkbox"/> DUSTY <input type="checkbox"/> LOOMY <input checked="" type="checkbox"/> DRY <input checked="" type="checkbox"/> GROOVED <input checked="" type="checkbox"/> ROUGH		SURFACE <input checked="" type="checkbox"/> INDOORS <input type="checkbox"/> GRAVEL <input type="checkbox"/> CARPET <input type="checkbox"/> OUTDOORS <input type="checkbox"/> ASTRO <input type="checkbox"/> ASPHALT	

Front Suspension

Toe: 0

Ride Height: 20 mm

Camber: -2 degrees

Caster: ☒ 10° ☐ 15° ☐ 20°

Sway Bar: White

Oil: 35 wt TLR

Piston: 1.4 x 3

Spring: ☐ Standard ☒ Low Freq. Color: Silver

Shock Limiters: 2mm

Shock Location: 2 - Inside

Bump Steer Ball Stud: ☒ Standard ☐ Low Mount

Bumper Steer Spacers: None

Camber Link: #1

Ackermann: A

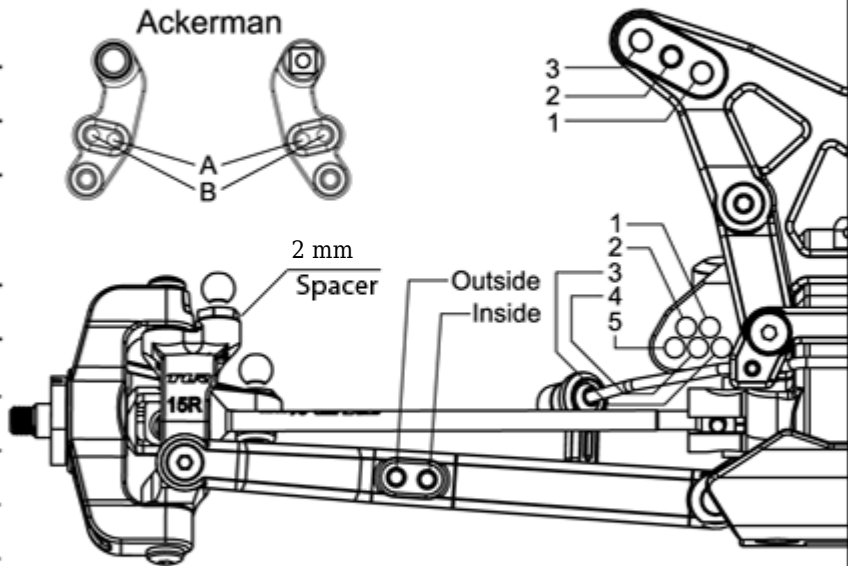

Notes: Need to either try 37.5 oil or one step thicker sway bar

Rear Suspension

Toe: 3 degrees

Anti-Squat: 2 degrees

Roll Center: ☒ Low Roll Center (LRC) ☐ High Roll Center (HRC)

Ride Height: 21mm

Camber: -2 degrees

Rear Hub Spacing: Middle

Hex Width: Std. Aluminum

Sway Bar: Yellow

Oil: 30wt TLR

Piston: 1.6 x 2

Spring: ☐ Standard ☒ Low Freq. Color: Yellow

Shock Limiters: -4 turns

Camber Link: 3 - B

Shock Locations: 3 - outside

Wing/Wickerbill: LFR Hammer, 1/2 inch

Battery Position: Back

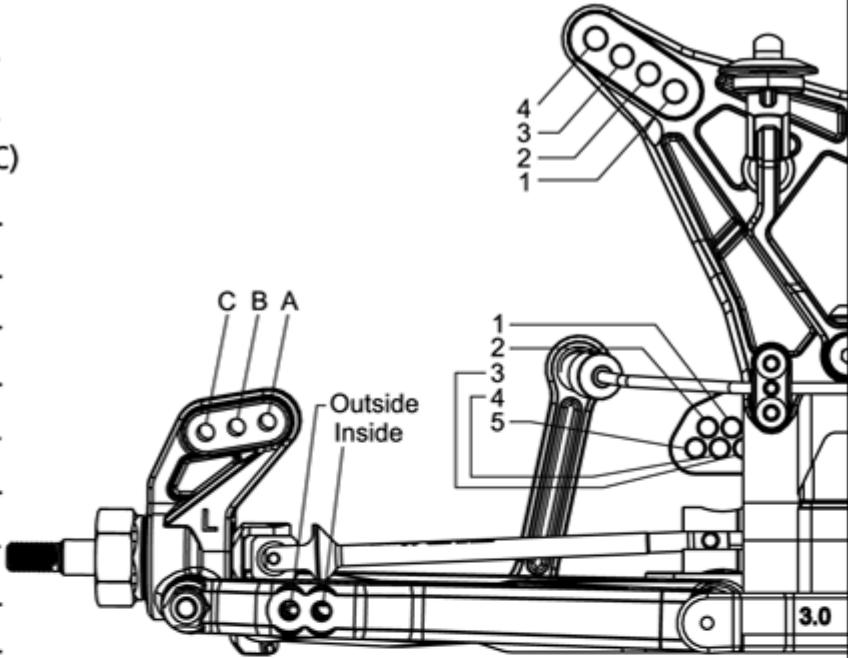

Notes: Take rear droop out. Turn eyelets up. Try 2.5 anti squat.

Try pink LF springs. IN THIS ORDER

Electronics

Radio: DX4R Pro

Servo: _____

ESC: Hobbywing v3.1

Initial Brake: _____

Drag Brake: 10%

Throttle Profile: _____

Timing Advance: 15 degrees

Throttle/Brake Expo: -25/0

Servo Expo: _____

Throttle/Brake EPA: 100/70

Motor: Orion 6.5 VST2

Pinion: 18 Spur: _____

Battery: Team Zombie 6000

Tires	Compound	Insert	Additive
Front: <u>Proline Scrub</u>	<u>M3</u>	<u>CC</u>	<u>None</u>
Rear: <u>Proline Suburb 1</u>	<u>M3</u>	<u>CC</u>	<u>None</u>

Notes: Ran heavy clicker spring locked down. Try full time 4wd back to back. Clicker let me be more aggressive

under braking but not sure it's the best option.
