



NAME Leon McIntosh		DATE 2014-02-10	TRACK Space Coast RC Raceway
CITY Cape Canaveral	COUNTRY USA		EVENT Chaos Final Setup
TRACTION LEVEL <input checked="" type="radio"/> HIGH <input type="radio"/> MEDIUM <input type="radio"/> LOW		TRACK TYPE <input type="radio"/> OPEN <input type="radio"/> MEDIUM <input checked="" type="radio"/> TIGHT	TRACK SIZE <input type="radio"/> LARGE <input checked="" type="radio"/> MEDIUM <input type="radio"/> SMALL
CONDITIONS <input type="checkbox"/> WET <input checked="" type="checkbox"/> DUSTY <input type="checkbox"/> LOOMY <input checked="" type="checkbox"/> DRY <input checked="" type="checkbox"/> GROOVED <input checked="" type="checkbox"/> ROUGH		SURFACE <input checked="" type="checkbox"/> INDOORS <input type="checkbox"/> GRAVEL <input type="checkbox"/> CARPET <input type="checkbox"/> OUTDOORS <input type="checkbox"/> ASTRO <input type="checkbox"/> ASPHALT	

Front Suspension

Toe: 0 degrees

Ride Height: 21mm

Camber: -2 degrees

Caster: ☐ 10° ☒ 15° ☐ 20°

Sway Bar: none

Oil: 32.5 wt TLR

Piston: 1.6 x 2

Spring: ☐ Standard ☒ Low Freq. Color: Silver

Shock Limiters: 2mm

Shock Location: 2 - Inside

Bump Steer Ball Stud: ☒ Standard ☐ Low Mount

Bumper Steer Spacers: none

Camber Link: 1

Ackermann: A

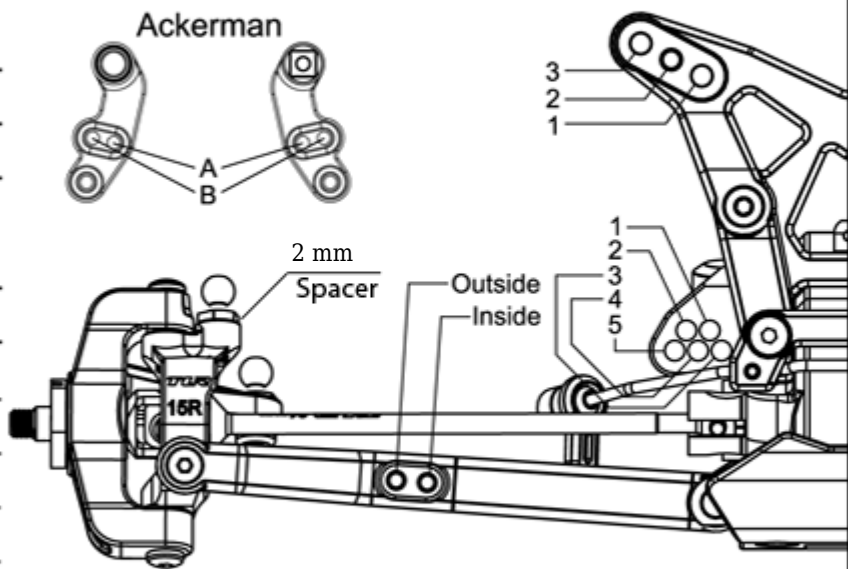

Notes: want to try: thin sway bar, 35 wt oil, outside hole on arm

Rear Suspension

Toe: 3 degrees

Anti-Squat: 3 degree

Roll Center: ☒ Low Roll Center (LRC) ☐ High Roll Center (HRC)

Ride Height: 22mm

Camber: -2 degrees

Rear Hub Spacing: middle

Hex Width: standard

Sway Bar: Yellow

Oil: 30wt TLR

Piston: 1.7 x 2

Spring: ☐ Standard ☒ Low Freq. Color: Yellow

Shock Limiters: none

Camber Link: 5 - B

Shock Locations: 3 - Outside

Wing/Wickerbill: LFR Hammer, 1/2" wicker

Battery Position: Back

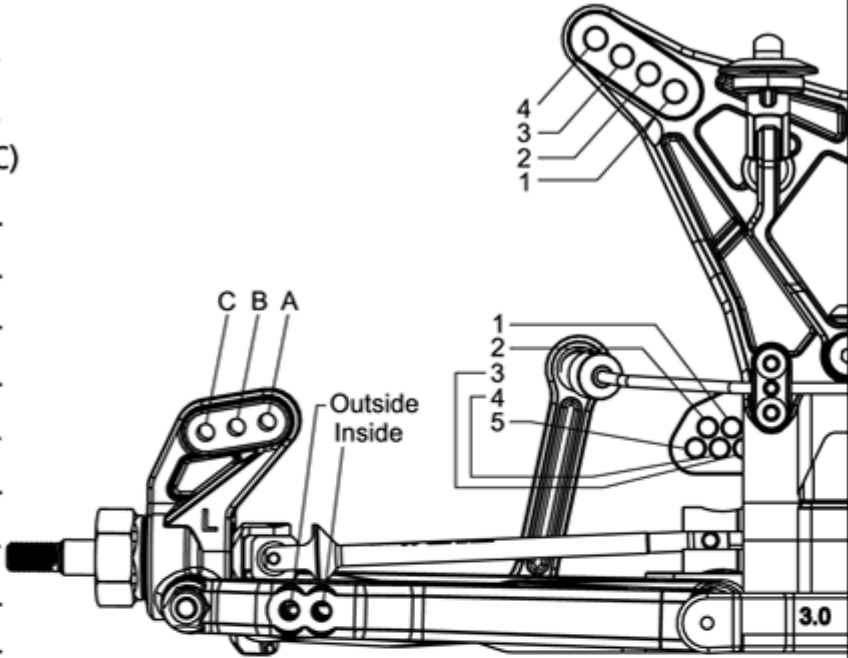

Notes: try 2 degrees anti squat, 1.6 rear pistons with thin sway bar. maybe try a tight clicker??

Electronics

Radio: DX4R Pro

Servo:

ESC: Hobbywing V3.1

Initial Brake:

Drag Brake:

Throttle Profile: 1

Timing Advance: 10

Throttle/Brake Expo: -30 / 0

Servo Expo:

Throttle/Brake EPA: 100 / 75

Motor: Orion VST2 6.5

Pinion: 18 Spur: stock

Battery: Team Zombie 6000 saddle

Tires	Compound	Insert	Additive
Front: Proline Scrub	M3	CC	none
Rear: Proline Suburb	M3	CC	none

Notes: car was super easy to drive but it seemed to stall rotation 1/2 to 3/4 the way through the corner. Also car wanted to traction roll a good bit in the high speed corners, try above notes to solve that. First time out, Qualified second and won