

Name: JP Richards		Date: 10/11/14	Event: WRL 4.1
City: Columbus		State: Ohio	
Track: Sparks Park Raceway			
Track Conditions	<input checked="" type="checkbox"/> Indoor <input type="checkbox"/> Outdoor	<input checked="" type="checkbox"/> Tight <input type="checkbox"/> Open	<input checked="" type="checkbox"/> Smooth <input type="checkbox"/> Rough
	<input checked="" type="checkbox"/> Hard Packed <input type="checkbox"/> Loose/Loamy	<input type="checkbox"/> Blue Groove <input checked="" type="checkbox"/> Dry	<input checked="" type="checkbox"/> Wet <input type="checkbox"/> Dusty
	<input type="checkbox"/> Grass <input type="checkbox"/> Astro Turf	<input checked="" type="checkbox"/> Low Bite <input type="checkbox"/> Med Bite	<input type="checkbox"/> High Bite <input type="checkbox"/> Other _____

Front Suspension

Toe: +1 degree
 Ride Height: 21mm (body on)
 Camber: -2 degrees
 Caster: ☐ 10° ☒ 15° ☐ 20°
 Sway Bar: None
 Oil: 35wt TLR
 Piston: 2x1.6
 Spring: ☐ Standard ☒ Low Freq. Color: Silver
 Shock Limiters: 2mm
 Shock Location: 2 - Inside
 Bump Steer Ball Stud: ☒ Standard ☐ Low Mount
 Bumper Steer Spacers: 2mm
 Camber Link: 1 w/ 2mm on the caster block
 Ackermann: B

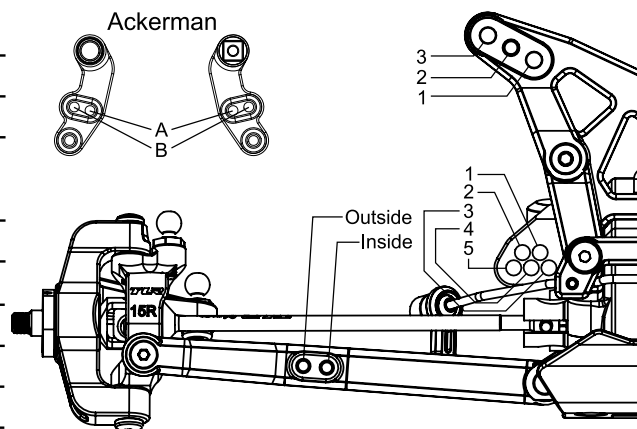

Notes: Front diff a little looser than the rear.

Rear Suspension

Toe: 3.0 Degree
 Anti-Squat: 2.0 degrees
 Roll Center: ☒ Low Roll Center (LRC) ☐ High Roll Center (HRC)
 Ride Height: 20mm
 Camber: -2 degrees
 Rear Hub Spacing: Forward 1mm (1mm front, 3mm back)
 Hex Width: +1.5mm (TLR332011)
 Sway Bar: Pink
 Oil: 27.5wt. TLR
 Piston: 4x55 machined
 Spring: ☐ Standard ☒ Low Freq. Color: Yellow
 Shock Limiters: 0mm
 Camber Link: 5 - B
 Shock Locations: 2 - Inside
 Wing/Wickerbill: 6.5" Wing - 1 line
 Battery Position: Shorty on left side, forward. (ESC on right side)

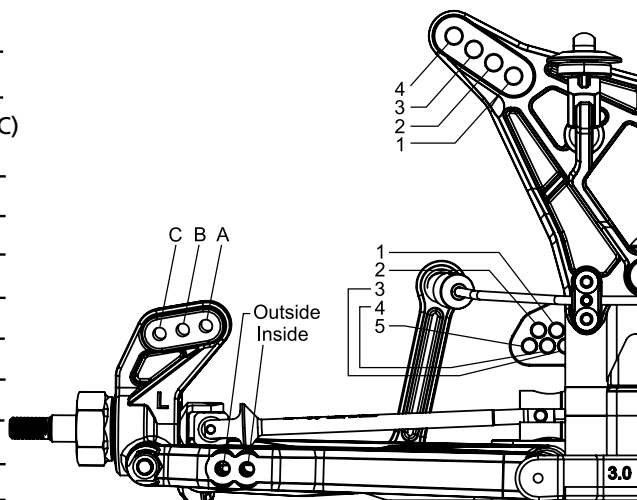
Electronics

Radio: <u>Airtronics M12</u>	Timing Advance: <u>0</u>
Servo: <u>Xpert SN-3401</u>	Throttle/Brake Expo: <u>0</u>
ESC: <u>Viper VTX10R-BE</u>	Servo Expo: <u>0</u>
Initial Brake: _____	Throttle/Brake EPA: <u>100/90</u>
Drag Brake: <u>5%</u>	Motor: <u>Orion VST2 Pro 6.5</u>
Throttle Profile: <u>9400</u>	Pinion: <u>19</u> Spur: <u>84</u>
	Battery: <u>Reedy 4100 Shorty</u>

Tires	Compound	Insert	Additive
Front: <u>AKA Typo</u>	<u>Clay</u>	<u>STD Red</u>	<u>Liquid Wrench</u>
Rear: <u>AKA Chainlink</u>	<u>Clay</u>	<u>STD Red</u>	<u>Liquid Wrench</u>

Notes: TLR Cab Forward 22-4 Body, cut left side guard to fit shorty LiPo, CVA TLR332012/13