



# Setup Sheet

Track: Rescue, Ca (Sacramento)

Driver: Matt Francis

<input type="checkbox"/> Indoor	<input type="checkbox"/> Smooth	<input checked="" type="checkbox"/> Slippery
<input checked="" type="checkbox"/> Outdoor	<input checked="" type="checkbox"/> Rough	<input type="checkbox"/> High-Bite
<input checked="" type="checkbox"/> Tight / <input type="checkbox"/> Open		<input type="checkbox"/> Blue-Groove

Date: June 2000

## FRONT SUSPENSION

(Circle or Check the Appropriate Settings)

Toe  In 0°  
 Out

Ride Height Arms Level

Camber  - 1°  
 +

Caster  Stock 30°  
 Other

Sway Bar  No  
 Yes size \_\_\_\_\_

# of washers under steering / tie-rod ball studs

Spindle ball stud: 1

Bellcrank ball stud: \_\_\_\_\_

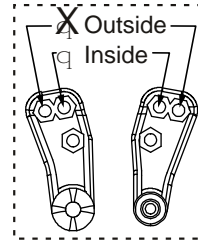

# of washers under ball stud 3

### Front Shocks

Oil: 30 wt Losi

Piston: 57  Standard /  Drilled

Spring: Green

Limiters:  Inside- .060  Outside- 0

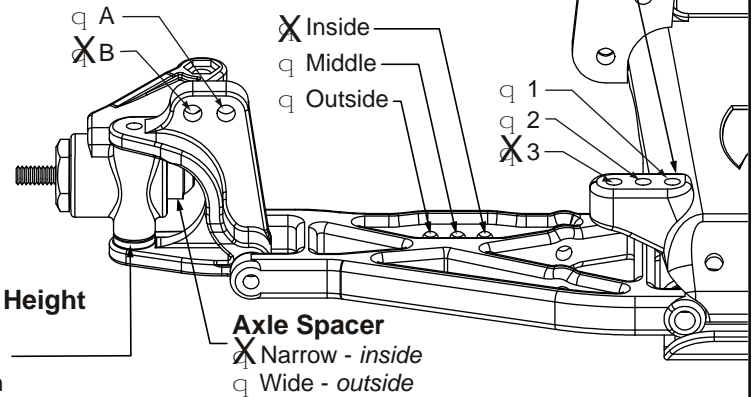

## REAR SUSPENSION

Toe-In  Inside 3°  
 Outside

Pivot Support 2  No Shim  
 Shim Under Front  
 Shim Under Rear > # of shims: \_\_\_\_\_

Ride Height Bones level

Camber  - 1/2°  
 +

Drive Shafts  Dogbones  Aluminum  
 CVDs  Steel

Rear Hub Spacing  Forward  
 Center  
 Rear

Outdrives  Steel  
 Plastic

Sway Bar  No  
 Yes size \_\_\_\_\_

### Wing Position

Forward  
 Back

### Wing Mount

Top  
 Bottom

### Rear Shocks

Oil: 27.5 wt Losi

Piston: 56  Standard /  Drilled

Spring: Pink

Limiters:  Inside- .050  Outside- 0

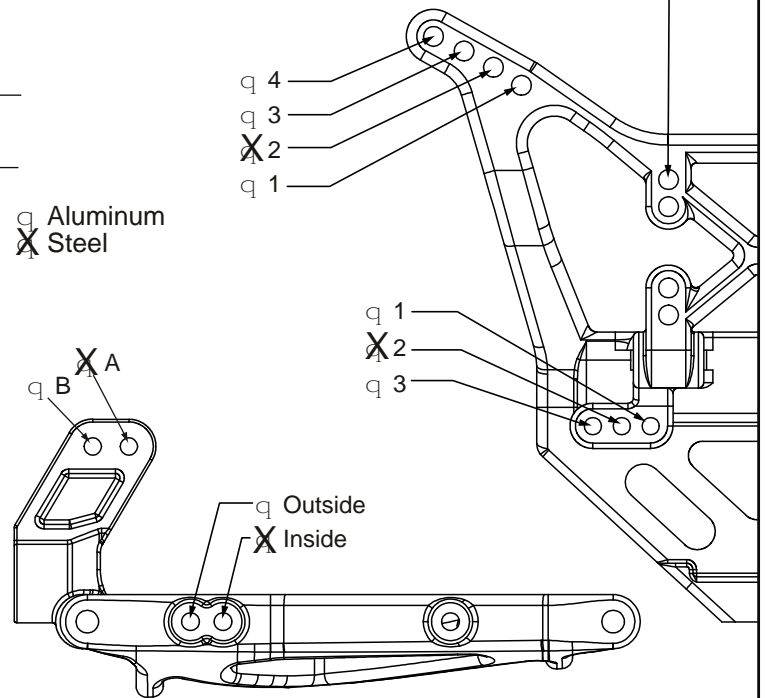

Tires

Front: A-7202 Wide body

Compound

Silver

Foam

Losi Firm

Motor: 13x2 Pinion/Spur: 24 92

Rear: A-7369 X-2000

Red

Losi Firm

Battery Position: Forward

Notes: 1/4 oz. Weight in front bulkhead