



Setup Sheet

Driver: Geoffrey Petit

Date: 08/05/99

Track: zillisheim

Indoor
 Outdoor

Slick
 Loose-Dirt

Smooth
 Rough

Tight / Open

Blue-Groove

Extra-Rough

Front Suspension (Circle or Check the Appropriate Settings)

Toe In 1 °
 Out

Ride Height Triangle a plat

Camber - 1 °
 +

Caster Stock
 Other

Sway Bar No
 Yes size _____

Steering Bellcranks

Inner Outer

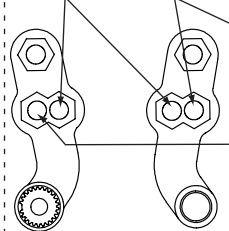

Rod Length

Stock
 Other 34mm

of washers 0

of washers 1

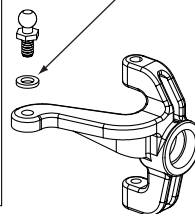

Inside
 Middle
 Outside

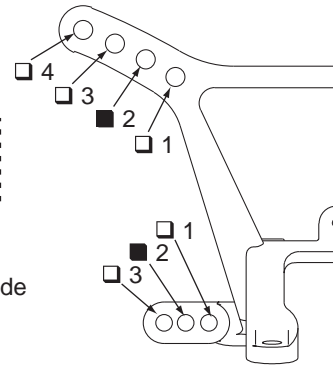

Front Shocks

Oil: 35

Piston: Black Standard / Drilled

Spring: BLEU

Limiters: Inside- / Outside- /

Rear Suspension

Toe-In Inside 2.5 °
 Outside

Ride Height Cardan a plat

Camber - 2.5 °
 +

Pivot Support No Shim
 Shim Under Front Shim Under Rear

Sway Bar No
 Yes size _____

Notes:

Rear Shocks

Oil: 35

Piston: BLEU Standard / Drilled

Spring: ROSE

Limiters: Inside- / Outside- /

Hole in Rear Hub 4

Hole in Bulkhead 0

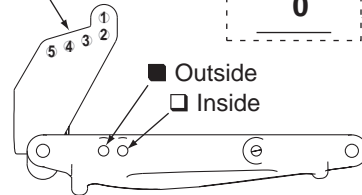

Outside
 Inside

Tires

Front: Ballistic Mini pin Pink

Rear: Ballistic Mini pin Pink

Compound

Foam

Motor: 12X3

Pinion: 17

Spur: 84

Clicker Adjustment: Locked One-Way: + possible

Battery Placement: Back Forward Other: _____

Notes: Voiture sousvireuse.