

Name: Ryan Harris Date: Event: Supercup Track: Newreds Hobbies - Ocala, FL

Track Conditions										
<input checked="" type="checkbox"/> Indoor	<input type="checkbox"/> Clay	<input type="checkbox"/> Carpet	<input checked="" type="checkbox"/> Tight	<input checked="" type="checkbox"/> Smooth	<input checked="" type="checkbox"/> Hard Packed	<input type="checkbox"/> Blue Groove	<input type="checkbox"/> Wet	Bite: <input type="checkbox"/> Low <input type="checkbox"/> Med <input checked="" type="checkbox"/> High	Other: Sealed Dirt Surface	
<input type="checkbox"/> Outdoor	<input checked="" type="checkbox"/> Dirt	<input type="checkbox"/> Astro	<input type="checkbox"/> Open	<input type="checkbox"/> Rough	<input type="checkbox"/> Loose/Loamy	<input type="checkbox"/> Dry	<input type="checkbox"/> Dusty	Tread: <input type="checkbox"/> Pin <input type="checkbox"/> Ghost <input checked="" type="checkbox"/> Slicks	New layout for the weekend	

Front Suspension

Ride Height	15	mm
Camber	-1.5	°
Toe	+1	°
Sway Bar	Kit	mm
Notes:		

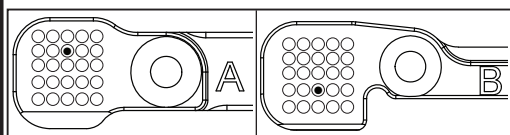
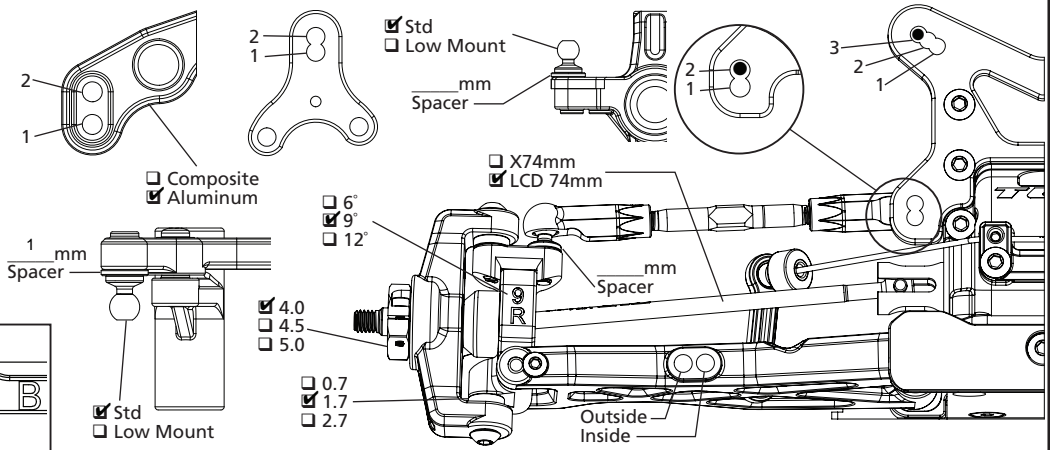

Rear Suspension

Ride Height	15	mm
Camber	-1.5	°
Sway Bar	Kit	mm
Notes:	Ti screws upper, Ti ballstuds Ti turnbuckles. Schelle ceramic bearings Aluminum chassis.	

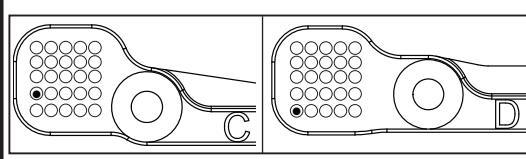
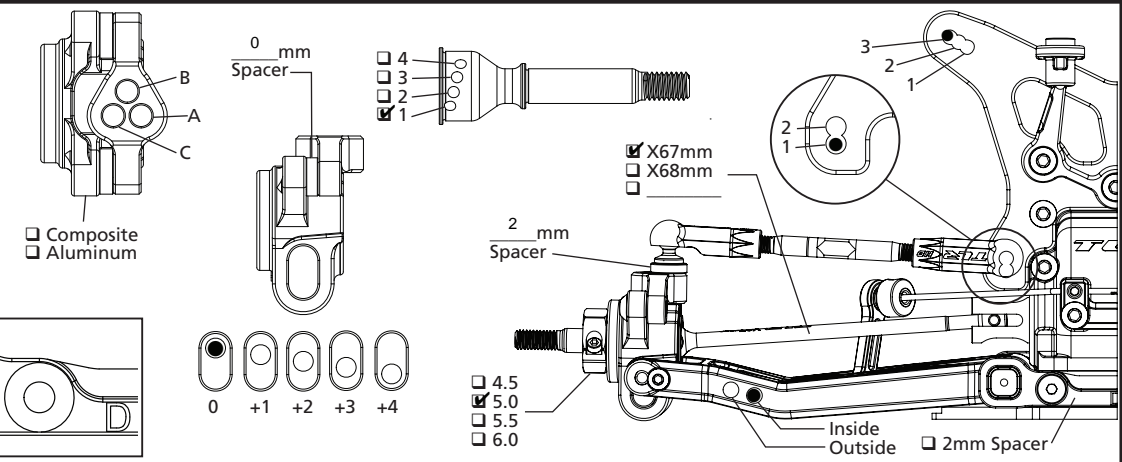

Chassis

Differentials	Front	Center	Rear
Fluid	10,000	500k	7,000
Int Gears	<input type="checkbox"/> Stl <input checked="" type="checkbox"/> Comp	<input type="checkbox"/> Stl <input checked="" type="checkbox"/> Comp	<input type="checkbox"/> Stl <input checked="" type="checkbox"/> Comp
Weight	g	g	g
Ring/Pin	<input type="checkbox"/> Stl <input checked="" type="checkbox"/> Comp		<input type="checkbox"/> Stl <input checked="" type="checkbox"/> Comp
Center Diff Cover		<input checked="" type="checkbox"/> Composite <input type="checkbox"/> Aluminum	
Slipper Pads		<input type="checkbox"/> Torque/Yellow <input type="checkbox"/> Drive/Orange	

Aerodynamics

Body	Rawspeed RS-3
Fr Scoop	TLR
Rr Wing	Rawspeed
Wicker	Low
Angle	0
Notes	

Tires

	Front	Rear
Brand	Rawspeed	Rawspeed
Tread	Slick	Slick
Compound	Clay (White)	Clay (White)
Insert	Rawspeed	Rawspeed V Cut
Sauce	TDK 2.0	TDK 2.0
Wheel	TLR	TLR
Notes	Warmers 5 min	Warmers 5 min

Shocks

	Front	Rear
Shock Caps	Domed	Domed
Oil	42.5wt TLR	37.5wt TLR
Piston	2 x 1.6 <input checked="" type="checkbox"/> Thin	2 x 1.7 <input checked="" type="checkbox"/> Thin
Limiter, Int	0 mm	0 mm
Shaft Dia	<input checked="" type="checkbox"/> 3.0mm <input type="checkbox"/> 3.5mm	<input checked="" type="checkbox"/> 3.0mm <input type="checkbox"/> 3.5mm
Limiter, Ext	1 mm	0 mm
Stroke	24 mm	30.5 mm
Eyelet	<input checked="" type="checkbox"/> Std <input type="checkbox"/> +2mm	<input checked="" type="checkbox"/> Std <input type="checkbox"/> +2mm
Spring	AE V2 Yellow	AE V2 Blue
Spring Cup	<input type="checkbox"/> Low <input checked="" type="checkbox"/> Mid <input type="checkbox"/> High	<input checked="" type="checkbox"/> Low <input type="checkbox"/> Mid <input type="checkbox"/> High

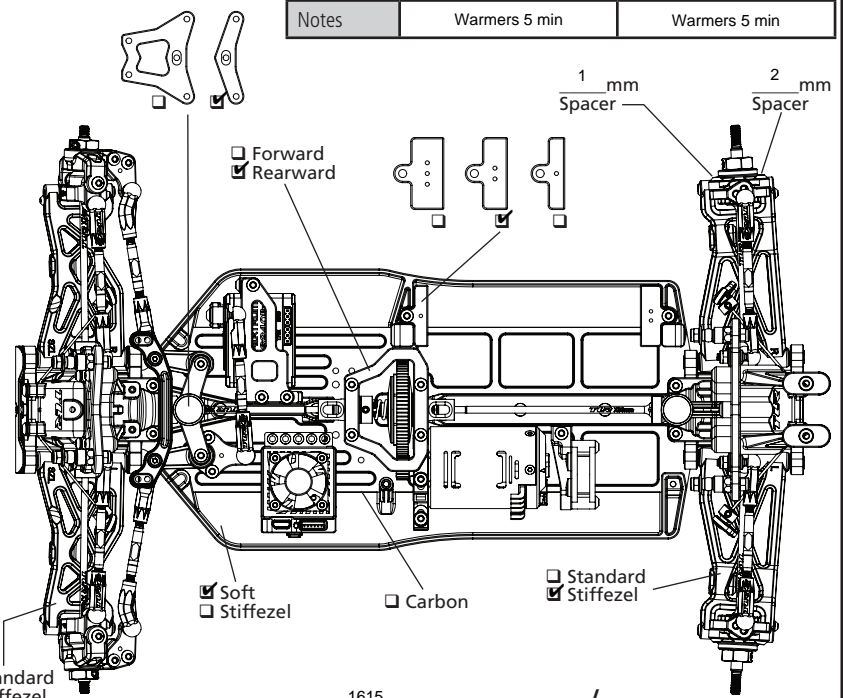

Electronics

Radio	M17	ESC	Hobbywing XR10 G2
Servo	S6245 w/ mount	Thro Prof	4k
Battery	Trinity 4100 LCG	Timing Adv	0
Battery Wt	g	Initial Brake	100
Motor	Xfactor 13.5 Cert	Drag Brake	0
Gearing	78 / 23	Thr/Bra EPA	100 / 85

Total Weight: 1615 g Fr/Rr _____ % / _____ %