

Track Conditions									
<input checked="" type="checkbox"/> Indoor	<input checked="" type="checkbox"/> Clay	<input type="checkbox"/> Carpet	<input checked="" type="checkbox"/> Tight	<input checked="" type="checkbox"/> Smooth	<input checked="" type="checkbox"/> Hard Packed	<input type="checkbox"/> Blue Groove	<input type="checkbox"/> Wet	Bite: <input type="checkbox"/> Low <input type="checkbox"/> Med <input checked="" type="checkbox"/> High	Other: Sealed Clay
<input type="checkbox"/> Outdoor	<input type="checkbox"/> Dirt	<input type="checkbox"/> Astro	<input type="checkbox"/> Open	<input type="checkbox"/> Rough	<input type="checkbox"/> Loose/Loamy	<input type="checkbox"/> Dry	<input type="checkbox"/> Dusty	Tread: <input type="checkbox"/> Pin <input type="checkbox"/> Ghost <input checked="" type="checkbox"/> Slicks	Very High-Bite

Front Suspension

Ride Height	13	mm
Camber	-2	°
Toe	0	°
Sway Bar	1.4	mm

Notes: This setup should be quite helpful for anyone looking to tame down the car on a super high-bite tight track. If you can find a LF Gold front spring, try that as well.

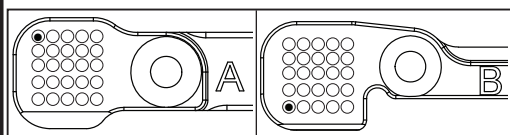
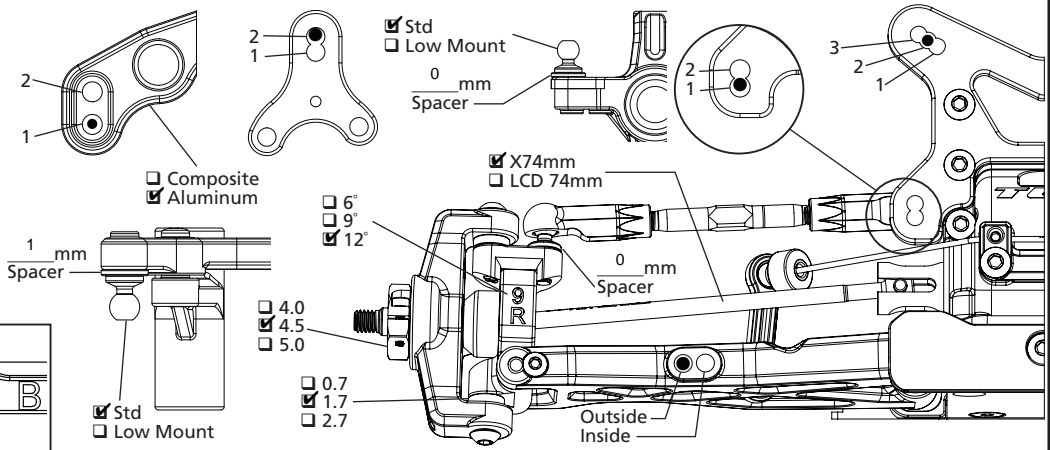

Rear Suspension

Ride Height	14	mm
Camber	-1	°
Sway Bar	1.2	mm

Notes:

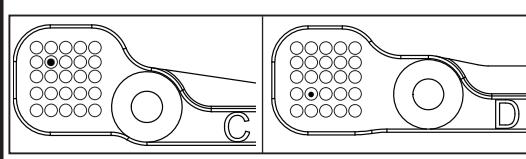
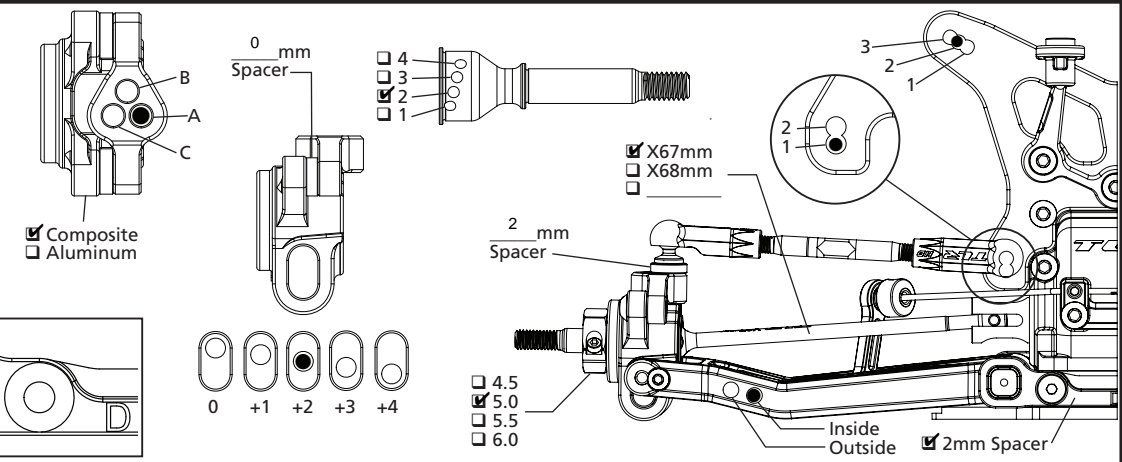

Chassis

Differentials	Front	Center	Rear
Fluid	7,000	500,000	5,000
Int Gears	<input type="checkbox"/> Stl <input checked="" type="checkbox"/> Comp	<input type="checkbox"/> Stl <input checked="" type="checkbox"/> Comp	<input type="checkbox"/> Stl <input checked="" type="checkbox"/> Comp
Weight	g	g	g
Ring/Pin	<input type="checkbox"/> Stl <input checked="" type="checkbox"/> Comp		<input type="checkbox"/> Stl <input checked="" type="checkbox"/> Comp
Center Diff Cover		<input checked="" type="checkbox"/> Composite <input type="checkbox"/> Aluminum	
Slipper Pads		<input type="checkbox"/> Torque/Yellow <input type="checkbox"/> Drive/Orange	

Aerodynamics

Body	Stock TLR
Fr Scoop	N/A
Rr Wing	TLR
Wicker	Cut Half
Angle	0
Notes	

Tires

	Front	Rear
Brand	AKA	AKA
Tread	EVO Slicks	2.2" Slicks
Compound	Purple	Purple
Insert	Red	Red
Sauce	SXT Baja	SXT Baja
Wheel	AKA EVO	AKA 2.2"
Notes	Run Black Insert if Possible	

Shocks

	Front	Rear
Shock Caps	Composite	Composite
Oil	45	40
Piston	2 x 1.5 <input checked="" type="checkbox"/> Thin	2 x 1.7 <input checked="" type="checkbox"/> Thin
Limiters, Int	1 mm	2 mm
Shaft Dia	<input checked="" type="checkbox"/> 3.0mm <input type="checkbox"/> 3.5mm	<input checked="" type="checkbox"/> 3.0mm <input type="checkbox"/> 3.5mm
Limiters, Ext	1 mm	1 mm
Stroke	mm	mm
Eyelet	<input checked="" type="checkbox"/> Std <input type="checkbox"/> +2mm	<input checked="" type="checkbox"/> Std <input type="checkbox"/> +2mm
Spring	LF Yellow	LF Pink
Spring Cup	<input type="checkbox"/> Low <input type="checkbox"/> Mid <input checked="" type="checkbox"/> High	<input type="checkbox"/> Low <input checked="" type="checkbox"/> Mid <input type="checkbox"/> High

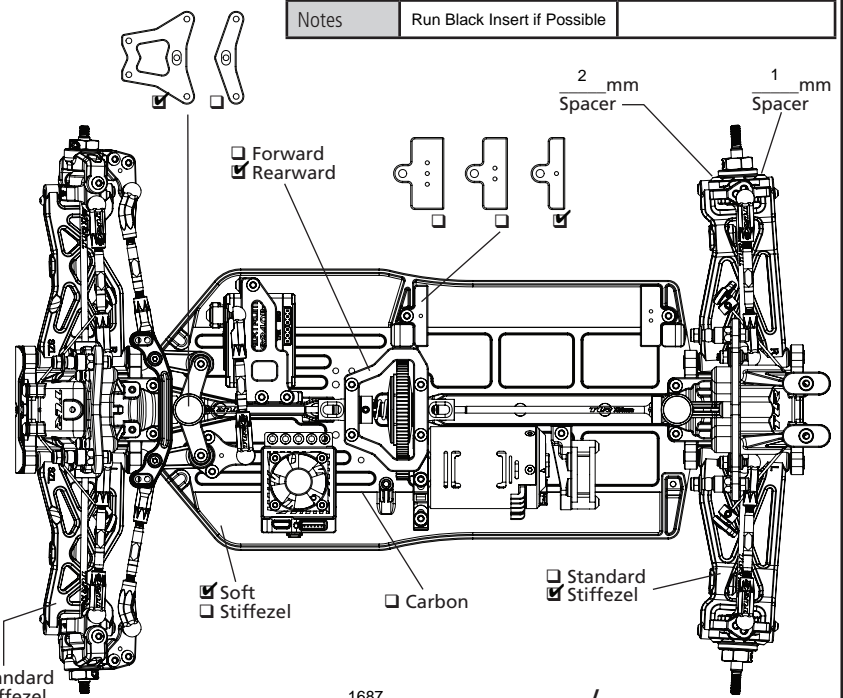

Electronics

Radio	Spektrum	ESC	HobbyWing XR10 Pro
Servo	Spektrum 6240RX	Thro Prof	Linear
Battery	Team Orion 4500	Timing Adv	Blinky
Battery Wt	200 g	Initial Brake	0
Motor	Trinity D4 13.5	Drag Brake	0
Gearing	26 / 78	Thr/Bra EPA	/

Total Weight: 1687 g Fr/Rr % / %