

LG10B5 EXPLODED VIEW

4WD electric racing buggy

Class: 1/10 electric 4WD off-road car
 Width: Adjustable 245-250mm
 Length: 350 mm
 Wheelbase: Adjustable 279-281 mm
 Weight: 1050 g
 Ready-to-run weight: 1750 g

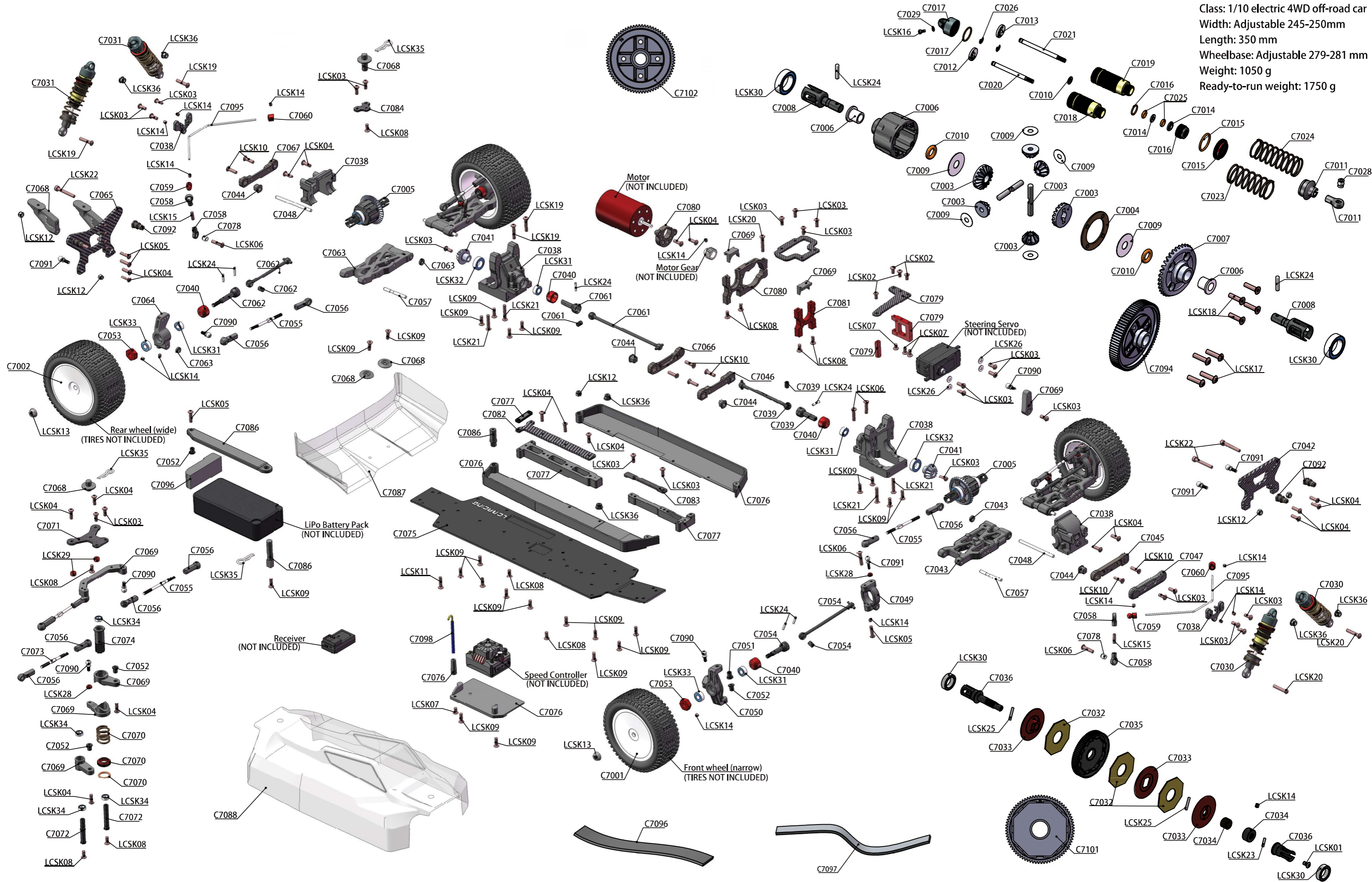

MODEL	PRODUCT DESCRIPTION
C7001	1/10 4WD Front Buggy Wheels(2)
C7002	1/10 4WD Rear Buggy Wheels(2)
C7003	Diff Bevel Gears Set
C7004	Diff Gasket(4)
C7005	Gear Differential Set
C7006	Gear Differential Case
C7007	Steel Diff Bevel Gear 35T
C7008	Gear Diff Outdrive Light Weight (2)
C7009	Diff Washer 3x9x0.1(10)/5x15x0.3(10)
C7010	Diff O-Ring Red 5x2(10)
C7011	Shock Parts
C7012	Shock Pistons(1.6x2)-POM Machined
C7013	Shock Pistons(1.7x2)-POM Machined
C7014	Shock Cartridge Spacer-POM(4)
C7015	Shock Adjustable Nut Alu(2)
C7016	Lower Shock Body Cap(2)
C7017	Shock Cap Alu 7075-T6 Hard Coated(2)
C7018	Front Shock body Alu(2)
C7019	Rear Shock body Alu(2)
C7020	Front Shock Shaft(2)
C7021	Rear Shock Shaft(2)
C7022	Shock Spring Retaining Collar Alu(2)
C7023	Front Spring 3 Dots
C7024	Rear Spring 2 Dots
C7025	Shock O-Ring Red(10)
C7026	E-Clip 2.3(20)
C7027	O-ring 14.5x1.5(4)/12x1(4)/8x1(4)
C7028	Pivot Ball 5.8(4)

MODEL	PRODUCT DESCRIPTION
C7029	Hex Screw M2x4(4)/Shims 2x4x0.5(4)
C7030	Front Shock complete Set(2)
C7031	Rear Shock complete Set(2)
C7032	Slipper Pad HDS(3)
C7033	Slipper Hub Set Alu(3)
C7034	Slipper Nut+Spring Set
C7035	Slipper Spur Gear 48p 81T
C7036	Slipper Shaft+Outdrive Set(2)
C7037	Slipper Set
C7038	Front+Rear Gearbox Set
C7039	Center/Front Drive Shaft Set
C7040	Drive Shaft Collar Alu(4)
C7041	Steel Bevel Drive Gear 14T
C7042	Front Carbon Fiber Shock Tower 4mm
C7043	Front Suspension Arm(2)
C7044	Arm Mount Inserts Set(4)
C7045	Arm Mount FF Alu 7075-T6
C7046	Arm Mount FR Alu 7075-T6
C7047	Front Bumper
C7048	3x50mm Inner Hinge Pin(4)
C7049	C-Hub 9° Deg L+R
C7050	Steering Block L+R
C7051	Steel Bushing-Long(4)
C7052	Steel Bushing-Short(4)
C7053	Wheel Hub Hex 12mm Alu(4)
C7054	Front Drive Shaft Set(2)
C7055	Steel Turnbuckle M3x50mm(2)
C7056	5.5mm Ball Cap Set(14)

MODEL	PRODUCT DESCRIPTION
C7057	3x32mm Outer Hinge Pin(4)
C7058	5.5mm Ball Cap Open(4)
C7059	5.5MM Ball End Alu(4)
C7060	Stop Collar Alu(4)
C7061	Center/Rear Drive Shaft Set
C7062	Rear Drive Shaft(2)
C7063	Rear Suspension Arm(2)
C7064	Rear Hubs L&R(2)
C7065	Rear Carbon Fiber Shock Tower 3.0mm
C7066	Arm Mount RF 7075-T6 Alu
C7067	Arm Mount RR 7075-T6 Alu
C7068	Wing Mount+Body Mount Set
C7069	Servo Saver,Steering Plate,Servo Arm,Servo Mount,Center Bulkhead cover(10)
C7070	Servo Saver Spring&Adjustable Nut
C7071	Front Carbon Fiber Steering Upper Deck 2.0mm
C7072	Steering Posts(2)
C7073	Steel Turnbuckle M3x42mm(1)
C7074	Servo Saver Pipe
C7075	Chassis Alu-7075 T6 2.0mm
C7076	Chassis Side Guards L+R, Radio Plate
C7077	Chassis Brace F+R
C7078	Pivot Ball 5.5(4)
C7079	Floating Servo Mount
C7080	Motor Mount Set Alu-7075 T6
C7081	Center Bulkhead Alu
C7082	Carbon Fiber Chassis Brace Upper Deck Rear 2.0mm
C7083	Carbon Fiber Chassis Brace Upper Front 2.0mm
C7084	Rear Carbon Fiber Upper Deck 2.0mm

MODEL	PRODUCT DESCRIPTION
C7085	Carbon Fiber Center Upper Deck 2.0mm
C7086	Battery Strap+Holders
C7087	Rear Aero Wing(7")
C7088	LC10B5 Buggy Body/Rear Aero Wing(Light Weight)
C7090	Ball Stud 5.5mm With Thread 6mm
C7091	Ball Stud 5.5mm With Thread 8mm
C7092	Shock Bushings Alu Hard coated(2)
C7093	Center Differential Set
C7094	Center Differential Spur Gear 48p 81T
C7095	Sway bar Set
C7096	Self-Adhesive EVA Foam+Foam Spacer
C7097	Velcro Tape With Double-Side(4)
C7098	Antenna Tube With Caps(5)
C7099	1/10 4WD Front Buggy Wheels(10)
C7100	1/10 4WD Rear Buggy Wheels(10)
C7101	Slipper Spur Gear 48P 76T
C7102	Center Differential Spur Gear 48p 76T
HARDWARE	
LCSK01	Round Head Screw M3×5mm (2.0mm Hex Socket/20pcs)
LCSK02	Round Head Screw M3×6mm (2.0mm Hex Socket/20pcs)
LCSK03	Round Head Screw M3×8mm (2.0mm Hex Socket/20pcs)
LCSK04	Round Head Screw M3×10mm (2.0mm Hex Socket/20pcs)
LCSK05	Round Head Screw M3×12mm (2.0mm Hex Socket/20pcs)
LCSK06	Round Head Screw M3×14mm (2.0mm Hex Socket/20pcs)
LCSK07	Countersunk Screw M3×6mm (2.0mm Hex Socket/20pcs)
LCSK08	Countersunk Screw M3×8mm (2.0mm Hex Socket/20pcs)
LCSK09	Countersunk Screw M3×10mm (2.0mm Hex Socket/20pcs)

MODEL	PRODUCT DESCRIPTION
LCSK10	Countersunk Screw M3×12mm (2.0mm Hex Socket/20pcs)
LCSK11	Countersunk Screw M3×14mm (2.0mm Hex Socket/20pcs)
LCSK12	Lock Nut M3 (5.5mm nut driver/20pcs)
LCSK13	Flange Nut M4 (7.0mm nut driver/20pcs)
LCSK14	Set screw M3×3mm (1.5mm Hex Socket/20pcs)
LCSK15	Set screw M3×10mm (1.5mm Hex Socket/20pcs)
LCSK16	Socket Head Screw M2×4mm (1.5mm Hex Socket/20pcs)
LCSK17	Round Head Screw M2.6×10mm (2.0mm Hex Socket/20pcs)
LCSK18	Countersunk Screw M2.5×10mm (1.5mm Hex Socket/20pcs)
LCSK19	Round Head Screw M3×16mm (2.0mm Hex Socket/20pcs)
LCSK20	Round Head Screw M3×18mm (2.0mm Hex Socket/20pcs)
LCSK21	Countersunk Screw M3×18mm (2.0mm Hex Socket/20pcs)
LCSK22	Socket Head Screw M3×24mm Black (2.5mm Hex Socket/10pcs)
LCSK23	2×8mm Pins(20)
LCSK24	2×9.8mm Pins(20)
LCSK25	2×11.6mm Pins(20)
LCSK26	3×7×0.5mm Stainless Steel Washer(20)
LCSK27	3×6×1mm Aluminum Washer(10)
LCSK28	3×6×2mm Aluminum Washer(10)
LCSK29	3×6×3mm Aluminum Washer(10)
LCSK30	10×15×4mm Rubber Sealed Bearing(10)
LCSK31	5×10×4mm Rubber Sealed Bearing(10)
LCSK32	8×14×4mm Rubber Sealed Bearing(10)
LCSK33	5×11×4mm Rubber Sealed Bearing(10)
LCSK34	5×8×2.5mm Rubber Sealed Bearing(10)
LCSK35	1/10 Scale body Clip(20)
LCSK36	M3 Flanged Lock Nut(10)

LCRACING guarantees this product to be free of manufacturing faults and material defects. This product has been checked and fine tuned individually by professional staff and quality control staff. The warranty does not cover any component parts damaged by use and modification. Please visit <https://www.lcracing.net> for updated product information. This product is not a toy. It is not recommended for children under 14 years old and any minor should be accompanied by an adult when operating. This product is a precision machine that requires proper assembly and setup to avoid accidents. Failure to take caution when operating this product may result in serious injury or property damage. It is the owner's responsibility to operate this product in a safe manner. Manufacturer and its distributors are not responsible in any way for any and all bodily injury(s) and/or property damage that may occur from the use of or caused by in any way this product.

WARNINGS

- Do not attempt to disassemble or modify any of the product components without the assistance of an experienced RC user.
- Only use the correct type of battery to operate. Using any wrong type of battery will damage the product and possibly make it dangerous to operate.
- The motor(s) may get hot during use. Always allow 10-15 minutes between each run for the motor to cool down. This will prolong the life of your product.
- Choose an appropriate operating site consisting of flat, smooth ground, and clear open field. Do not operate near buildings, high voltage cable lines, or trees to ensure safety. RC models are prone to accidents, failures, and crashes due to a variety of reasons including, lack of maintenance, driver error, and radio interference.
- Drivers are responsible for their actions and damage or injury occurring during the operation.

- Do not operate in inclement weather, such as rain, wind, snow and darkness.
- The product is composed of precision electrical components. It is critical to keep the product away from moisture and other contaminants. Do not allow them to get wet. Electrical damage may occur that could affect safe operation.
- After each use, always allow the battery to cool down before recharging. When charging the battery pack, do not over charge! If batteries get hot during charging, discontinue charging immediately and disconnect the battery from the charger. Never leave battery unattended while charging. If you are unsure of how to charge this battery, please seek the advice of experienced RC users. Never let children charge the battery without adult supervision.
- Always turn on the transmitter before connecting the battery on the models. When turning off the model, always disconnect the battery first, and then turn off the transmitter. If the order is reversed, the model may become uncontrollable and cause serious damage.
- If you are in doubt of your ability to operate the model, we strongly recommend that you seek assistance from experienced RC users or join your local model flying club to gain the required knowledge and skill. As the manufacturer and distributor, we assume no liability for the use of this product.
- Before turning on your model and transmitter, please check to make sure no one else is operating under the same frequency. Frequency interference can cause your model, or other's models to crash. The guidance provided by experienced RC users will be valuable for the assembly, tuning, trimming, and actual first flight.
- Never allow batteries to run low or you might lose control of the model.
- You should complete a successful pre-run check of your radio equipment and model prior to each run.
- Plastic is very susceptible to damage or deformation due to extreme heat and cold climate. Do not store the model near any source of heat such as over or heater. Store the model indoors, in a climate-controlled, room temperature environment.

Charge the battery pack
Disconnect the battery from the charger when the charging process completed. Do not charge the battery unattended at all time.

Lithium Polymer (LiPo) Battery Warning

- Never charge a lithium polymer battery with a charger designed for NiCd, NiMH, or any other type of battery chemistry. Use ONLY charger designed for LiPo Battery.
- Do not leave LiPo battery unattended during charging.
- Do not overcharge the battery.
- Always place the battery on a heat resistant surface alone when charging.
- Always put the LiPo battery inside a charging protection container while charging.
- Do not allow LiPo cells to overheat at any time. Cells which reach greater than 140 Fahrenheit (60°C) will usually become damaged and will catch fire.
- Do not allow LiPo cells on or near combustible materials including paper, plastic, carpets, vinyl, leather, and wood, inside an R/C model or full size automobile.
- Do not over discharge LiPo; doing so will damage the battery.
- Do not expose LiPo cell to water or moisture at any time.
- Do not store battery near open flame or heater.
- Do not assemble LiPo cells or pre-assembled packs together with other LiPo cells or packs.
- Always store LiPo battery in secure location away from children.
- Always remove the LiPo battery if model is involved in any kind of crash. Carefully inspect the battery and connectors for even the smallest damage. CAUTION: cells may be hot!
- Do not allow the electrolyte to get into eyes or on skin. Wash affected areas immediately if they come into contact with electrolyte. Do not alter or modify connectors or wires of a LiPo battery pack.
- Always inspect the condition of the battery before charging and operation.
- Do not short circuit the LiPo battery.
- Do not have contact with a leaky/damaged battery directly.
- Do not charge battery out of recommended temperature rang (0°C-45°C)