

**BJ4 WORLDS EDITION SET-UP SHEET:**

**DRIVER** Peter Pinisch

**DATE** August 14-19 2006

**TRACK/CITY** RMC Wein - Austria

**EVENT** Euros Championship 2006

**NOTES:**

**2006 Euros Champion.**  
Car was very easy to drive.



**TRACK CONDITIONS:**

SOFT SURFACES:    HARD SURFACES:

SAND / SOIL	WET
LOAMY	HARD SLICK
RUTS	ABRASIVE <input checked="" type="checkbox"/>
WET	BLUE GROOVE <input checked="" type="checkbox"/>
DRY	BLACK GROOVE
	BROKEN

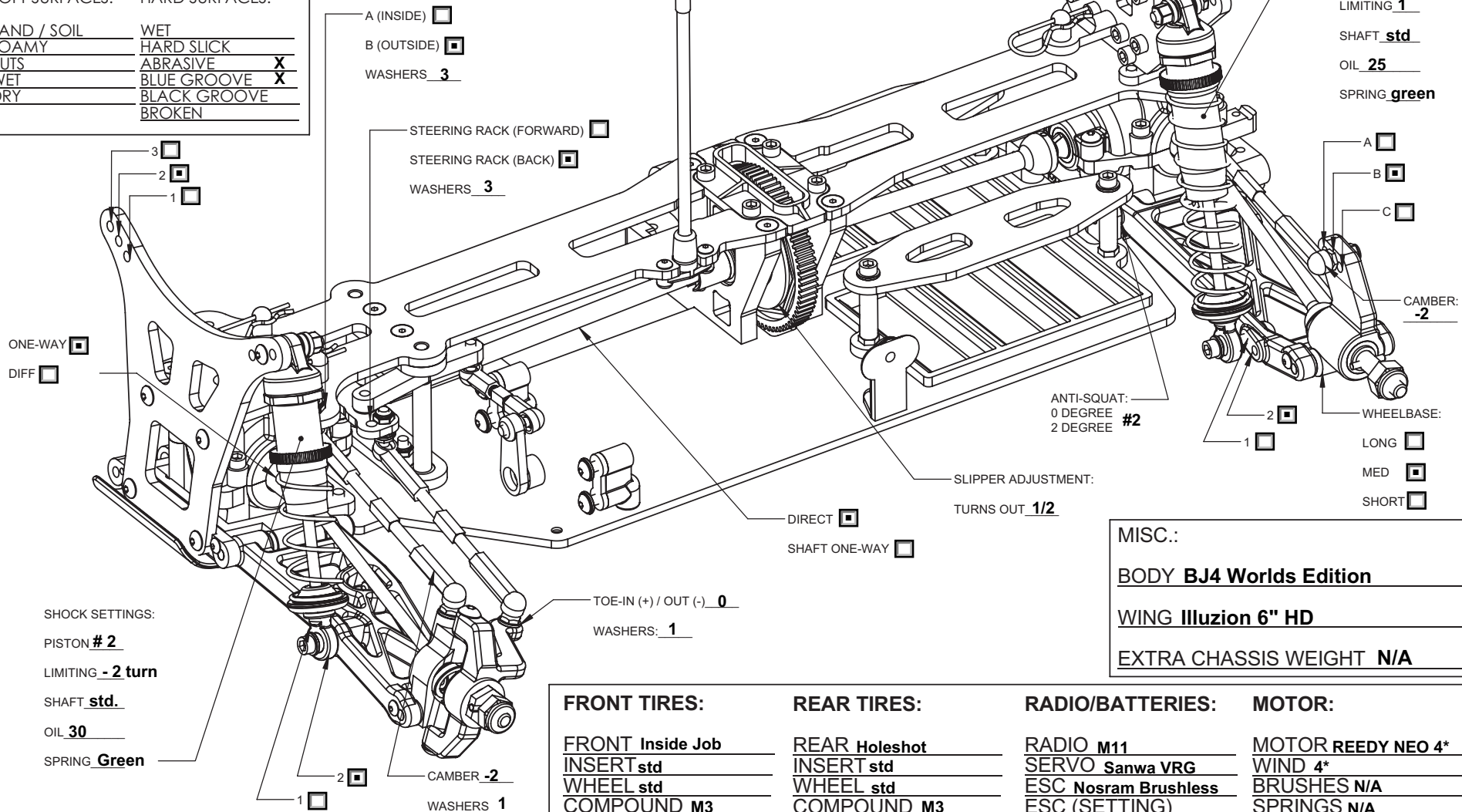

SHOCK SETTINGS:  
PISTON #1  
LIMITING 1  
SHAFT std  
OIL 25  
SPRING green

A   
B   
C   
CAMBER: -2  
WHEELBASE:  
LONG   
MED   
SHORT

ANTI-SQUAT:  
0 DEGREE   
2 DEGREE  #2

SLIPPER ADJUSTMENT:  
TURNS OUT 1/2

DIRECT   
SHAFT ONE-WAY

MISC.:  
**BODY** BJ4 Worlds Edition  
**WING** Illuzion 6" HD  
**EXTRA CHASSIS WEIGHT** N/A

SHOCK SETTINGS:  
PISTON #2  
LIMITING -2 turn  
SHAFT std.  
OIL 30  
SPRING Green

A (INSIDE)   
B (OUTSIDE)   
WASHERS 3  
STEERING RACK (FORWARD)   
STEERING RACK (BACK)   
WASHERS 3

TOE-IN (+) / OUT (-) 0  
WASHERS: 1

**FRONT TIRES:**  
FRONT Inside Job  
INSERT std  
WHEEL std  
COMPOUND M3  
ADDITIVE N/A

**REAR TIRES:**  
REAR Holeshot  
INSERT std  
WHEEL std  
COMPOUND M3  
ADDITIVE N/A

**RADIO/BATTERIES:**  
RADIO M11  
SERVO Sanwa VRG  
ESC Nosram Brushless  
ESC (SETTING)  
BATTERIES REEDY

**MOTOR:**  
MOTOR REEDY NEO 4\*  
WIND 4\*  
BRUSHES N/A  
SPRINGS N/A  
PINON/SPUR 16 x 78