



D815 Tessmann Worlds Edition

Driver Teemu Leino

Date

Track Sacile EC

Event Euro's 2015

Track Condition High grip and bumpy

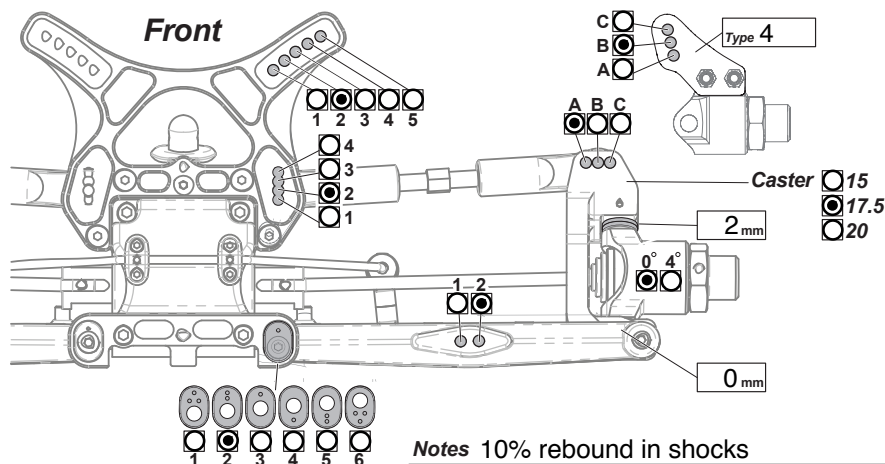

Ride Height	27 mm
Camber Angle	2°
Toe Angle	toe out 2°
Sway Bar	2,4 mm
Shock Length	mm

Front Shocks

Oil weight	35 losi wt
Piston	6x1.3 mm
Bladder	std new type
Spring	yellow

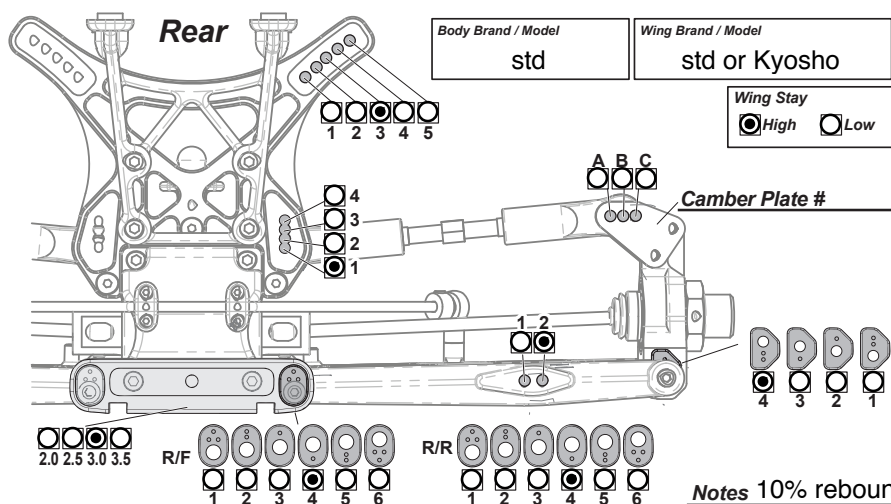

Ride Height	28 mm
Camber Angle	3°
Sway Bar	mm
Shock Length	2,6 mm

Rear Shocks

Oil weight	27,5 losi wt
Piston	6x1.3 mm
Bladder	std new type
Spring	blue

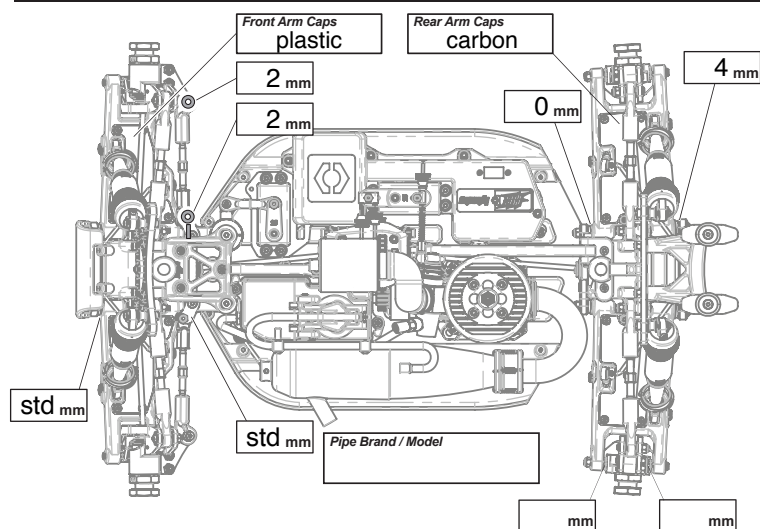

Engine

Brand	Novarossi
Spur gear	Clutch Bell
48/13	
Clutch Shoes	std
Clutch Springs	2x1.1 1x1.0mm
Glow Plug	Nova 5
Glow Fuel	Runnertime

Tires

Brand	Front	Rear
Brand	HB	HB
Compound	RED	RED
Insert	STD	STD
Wheel	HB	HB
Notes		

Diff Oils

	Front	Center	Rear
Brand	mugen	mugen	mugen
Oil Weight / Grade	10k	7k	3k

Notes D8'12 rear hubs, link on upper row outside hole

droop front -2 and rear -8, wing spaced back 5mm between shock towers