

## :: Bag 4 - Step 2

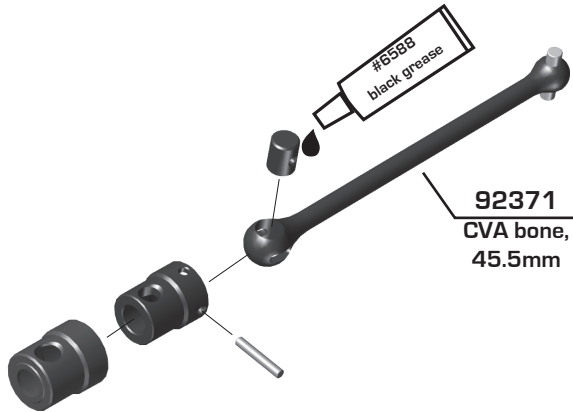

## :: Bag 7 - Step 1

Build x2  
(1 left side, 1 right side)

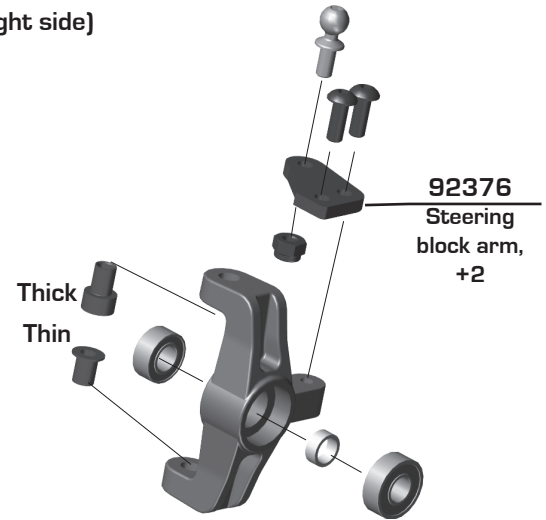

## :: Bag 10 - Step 1

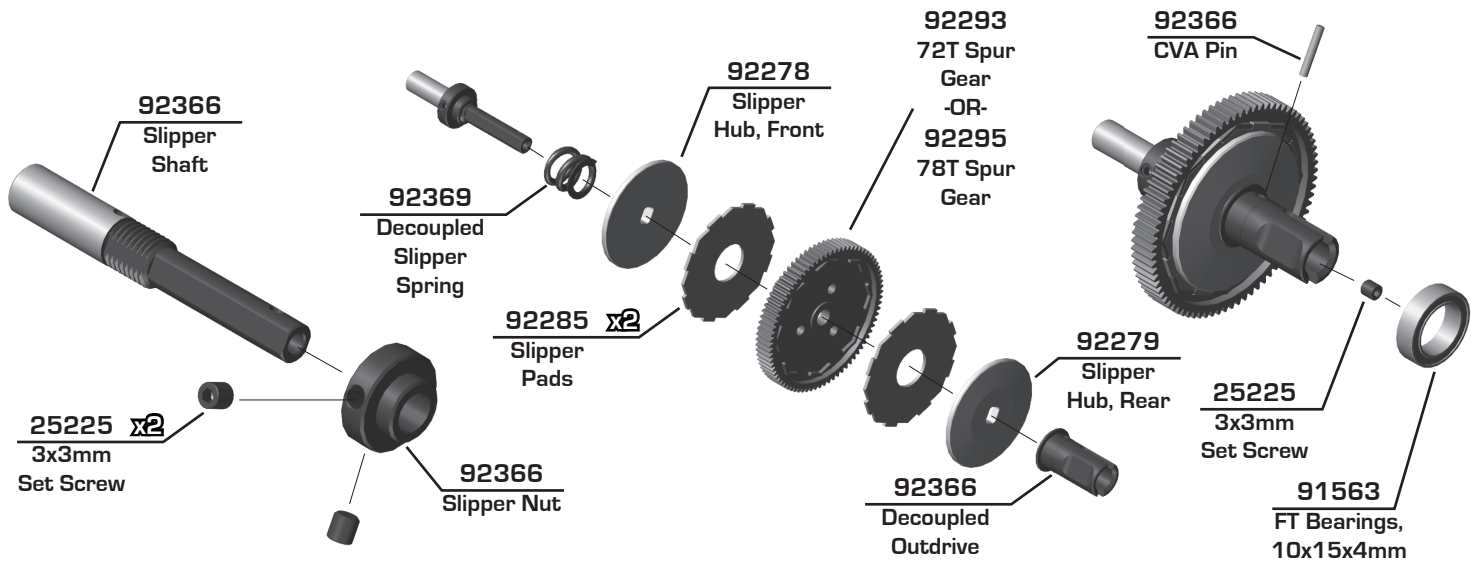

## :: Bag 10 - Step 2

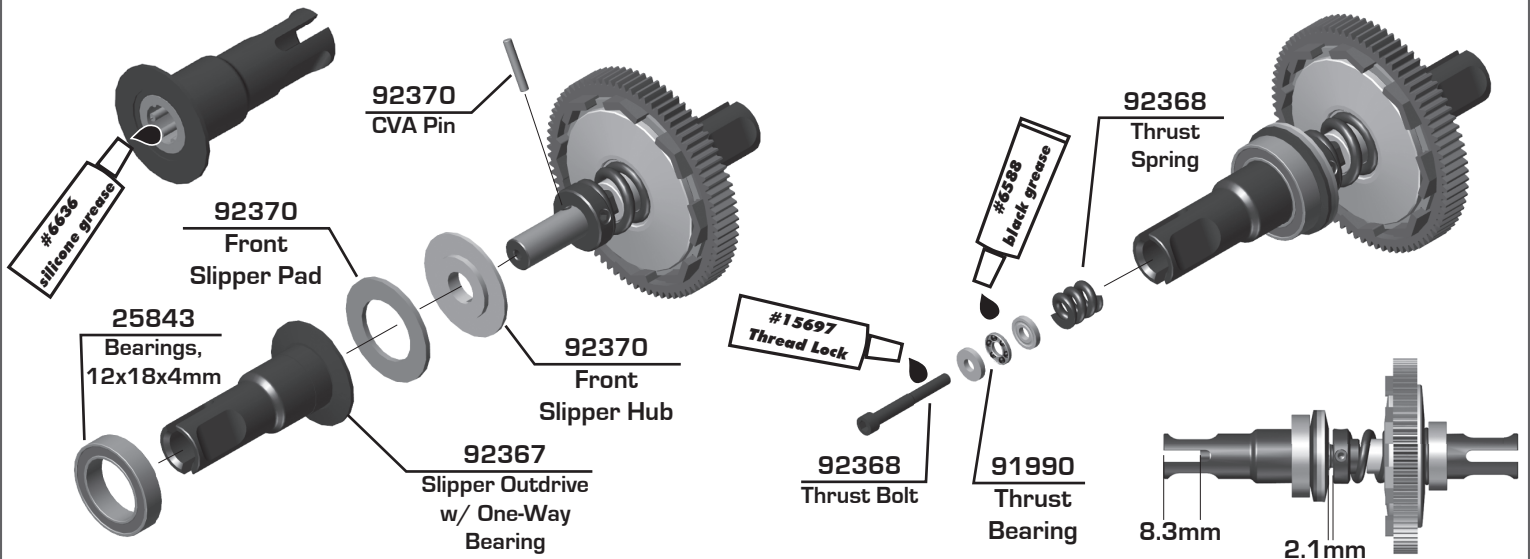

## :: Bag 11 - Step 1

**#1596 thread lock**

**91932 FT 13mm shock piston, 2.5mm (2x1.6)**

Build x2 front shocks

**#1596 thread lock**

**91934 FT 13mm shock piston, 2.5mm (2x1.8)**

Build x2 rear shocks

Mount the shock pistons with the number facing up!

Racers Tip:  
Use a marker over the numbers on the pistons to make them easily visible!

## :: Bag 11 - Step 5

**Racers Tip:**  
Use your finger to rub shock fluid on the O-ring for smoother adjustment!

**91946 13mm Front Spring, Purple (4.60lb)**

Build x2 front shocks

## :: Bag 13 - Step 2/3

**92378 Center Bulkhead Brace**

**92378 Center Bulkhead Brace Spacer**

**92378 Center Bulkhead**

**92377 Servo Mount Brace**

**92377 Servo Mount**

### Front Suspension:

Ride Height:	13mm
Camber:	-1deg
Toe:	1deg
Anti-Roll Bar:	1.8mm
Arm Type:	Gull Wing - Standard
Tower Type:	Gull Wing
Wheelbase Shim:	1mm behind arm
Wheel Hex:	5.0mm
Caster Block:	8° <input type="checkbox"/> 9° <input checked="" type="checkbox"/> 10° <input type="checkbox"/>
Chassis Brace Support:	2mm G10
Top Plate Brace:	None
Front Axles:	CVA <input checked="" type="checkbox"/> DCV <input type="checkbox"/>
Notes:	

1 2

Front Chassis Brace Screws: \_\_\_\_\_ Ball Stud Spacing: 1mm

Arm Mount A: 1°  0.5°   
 Gray  Black

Diff Height: +2  +0

Arm Mount B: 1°  0.5°   
 Gray  Black

Ball Stud Spacing: 2mm

Steering Plate: +2

Ball Stud Spacing: 2mm

3 2 1

3 2 1

6 5 4

74mm

B A

### Rear Suspension:

Ride Height:	13mm
Camber:	-1deg
Anti-Roll Bar:	1.8mm
Arm Type:	Standard
Wheelbase Shim:	2mm in front of arm
Wheel Hex:	6.0mm
Chassis Brace Support:	2mm G10
Hub Spacing:	Fwd <input type="checkbox"/> Mid <input checked="" type="checkbox"/> Back <input type="checkbox"/>
Notes:	

Rear Chassis Brace Screws: \_\_\_\_\_

Arm Mount C: 1°  0.5°   
 Gray  Black

Diff Height: +3  +2  +1  +0

Arm Mount D: 1°  0.5°   
 Gray  Black

Axle Height:  0  3  +3  
 1  2  +2  
 1  2  +1  
 0  3  +0

Camber Link Spacing: 1mm

Ball Stud Spacing: 2mm

3 2 1

3 2 1

65mm

C B A

### Electronics:

Radio:	Servo:
EPA: Throttle: %	Brake: %
ESC:	
ESC Settings:	
Motor / Wind:	Timing:
Pinion:	Spur: 78T
Battery:	
Battery Position:	
Back 1 <input type="checkbox"/> 2 <input type="checkbox"/> 3 <input type="checkbox"/> 4 <input checked="" type="checkbox"/> Forward	
Battery Weight:	

### Differential:

	Front	Center	Rear
Fluid:	15K		15K
Gears:	Metal		Metal
Type:	LTC		LTC
Notes:			
<b>Slipper Clutch:</b>			
Type:	Decoupled Slipper		
# of Pads:	2 Pad		
Setting:	2.1mm		

### Shocks:

	Front	Rear
Piston:	2x1.6	2x1.8
Thickness:	2.5mm	2.5mm
Fluid:	45wt	35wt
Spring:	Purple	Blue
Limiters:	Int: 1 Ext: 2	Int: ___ Ext: ___
Stroke:	22mm	27.5mm
Eyelet Length:	+2	0
Cup Offset:	5mm	0mm
Notes:		

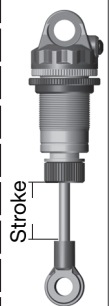

### Track Info:

Size:	Small <input type="checkbox"/> Medium <input type="checkbox"/> Large <input type="checkbox"/> Extra Large <input type="checkbox"/>
Surface:	Dirt <input type="checkbox"/> Carpet <input type="checkbox"/> AstroTurf <input type="checkbox"/> Multi Surface <input type="checkbox"/>
Traction:	Low <input type="checkbox"/> Medium <input type="checkbox"/> High <input type="checkbox"/> Very High <input type="checkbox"/>
Moisture:	Dry <input type="checkbox"/> Damp <input type="checkbox"/> Wet <input type="checkbox"/>
Condition:	Indoor <input type="checkbox"/> Outdoor <input type="checkbox"/> Dusty <input type="checkbox"/> Hard Packed <input type="checkbox"/> Bumpy <input type="checkbox"/> Grooved <input type="checkbox"/> Smooth <input type="checkbox"/> Loamy <input type="checkbox"/>
Temperature:	Ambient: _____ Track: _____
Notes:	
Vehicle Comments:	

### Tires:

Front Tires:	
Front Compound:	
Front Insert:	
Rear Tires:	
Rear Compound:	
Rear Insert:	
Wheel (F/R):	
Notes:	

### Body, Wing, Weight:

Body:	Kit - Lightweight
Front Wing:	Yes <input type="checkbox"/> No <input checked="" type="checkbox"/>
Rear Wing:	Kit
Wing Angle:	0° <input type="checkbox"/> 6° <input checked="" type="checkbox"/>
Wing Mount Height:	0 <input type="checkbox"/> -2 <input checked="" type="checkbox"/>
Servo Weights:	
Electronic Weights:	
Total Vehicle Weight:	