

## Front Suspension:

|                             |  |
|-----------------------------|--|
| <b>Ride Height:</b>         | -17mm  |
| <b>Camber:</b>              | -2.0   |
| <b>Toe:</b>                 | 0  |
| <b>Arm Type:</b>            | Gull-Wing  |
| <b>Tower Type:</b>          | Gull-Wing  |
| <b>Caster Block Insert:</b> | +5   |
| <b>Bulkhead Type:</b>       | Aluminium 10g  |
| <b>Kick-Up Angle:</b>       | 25   |
| <b>Wheel Hex:</b>           | 5.0mm  |
| <b>Notes:</b>               | 1.0mm Bulkhead Shim<br>#91704 B6 Gearbox/Bulkhead Shim Set |

**Anti Roll Bar:**

None

White (0.8mm)

Gray (0.9mm)

Blue (1.0mm)

Other: \_\_\_\_\_

**Bump Steer Spacing:** 0

**Axle Height:**

+3

+2

+1

0

**Ball Stud Spacing:** 0

**Steering Plate:** Kit

**Steering Stop Spacing:** 0

**Ball Stud Spacing:** 1mm

**Caster Block Spacing:** 1mm

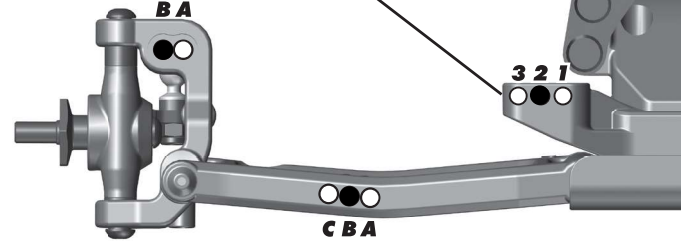
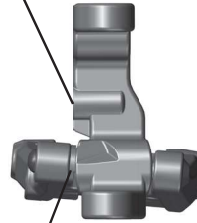
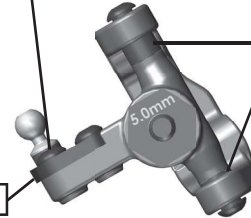

## Rear Suspension:

|                                 |   |
|---------------------------------|---|
| <b>Ride Height:</b>             | -17mm   |
| <b>Camber:</b>                  | -2.0  |
| <b>Wheel Hex:</b>               | 7.0mm   |
| <b>Hub Spacing:</b>             | Forward <input type="checkbox"/> Middle <input checked="" type="checkbox"/> Back <input type="checkbox"/> |
| <b>Shock Mounting Position:</b> | Front of Arm <input checked="" type="checkbox"/> Rear of Arm <input type="checkbox"/>                     |
| <b>Notes:</b>                   | #91704 B6 Gearbox/Bulkhead Shim Set   |

**Anti Roll Bar:**

None

White (1.2mm)

Gray (1.3mm)

Blue (1.4mm)

Other: \_\_\_\_\_

**Rear Hub Link Setting:**

**Up**

E C A

D B

**Down**

D B

E A

**C Mount Inserts:** 1°  0.5°

**D Mount Inserts:** 1°  0.5°

**Hub Insert:**

+3  +2  +1  0

**Ball Stud Spacing:** 0mm

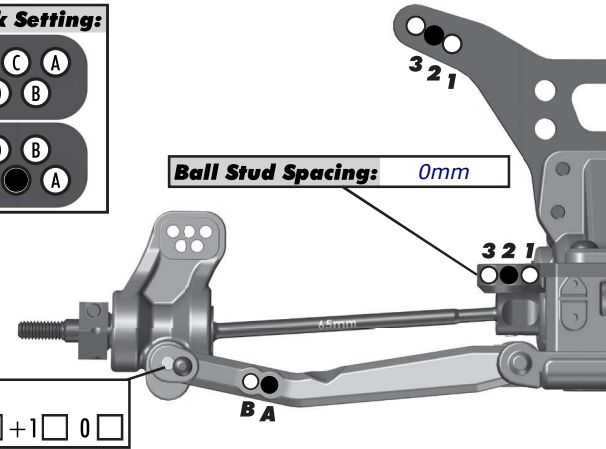
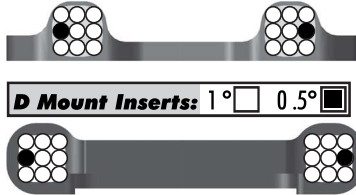

## Electronics:

|  |                             |
|--|-----------------------------|
| <b>Radio:</b> <u>Mt-44</u>                                       | <b>Servo:</b> <u>SRG-BS</u> |
| <b>EPA:</b> Throttle: <u>100</u> % Brake: <u>100</u> %           |                             |
| <b>ESC:</b> <u>Sanwa vortex pro gen 2</u>                        |                             |
| <b>ESC Settings:</b> <u>small amount of punch and drag brake</u> |                             |
| <b>Motor:</b> <u>Reedy</u>                                       |                             |
| <b>Wind:</b> <u>10.5</u>   | <b>Timing:</b> <u>40</u>    |
| <b>Pinion:</b> <u>28</u>   | <b>Spur:</b> <u>78T 48P</u> |
| <b>Battery:</b> <u>Core-RC 4000mah</u>                           |                             |
| <b>Battery Position:</b> <u>5F</u>                               |                             |

## Drivetrains:

|  |   |
|--|---|
| <b>Transmission:</b>                       |   |
| <b>3 Gear:</b> <input type="checkbox"/>    | <b>4 Gear:</b> <input type="checkbox"/>               |
| <b>Stand Up:</b> <input type="checkbox"/>  | <b>Lay Down:</b> <input checked="" type="checkbox"/>  |
| <b>Differential:</b>                       |   |
| <b>Ball Diff:</b> <input type="checkbox"/> | <b>Gear Diff:</b> <input checked="" type="checkbox"/> |
| <b>Notes:</b> <u>4,000 Diff Fluid</u>      |   |
| <b>Slipper Clutch:</b>                     |   |
| <b>Type:</b> <u>Kit</u>                    |   |
| <b># of Pads:</b> <u>2</u>                 |   |

## Shocks:

|                       | Front   | Rear    |
|-----------------------|---------|---------|
| <b>Piston:</b>        | 2 x 1.6 | 2 x 1.7 |
| <b>Fluid:</b>         | 40      | 30      |
| <b>Spring:</b>        | Purple  | Blue    |
| <b>Limiters:</b>      | 2       | 0       |
| <b>Stroke:</b>        | 20.0    | 28.0    |
| <b>Eyelet Length:</b> | Short   | Short   |
| <b>Cup Offset:</b>    | 5mm     | 0mm     |
| <b>Notes:</b>         |         |         |



## Track Info:

|  |
|--|
| <b>Size:</b> Small <input checked="" type="checkbox"/> Medium <input type="checkbox"/> Large <input type="checkbox"/> Extra Large <input type="checkbox"/>   |
| <b>Surface:</b> Dirt <input type="checkbox"/> Carpet <input type="checkbox"/> Astroturf <input checked="" type="checkbox"/> Multi Surface <input type="checkbox"/>   |
| <b>Traction:</b> Low <input type="checkbox"/> Medium <input checked="" type="checkbox"/> High <input type="checkbox"/> Very High <input type="checkbox"/>  |
| <b>Moisture:</b> Dry <input checked="" type="checkbox"/> Damp <input type="checkbox"/> Wet <input type="checkbox"/>  |
| <b>Condition:</b> Indoor <input checked="" type="checkbox"/> Outdoor <input type="checkbox"/> Dusty <input type="checkbox"/> Hard Packed <input type="checkbox"/><br>Bumpy <input type="checkbox"/> Grooved <input type="checkbox"/> Smooth <input checked="" type="checkbox"/> Loamy <input type="checkbox"/> |
| <b>Temperature:</b> Ambient: <u>5c</u> Track: <u>7c</u>  |
| <b>Notes:</b> <u>Cold</u>  |

## Tires:

|  |
|--|
| <b>Front Tires:</b> <u>Cut Stagger - Low Profile</u> |
| <b>Front Compound:</b> <u>Yellow</u>                 |
| <b>Front Insert:</b> <u>None</u>                     |
| <b>Rear Tires:</b> <u>Mini Darts</u>                 |
| <b>Rear Compound:</b> <u>Yellow</u>                  |
| <b>Rear Insert:</b> <u>Yellow</u>                    |
| <b>Wheel (F/R):</b> <u>JC Mono / Schumacher</u>      |
| <b>Notes:</b> <u>Rears are Pre-Mounts</u>            |

## Body, Wing, Weight:

|  |
|--|
| <b>Body:</b> <u>Kit</u>  |
| <b>Wing:</b> <u>Kit</u>  |
| <b>Wing Angle:</b> 0° <input type="checkbox"/> 3° <input type="checkbox"/> 6° <input checked="" type="checkbox"/>                        |
| <b>Servo Weights:</b>  |
| None <input type="checkbox"/> Aluminum <input type="checkbox"/> Steel <input checked="" type="checkbox"/> Other <input type="checkbox"/> |
| <b>Electronic Weights:</b>   |
| None <input checked="" type="checkbox"/> Aluminum <input type="checkbox"/> Steel <input type="checkbox"/> Other <input type="checkbox"/> |
| <b>Total Vehicle Weight:</b>   |

## Vehicle Comments:

**Notes:** \_\_\_\_\_