

Front Suspension:

Reset Forms

Ride Height:	22.5
Camber:	-1
Toe:	0
Arm Type:	gullwing hard
Tower Type:	gull
Caster Block Insert:	5
Bulkhead Type:	aluminum
Kick-Up Angle:	25
Wheel Hex:	kit
Notes:	RCSS complete Car Ceramic Bearings RCSS Titanium screw kit low mount front WIDE wing

Anti Roll Bar:

None

White (0.8mm)

Gray (0.9mm)

Blue (1.0mm)

Other:

Bump Steer Spacing: 1mm

Axle Height:

+3

+2

+1

0

Ball Stud Spacing: 2mm

Steering Plate: +1.5

Steering Stop Spacing: 0

Ball Stud Spacing: 0

Caster Block Spacing: 1

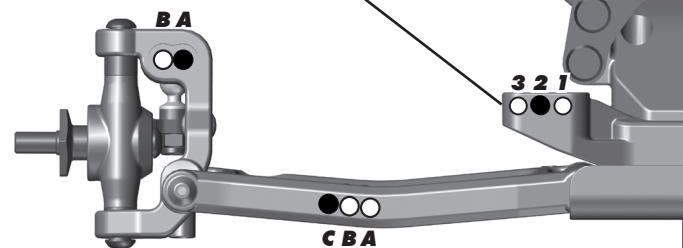
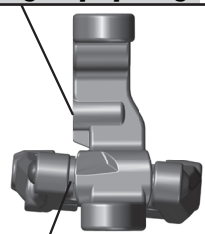
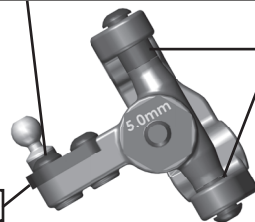

Rear Suspension:

Ride Height:	22.5
Camber:	-1
Wheel Hex:	6 w/TLR offset rear wheel
Hub Spacing:	Forward <input type="checkbox"/> Middle <input checked="" type="checkbox"/> Back <input type="checkbox"/>
Shock Mounting Position:	Front of Arm <input checked="" type="checkbox"/> Rear of Arm <input type="checkbox"/>
Notes:	aluminum rear hubs inside camber link position with 4mm under ballstud 68mm TLR dogbones 20g TC weight under waterfall 3rd hole shock position in arm (Labeled C)

Anti Roll Bar:

None

White (1.2mm)

Gray (1.3mm)

Blue (1.4mm)

Other:

Rear Hub Link Setting:

Up

E C

D B

Down

D B

E C A

C Mount Inserts: 1° 0.5°

D Mount Inserts: 1° 0.5°

Hub Insert:

+3 +2 +1 0

Ball Stud Spacing: 0

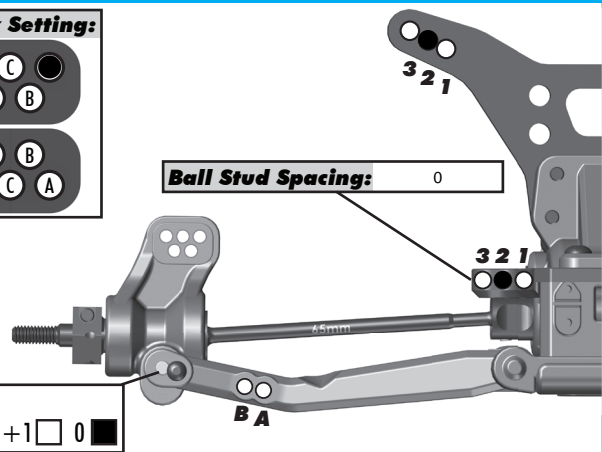
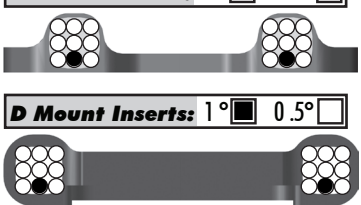

Electronics:

Radio:	4px	Servo:	Low Pro 1408
EPA: Throttle:	100	% Brake:	87.50 %
ESC:	XR10pro Stock		
ESC Settings:	4k throttle		
Motor:	R1 V16 w/RCSS motor kit		
Wind:	17.5	Timing:	55
Pinion:	27	Spur:	75
Battery:	3600 low profile		
Battery Position:	Taped In all the way Forward		

Drivetrains:

Transmission:

3 Gear: **4 Gear:**

Stand Up: **Lay Down:**

Differential:

Ball Diff: **Gear Diff:**

Notes:

Slipper Clutch:

Type: AE milled

of Pads: 2

Shocks:

	Front	Rear
Piston:	3x1.4/1x1.0Tapered up	3x1.4/1x1.0Tapered up
Fluid:	32.5	27.5
Spring:	Yokomo Green	AE Green
Limiters:	0	2 outside body
Stroke:	21.00	28.00
Eyelet Length:	long	long
Cup Offset:	5	0
Notes:	2 uptravel limiters outside rear body on shaft	



Track Info:

Size: Small Medium Large Extra Large

Surface: Dirt Carpet Astroturf Multi Surface

Traction: Low Medium High Very High

Moisture: Dry Damp Wet

Condition: Indoor Outdoor Dusty Hard Packed

Bumpy Grooved Smooth Loamy

Temperature: Ambient: 70 Track: 70

Notes: new layout soft damp grooved

Tires:

Front Tires: Raw Speed stage2 Ghosted pin

Front Compound: Clay

Front Insert: RS

Rear Tires: RS Stage 2 Ghosted pin

Rear Compound: clay

Rear Insert: RS

Wheel (F/R): AE offset/TLR offset

Notes: new tires sanded to near slick

Body, Wing, Weight:

Body: Kit

Wing: RawSpeed precut

Wing Angle: 0° 3° 6°

Servo Weights:

None Aluminum Steel Other

Electronic Weights: carbon esc plate

None Aluminum Steel Other

Total Vehicle Weight: 1505

Vehicle Comments:

Notes: RCSS Cut gears, Hard siderails, titanium shock standoffs, titanium turnbuckles, plastic rear arms, RCSS fan mount with WTF fan @battery voltage, Plastic pinion, MIP lightweight topshaft