

Front Suspension:

Reset Forms

Ride Height:	22mm
Camber:	-1
Toe:	.5
Arm Type:	Flat Hard
Tower Type:	Flat
Caster Block Insert:	5 deg
Bulkhead Type:	Alloy
Kick-Up Angle:	25 deg
Wheel Hex:	kit
Notes:	1mm shims between bulkhead and chassis.

Anti Roll Bar:

None

White (0.8mm)

Gray (0.9mm)

Blue (1.0mm)

Other:

Bump Steer Spacing: 1.5mm

Axle Height:

+3

+2

+1

0

Ball Stud Spacing: 1mm

Steering Plate: +1

Steering Stop Spacing: 0

Ball Stud Spacing: 1.5mm

Caster Block Spacing: 2mm

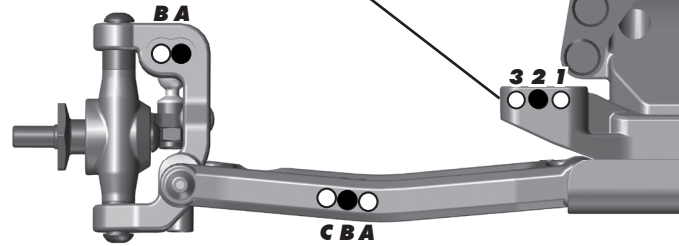
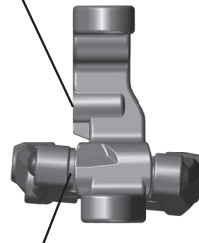
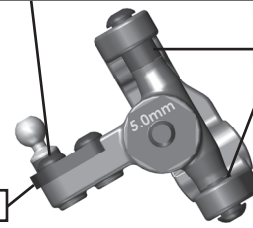

Rear Suspension:

Ride Height:	22
Camber:	-1
Wheel Hex:	Kit 7mm
Hub Spacing:	Forward <input checked="" type="checkbox"/> Middle <input type="checkbox"/> Back <input type="checkbox"/>
Shock Mounting Position:	Front of Arm <input type="checkbox"/> Rear of Arm <input checked="" type="checkbox"/>
Notes:	B5 Alloy Hubs back row inside 3mm washer Brass C 12G, alloy D B5R Hard Rear Arms #91413

Anti Roll Bar:

None

White (1.2mm)

Gray (1.3mm)

Blue (1.4mm)

Other:

Rear Hub Link Setting:

Up

E A

D B

Down

D B

E C A

C Mount Inserts: 1° 0.5°

D Mount Inserts: 1° 0.5°

Hub Insert:

+3 +2 +1 0

Ball Stud Spacing: 2mm

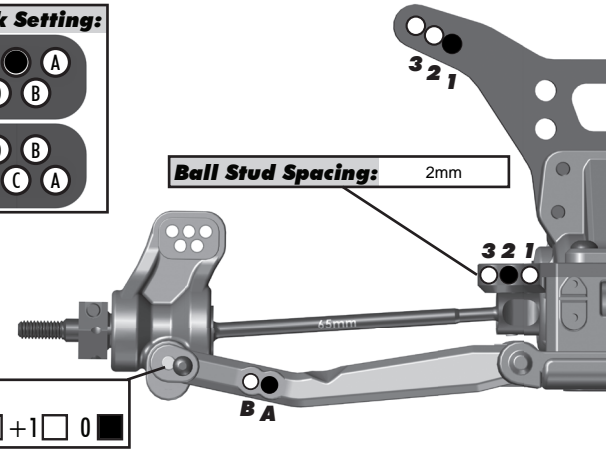
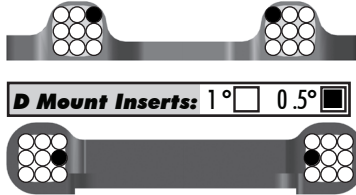

Electronics:

Radio:	Servo: Reedy
EPA: Throttle: 100 %	Brake: 84 %
ESC:	Reedy 510
ESC Settings:	
Motor:	Reedy 7.5
Wind: 7.5	Timing: 30 deg
Pinion: 22	Spur: 78
Battery:	Reedy 5300 Shorty, 56g brass under
Battery Position:	3R

Drivetrains:

Transmission:	3 Gear: <input type="checkbox"/> 4 Gear: <input checked="" type="checkbox"/>
Stand Up: <input checked="" type="checkbox"/>	Lay Down: <input type="checkbox"/>
Differential:	Ball Diff: <input checked="" type="checkbox"/> Gear Diff: <input type="checkbox"/>
Notes:	Tight
Slipper Clutch:	Type: Kit
# of Pads:	2 pad

Shocks:

	Front	Rear
Piston:	1.6	1.7
Fluid:	32.5	30
Spring:	green	black
Limiters:	2	0
Stroke:	20.5	28.0
Eyelet Length:	short	long
Cup Offset:	std	std
Notes:	X-rings	



Track Info:

Size:	Small <input type="checkbox"/> Medium <input checked="" type="checkbox"/> Large <input checked="" type="checkbox"/> Extra Large <input type="checkbox"/>
Surface:	Dirt <input checked="" type="checkbox"/> Carpet <input type="checkbox"/> Astroturf <input type="checkbox"/> Multi Surface <input type="checkbox"/>
Traction:	Low <input checked="" type="checkbox"/> Medium <input checked="" type="checkbox"/> High <input type="checkbox"/> Very High <input type="checkbox"/>
Moisture:	Dry <input checked="" type="checkbox"/> Damp <input checked="" type="checkbox"/> Wet <input type="checkbox"/>
Condition:	Indoor <input type="checkbox"/> Outdoor <input checked="" type="checkbox"/> Dusty <input checked="" type="checkbox"/> Hard Packed <input checked="" type="checkbox"/>
	Bumpy <input checked="" type="checkbox"/> Grooved <input checked="" type="checkbox"/> Smooth <input type="checkbox"/> Loamy <input type="checkbox"/>
Temperature: Ambient: 31	Track: 40
Notes:	

Tires:

Front Tires:	Dirt Webs
Front Compound:	Blue
Front Insert:	Closed cell
Rear Tires:	Control 3D's
Rear Compound:	Blue
Rear Insert:	Foam STD
Wheel (F/R):	JC Mono
Notes:	Punched closed cell inserts

Body, Wing, Weight:

Body:	S2
Wing:	JC
Wing Angle:	0° <input type="checkbox"/> 3° <input checked="" type="checkbox"/> 6° <input type="checkbox"/>
Servo Weights:	None <input checked="" type="checkbox"/> Aluminum <input type="checkbox"/> Steel <input type="checkbox"/> Other <input type="checkbox"/>
Electronic Weights:	None <input type="checkbox"/> Aluminum <input checked="" type="checkbox"/> Steel <input type="checkbox"/> Other <input type="checkbox"/>
Total Vehicle Weight:	1570

Vehicle Comments:

Notes: Very stable starting setup, reduce anti squat for better braking in high speed sweeper