

Front Suspension

Ride Height: _____
Camber: _____
Toe: _____
Anti-Roll Bar: _____
Arm Type: _____
Tower Type: _____
Caster Block Insert: _____
Steering Block: _____
Bulkhead Type: _____
Kick-Up Angle: _____
Wheel Hex: _____

Notes

Bump Steer Spacing: _____
Steering Plate: _____
Steering Stud Spacing: _____
Axle Height:
+3 ☐
+2 ☐
+1 ☐
0 ☐
SCH1256 ☐
Caster Block Spacing: _____

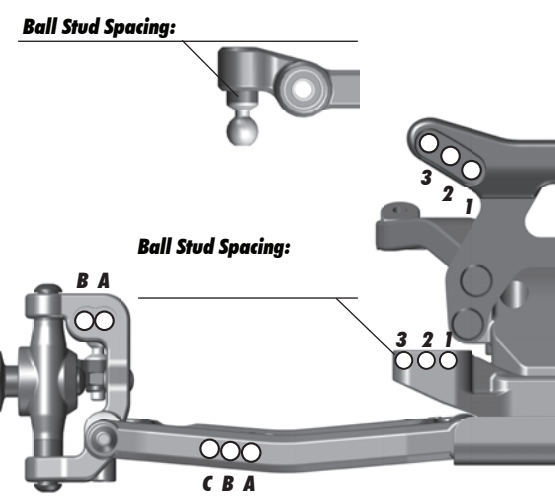

Rear Suspension

Ride Height: _____
Camber: _____
Tower Type: _____
Wheel Hex: _____
CVA Bone Length: _____
CVA Pin Location: _____
Anti-Roll Bar: _____
Arm & Position
73 ☐ 75 ☐ Forward ☐ Back ☐
Hub Spacing:
Forward ☐ Middle ☐ Back ☐
Shock Mounting Position:
Front of Arm ☐ Rear of Arm ☐

Notes

C Mount: Aluminum ☐ Brass ☐
D Mount: Aluminum ☐ Brass ☐

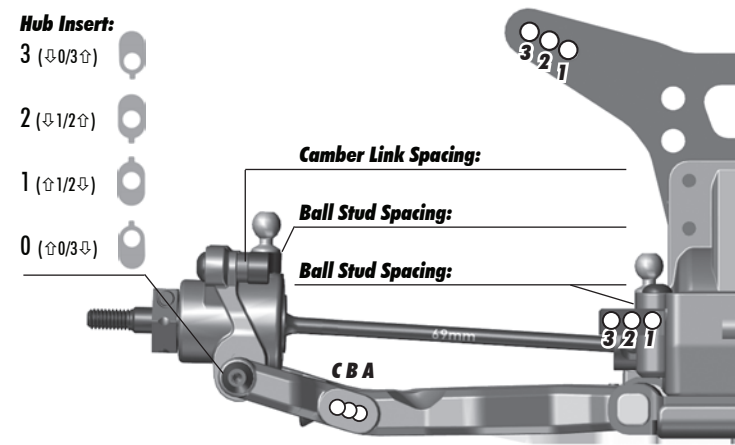

Radio: _____ Servo: _____
EPA: Throttle: _____ % Brake: _____ %
ESC: _____
ESC Settings: _____
Motor: _____ Timing: _____
Pinion: _____ Spur: _____
Battery: _____ Battery Weight: _____
Battery Position: _____

Notes

Transmission ☐ Laydown ☐ Layback ☐ Stand-Up
☐ 3 Gear ☐ 4 Gear
Differential Height: _____
☐ Ball Diff: _____
☐ Gear Diff: _____
Slipper Type: _____
of Pads: _____

Shocks

	Front	Rear
Piston:		
Fluid:		
Spring:		
Int. Limiter:		
Ext. Limiter:		
Stroke:		
Eyelet Length:		
Cup Offset:		
Notes:		



Size: Small ☐ Medium ☐ Large ☐ Extra Large ☐
Surface: Dirt ☐ Carpet ☐ Astroturf ☐ Multi Surface ☐
Traction: Low ☐ Medium ☐ High ☐ Very High ☐
Moisture: Dry ☐ Damp ☐ Wet ☐
Condition: Indoor ☐ Outdoor ☐ Dusty ☐ Hard Packed ☐
Bumpy ☐ Grooved ☐ Smooth ☐ Loamy ☐
Temperature: Ambient: _____ Humidity: _____

Notes

Front Tires: _____
Front Compound: _____
Front Insert: _____
Rear Tires: _____
Rear Compound: _____
Rear Insert: _____
Wheel (F/R): _____

Notes

Body: _____
Wing: _____
Wing Angle: 0° ☐ 3° ☐ 6° ☐
Front Wing: _____
Chassis Length: _____
Servo Weights: _____
Electronic Weights: _____
Total Vehicle Weight: _____

Track Info, Tires & Aero Electronics, Drivetrain & Shocks Comments

Notes