

Front Suspension:

Reset Forms

Ride Height:	18 mm
Camber:	-1 (Tierod Gap = 27.5 mm)
Toe:	+1/2 (Tierod Gap = 27.9 mm)
Arm Type:	#91674 Gullwing, Hard
Tower Type:	#91768 Gullwing
Caster Block Insert:	5°
Steering Block:	4
Bulkhead Type:	#91659 Brass
Kick-Up Angle:	25°
Wheel Hex:	#91682 Aluminum
Notes:	#1366 FT Aluminum Servo Horn, 25T #91667 Plastic Steering Rack #91668 Aluminum Steering Bellcranks

Anti Roll Bar:

White (0.8mm)
 Gray (0.9mm)
 Blue (1.0mm)
 Other:

Bump Steer Spacing: 0.5 mm

Axle Height:

+3
 +2
 +1
 0

Ball Stud Spacing: 0 mm

Steering Plate: #91680 +1

Steering Stop Spacing: 0 mm

Ball Stud Spacing: 1.5 mm

Caster Block Spacing: 1 mm

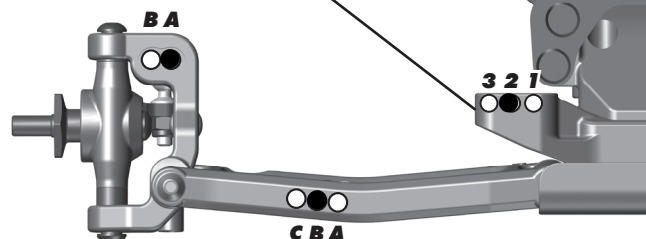
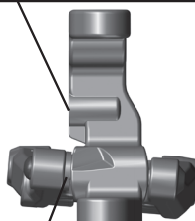
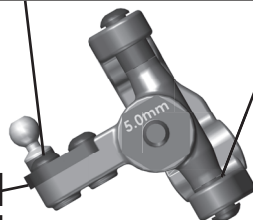

Rear Suspension:

Ride Height:	18 mm
Camber:	-1° (Tierod Gap = 27.6 mm)
Tower Type:	#91769 Standard
Wheel Hex:	#71034 FT 6.0 mm
CVA Bone Length:	#91434 67 mm
CVA Pin Location:	Towards Hex
Hub Spacing:	Forward <input type="checkbox"/> Middle <input type="checkbox"/> Back <input checked="" type="checkbox"/>
Shock Mounting Position:	Front of Arm <input checked="" type="checkbox"/> Rear of Arm <input type="checkbox"/>
Notes:	

Anti Roll Bar:

White (1.2mm)
 Gray (1.3mm)
 Blue (1.4mm)
 Other:

Rear Hub Link Setting:

Plastic Hub Aluminum Hub Ball Stud Spacing: _____

Up: Down:

C Mount Inserts: 1° 0.5°
 Aluminum Brass

D Mount Inserts: 1° 0.5°
 Aluminum Brass

Hub Insert:

+3 +2 +1 0

Ball Stud Spacing: 5 mm

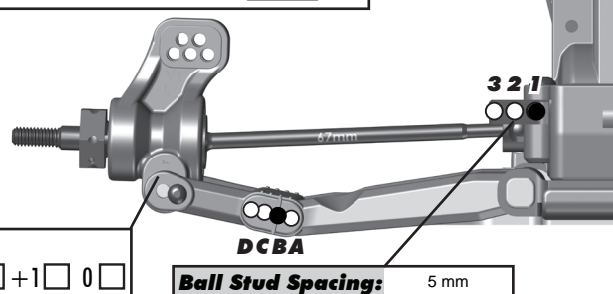

Electronics:

Radio:	Sanwa M12S	Servo:	#27109 Reedy RT1408
EPA: Throttle:	100 %	Brake:	100 %
ESC:	#27004 Reedy Blackbox 510R		
ESC Settings:	See Setup Sheet		
Motor:	Reedy M3 (#275 12.5mm Mod Rotor)		
Wind:	6.5	Timing:	18°
Pinion:	22	Spur:	78
Battery:	#27310 Reedy Zapper 3600 100C LP - Charge To 8.20v		
Battery Position:	5F		

Drivetrains:

Transmission:	Laydown:	<input checked="" type="checkbox"/>
3 Gear:	Layback:	<input type="checkbox"/>
4 Gear:	Stand Up:	<input type="checkbox"/>
Differential:	Ball Diff:	<input type="checkbox"/>
Height:	Gear Diff:	<input checked="" type="checkbox"/>
Notes:	5,000 - 2 Gear	

Slipper Clutch:

Type:	Team Associated HTC
# of Pads:	3 x #91197 LCF

Shocks:

	Front	Rear
Piston:	2 x 1.6 Flat Machined	2 x 1.9 Flat Machined
Fluid:	37.5 wt	35 wt
Spring:	#91835 V2 Red	#91840 V2 Blue
Limiters:	1	0
Stroke:	22.0 mm	28.0 mm
Eyelet Length:	Short	Long
Cup Offset:	5 mm	0 mm
Notes:	#91494 Machined Shock Spacers V2	

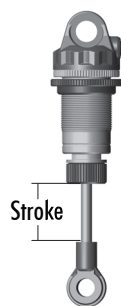

Track Info:

Size:	Small <input checked="" type="checkbox"/> Medium <input checked="" type="checkbox"/> Large <input type="checkbox"/> Extra Large <input type="checkbox"/>		
Surface:	Dirt <input type="checkbox"/> Carpet <input checked="" type="checkbox"/> Astroturf <input type="checkbox"/> Multi Surface <input type="checkbox"/>		
Traction:	Low <input type="checkbox"/> Medium <input type="checkbox"/> High <input checked="" type="checkbox"/> Very High <input checked="" type="checkbox"/>		
Moisture:	Dry <input checked="" type="checkbox"/> Damp <input type="checkbox"/> Wet <input type="checkbox"/>		
Condition:	Indoor <input checked="" type="checkbox"/> Outdoor <input type="checkbox"/> Dusty <input type="checkbox"/> Hard Packed <input type="checkbox"/> Bumpy <input type="checkbox"/> Grooved <input type="checkbox"/> Smooth <input checked="" type="checkbox"/> Loamy <input type="checkbox"/>		
Temperature: Ambient:	60F	Track:	60F
Notes:	Home Depot Carpet		

Tires:

Front Tires:	JConcepts Swaggers
Front Compound:	Double Pink
Front Insert:	None
Rear Tires:	JConcepts Pin Downs
Rear Compound:	Double Pink
Rear Insert:	JConcepts Open Cell
Wheel (F/R):	Team Associated
Notes:	Outer Row Of Rear Spikes Removed / 3 Rows Outside

Body, Wing, Weight:

Body:	#91828 Team Associated Kit, Lightweight
Wing:	JC Lower Front Wing / #91741 B6 Wing
Wing Angle:	0° <input type="checkbox"/> 3° <input type="checkbox"/> 6° <input checked="" type="checkbox"/>
Servo Weights:	None <input type="checkbox"/> Aluminum <input type="checkbox"/> Steel <input checked="" type="checkbox"/> Other <input type="checkbox"/>
Electronic Weights:	None <input type="checkbox"/> Aluminum <input type="checkbox"/> Steel <input checked="" type="checkbox"/> Other <input type="checkbox"/>
Total Vehicle Weight:	1555g

Vehicle Comments:

Notes: #91755 Ti Screw Kit (only used above chassis); #91653 Side Rails, Hard; #91697 & 91620 Chrome Shock Shafts; #91576 & 91577 Fox Shock Bodies; #27304 Reedy Battery Weight (34 g)