

SET-UP SHEET

XRAY X12'15

RACE	International Indoor Champs	
TRACK	IIC	

NAME	CraigX	
CITY / COUNTRY	Las Vegas, NV	USA
CONTACT	craigxavier@hotmail.com	

DATE	21/10/2014	
TEMPERATURE / °F or °C	AIR	TRACK

QUALIFYING POSITION	BEST LAPTIME / sec	FINAL POSITION	RACE LENGTH / minutes
2	11.1	1	8

TRACK CONDITION	<input checked="" type="checkbox"/> CARPET	<input type="checkbox"/> ASPHALT
	<input type="checkbox"/> TECHNICAL	<input checked="" type="checkbox"/> MIXED
		<input type="checkbox"/> FAST

TRACTION		
<input type="checkbox"/> LOW	<input type="checkbox"/> MEDIUM	<input checked="" type="checkbox"/> HIGH

CENTER SHOCK ABSORBER			
SPRING	Gold	OIL / cSt	400
		REBOUND %	25

SIDE LINKAGES	<input checked="" type="checkbox"/>	OIL / cSt	15K Kyosho
SIDE SHOCK	<input type="checkbox"/>	OIL / cSt	

FRONT		TIRES	REAR	
Ulti JH			Ulti XM	
39.75	DIAMETER/mm		41.25	
SXT	ADDITIVE		SXT	
10 min	ADDITIVE timing		10 min	



TRANSMISSION			
DIFF SETTING			
<input type="checkbox"/> LOOSE	<input type="checkbox"/>	<input type="checkbox"/> MEDIUM	<input checked="" type="checkbox"/> TIGHT

PINION / T	57	SPUR GEAR/T	75
FINAL DRIVE RATIO	1.3158	ROLLOUT	98.438

ELECTRONICS	
MOTOR	EA Actinium
SPEEDO	ORCA VX1
BATTERIES	EA Motorsports

BODY	Protoform Strakka
-------------	-------------------

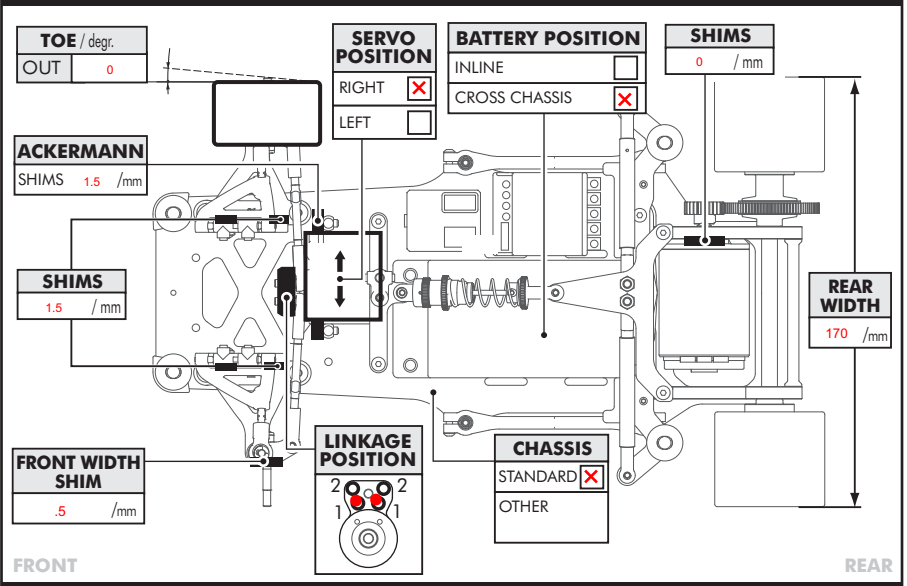
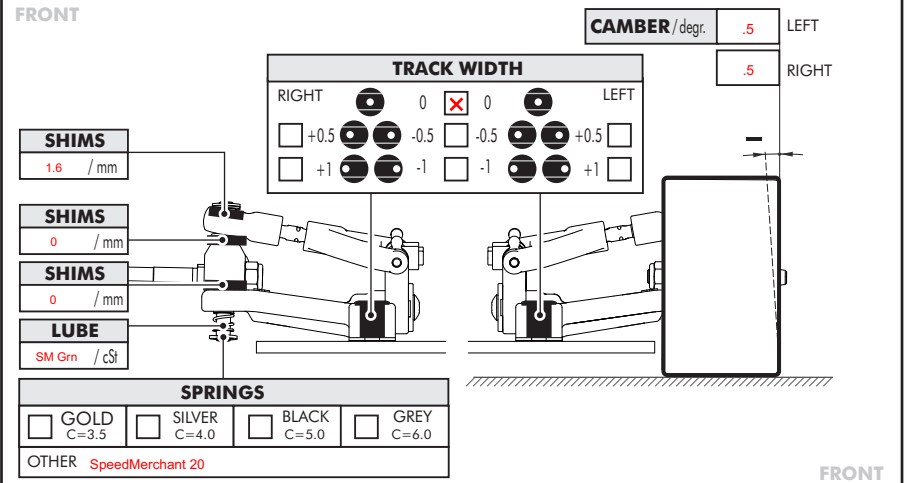
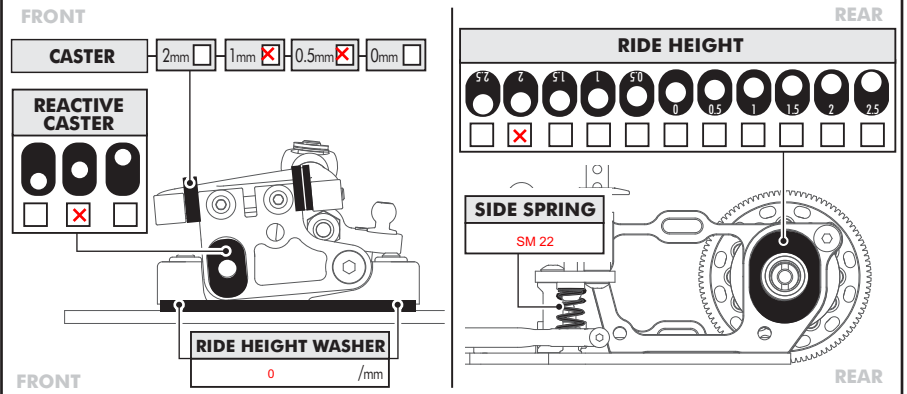
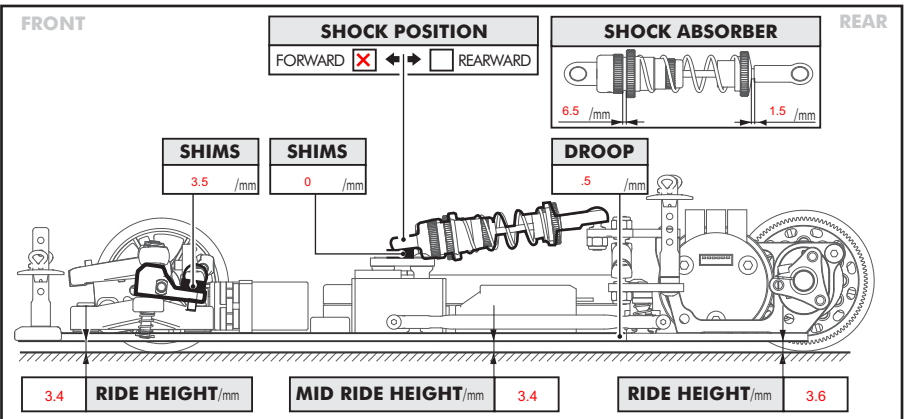

COMMENTS Shock shimmed 5mm up at mounting point on motor pod
 Optional graphite front arms and uprights
 Damper tubes shimmed 1.5mm up on outside mounting points
 Lexan wheel stiffeners used on rear Ulti wheels