

EXECUTE

1/10 SPORT TOURING CAR

XQ2S

INSTRUCTION MANUAL

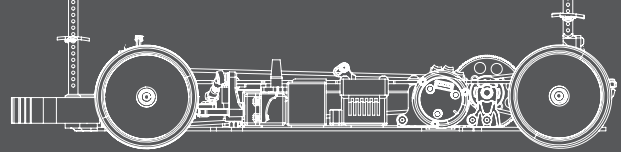

Bag A,F , HW A,B

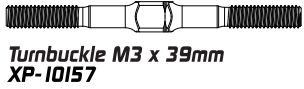

Turnbuckle M3 x 39mm
XP-10157



Turnbuckle M3 x 29mm
XP-10156



Turnbuckle M3 x 18mm
XP-10157

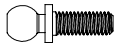

4.8mm Ball End 8mm Thread
XP-10150

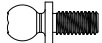

4.8mm Ball End 6mm Thread
XP-10149

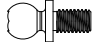

4.8mm Ball End 5mm Thread
XP-10148

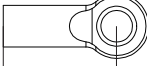

4.8mm Flat Type Ball End 15mm
XP-10251 Optional XP-10636

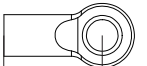

4.8mm Flat Type Ball End 13mm
XP-10252 Optional XP-10635

Use the multi-tool to
measure length links

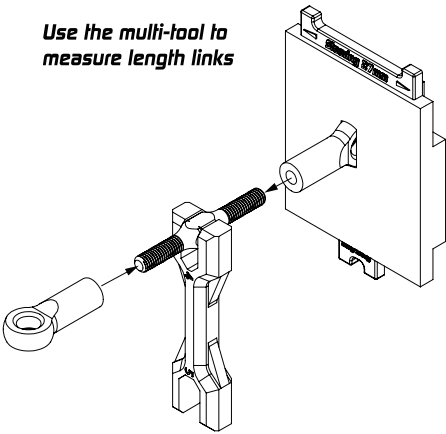

Turnbuckle Wrench From Bag I

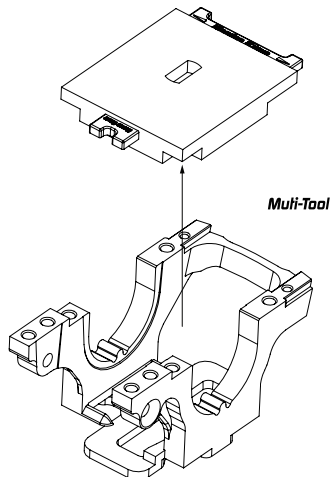

2X For Rear Camber Link

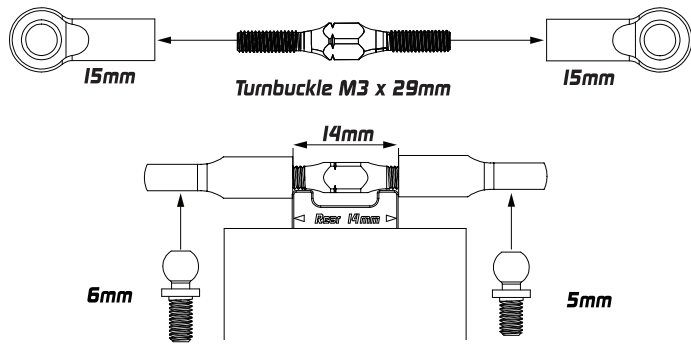

2X For Front Camber Link

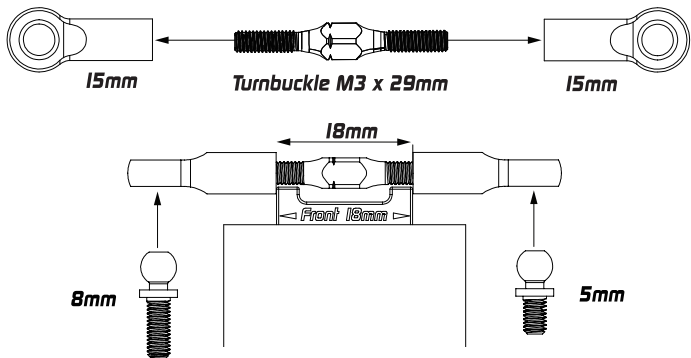

2X For Steering

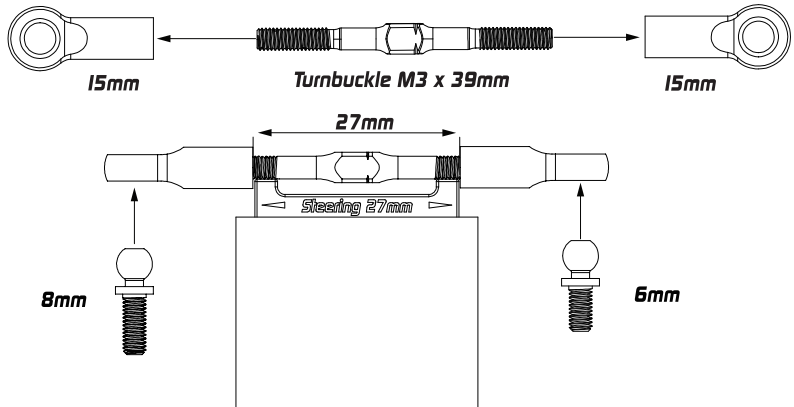

1X For Servo

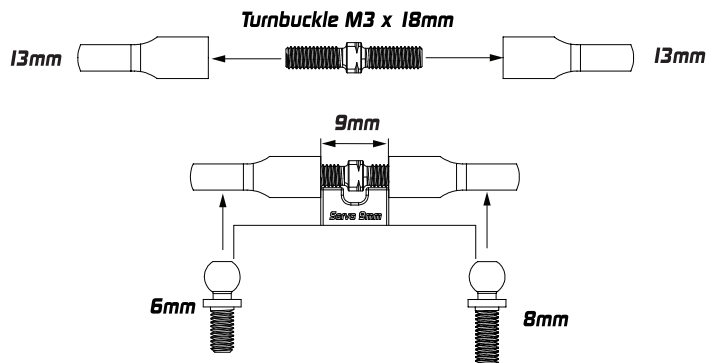

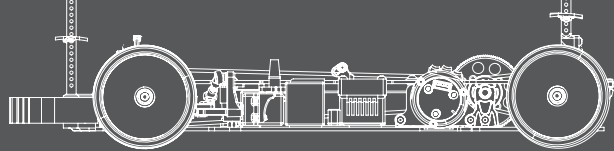

Bag B , Bag C , HW H and HW J

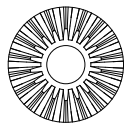

Bevel Gears 18T
XP-10009



Bevel Gears 10T
XP-10009

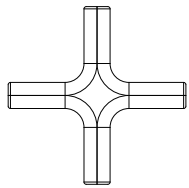

Gear Diff Cross Pin
XP-10009

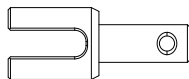

Steel Gear Diff Outdrive Adaptor
XP-10288
Optional XP-10125

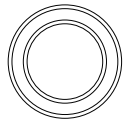

Bearing 10 x 15 x 4mm
XP-40065



O-ring 5 x 2mm
XP-10184



Pin 2 x 9.8mm
XP-40069

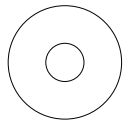

Spacer 5 x 15 x 0.4mm
XP-10181



Spacer 3.6 x 9.5 x 0.2mm
XP-10182



Flat Head Screw M2.5 x 8mm
XP-40044

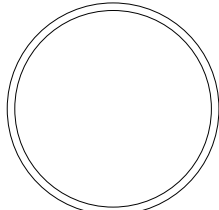

O-ring 25 x 1mm
XP-10183

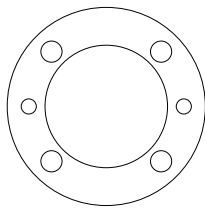

Diff Gasket
XP-10179

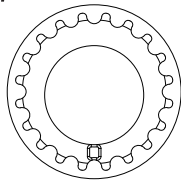

Composite Adjustment
Ball-Bearing Hub
XP-10107

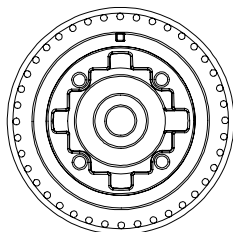

Gear Differential Case
XP-10008

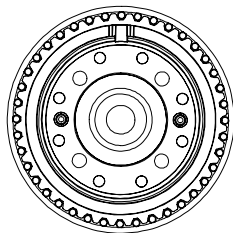

Gear Differential Cover
XP-10008

Optional



Silicone Gear Differential X-RING 5x2mm
XP-10600

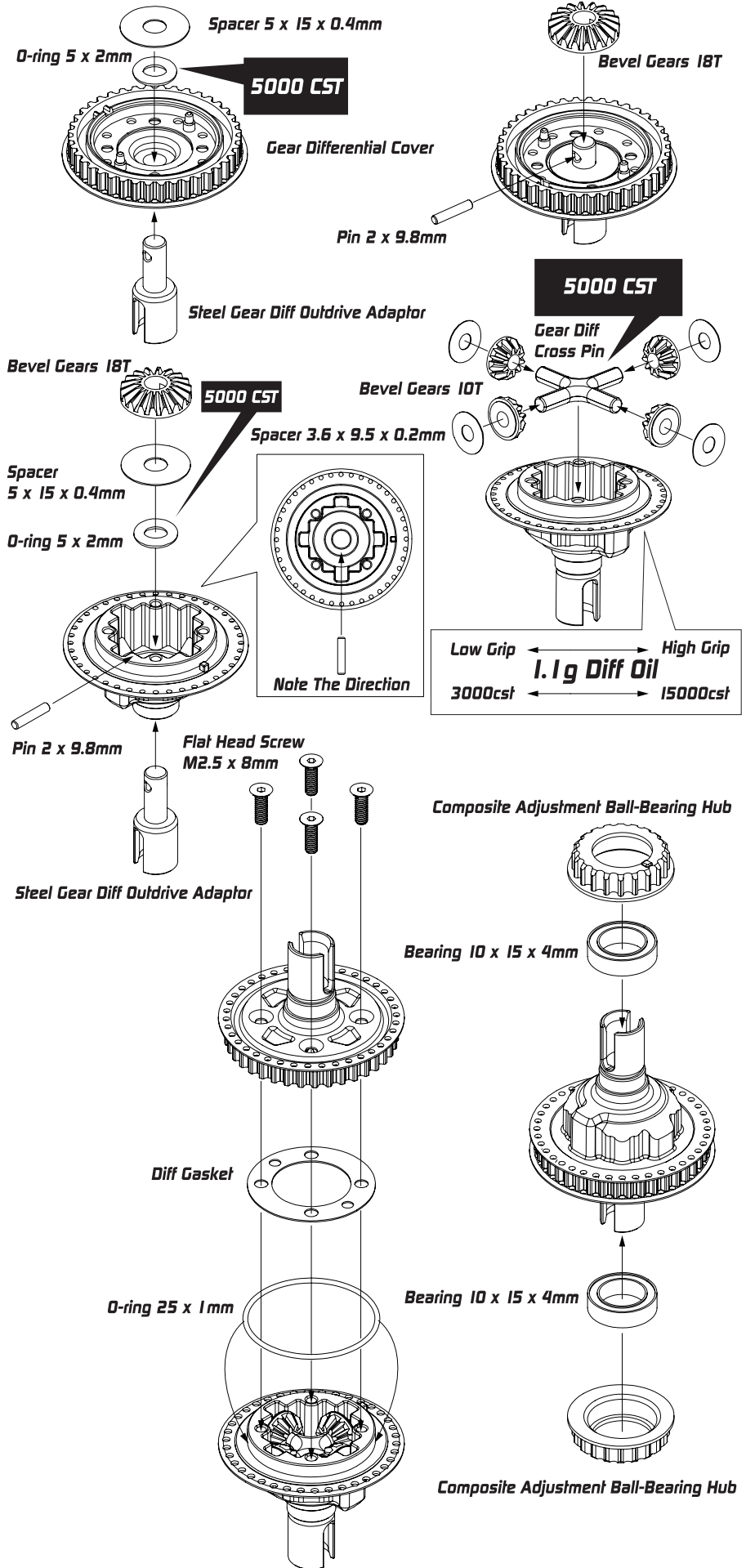

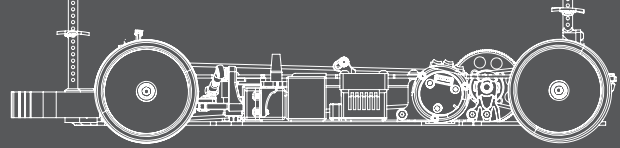

Bag C , HW H and HW K

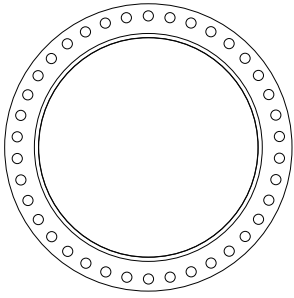
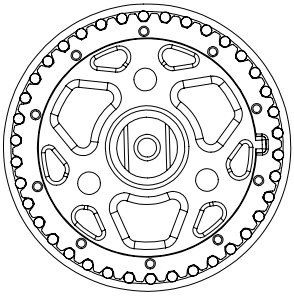

**Composite 38T Spool Set
XP-10264**

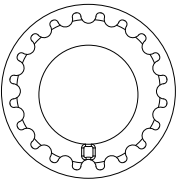

**Composite Adjustment Ball-Bearing Hub
XP-10107**

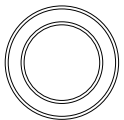

**Bearing 10 x 15 x 4mm
XP-40065**

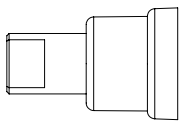

**Composite Axle Driveshaft Adaptors Set
XP-10264
Optional XP-10556**



**Round Head Screw M3 x 12mm
XP-40040**

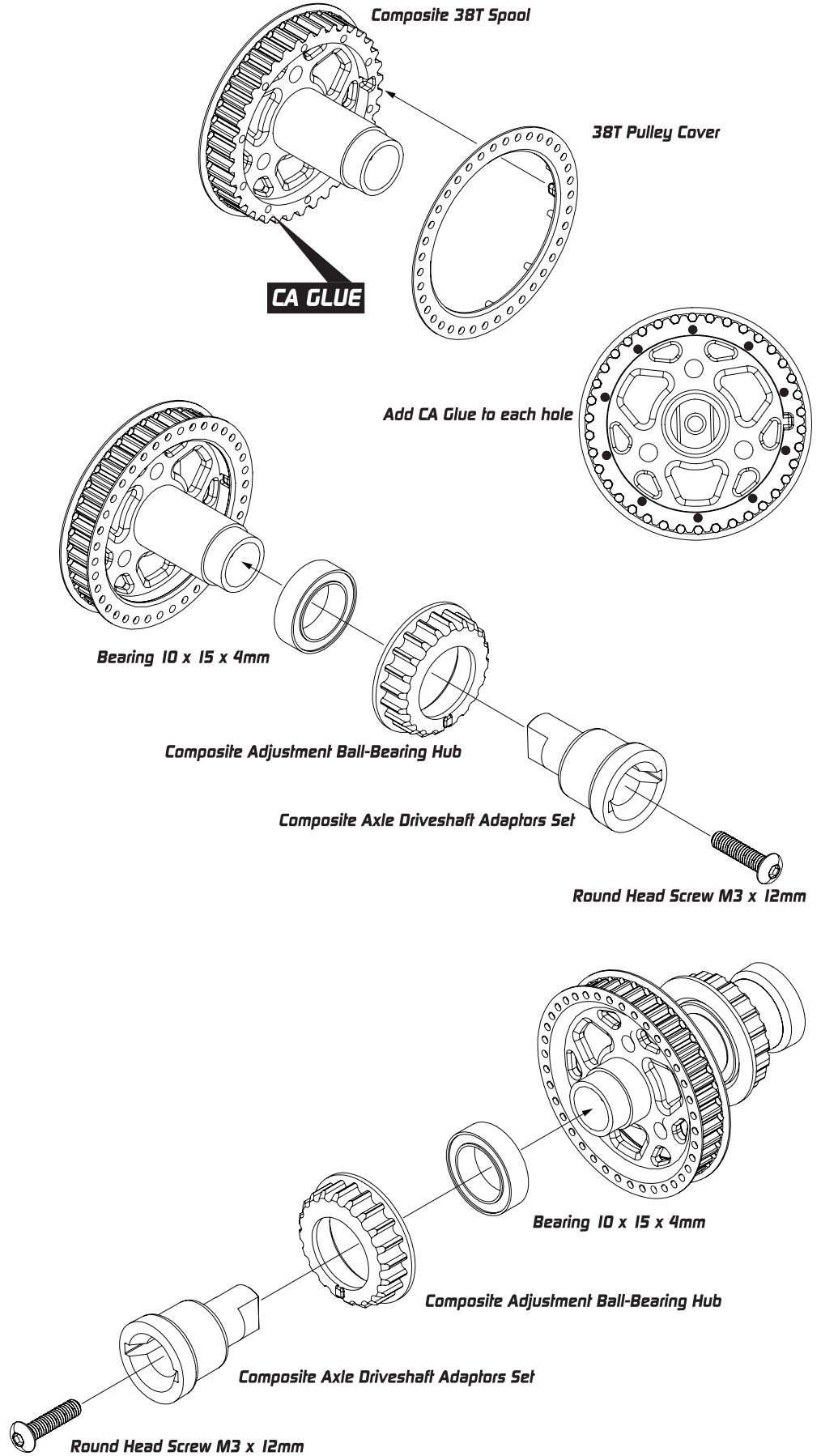

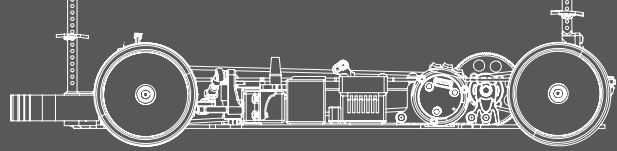

Bag D

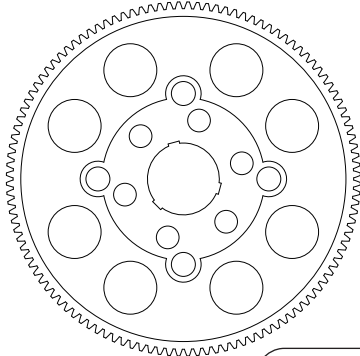

Spur Gear 64P 116T
XP-10053

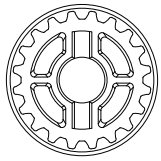

20T Center Pulley
XP-10134

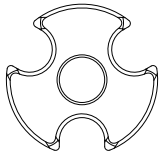

Center Pulley Cover
XP-10134

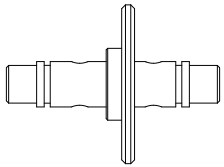

XQ1-5 Aluminium Solid Layshaft
XP-10284



Round Head Screw M3 x 4mm
XP-40036

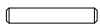

Pin 2 x 12mm
XP-40070



M5 E-Clip
XP-40058

64P Spur Gear

- OP** High Composite Spur Gear 64P 94T
XP-40122
- OP** High Composite Spur Gear 64P 96T
XP-40082
- OP** High Composite Spur Gear 64P 98T
XP-40081
- OP** High Composite Spur Gear 64P 100T
XP-40121
- OP** High Composite Spur Gear 64P 110T
XP-40083
- OP** High Composite Spur Gear 64P 112T
XP-40084
- OP** High Composite Spur Gear 64P 114T
XP-40085

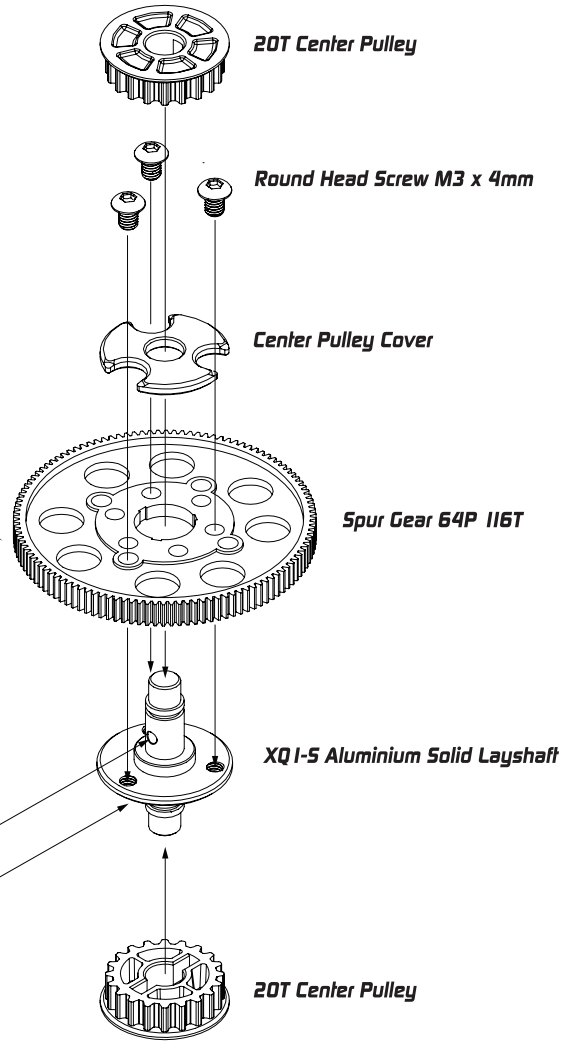

Pin 2 x 12mm

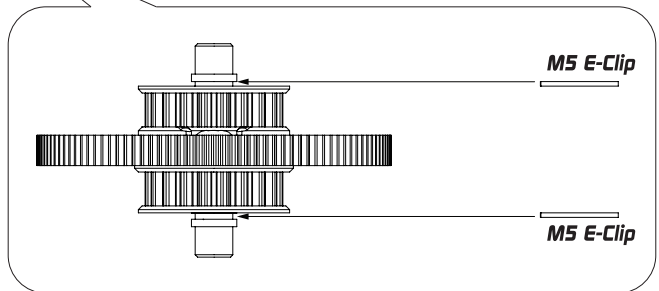
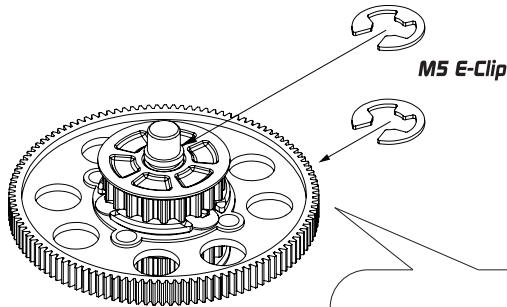

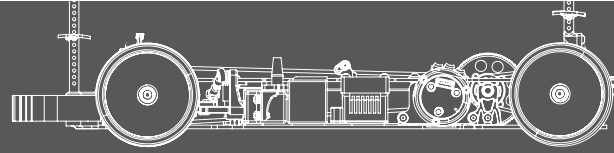

Bag F, G, K, L, N, FRP, HW H and HW K

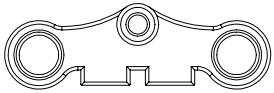

Option: XP-10113

Composite Steering Plate For Dual Servo Saver
XP-10261

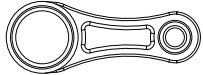

Option: XP-10111

Composite Dual Servo Saver Arm
XP-10261



Bearing 5 x 8 x 2.5mm
XP-40061



Bearing 3 x 6 x 2.5mm
XP-40060



Round Head Screw M3 x 8mm
XP-40038



Round Head Screw M3 x 6mm
XP-40037

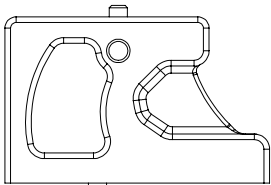

Composite Servo Mount
XP-10261 Optional XP-10136

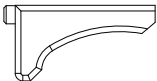

Composite Servo Side Mount
XP-10261
Optional XP-10136

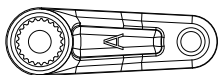

Servo Horn 23T for Sanwa, KO
XP-10163

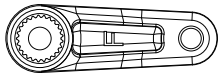

Servo Horn 25T for Futaba
XP-10163



3 x 5.5 x 1 mm Composite Spacer
XP-10740
Optional XP-10119, XP-10240

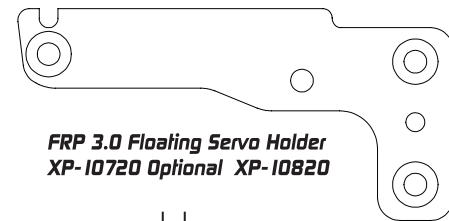

FRP 3.0 Floating Servo Holder
XP-10720 Optional XP-10820

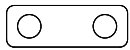

Servo Spacer
XP-10136



Antenna Holder
XP-10001



Flat Head Screw M3 x 10mm
XP-40049



Flat Head Screw M3 x 6mm
XP-40046



Battery Stopper
XP-10185

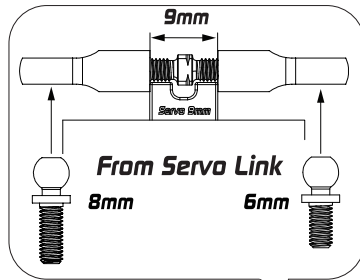

Bearing 3 x 6 x 2.5mm

4.8mm Ball End 6mm Thread

Bearing 3 x 6 x 2.5mm

Composite Steering Plate For Dual Servo Saver

4.8mm Ball End 6mm Thread

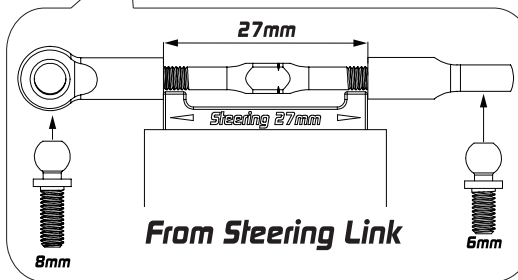

Flat Head Screw M3 x 10mm

Flat Head Screw M3 x 6mm

FRP Floating Servo Holder 3.0mm

Battery Stopper

FRP Floating Servo Holder 3.0mm

Flat Head Screw M3 x 6mm

Composite Servo Mount

Servo Spacer

Flat Head Screw M3 x 6mm

No Electronics are included

3 x 5.5 x 1 mm Composite Spacer

Round Head Screw M3 x 8mm

Servo Horn

Servo Spacer

4.8mm Ball End 8mm Thread
From Servo Link

Round Head Screw M3 x 8mm

Round Head Screw M3 x 6mm

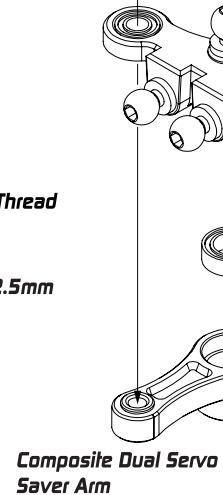

Bearing 5 x 8 x 2.5mm

Bearing 5 x 8 x 2.5mm

Flat Head Screw M3 x 6mm

Flat Head Screw M3 x 6mm

Antenna Holder

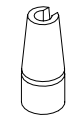

Antenna Holder

Antenna Holder

Antenna Holder

Antenna Holder

Antenna Holder

Antenna Holder

Antenna Holder

Antenna Holder

Antenna Holder

Antenna Holder

Antenna Holder

Antenna Holder

Antenna Holder

Antenna Holder

Antenna Holder

Antenna Holder

Antenna Holder

Antenna Holder

Antenna Holder

Antenna Holder

Antenna Holder

Antenna Holder

Antenna Holder

Antenna Holder

Antenna Holder

Antenna Holder

Antenna Holder

Antenna Holder

Antenna Holder

Antenna Holder

Antenna Holder

Antenna Holder

Antenna Holder

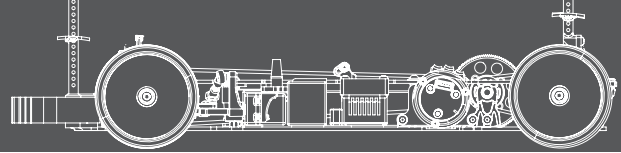

Bag E, G, HW C, E, H, K

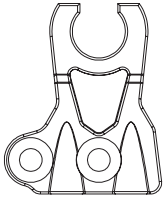

Composite Layshaft Bulkhead
XP-10231 Optional XP-10274

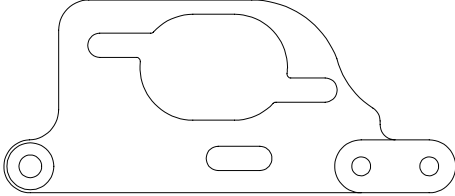

Alu Motor Mount Plate V2
XP-10594

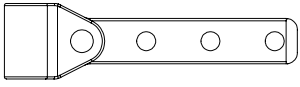

Alu Motor Mount Center Support V2
XP-10594



3 x 5.5 x 1 mm Composite Spacer
XP-10261 Optional XP-10119, XP-10240



XQ15 Aluminum Center Post
XP-10259



Round Head Screw M3 x 6mm
XP-40037



Flat Head Screw M3 x 6mm
XP-40046



Flat Head Screw M3 x 10mm
XP-40049



Flat Head Screw M3 x 12mm
XP-40050



Bearing 5 x 10 x 4mm
XP-40064

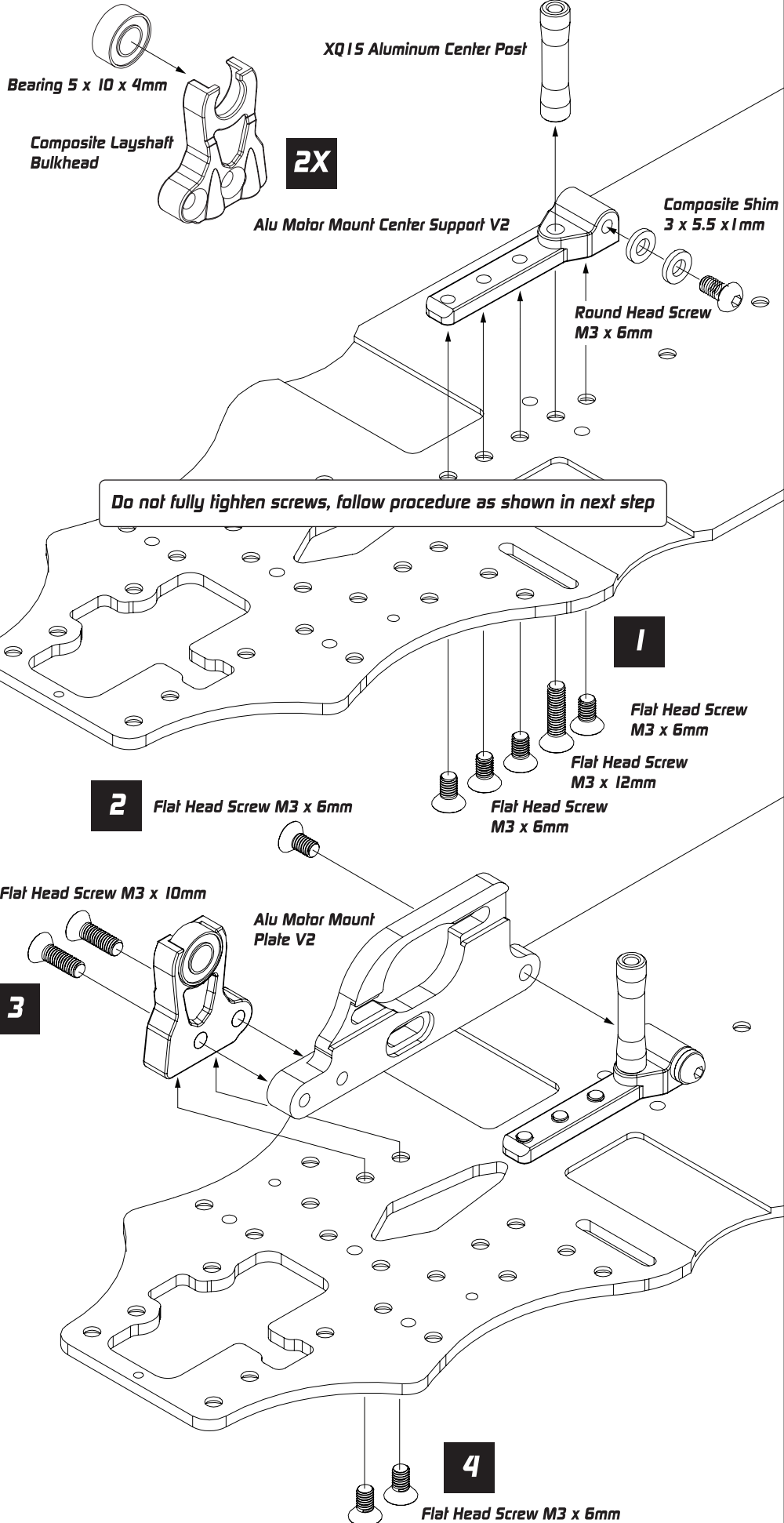

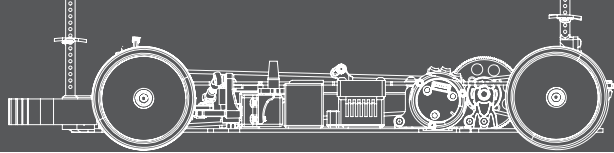

Bag 1, F, HW K

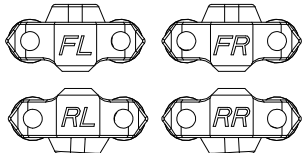

Composite Lower 2-Piece Suspension Holder
FL,FR,RL,RR XP-10260

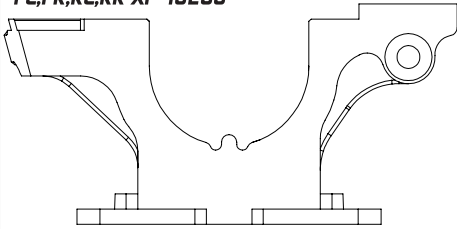

Composite Lower Bulkhead
XP-10229

Flat Head Screw M3 x 8mm
XP-40048

Flat Head Screw M3 x 6mm
XP-40046

Optional

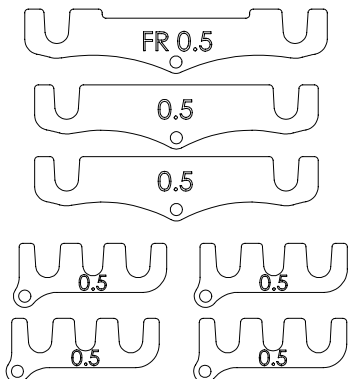

Lower Suspension Mount Spacer 0.5mm
XP-10726

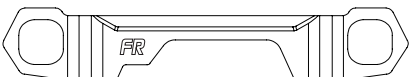

Aluminum FR One Piece Suspension Mount
XP-10637

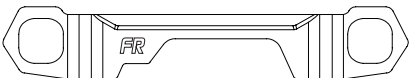

Brass FR One Piece Suspension Mount
XP-10638

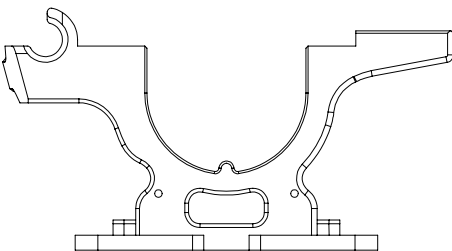

Alu Lower Bulkhead
XP-10115

Optional

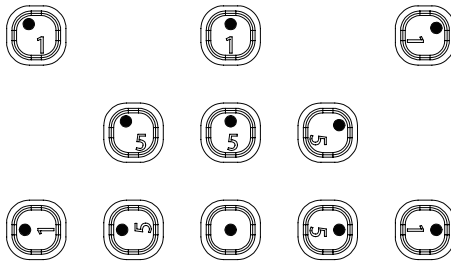

Diagonal Offset

Use either 0.5 or 1 mm to shift the roll center in a diagonal direction from the center.

4X

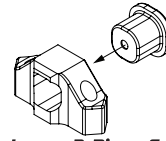

Eccentric Bushing Set
XP-10127

Alu Lower 2-Piece Suspension Holder XP-10123

Horizontal Offset

Choice of either 0.5 or 1 mm offset from center

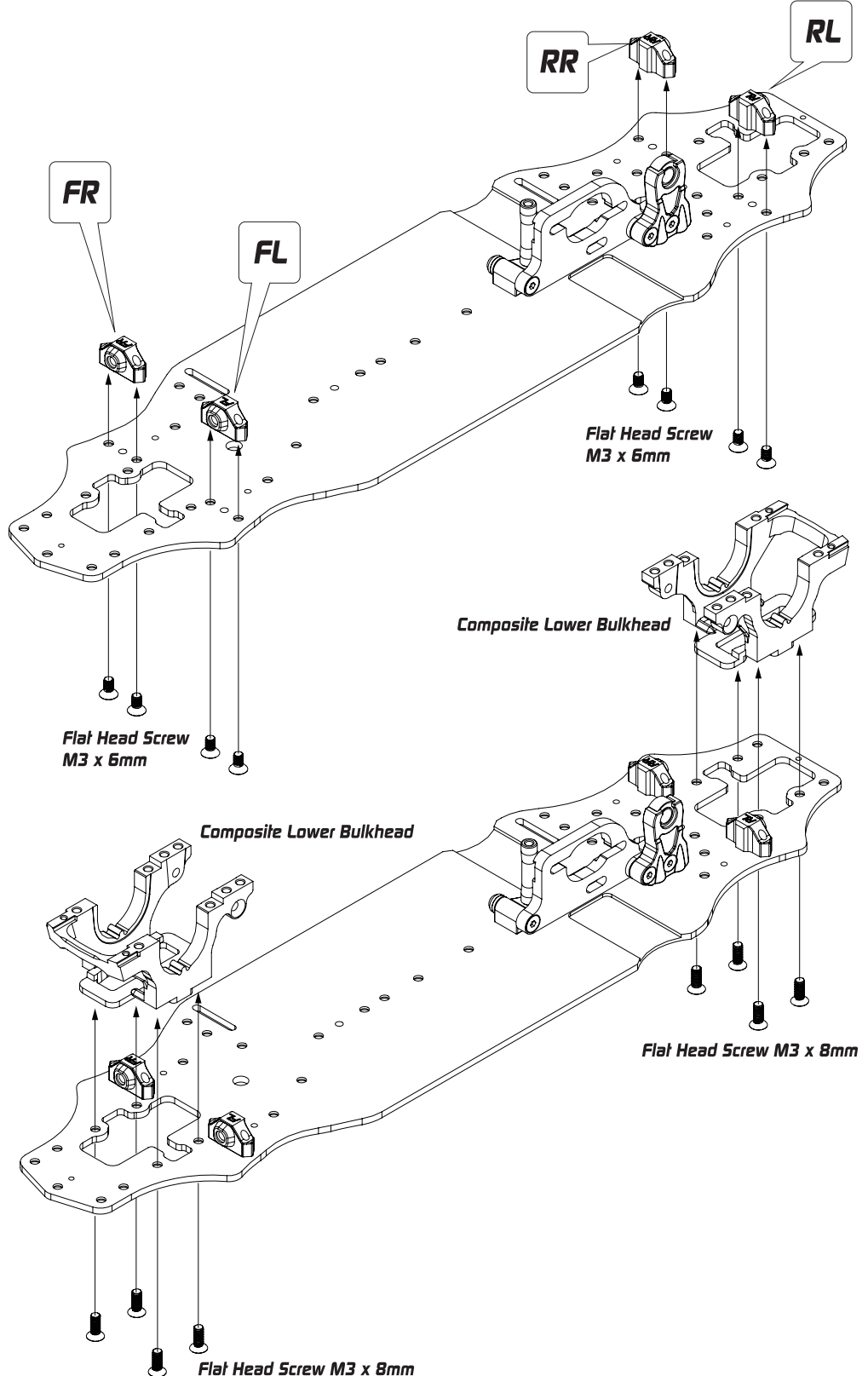

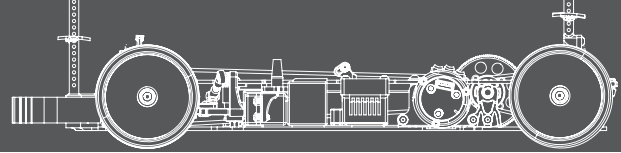

Bag E , K , FRP , HW D , E , K

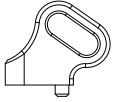

Belt Tensioner
XP-10163



Bearing 3 x 6 x 2.5mm
XP-40060



Spacer 3 x 5 x 0.2mm
XP-40066



Round Head Screw M3 x 6mm
XP-40037



Round Head Screw M3 x 8mm
XP-40038



Round Head Screw RM3 x 16mm
XP-40042



Flat Head Screw M3 x 6mm
XP-40046



Flat Head Screw M3 x 8mm
XP-40048



Nut 3 x 5.5mm
XP-40067

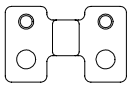

Composite Upper Deck Stiffener
XP-10643 Optional XP-10566



XQ15 Aluminum Center Post
XP-10259



Composite Upper Deck Collar For Flex Elimination
XP-10739 Optional XP-10683



Bearing 3 x 6 x 2.5mm
XP-40060



Composite Upper Deck Collar For Flex Elimination
XP-10739 Optional XP-10683

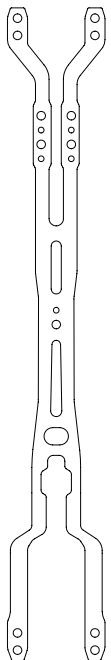

FRP 2.0mm Top Deck V2
XP-10595
Optional XP-10820

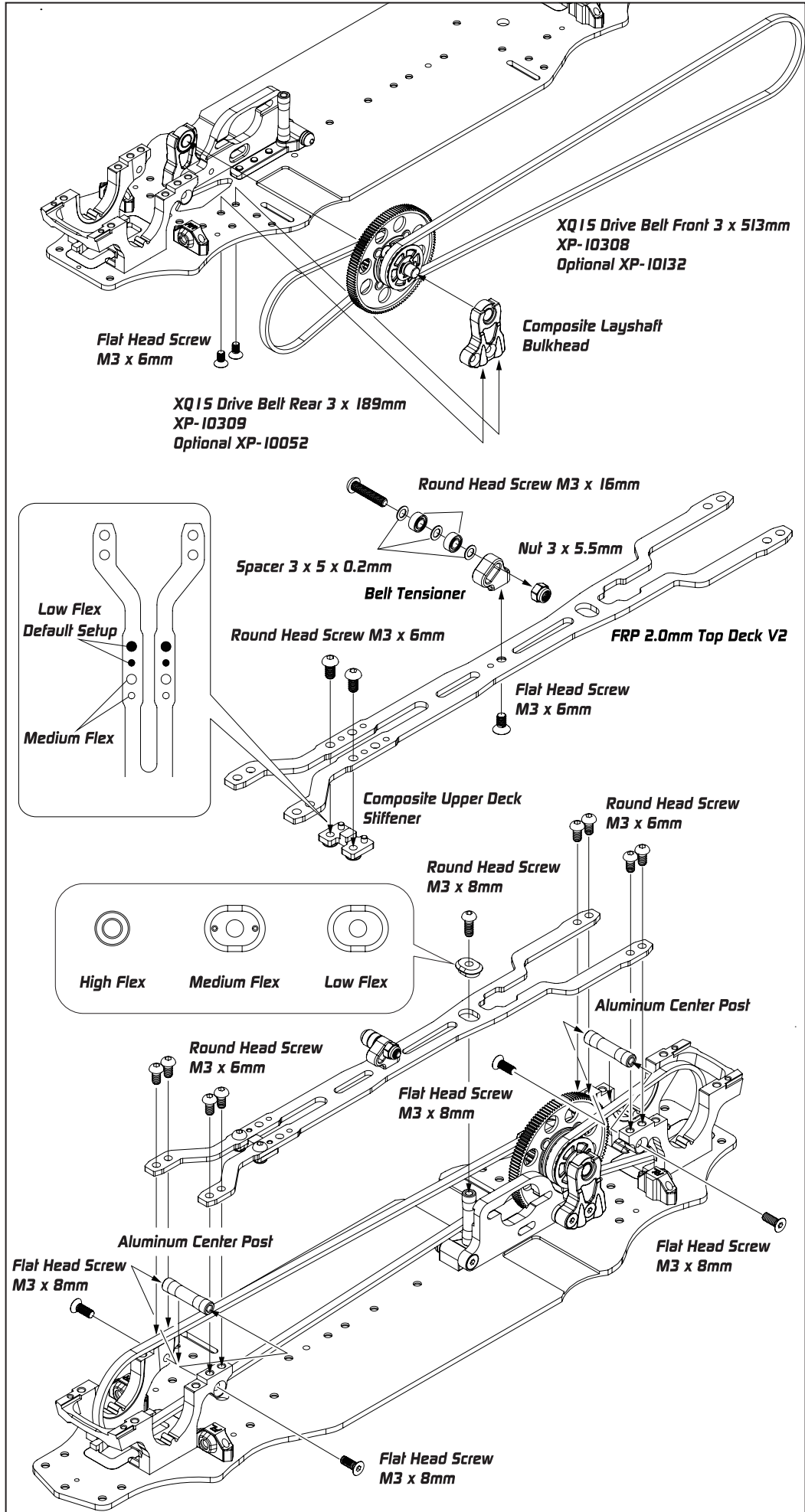

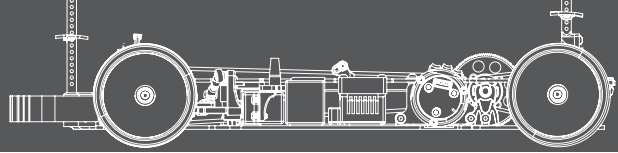

Bag H, HW K

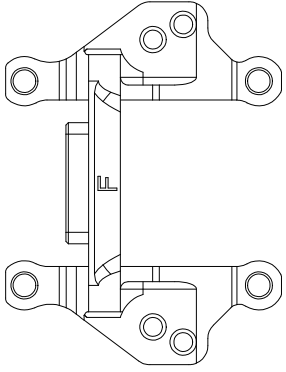

Composite One Piece Upper Clamp V2 Front
XP-10699 Optional XP-10104

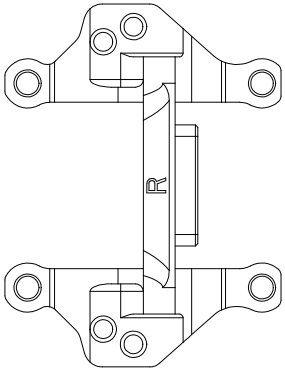

Composite One Piece Upper Clamp V2 Rear
XP-10699 Optional XP-10130



Round Head Screw M3 x 8mm
XP-40038

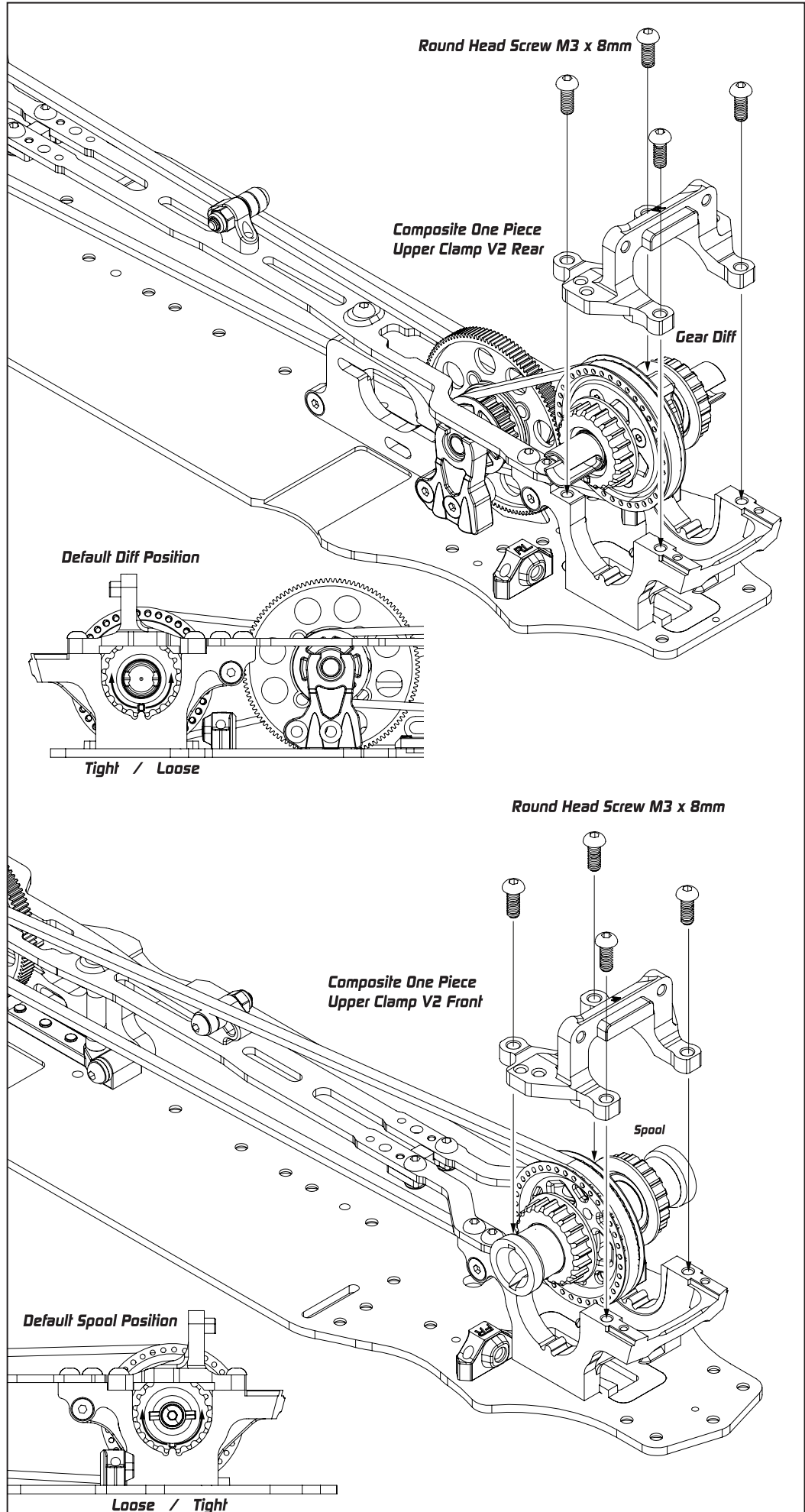

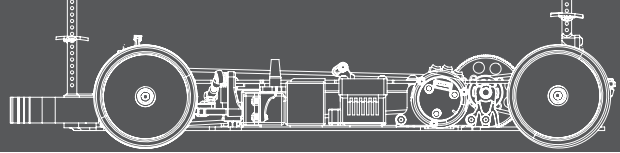

Bag F , HW K



Composite Steering Post
For Dual Servo Saver 11.5mm
XP-10740



Flat Head Screw M3 x 6mm
XP-40046



Round Head Screw M3 x 6mm
XP-40037

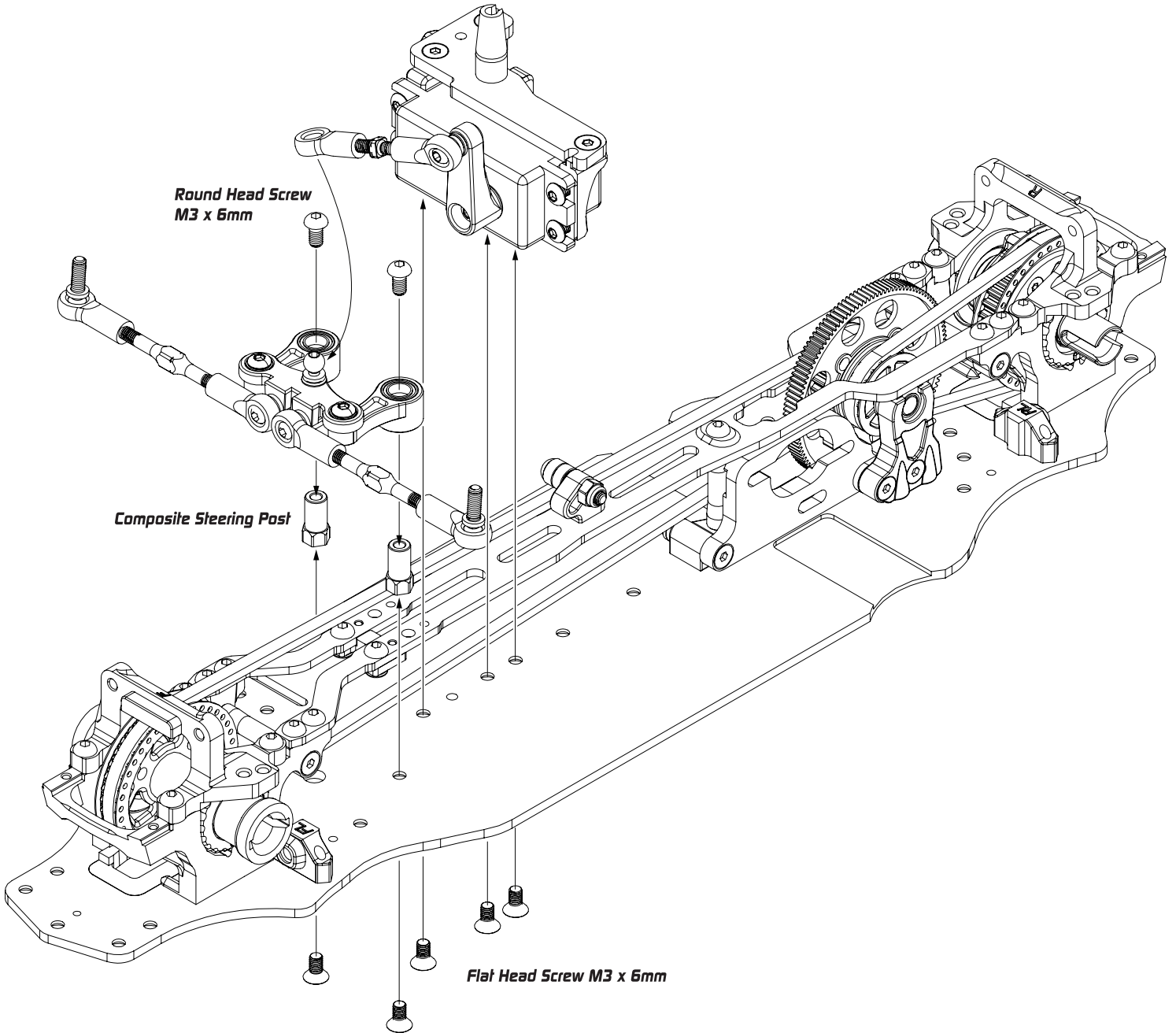

Optional



Aluminum Steering Post
For Dual Servo Saver 11.5mm
XP-10494

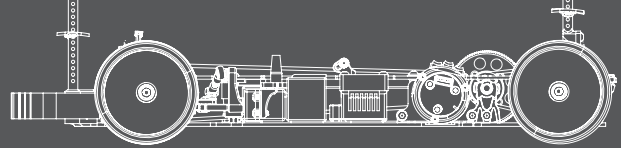

Bag E, J, HW F, H, I and HW K

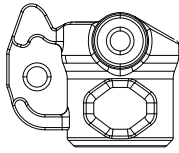

Composite Steering Block Right
XP-10109
Optional XP-10247

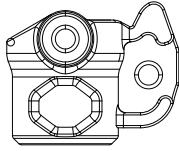

Composite Steering Block Left
XP-10109
Optional XP-10247

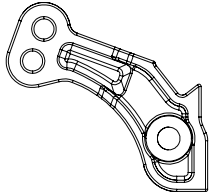

Composite Steering Block Plate Right
XP-10109
Optional XP-10247

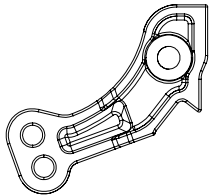

Composite Steering Block Plate Left
XP-10109
Optional XP-10247

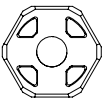

Composite Wheel Hub
XP-10262
Optional XP-10129, XP-20015, XP-20016



Bearing 5 x 10 x 4mm
XP-40064



Pin 2 x 9.8mm
XP-40069



Round Head Screw M3 x 8mm
XP-40038



5 x 7 x 0.2mm Spacer
XP-10376

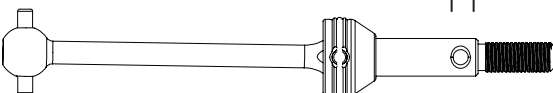

XQ I-5 Steel Universal Shaft
XP-10244
Optional XP-10166, XP-10167, XP-10334

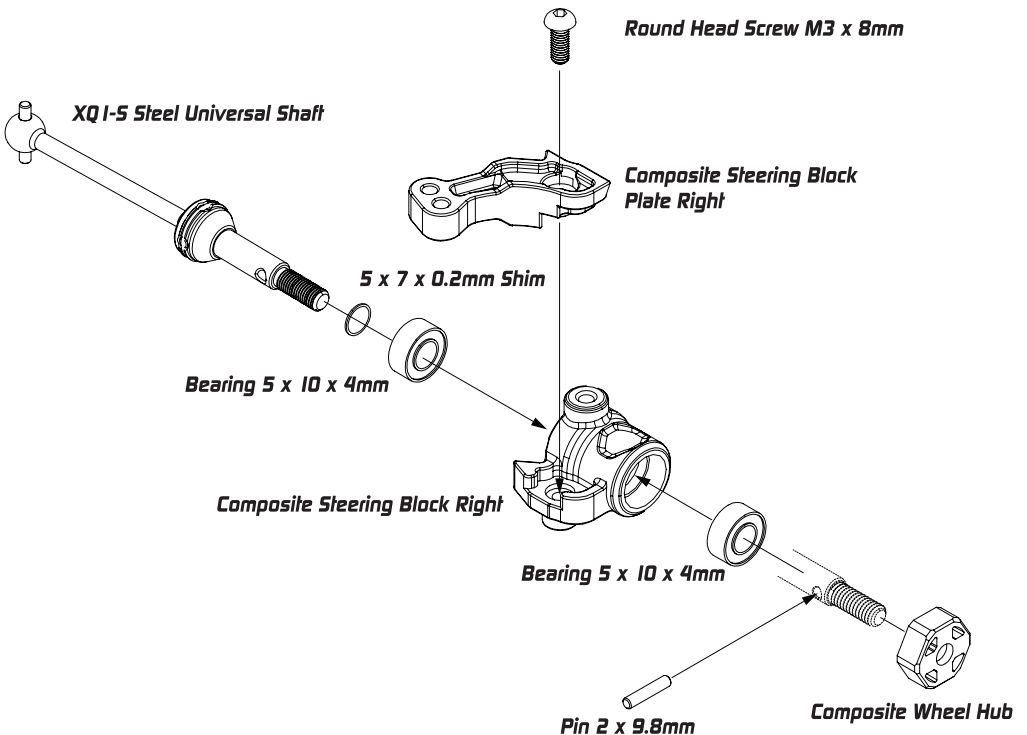
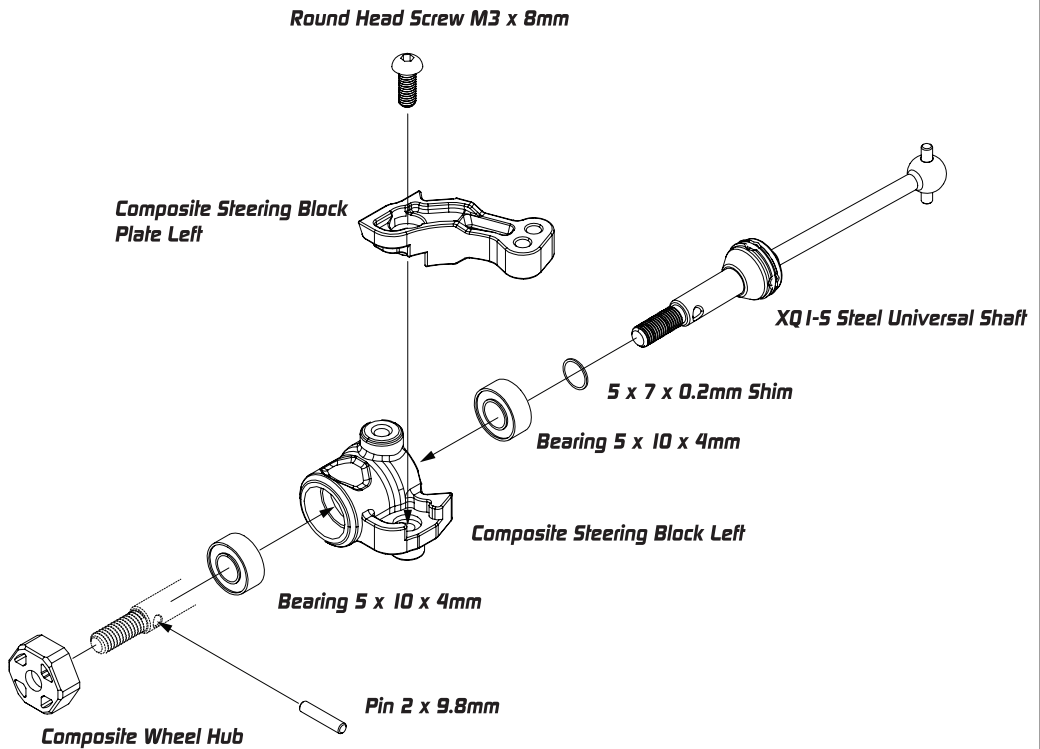

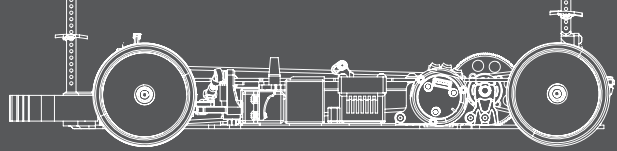

Bag J , L , HW I and HW K

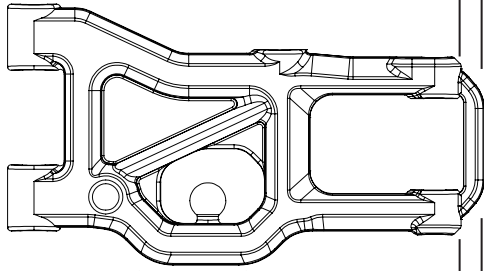

Front Composite Suspension Arm (Strong)
XP-10603 Optional XP-10597 (Strong Hard)

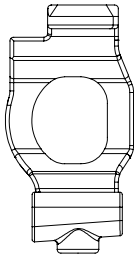

Composite C Hub 4 Degree L (Strong V2)
XP-10400
Optional XP-10810

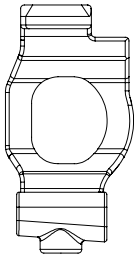

Composite C Hub 4 Degree R (Strong V2)
XP-10400
Optional XP-10810

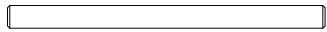

Suspension Pivot Pin 3 x 42mm
XP-10139



3mm Outer Suspension Pin w/ Groove
XP-10602



Set Screw M3 x 3mm
XP-40052



Hex Set Screw M4 x 10mm
XP-40056



Hex Set Screw M3 x 8mm
XP-40054

Composite C Hub 4 Degree R (Strong)

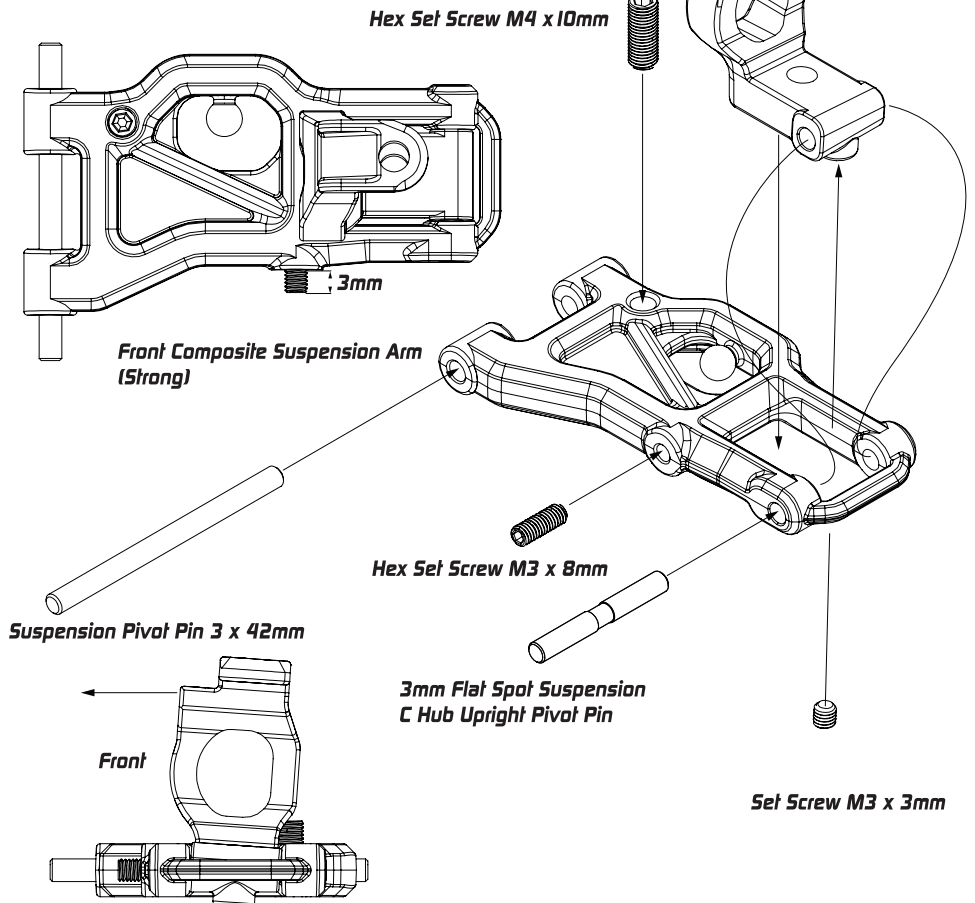
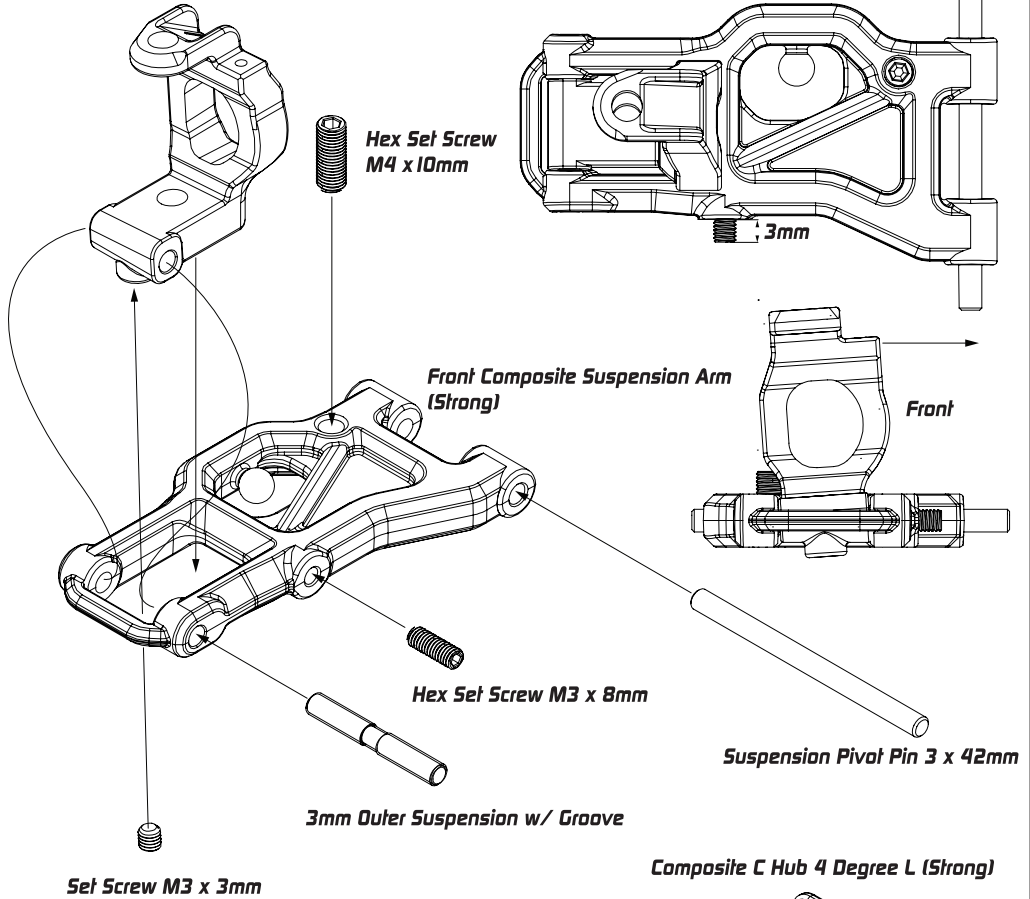

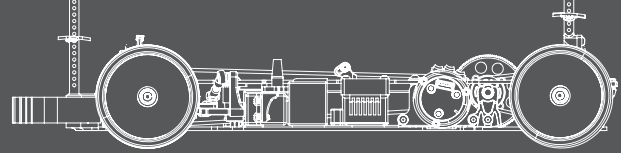

HW G

 **King Pin Collar V2**
XP-10401

 **King Pin V2**
XP-10401

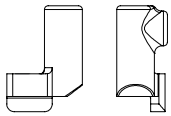
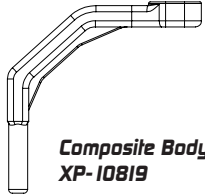

Composite Body Support Base - Right
XP-10819

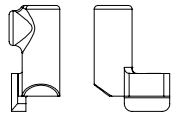

Hex Screw Round Head M2 x 6mm
XP-40100



Set Screw M3 x 3mm
XP-40052

King Pin
XP-10401

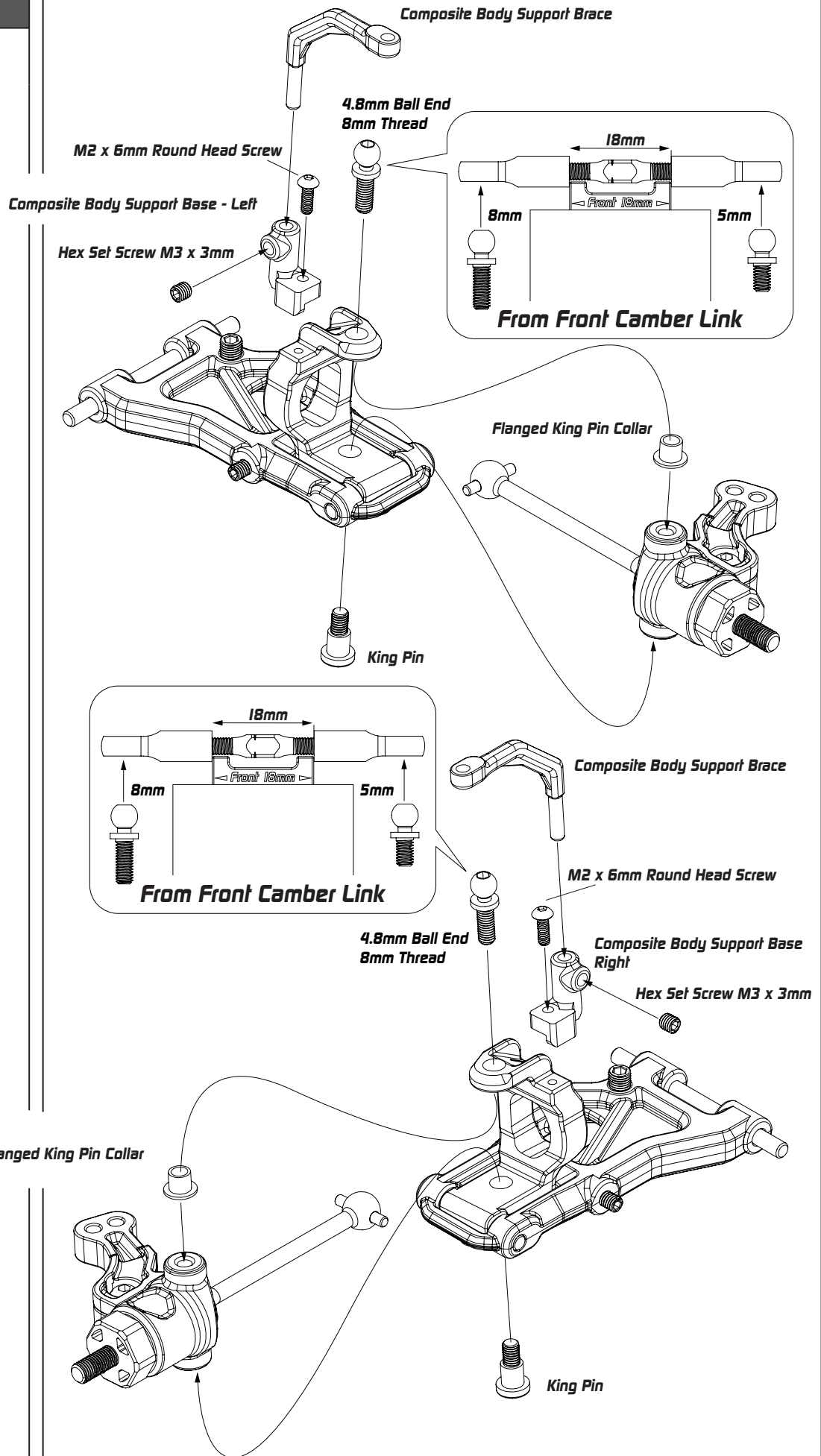

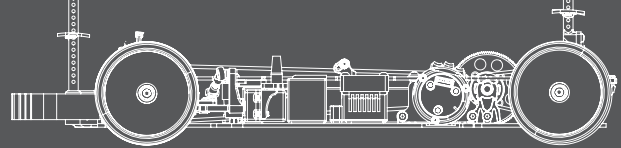

Bag G , I , HW K



Flat Head Screw M3 x 6mm
XP-40046



Composite Suspension Mount - FF
XP-10260



3 x 5.5 x 1mm Composite Spacer
XP-10261

Optional



Diagonal Offset
Use either 0.5 or 1mm to shift the roll center in a diagonal direction from the center.



Eccentric Bushing Set
XP-10127

Alu Front Lower 1-Piece Suspension Holder - FF
XP-10114



Horizontal Offset
Choice of either 0.5 or 1mm offset from center

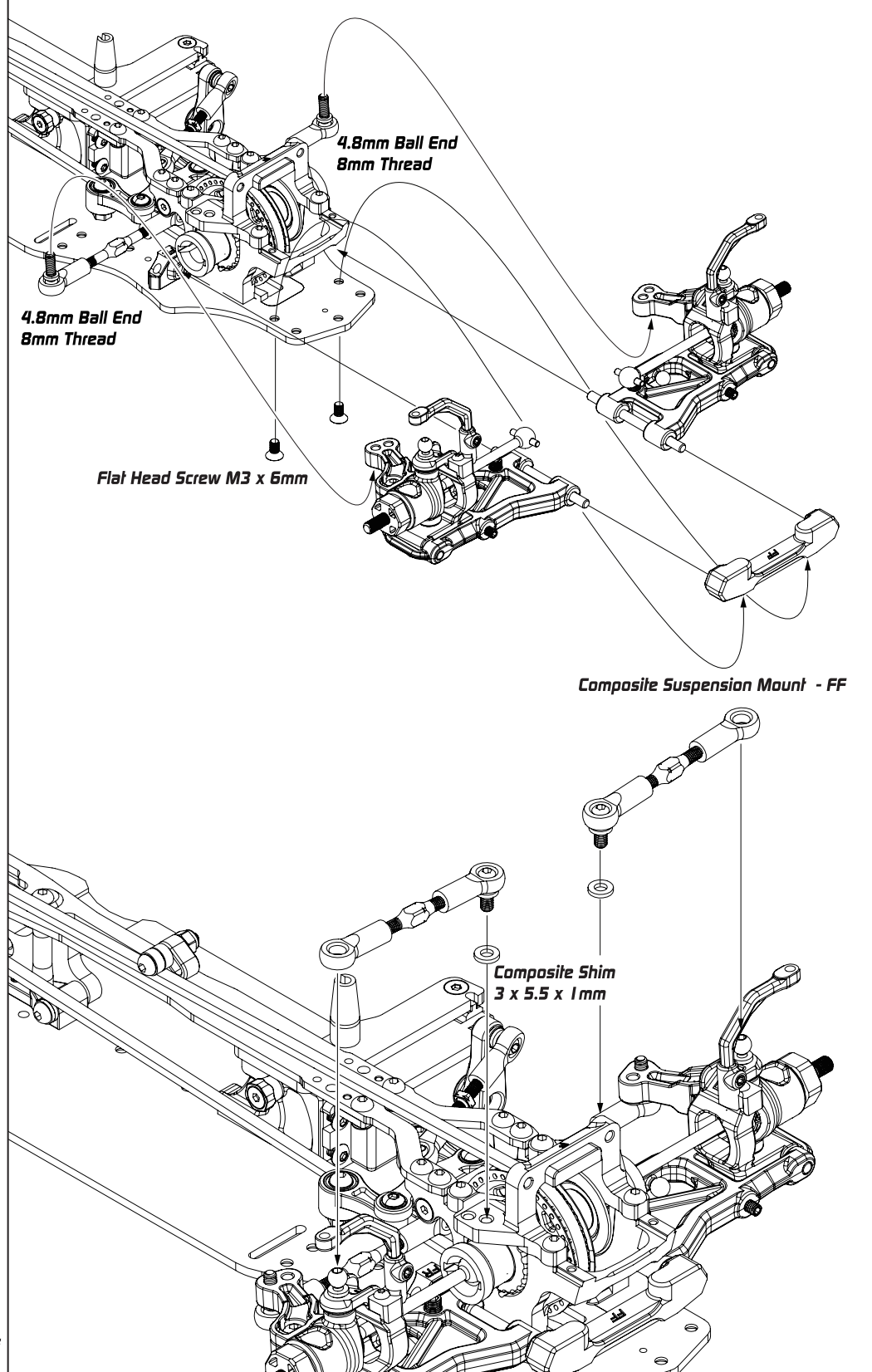

Optional

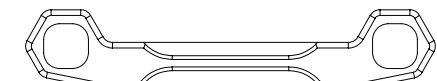

Alu Front Lower 1-Piece Suspension Holder - FF
XP-10114

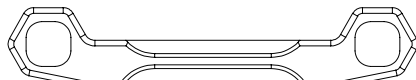

Brass Front Lower 1-Piece Suspension Holder - FF
XP-10199

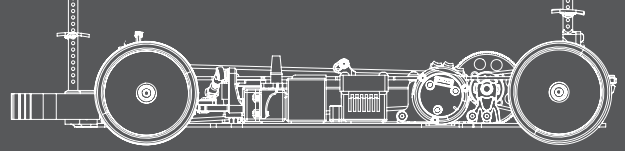

Bag K, L, HW F, H, I, K

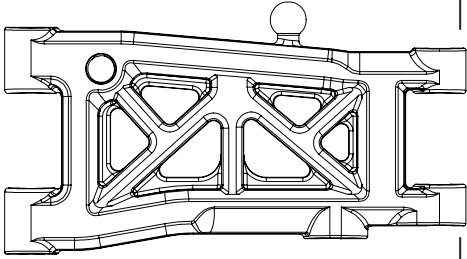

Composite Suspension Rear (Strong)
XP-10606 Optional XP-10597

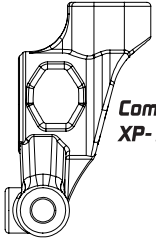

Composite Rear Upright (Strong) V2
XP-10689 Optional XP-10822



Driveshaft Protector Blade
XP-10128



Bearing 5 x 10 x 4mm
XP-40064

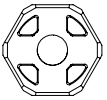

Composite Wheel Hub
XP-10262
Optional XP-20015, XP-20016,
XP-10129



Pin 2 x 9.8mm
XP-40069



Suspension Pivot Pin 3 x 42mm
XP-10139



3mm Outer Suspension Pin w/ Groove
XP-10602



Set Screw M3 x 3mm
XP-40052



Hex Set Screw M3 x 8mm
XP-40054



Hex Set Screw M4 x 10mm
XP-40056

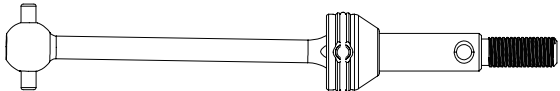
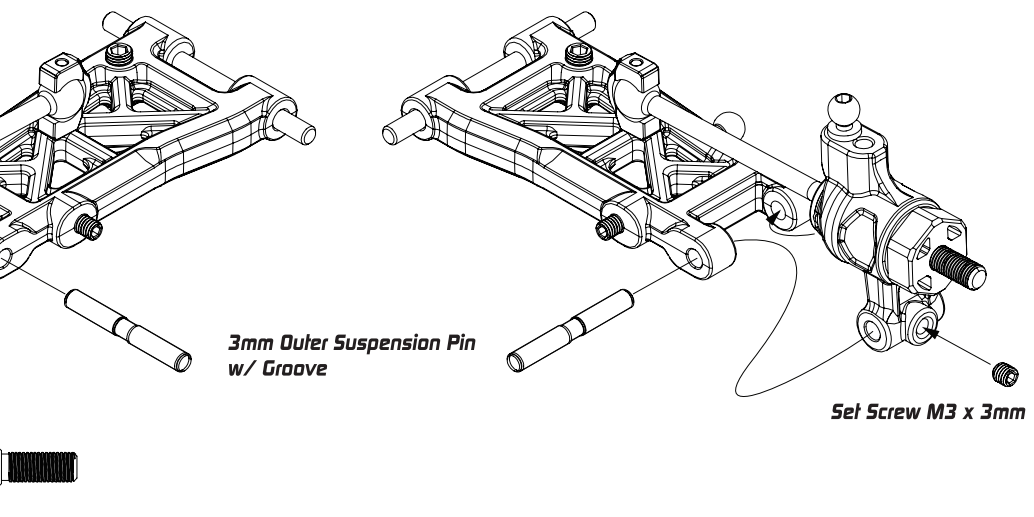
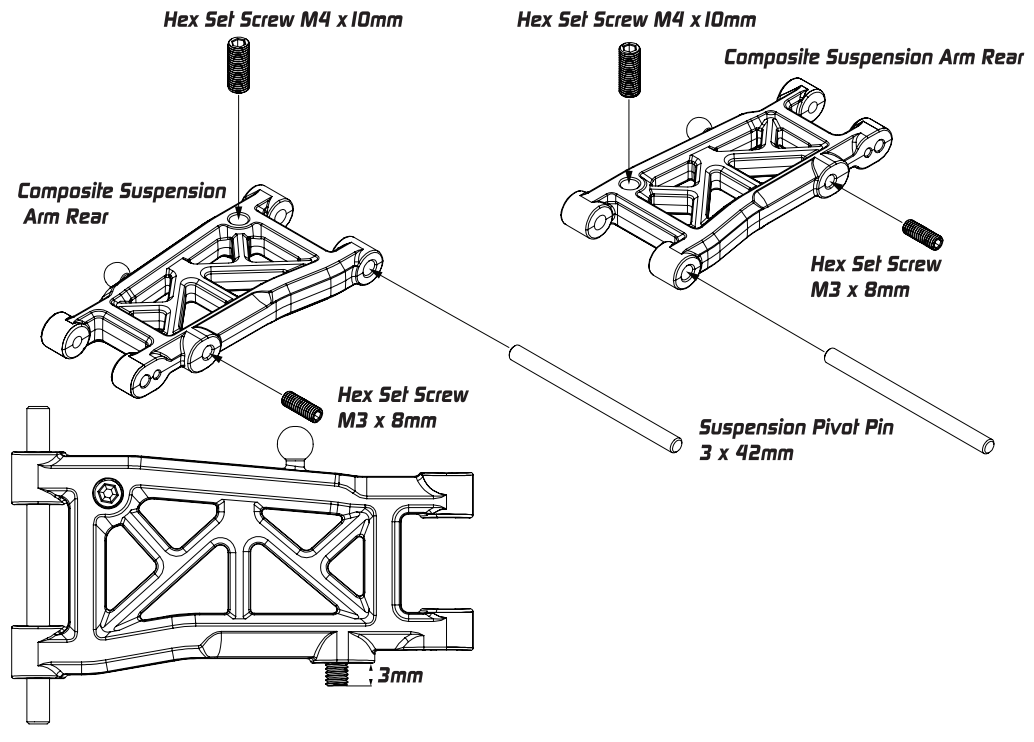
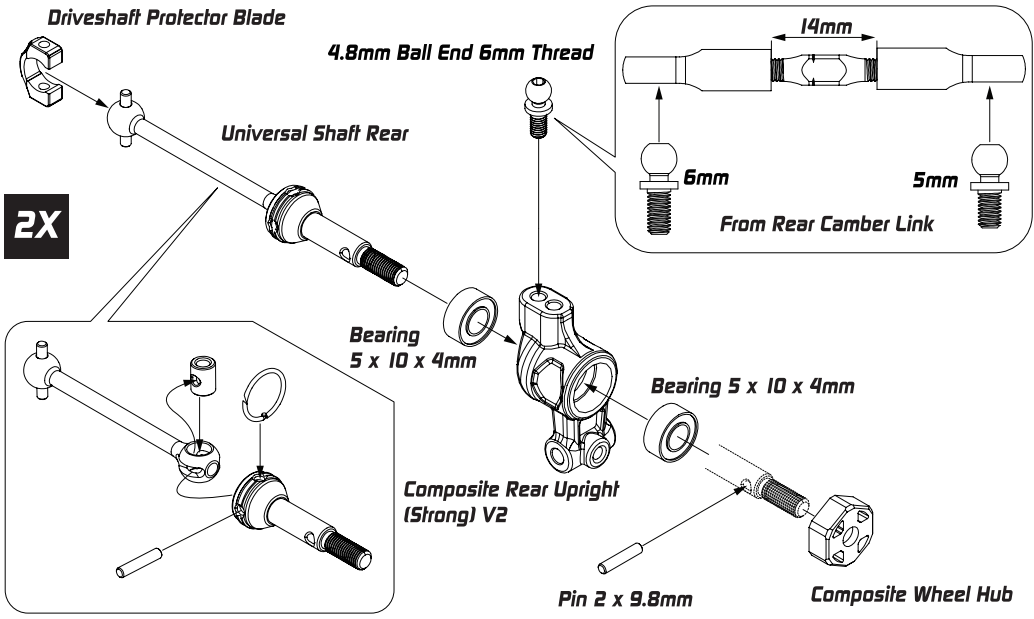

XQ1-S Steel Universal Shaft
XP-10244 Optional XP-10167

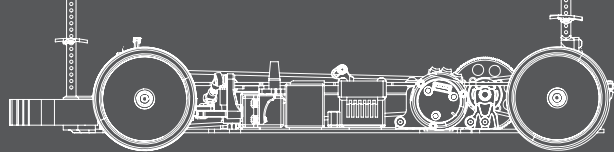

Bag G , I , HW K



**Composite Suspension Mount - RR
XP-10260**



**Flat Head Screw FM3 x 6mm
XP-40046**



Composite Shim 3 x 5.5 x 1mm

Composite Suspension Mount - RR

Optional



Default Setup

Diagonal Offset

Use either 0.5 or 1mm to shift the roll center in a diagonal direction from the center.

**Alu Rear Lower 1-Piece Suspension holder - RR
XP-10124**

Horizontal Offset

Choice of either 0.5 or 1mm offset from center

**Eccentric Bushing Set
XP-10127**

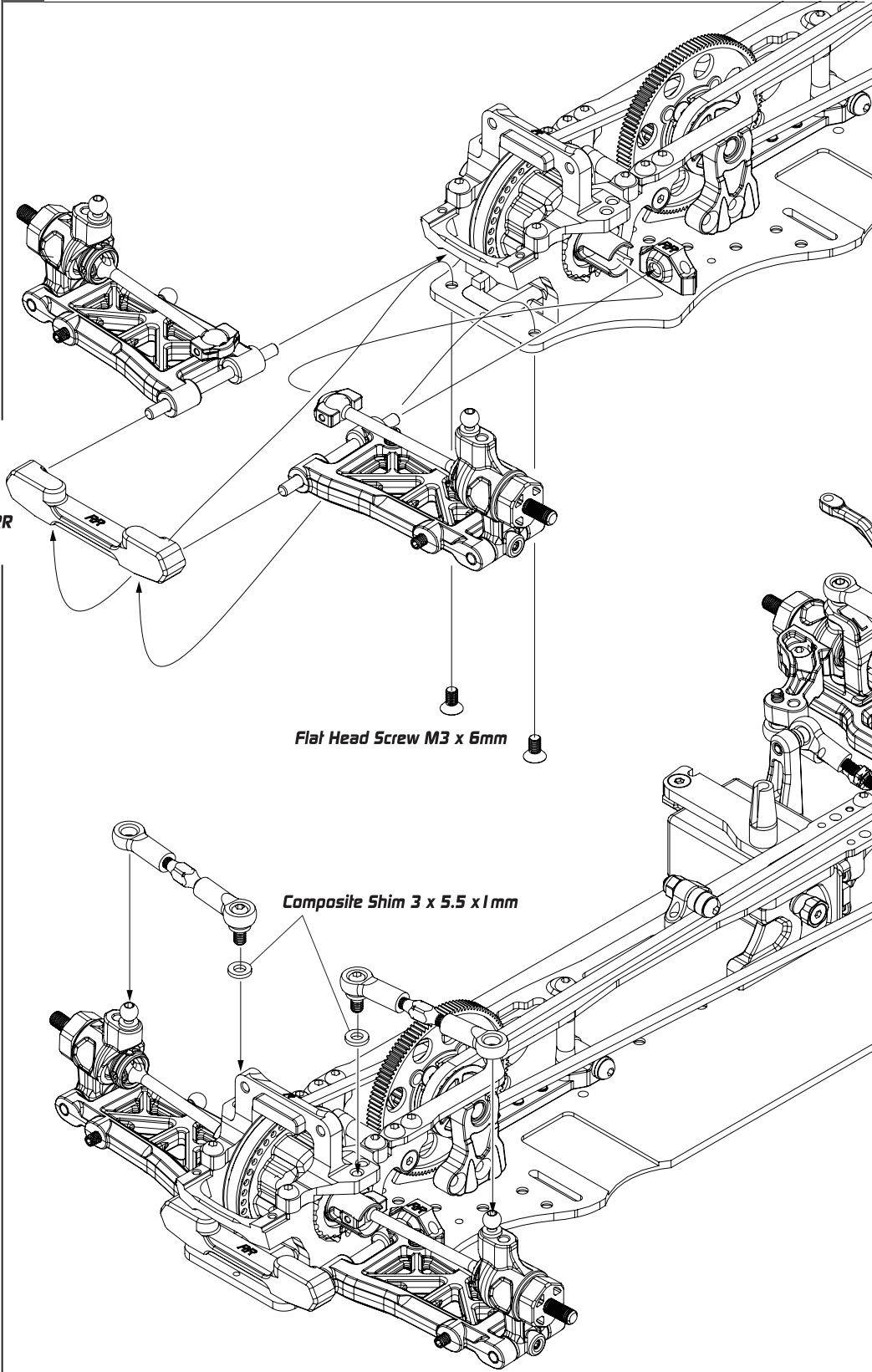

Flat Head Screw M3 x 6mm

Composite Shim 3 x 5.5 x 1mm

Optional

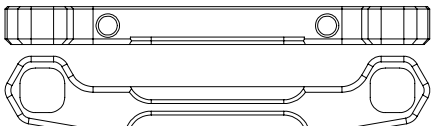

**Alu Rear Lower 1-Piece Suspension holder - RR
XP-10124**

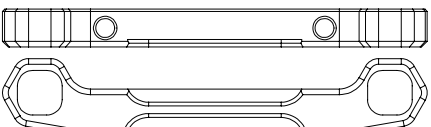

**Brass Rear Lower 1-Piece Suspension holder
- RR XP-10200**

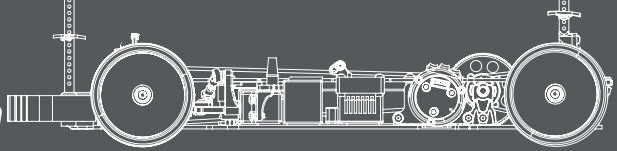

Bag H and HW K

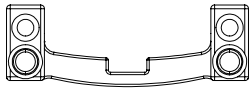

Anti-Roll Bar Mount XP-10230

M3 x 3mm Set Screw XP-40052



Cap Hex Screw 2x5mm XP-40034

Optional XP-10326

Front Anti-Roll Bar

- 1.2mm More Response
- 1.3mm Default Setup
- 1.4mm Less Response

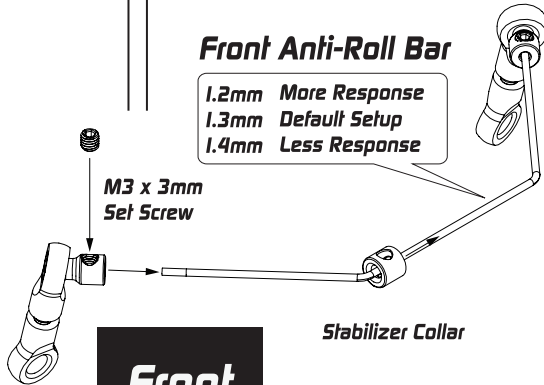

Front

4X

For Anti-Roll Bar

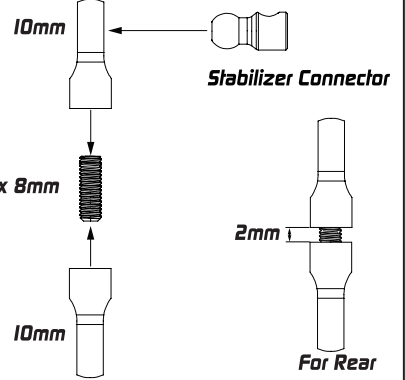

Stabilizer Connector

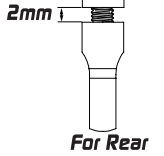

For Rear

Rear Anti-Roll Bar

- 1.2mm More Response
- 1.3mm Default Setup
- 1.4mm Less Response

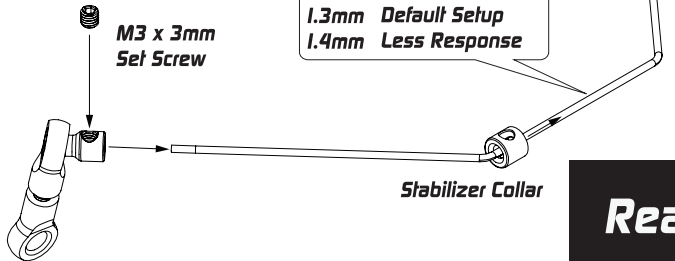

Rear

M3 x 3mm Set Screw

Cap Hex Screw 2x5mm

Cap Hex Screw 2x5mm

Anti-Roll Bar Mount

M3 x 3mm Set Screw

Move Freely

Optional

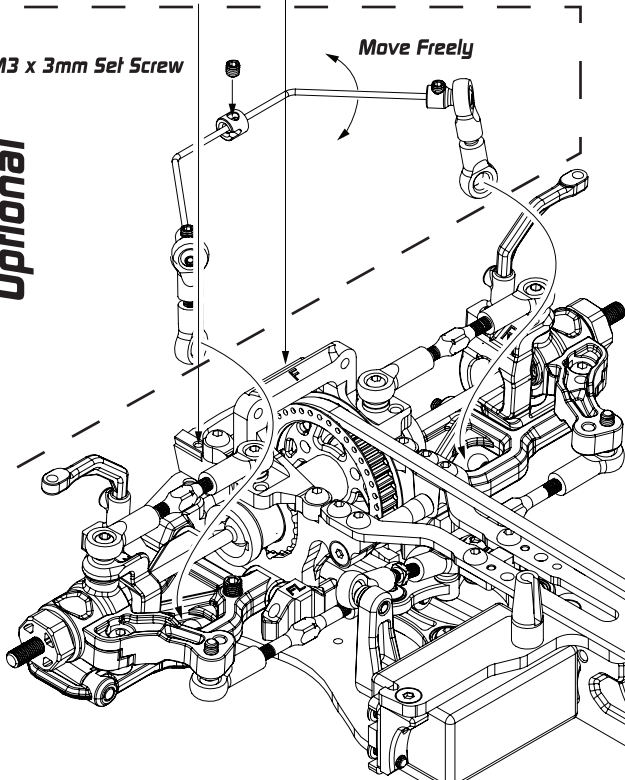

Cap Hex Screw 2x5mm

M3 x 3mm Set Screw

Anti-Roll Bar Mount

M3 x 3mm Set Screw

Move Freely

Optional

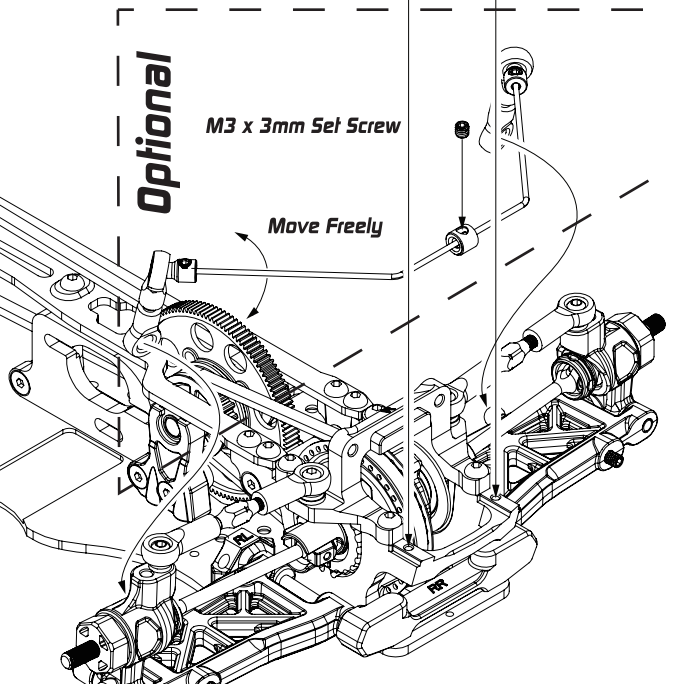

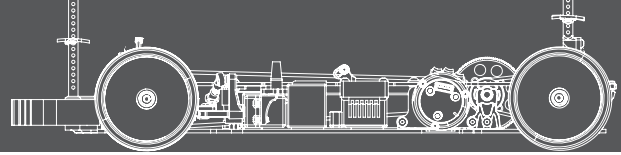

Bag L and HW J

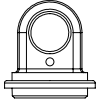

Long Travel Short Shock Composite Shock Top Connector (Black) XP-10396

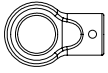

Long Travel Short Shock Lower Connector (Black) XP-10396

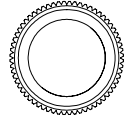

Alu Upper Short Shock Cap XP-10397



Alu Lower Short Shock Cap XP-10398

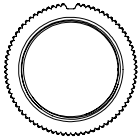

Alu Short Shock Spring Tension Adjust Nut XP-10399

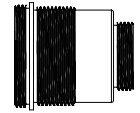

Composite Short Shock Body XP-10596

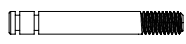

Short Shock Shaft XP-10582

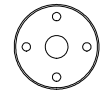

4 Hole Piston XP-10159



Shock Absorber Membrane XP-10147



E-Clip 2.5mm XP-40057



Shock O-Ring XP-10160

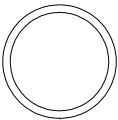

O Ring For Short Shock Spring Adjust Nut XP-10607



Shaft Cover XP-10159

Optional



Shock X-Ring XP-10601

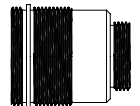

Long Travel Aluminum Short Shock Body XP-10725

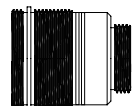

Progressive Aluminum Short Shock Body XP-10718

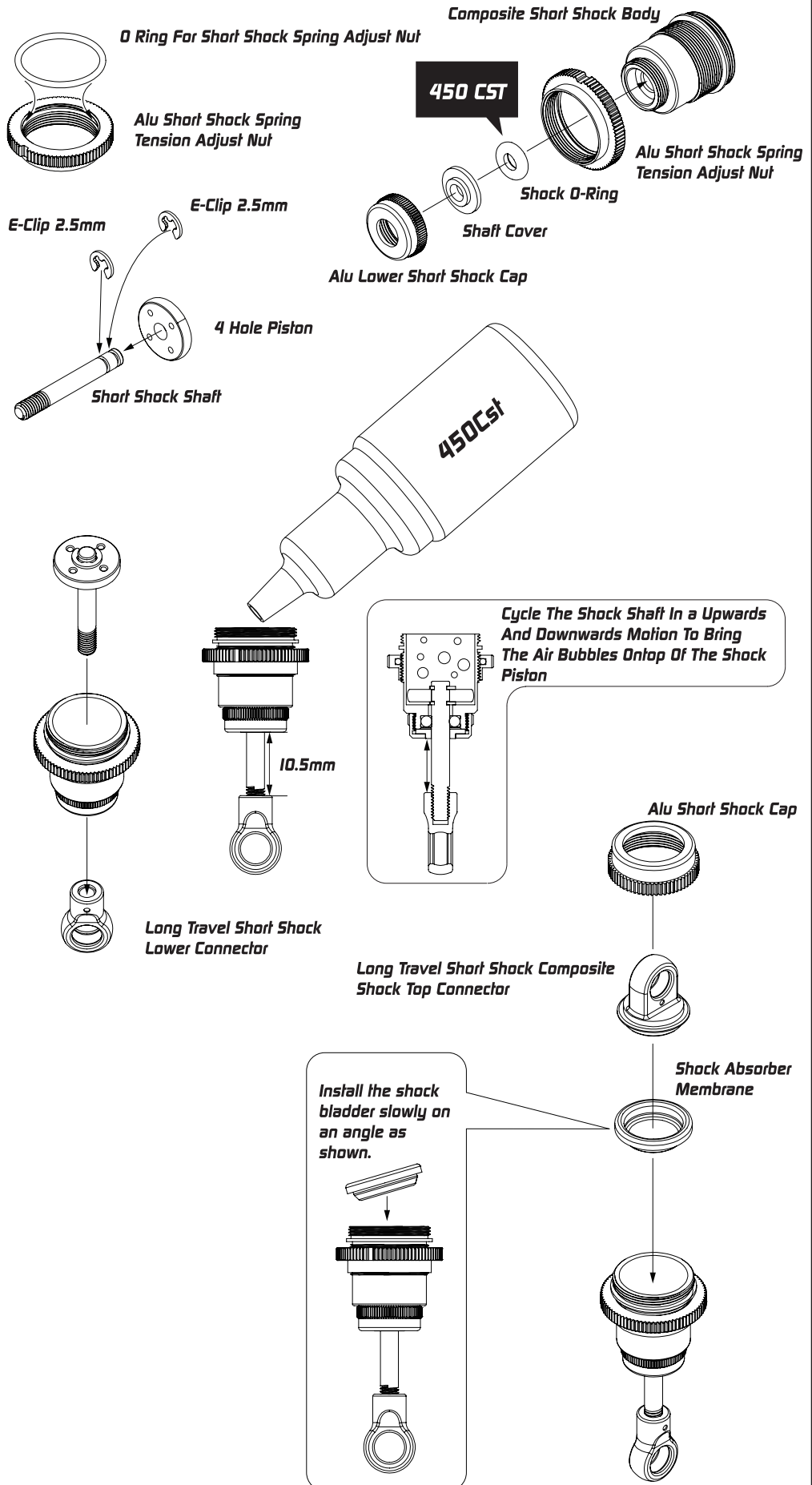

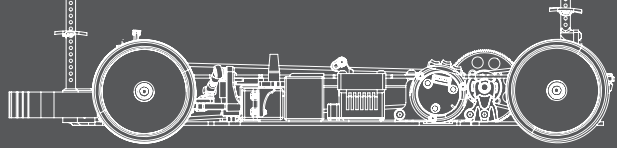

Bag L, FRP, HW I and HW K

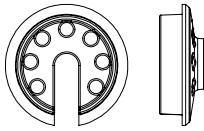

Short Spring Retainer
(Black) XP-10396

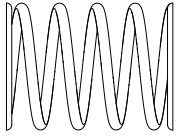

Shock Spring Medium Silver
XP-10169
Optional
XP-10168 (Soft)
XP-10170 (Stiff)

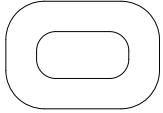

Body Height Adjuster Support
XP-10561

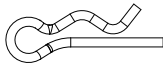

Body Clip
XP-10055



Round Head Screw M3 x 6mm
XP-40037

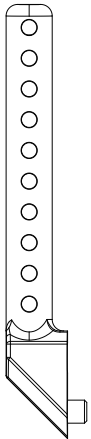

Rear Body Post
XP-10561



Pivot Ball 5.5 mm
XP-10121



Round Head Screw M3 x 8mm
XP-40038



Flat Head Screw M3 x 8mm
XP-40048

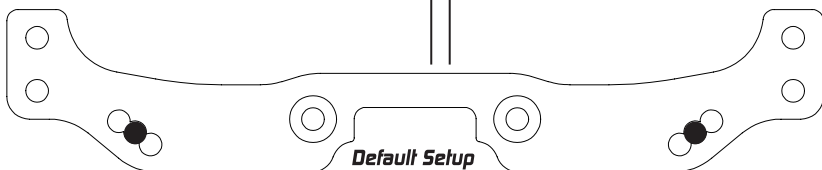

Default Setup

FRP 3.0mm Rear Shock Tower (Short Shock)
XP-10792 Optional XP-10609

4X

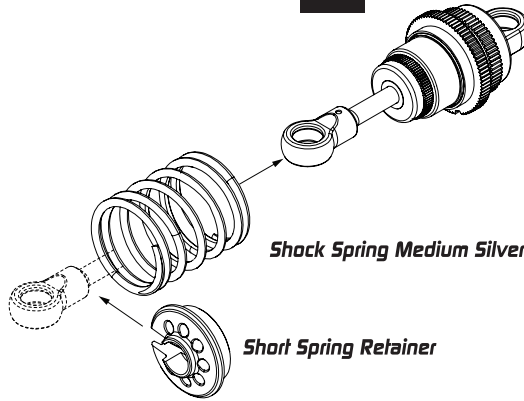

Shock Spring Medium Silver

Short Spring Retainer

4X

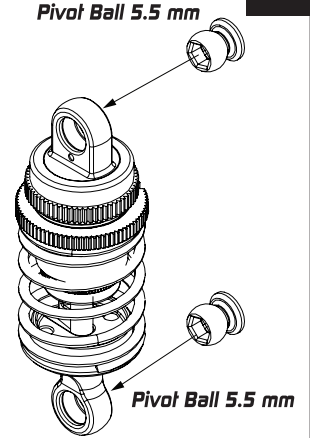

Pivot Ball 5.5 mm

Pivot Ball 5.5 mm

Body Height Adjuster Support

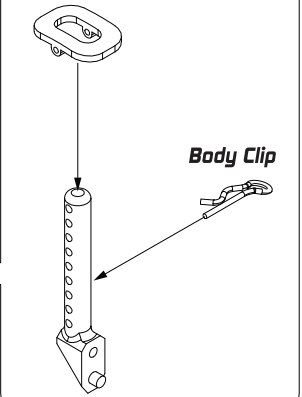

Body Clip

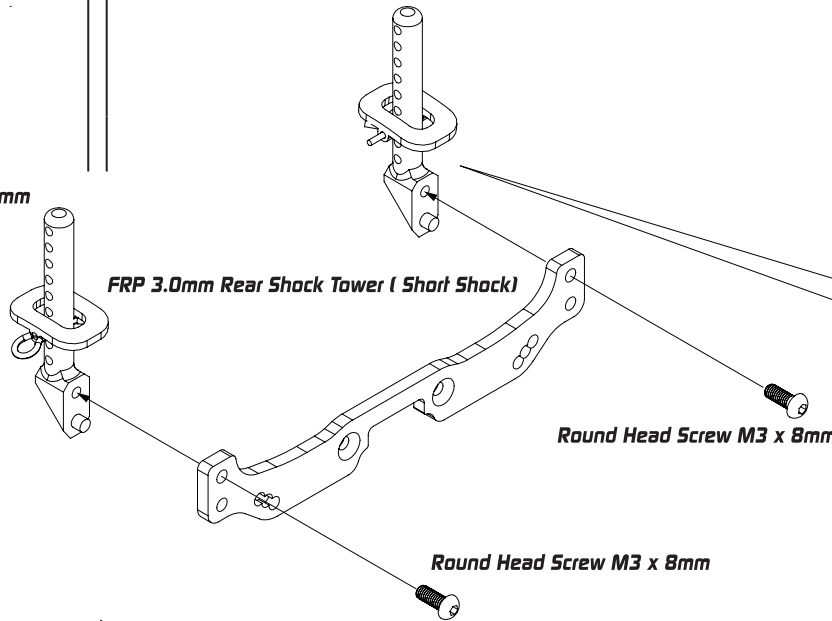

FRP 3.0mm Rear Shock Tower (Short Shock)

Round Head Screw M3 x 8mm

Round Head Screw M3 x 8mm

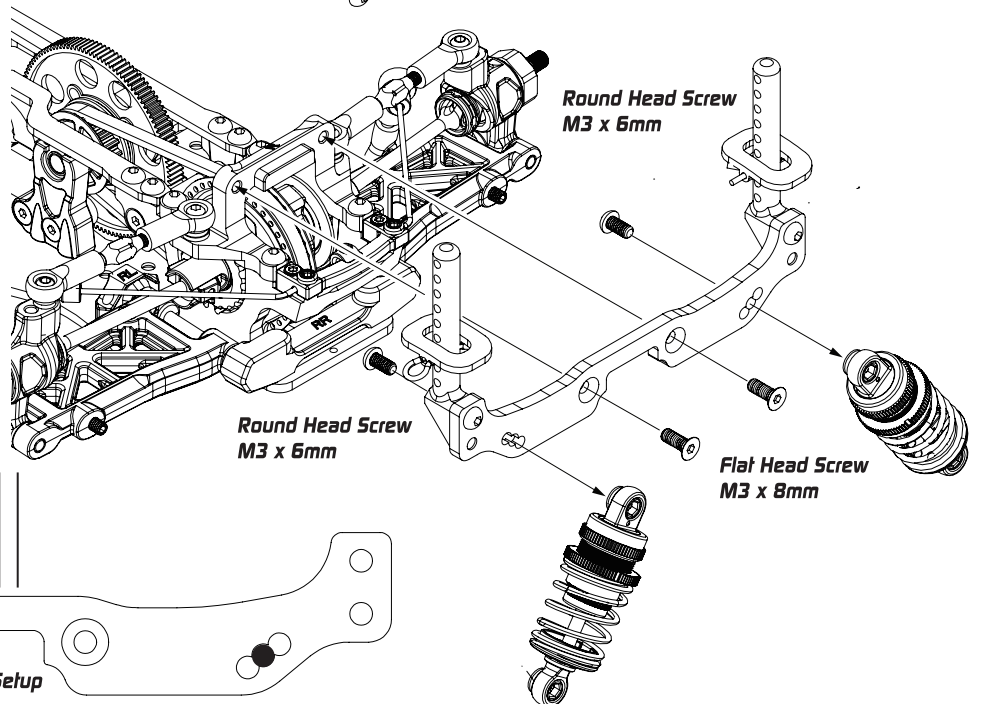

Round Head Screw M3 x 6mm

Round Head Screw M3 x 6mm

Flat Head Screw M3 x 8mm

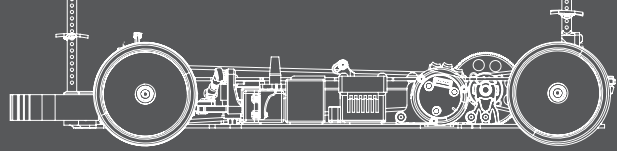

Bag L , FRP and HW K

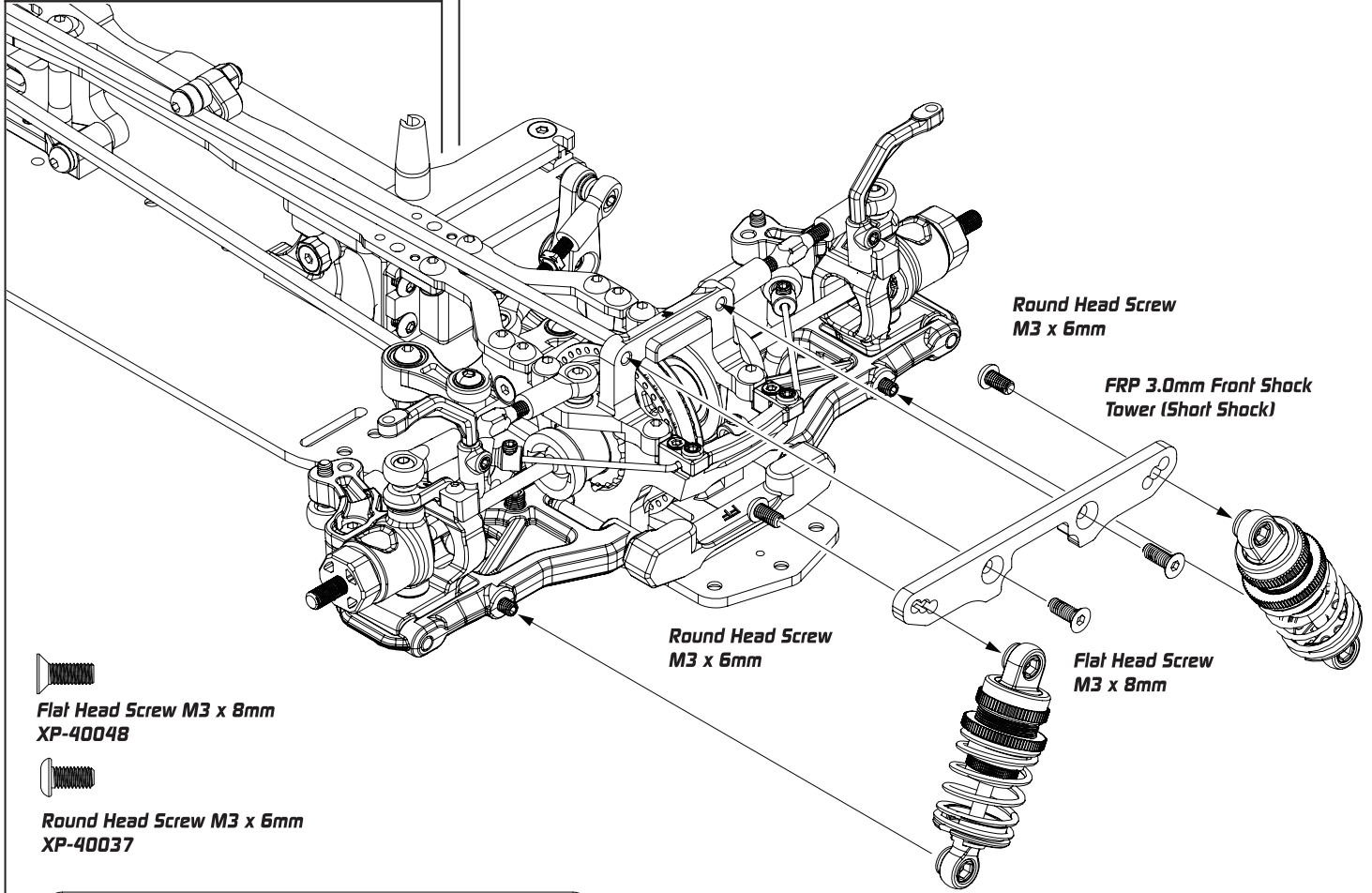

Flat Head Screw M3 x 8mm
XP-40048



Round Head Screw M3 x 6mm
XP-40037

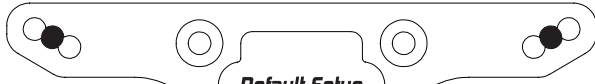

Default Setup

FRP 3.0mm Front Shock Tower (Short Shock)
XP-10791 Optional XP-10608

Prepare These Composite Battery Holder From Bag O

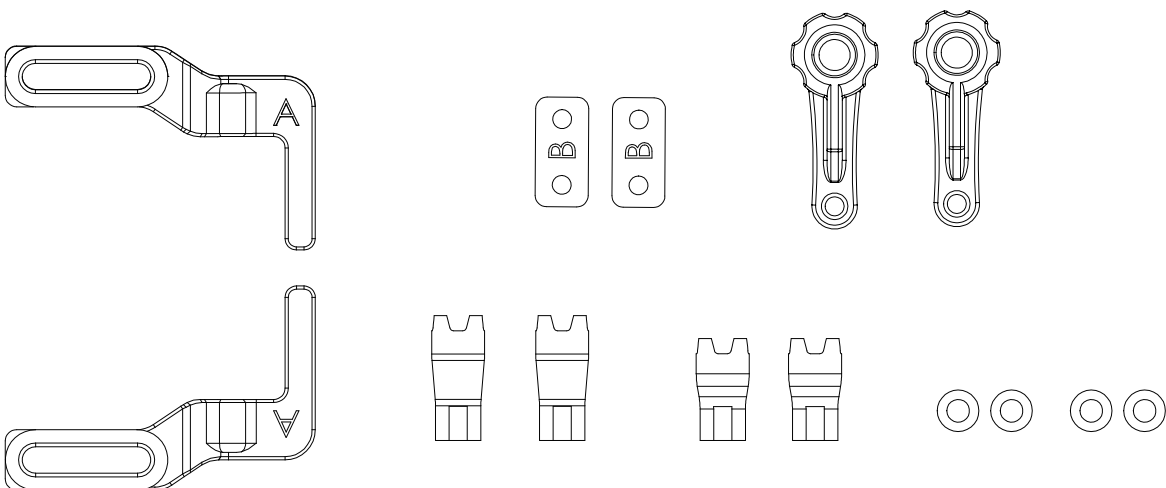

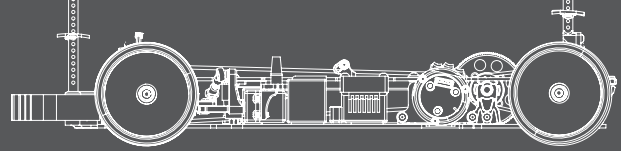

Bag O and HW K

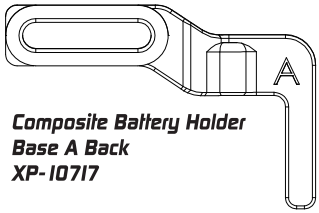

Composite Battery Holder Base A Back XP-10717

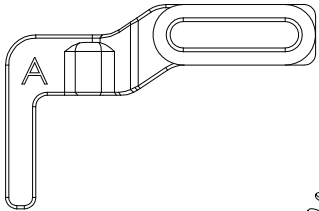

Composite Battery Holder Base A Front XP-10717



Composite Battery Adaptor B XP-10717



Hex Set Screw M3 x 4mm XP-40053

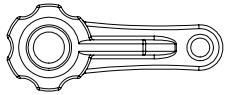

Composite Battery Holder XP-10717



Composite Battery Holder Post For Standard Battery XP-10717



Flat Head Screw M3 x 6mm XP-40046

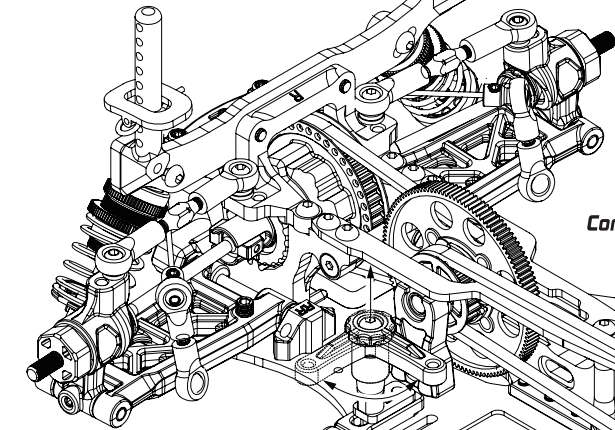

Composite Battery Holder Post For LCG Battery XP-10717



Battery Holder Spring XP-10717



Battery Holder Post XP-10717



Round Head Screw M3 x 12mm XP-40040



Flat Head Screw M3 x 8mm XP-40048



Flat Head Screw M3 x 14mm XP-40114

Note The Direction



Note The Direction

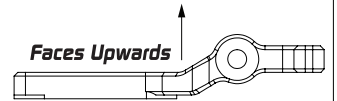

Composite Battery Adaptor B

Composite Battery Holder Base A Back

Faces Upwards

Composite Battery Adaptor B

Composite Battery Holder Base A Front

Flat Head Screw M3 x 6mm

Flat Head Screw M3 x 8mm

Flat Head Screw M3 x 14mm

Round Head Screw M3 x 12mm

Battery Holder Spring

Battery Holder Post

Flat Head Screw M3 x 8mm

Flat Head Screw M3 x 14mm

Composite Battery Holder

Composite Battery Holder Post For Standard Battery

Composite Battery Holder Post For LCG Battery

Hold Battery Hook For Easier Installation

Pre-thread Post For Easy Installation

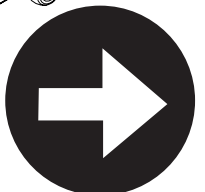

More Information On Next Page

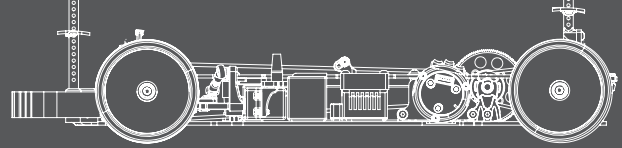

Screw Bag

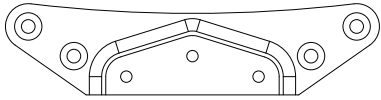

Lower Bumper
XP-10561

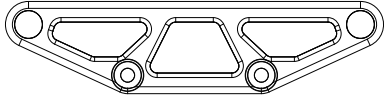

Bumper Plate For Light Bumper
XP-10561 Optional XP-10243, XP-10387

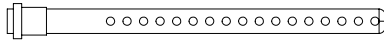

Front Body Post
XP-10561

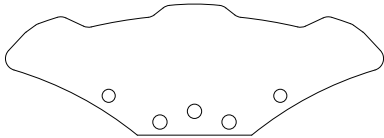

Foam Bumper Light
XP-10562

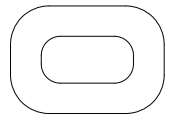

Body Height Adjuster Support
XP-10561

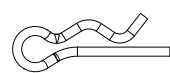

Body Clip
XP-10055



Flat Head Screw M3 x 10mm
XP-40049



Flat Head Screw M3 x 8mm
XP-40048

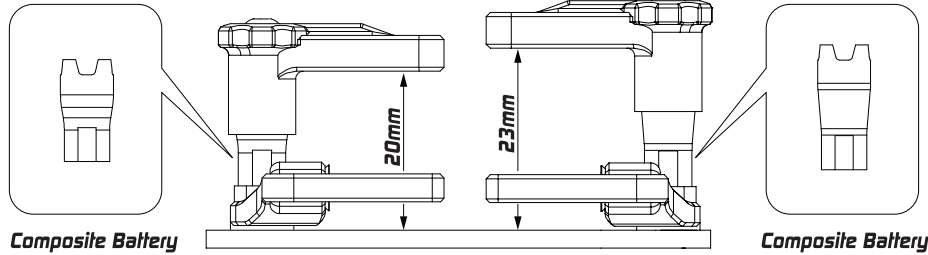
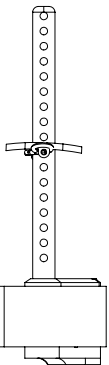

Composite Battery Holder Post For LCG Battery
XP-10717

Freely Adjust Height Of Post With Shims,
Change To a 16mm Screw If Needed

Composite Battery Holder Post For Standard Battery
XP-10717

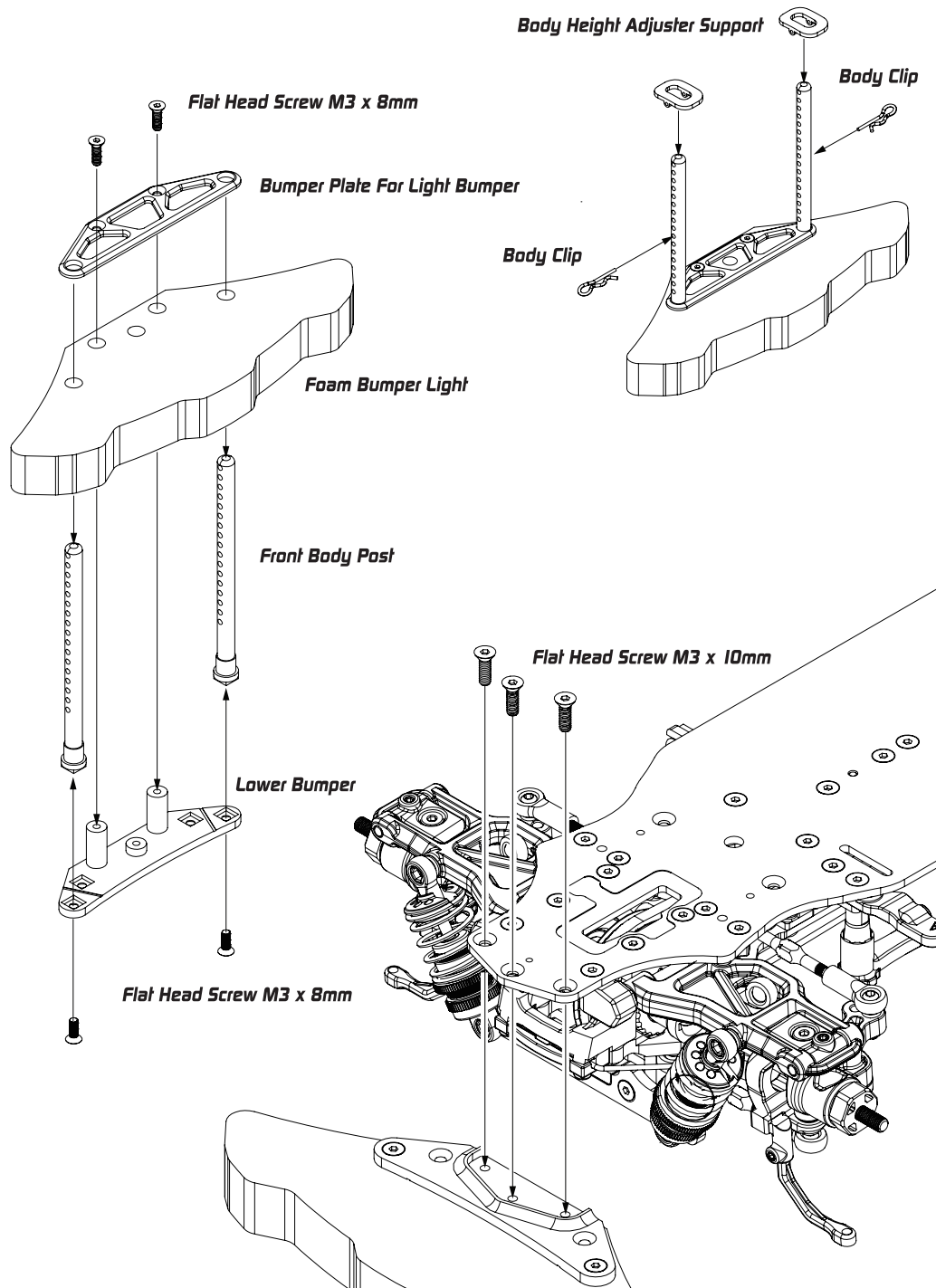

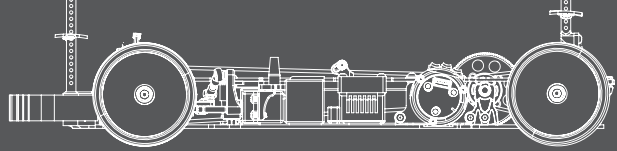

HW K



Lock Nut 7mm
XP-40068

[Receiver Not Included]

[ESC Not Included]

Round Head Screw M3 x 6mm

[Double Sided Tape Not Included]

[Pinion Not Included]

[Motor Not Included]



Round Head Screw M3 x 6mm
XP-40037

[Battery Not Included]

[Tires Not Included]

Lock Nut 7mm

Lock Nut 7mm

[Tires Not Included]

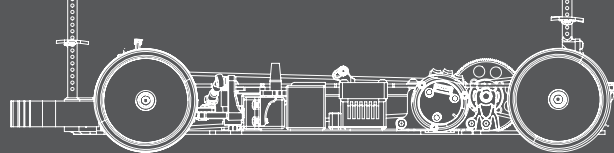

XQ2S Original Parts	
Model	Product Name
XP-10008	Gear Differential Case and Cover
XP-10009	Gear Differential Bevel Satellite Gears Set
XP-10011	Gear Differential Repair Parts
XP-10022	Gear Differential Set
XP-10052	Kevlar Drive Belt Rear 3 x 189 mm
XP-10053	Spur Gear 64P 116T
XP-10055	Body Clips 20pcs
XP-10107	Composite Ball Bearing Tension Adjustment Hub 4pcs
XP-10109	Composite Steering Block Pair
XP-10111	Aluminum Dual Servo Saver Arm 2pcs
XP-10113	Aluminum Steering Plate For Dual Servo Saver 4mm
XP-10121	5.5mm Pivot Ball 8pcs
XP-10128	Driveshaft Protector Blade 8pcs
XP-10139	3.0mm Suspension Pivot Pin 4pcs
XP-10147	Shock Membrane 8pcs
XP-10148	4.8mm Ball End 5mm Thread 10pcs
XP-10149	4.8mm Ball End 6mm Thread 10pcs
XP-10150	4.8mm Ball End 8mm Thread 10pcs
XP-10151	4.8mm Ball End 10mm Thread 10pcs
XP-10156	Steel Turnbuckle 29 mm 4pcs
XP-10157	Steel Steering Turnbuckle Set
XP-10159	Composite 1.1mm Piston Spacer Set
XP-10160	Shock O-RING 8pcs
XP-10163	Composite Servo Horn Belt Tensioner Set
XP-10169	Medium Spring Pair Silver 2pcs
XP-10179	Gear Differential Gasket 5pcs
XP-10181	Gear Differential Spacer 5x15.5x0.4mm 10pcs
XP-10182	Gear Differential Spacer 3.6x9.5x0.2mm 10pcs
XP-10183	Silicone Gear Differential O-RING 25x1mm 10pcs
XP-10184	Silicone Gear Differential O-RING 5x2mm 10pcs
XP-10227	FRP 2.5mm Chassis Plate
XP-10229	Composite Lower Bulkhead 2pcs
XP-10231	Composite Layshaft Bulkhead
XP-10236	4.8mm Ball End 5mm Thread 4pcs
XP-10237	4.8mm Ball End 6mm Thread 4pcs
XP-10238	4.8mm Ball End 8mm Thread 4pcs
XP-10239	4.8mm Ball End 10mm Thread 4pcs
XP-10244	Steel Universal Shaft 2pcs
XP-10251	4.8mm Flat Type Ball End 15mm 4pcs
XP-10252	4.8mm Flat Type Ball End 13mm 2pcs
XP-10253	4.8mm Flat Type Ball End 10mm 4pcs
XP-10254	4.8mm Low Profile Ball End Set
XP-10262	Composite Wheel Hub Set 4pcs
XP-10264	Composite Spool 38T Set
XP-10265	Composite Spool Cups 2pcs
XP-10284	Aluminum Solid Layshaft
XP-10288	Gear Diff Outdrive Adapter 2pcs
XP-10308	XQ1S Drive Belt Front 513mm
XP-10309	XQ1S Drive Belt Rear 189mm
XP-10336	Steel Turnbuckle 18mm 4pcs
XP-10396	Short Shock Composite Shock Part (Black)
XP-10397	Aluminum Upper Short Shock Cap 2pcs (Sport)
XP-10398	Aluminum Lower Short Shock Cap 2pcs (Sport)
XP-10399	Aluminum Short Shock Spring Tension Adjust Nut 2pcs (Sport)
XP-10400	Composite C Hub 4 Degree L/R (Strong V2)
XP-10401	C Hub King Pin Set 2+2 V2
XP-10561	Bumper Body Post (Foam Bumer LIGHT)
XP-10562	Foam Bumer Light
XP-10594	Aluminum Motor Mount Set V2
XP-10595	FRP 2.0mm Top Deck V2
XP-10596	Composite Short Shock Body 4pcs
XP-10602	3mm Outer Suspension pin w/ Groove 4pcs
XP-10603	Front And Rear Composite Suspension Arm (Strong)
XP-10607	O Ring For Spring Adjust Nut 4pcs (Short Shock)
XP-10689	Composite Rear Upright 2 PCS (Strong) V2
XP-10699	Front and Rear Composite One Piece Upper Clamp V2
XP-10717	Composite Anti Tweak Battery Holder
XP-10720	XQ1S Mid Pulley FRP 3.0mm Floating Servo Holder For XP-10690
XP-10724	Long Travel Short Shock Composite Shock Part
XP-10791	FRP 3.0mm Front Shock Tower (Short Shock)
XP-10792	FRP 3.0mm Rear Shock Tower (Short Shock)
XP-10797	Composite Short Shock Set 2pcs

XQ2S Option Parts	
Model	Product Name
XP-10104	Aluminum Front One Piece Upper Clamp
XP-10105	Front Camberlink Mount 2pcs
XP-10114	Aluminum FF Lower 1 Piece Suspension Mount
XP-10115	Aluminum One Piece Lower Bulkhead
XP-10116	Aluminum Layshaft Holder Bulkhead 2pcs
XP-10119	Aluminum Shim 3x5.5x1.0mm Red 20pcs
XP-10120	Aluminum Shim 3x5.5x2.0mm Red 20pcs
XP-10123	Aluminum 2 Piece Suspension Mount 2pcs
XP-10124	Aluminum RR Lower one Piece Suspension Mount
XP-10125	Aluminum Gear Diff Outdrive Adapter 2pcs
XP-10126	Steel Spool Outdrive Adapter 2pcs
XP-10127	Eccentric Bushing Set
XP-10129	Aluminum 5mm Wheel Hub Red 2pcs
XP-10130	Aluminum Rear One Piece Upper Clamp
XP-10131	Rear Camberlink Mount 2pcs
XP-10132	Kevlar Front Drive Belt 3 x 513 mm
XP-10133	Aluminum Solid Axle
XP-10134	Center Layshaft Pulley Set
XP-10136	Aluminum Servo Mount
XP-10166	Steel Double Joint Universal Shaft 2pcs
XP-10167	Steel Universal Shaft Rear 2pcs
XP-10168	Soft Spring Pair Black 2pcs
XP-10170	Stiff Spring Pair Pink 2pcs
XP-10175	Aluminum Solid Layshaft
XP-10186	Brass Chassis Balancing Weights 15g 10g 4pcs
XP-10187	Brass Chassis Centerline Balancing Weights 15g 25g 2pcs
XP-10191	Aluminum Rf One Piece Suspension Mount
XP-10192	Aluminum Adjustable Battery Stoppers
XP-10194	Aluminum FR One Piece Suspension Mount
XP-10196	Brass RF One Piece Suspension Mount
XP-10197	Brass FR One Piece Suspension Mount
XP-10198	Brass 2 Piece Suspension Mount
XP-10199	Brass FF 1 Piece Suspension Mount
XP-10200	Brass RR 1 Piece Suspension Mount
XP-10220	Camberlink Stiffener set
XP-10222	Graphite Option Steering Knuckle Plate 2pcs
XP-10224	Aluminum 5mm Ackermann Steering Plate For Dual Servo Saver
XP-10240	Aluminum Shim 3x5.5x1.0mm Red 10pcs
XP-10241	Aluminum Shim 3x5.5x2.0mm Red 10pcs
XP-10242	Brass Chassis Balancing Weights 10g 5g 4pcs
XP-10243	Graphite 2.25mm Upper Bumper Holder
XP-10255	Camber Stiffener Link Ball End
XP-10310	Aluminum Motor Fan Mount
XP-10320	Graphite Option Steering Knuckle plate (Less ackermann)
XP-10321	Vertical Topdeck Set
XP-10323	Anti-Roll Bar 1.2mm Front and Rear 2pcs
XP-10324	Anti-Roll Bar 1.3mm Front and Rear 2pcs
XP-10325	Anti-Roll Bar 1.4mm Front and Rear 2pcs
XP-10326	Aluminum Anti-Roll Bar Set
XP-10327	Aluminum Anti-Roll Bar Bushing Set
XP-10334	39.3mm Spring Steel Double Joint Universal Shaft 2pcs
XP-10365	Aluminum Wheel Adapter 6mm 2pcs
XP-10380	Graphite Body Post Stiffener Front and Rear
XP-10382	Graphite 2mm Vertical Topdeck Plates 2pcs For XP-10321
XP-10490	2.25mm Graphite Mid Motor Main Chassis Plate
XP-10491	2.0mm Graphite Mid Motor Upper Deck
XP-10492	Aluminum Mid Motor Mount
XP-10493	Aluminum Mid Motor Servo Mount
XP-10494	Aluminum Steering Post For Dual Servo Saver 11.5mm 2pcs
XP-10496	Kevlar Drive Belt 3 x 351mm
XP-10556	Steel Spool Outdrive Adapter 2pcs
XP-10565	Composite Suspension Parts Set (Hard Strong)
XP-10566	Upper Deck Stiffener
XP-10593	Long Travel Short Shock Set 2pcs
XP-10597	Front And Rear Composite Suspension Arm (Strong Hard)
XP-10600	Silicone Gear Differential X-RING 5x2mm 10pcs
XP-10601	Shock X-Ring 10pcs
XP-10608	Graphite 3.0mm Front Shock Tower (Short Shock)
XP-10609	Graphite 3.0mm Rear Shock Tower (Short Shock)
XP-10610	XQ1 XQ1S Double Joint Universal Shaft Bone
XP-10611	XQ1 XQ1S Double Joint Universal Shaft Axle
XP-10612	XQ1 XQ1S Double Joint Universal Shaft Case
XP-10613	XQ1 XQ1S Double Joint Universal Shaft Coupling Pins
XP-10621	Composite Rear Upright 2 PCS (Strong Hard) V2
XP-10622	Steel Spool Outdrive Adapter 3.5mm 2pcs
XP-10623	Aluminum Mid Motor Mount V2
XP-10624	2.0mm Graphite Mid Motor Upper Deck V2
XP-10625	XQ1 Mid Motor Conversion Kit V2
XP-10626	White Kevlar Low Friction White Belt 3x189mm
XP-10627	White Kevlar Low Friction White Belt 3x513mm
XP-10634	Grey Composite 4.8mm Flat Type Ball End 10mm 4pcs
XP-10635	Grey Composite 4.8mm Flat Type Ball End 13mm 4pcs
XP-10636	Grey Composite 4.8mm Flat Type Ball End 15mm 4pcs
XP-10637	XQ10 Aluminum FR One Piece Suspension Mount
XP-10638	XQ10 Brass FR One Piece Suspension Mount
XP-10641	On-power Control System V2
XP-10643	Composite Upper Deck Stiffener 2pcs
XP-10645	Kevlar Low Friction Belt 3x189mm

XQ2S Option Parts	
Model	Product Name
XP-10646	Kevlar Low Friction Belt 3x513mm
XP-10654	Anti Tweak Battery Holder
XP-10680	Aluminum Ball Bearing Tension Adjustment Hub 2pcs
XP-10683	XQ10 Aluminum Upper Deck Collar For Flex Elimination
XP-10684	Hard Composite On-power Control System Suspension Arm (Strong)
XP-10685	On-power Control System 0 Deg Aluminum C-hub 2pcs
XP-10725	Long Travel Aluminum Short Shock Body 2pcs
XP-10726	Lower Suspension Mount Spacer 0.5mm
XP-10735	Composite Anti-Roll Bar Ball Joint 4pcs (Black)
XP-10810	Composite C Hub 4 Degree L/R (Strong Hard) V2
XP-10811	Aluminum 2 Piece Suspension Mount 2pcs (+0.75)
XP-10812	Aluminum RR Lower one Piece Suspension Mount (+0.75)
XP-10819	Body Support Brace
XP-10820	Graphite 2.0mm Top Deck V2

Driver _____ Track Surface _____ Track Temperature _____
 Date _____ Track Traction _____ Result _____ Air Temperature _____
 Track _____ Country _____ Best Lap _____ Humidity _____ Remark _____

Front

Spacer mm
3 2 1
Spacer mm
Spacer mm
Spacer mm
5.2 5.0 4.8 4.6 4.4 4.2 4
4 4.2 4.4 4.6 4.8 5.0 5

C-Hub	Hex Offset	mm	mm
<input type="checkbox"/> M <input type="checkbox"/> H	Camber		
Steering Block	Ride Height	mm	mm
<input type="checkbox"/> M <input type="checkbox"/> H	DownStop	mm	mm
Suspension Arm	Sway Bar	mm	mm
<input type="checkbox"/> M <input type="checkbox"/> H			

Rear

Spacer mm
Spacer mm
4 4.2 4.4 4.6 4.8 5.0 5

Rear Hub	<input type="checkbox"/> M <input type="checkbox"/> H
Suspension Arm	<input type="checkbox"/> M <input type="checkbox"/> H

Optional On-Power Control System

Spacer mm
Spacer mm
Spacer mm
Spacer mm

Hex Offset	mm
Camber	
Ride Height	mm
DownStop	mm
Sway Bar	mm

Steering Block	<input type="checkbox"/> M <input type="checkbox"/> H
Suspension Arm	<input type="checkbox"/> M <input type="checkbox"/> H

Front Toe Out Front Tire Additive Area

Lower Arm Spacer mm
Wheelbase Spacer
FF mm
FR mm

Bump Steering Spacer mm
Shock Tower Spacer mm
Weight g

Flex Control

<input type="checkbox"/> Aluminum	<input type="checkbox"/> Wheelbase Spacer
<input type="checkbox"/> Composite	RF mm
<input type="checkbox"/> Composite (2 Dot)	RR mm
<input type="checkbox"/> Bearing	

Rear Toe In Rear Tire Additive Area

Lower Arm Spacer mm
Shock Tower Spacer mm
Weight g

Suspension Mount Setup

FF

<input type="checkbox"/> 1 <input type="checkbox"/> Aluminium	<input type="checkbox"/> Spill
<input type="checkbox"/> 0.5 <input type="checkbox"/> Brass	<input type="checkbox"/> Solid

FR

<input type="checkbox"/> 1 <input type="checkbox"/> Aluminium	<input type="checkbox"/> Spill
<input type="checkbox"/> 0.5 <input type="checkbox"/> Brass	<input type="checkbox"/> Solid

RR

<input type="checkbox"/> 1 <input type="checkbox"/> Aluminium	<input type="checkbox"/> Spill
<input type="checkbox"/> 0.5 <input type="checkbox"/> Brass	<input type="checkbox"/> Solid

RF

<input type="checkbox"/> 1 <input type="checkbox"/> Aluminium	<input type="checkbox"/> Spill
<input type="checkbox"/> 0.5 <input type="checkbox"/> Brass	<input type="checkbox"/> Solid

Flex Control

Damper Setup

Front	Rear
Spring _____	Spring _____
Oil _____	Oil _____
Rebound _____	Rebound _____
Piston _____	Piston _____
Length _____	Length _____
Foam Insert <input type="checkbox"/>	Foam Insert <input type="checkbox"/>
Hole In Cap <input type="checkbox"/>	Hole In Cap <input type="checkbox"/>

Transmission Setup

Front	Rear
Oil _____	Gear Diff _____
Weight _____ g	Oil _____
Position _____	Weight _____ g
	Position _____

Others

Servo _____ Tires _____
 Esc _____ Additive _____
 Motor _____ Body _____
 Spur P/ T Rear Wing _____
 Pinon P/ T FDR _____

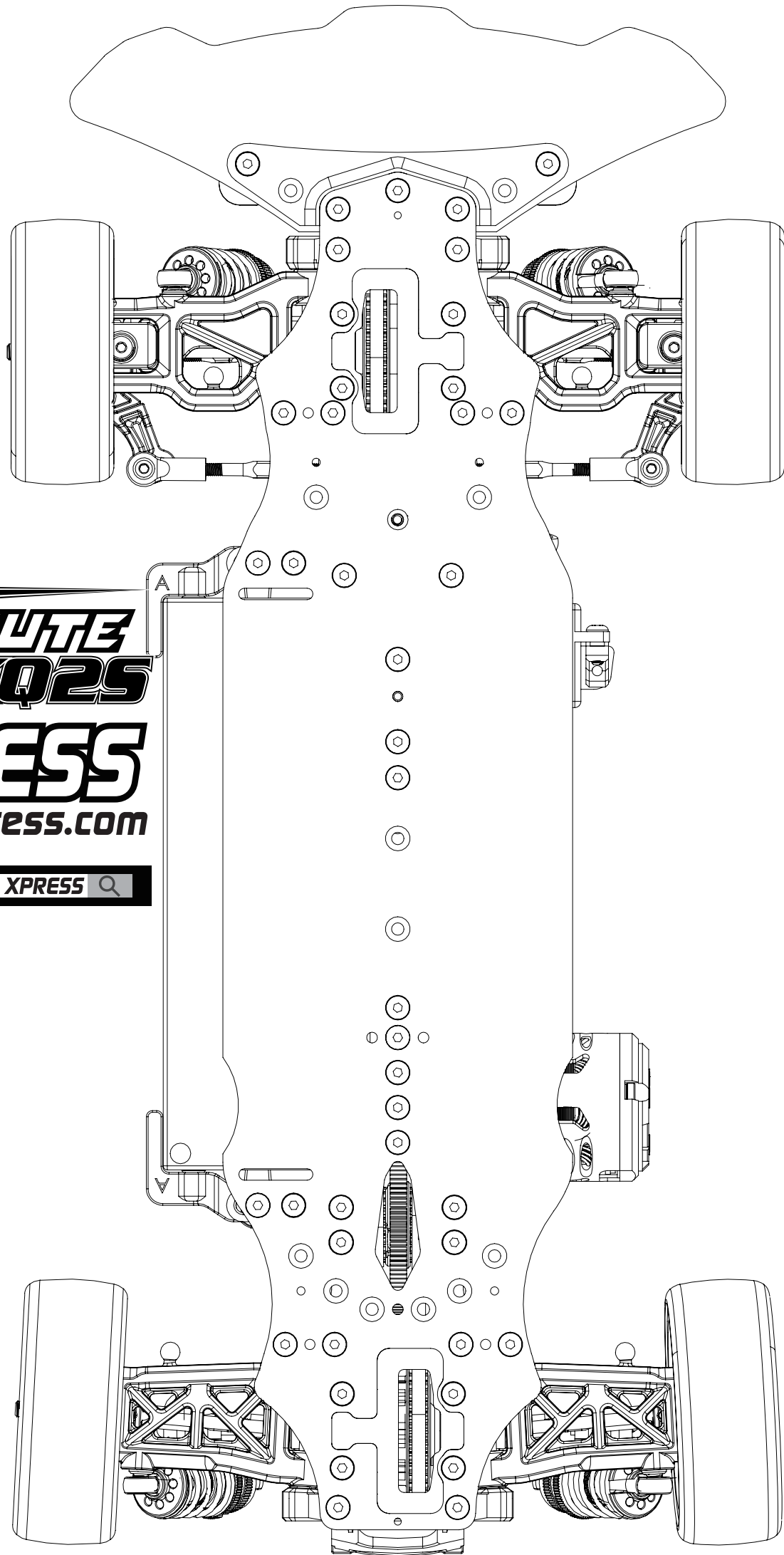

EXECUTE
1/10 SPORT TOURING CAR **XQ25**

XPRESS
www.rc-xpress.com



RC XPRESS 🔍