

TRF 419 WORLD CHAMPION TEAM

TAMIYA RACING FACTORY

SETTING SHEET

Name **Ed Clark** Date **22 Feb 2015** Air temp. **23°C** Humidity **65+%**

Track **Logan - Outdoor Asphalt** Track condition **Variable grip due to weather** Track temp. **28°C**

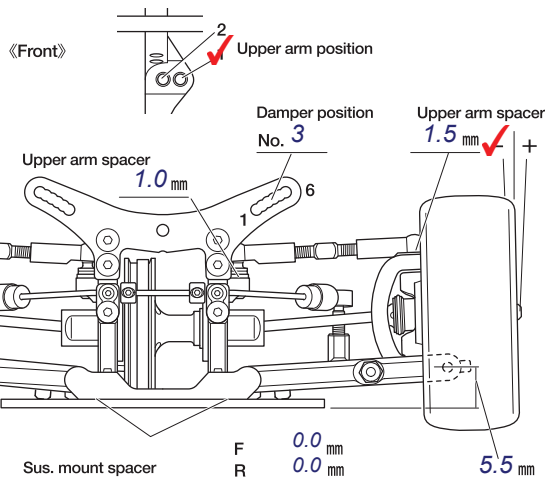

Front axle	4°
Camber angle	-1.5°
Ground clearance	5.4 mm
Rebound stroke	3.0 mm
Stabilizer	1.3 (Black)
Wheel spacer	0.5 mm
Front drive	Spool
Differential oil	# %

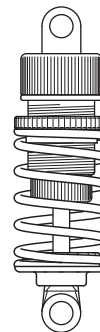

Damper type	419
Piston	3 x 1.1mm hole(s)
Oil	MuchMore 450 #
Spring	HPI Silver

Double O-ring in shock bottom
Inner Link H5 Ballstud

Memo

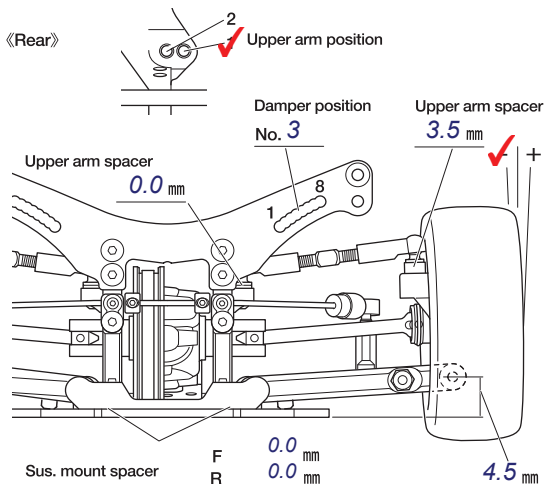

Rear upright	416 / <input checked="" type="checkbox"/> 8
Camber angle	-2.0°
Ground clearance	5.6 mm
Rebound stroke	3.0 mm
Stabilizer	1.2 (Black)
Wheel spacer	0.5 mm
Rear drive	Gear Diff
Differential oil	MuchMore 3000

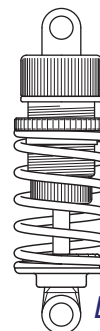

Damper type	419
Piston	3 x 1.1mm hole(s)
Oil	MuchMore 450 #
Spring	HPI Silver

Double O-ring in shock bottom
Inner Link H5 Ballstud
Outer Link Std Ballstud

Memo

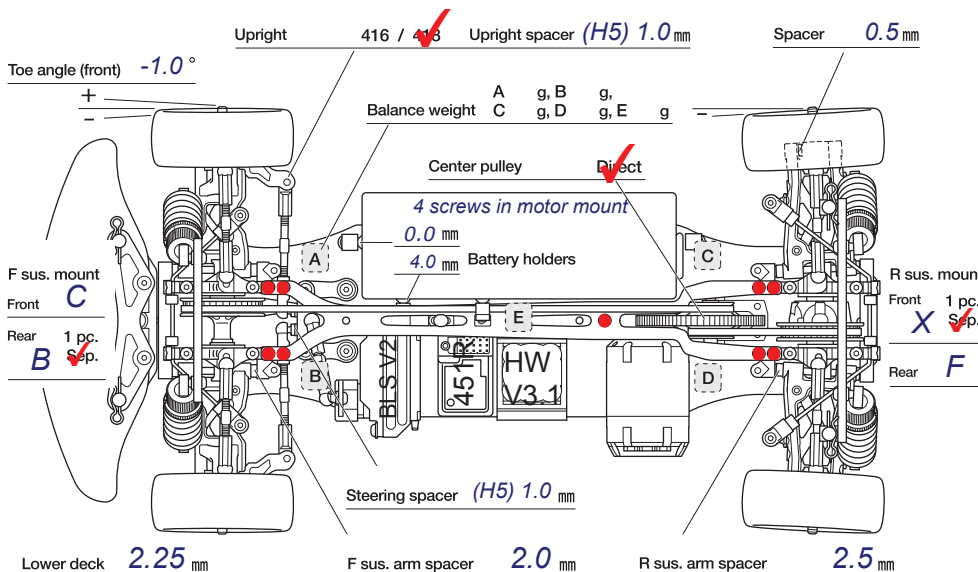

Motor	HW V10 4.5t
Spur	86 _T
Pinion	20 _T
Pitch	48
Battery	ProAmps 6000 / g
Body	LTC-R
Wing	Yokomo stiff
Tire	Rush 36X
Wheel	MuchMore
Tire insert	MuchMore Yellow
Best lap	21.4s