

Driver: _____ Track: _____ Event: _____
 Date: _____ Qualifying: _____ Final: _____ Best Lap: _____

TRACK TYPE

Grip Level High Medium Low
 Type Tight Open Mixed
 Condition Flat Bumpy
 Surface Asphalt Carpet
 Track Temp _____ °C
 Weather _____

TYRES

Side Wall Glue Height Ø _____ mm

Tyres _____
 Cleaner _____
 Additive _____
 Additive Time Front: _____ mins Rear: _____ mins
 Heating Time Front: _____ mins Rear: _____ mins
 Heating Temp Front: _____ °C Rear: _____ °C

FRONT

KEY: CF = Carbon Fibre, AL = Aluminium, P = Plastic, F = Front, R = Rear
 H = High, L = Low, Y = Yes, N = No, V = Vertical, H = Horizontal

Ride Height _____ mm
 Droop _____ mm
 Camber _____ deg
 Toe _____ deg
 Anti Roll Bar 1.1 1.2 1.3 1.4
 Servo Horn Height _____ mm Saver
 Steering Travel _____ in _____ out
 Diff Height ↑ ↓
 Diff Oil _____ cSt

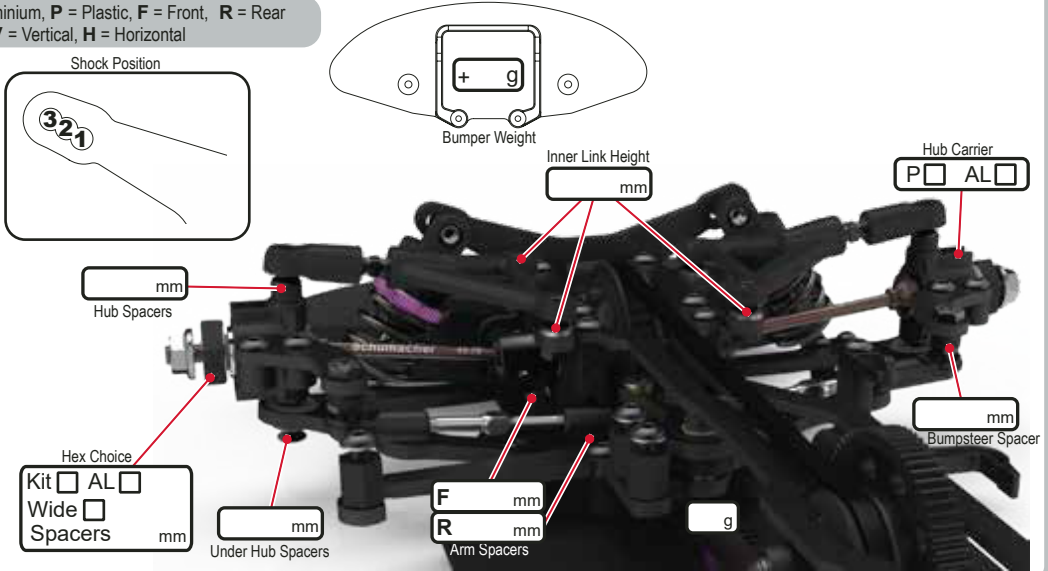



REAR

KEY: CF = Carbon Fibre, AL = Aluminium, P = Plastic, Ti = Titanium, F = Front, R = Rear
 H = High, L = Low, Y = Yes, N = No, V = Vertical, H = Horizontal

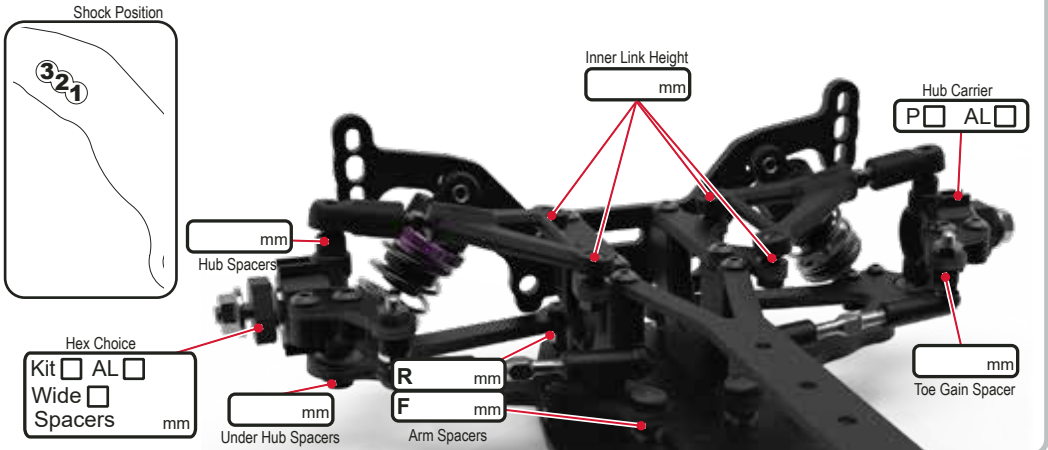
Ride Height _____ mm
 Droop _____ mm
 Camber _____ deg
 Toe _____ deg
 Anti Roll Bar 1.1 1.2 1.3 1.4



BODYSHELL

Body _____
 Wing _____
 Wing Height _____ mm
 Splitter Height _____ mm
 Body Weight _____ g
 Body Offset Fwrd _____ mm
 Wing Offset Rwrd _____ mm
 Wing End Plates
 Front Post 1dot 2dot 3dot Pin Hole 
 Rear Post 1dot 2dot 3dot Pin Hole 

CHASSIS

PTFE Tape
 Total Weight _____ g
 Weight Distribution Forwards _____ %
 Wheelbase Options Short Long
 ESC Location Bumper Middle

ELECTRONICS

E.S.C. _____ + g
 Servo _____
 Receiver _____ + g
 Battery _____ + g
 Motor _____ Spacers _____ mm
 Rotor Dia. _____ mm
 Timing _____ deg
 Pinion _____ t
 Spur _____ t
 Ratio _____

SHOCKS

KEY: x = Stroke, e = external
 V = Vented (Drilled), S = Sealed

	FRONT		REAR	
Cap Type	V <input type="checkbox"/>	S <input type="checkbox"/>	V <input type="checkbox"/>	S <input type="checkbox"/>
Oil	_____ cSt		_____ cSt	
Piston	_____			
Spring	_____			
Length (x)	_____ mm		_____ mm	
Rebound	_____ mm		_____ mm	
Limiters (e)	_____ mm		_____ mm	