

<b>DRIVER</b>	<i>Robert Pietsch</i>		
<b>DATE</b>	<i>08.11.2021</i>		
<b>TRACK</b>	Carpet <input type="radio"/>	Asphalt <input checked="" type="radio"/>	
<b>TRACTION</b>	LOW <input type="radio"/>	MEDIUM <input checked="" type="radio"/>	HIGH <input type="radio"/>
<b>LAYOUT</b>	SLOW <input type="radio"/>	MIXED <input checked="" type="radio"/>	FAST <input type="radio"/>
<b>TEMP °C</b>	<b>AIR</b> <i>15-20</i>	<b>TRACK</b>	
<b>ELECTRONICS</b>			
ESC	<i>LRP</i>	ESC SET <i>stock setting</i>	MOTOR <i>13.5</i>
SERVO	<i>Sanwa</i>	RECEIVER <i>Sanwa</i>	BATTERY <i>LRP6100</i>
<b>TIRES</b>			
<b>BRAND</b>	<i>Volante</i>		
<b>TYPE</b>	<i>28R</i>		
<b>ADDITIVE</b>	<i>MR33</i>		
<b>WARMER °C</b>	FRONT	REAR	
<b>TIME(min)</b>	FRONT <i>10</i>	REAR <i>10</i>	
<b>SHOCK ABSORBERS</b>			
<b>PISTON</b>	FRONT <i>std</i>	REAR <i>std</i>	
<b>SHOCK CASE</b>	<i>std</i>	<i>std</i>	
<b>OIL</b>	<i>350</i>	<i>350</i>	
<b>SPRING</b>	<i>7.0P</i>	<i>6.5</i>	
<b>LENGTH</b>	<i>9.5</i>	<i>9.5</i>	<i>9.5</i>
<b>ANTI ROLL BAR DIAMETER FRONT/REAR</b>			
<b>FRONT</b>	<i>1.1</i>	<b>REAR</b>	<i>1.0</i>
<b>REAR DIFFERENTIAL</b>			
<b>DIFF OIL CST (1,6g oil qty.)</b>	<i>10000</i>		
<b>GEAR RATIO</b> (T)Spur/(T)Pinion*1,9=Ratio			
<b>PINION</b>	<i>38</i>	<b>SPUR</b>	<i>100</i>
<b>AERODYNAMIC SETTINGS</b>			
<b>BODY TYPE</b>	<i>Wolverine</i>		
<b>WING TYPE</b>	<i>original</i>		
<b>WING POS</b>	(mm)	<i>std.</i>	
<b>BODY POSITION</b> (see picture below)	(mm)	<i>50</i>	
<b>FRONT BODY HEIGHT &amp; POSITION</b>		<b>REAR BODY POST A2407C</b> <input checked="" type="radio"/>	<b>REAR BODY POST A2416B</b> <input type="radio"/>
(mm) vertical	<i>46</i>	(mm)	<i>45</i>

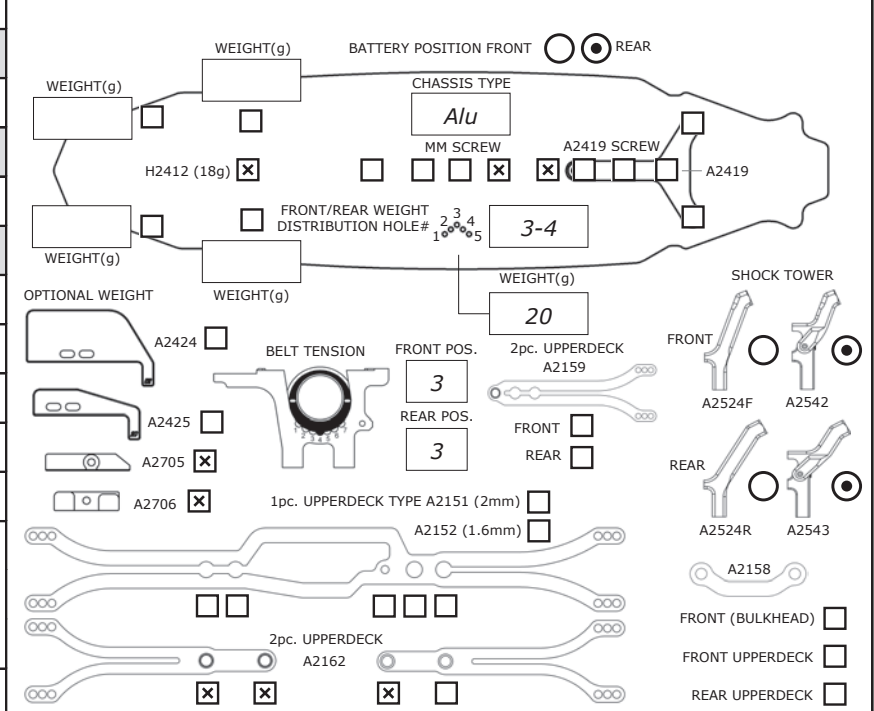
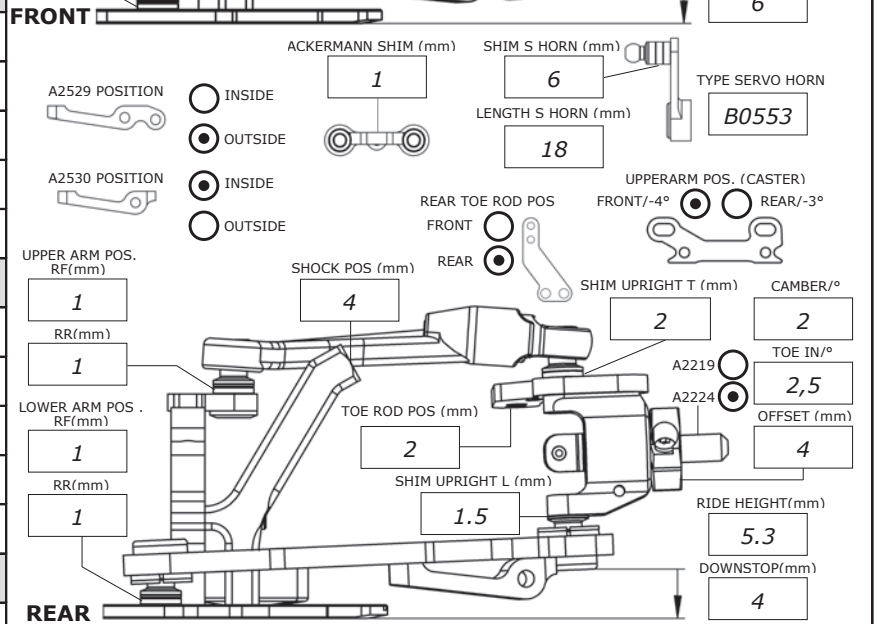
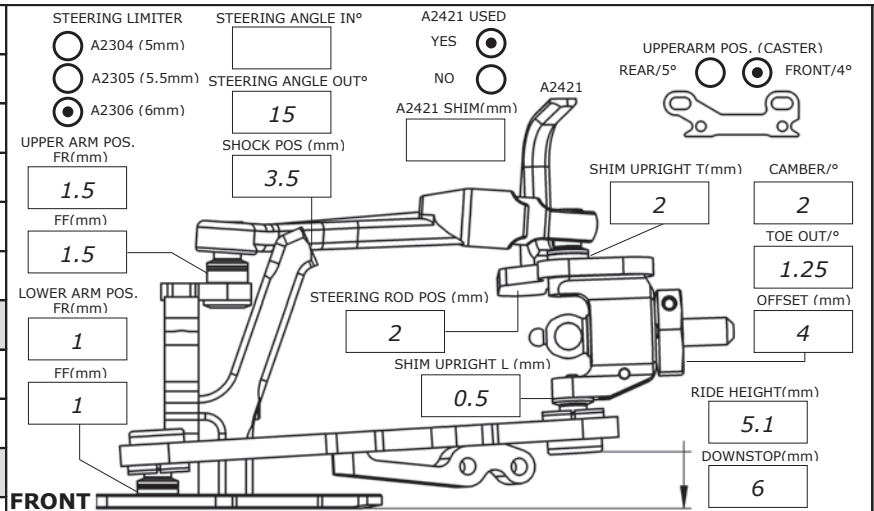

REMARKS  
 A2407D used under Rear body post + 1,5mm below A2420  
 A2427 body stopper instead of A2421 (A2427=-1,5mm)