

Name **Teemu Leino** Date **07/28/2012** Event **2012 IFMAR ISTC** Temp Air Track _____
 Track **MACH Heemstede** Track Condition Indoor Tight Smooth Wet Low Bite High Bite
Outdoor Open Rough Dusty Med Bite Other

Front

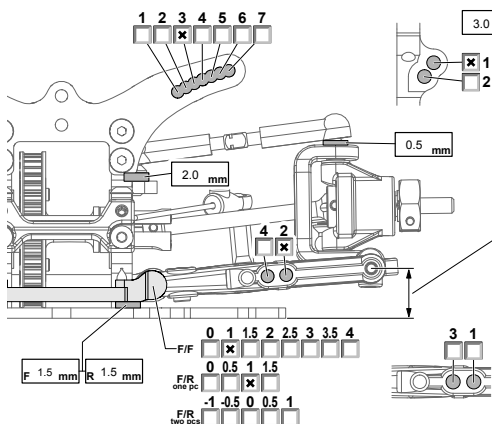

Ride Height 4.8 mm
 Camber Angle 1.5 °
 Droop 8.5 mm Sway bar 1.2 mm
 Toe Angle out 1 ° Caster Angle 4 °
 Wheel Spacer 0 mm Wheel Hub 5 mm

Shocks

	Front	Rear
Piston	1.3mm x 6	1.3mm x 6
Oil wt.	#1900	#1900
Bladder	STD	STD
Spring	Ride Yellow	Ride Yellow
Shock Length	64.0 mm	64.0 mm

Rear

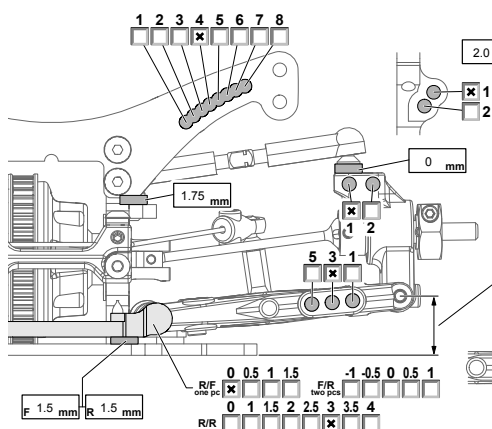

Ride Height 5.0 mm
 Camber Angle 1.5 °
 Droop 5.5 mm
 Sway bar 1.2 (wide) mm
 Wheel Spacer 0 mm Wheel Hub 5 mm

Tires

	Front	Rear
Brand	Sorex	Sorex
Compound	36R	36R
Insert	Schumacher	Schumacher
Wheel	Schumacher	Schumacher
Tire Treatment	None	None

Chassis

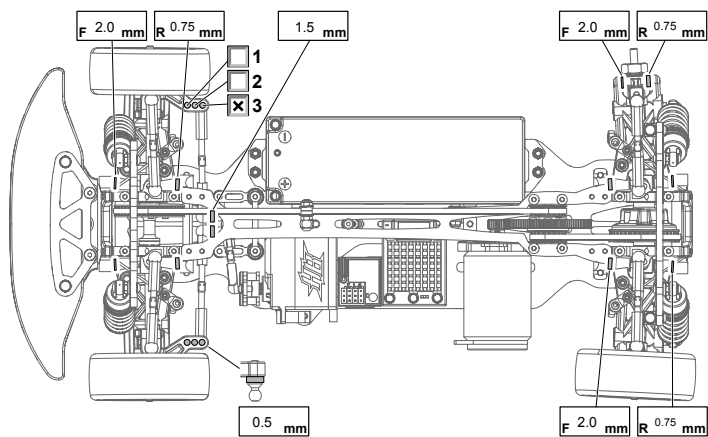

2.25mm Option chassis (no cutout) used. Tamiya Rear hubs used.

Note

Diff

	Front	Rear
Type	Spool	Gear Diff
Note	P.O.M Cup	#2000 diff oil

Motor

Motor	LRP 4.5T	Spur Gear	115
Battery	LRP	Pinion Gear	25
Body	PF LTC-R	ESC	LRP
Wing	Ride 27006	Note	