

Name **Andy Moore**

Date **07/28/2012**

Event **2012 IFMAR WC**

Temp **Air 26 Track 38**

Track **MACH Heemstede**

Track Condition

Indoor  Tight  Smooth  Wet  Low Bite  High Bite  
 Outdoor  Open  Rough  Dusty  Med Bite  Other

## Front

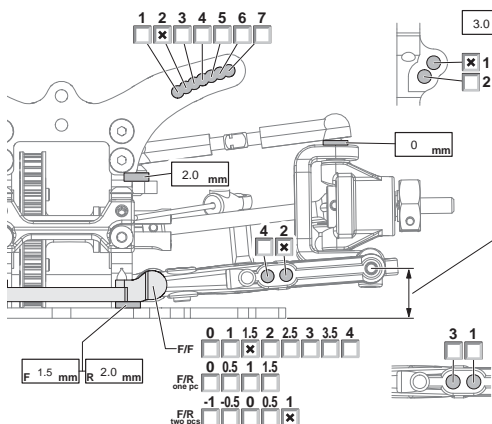

Ride Height 4.8 mm

Camber Angle 1.5 °

Droop 9.0 mm Sway bar 1.3 mm

Toe Angle out 0.5 ° Caster Angle 4 °

Wheel Spacer 0.5 mm Wheel Hub 4 mm

F/F	0	1	1.5	2	2.5	3	3.5	4
F/R one pc	0	0.5	1	1.5				
F/R two pc	-1	-0.5	0	0.5	1			

## Shocks

Front \_\_\_\_\_ Rear \_\_\_\_\_

Piston 6x1.3mm 6x1.3mm

Oil wt. 2000 mixed with 1300 2000 mixed with 1300

Bladder STD STD

Spring 6543\_silver 6543\_silver

Shock Length 62.0 mm 62.5 mm

## Rear

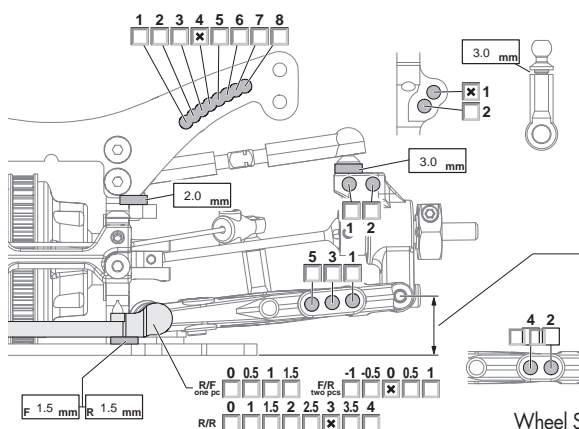

Ride Height 5.2 mm

Camber Angle 2 °

Droop 8.25 mm

Sway bar 1.2 mm

Wheel Spacer 0 mm Wheel Hub 5 mm

R/F one pc	0	0.5	1	1.5				
F/R two pc	-1	-0.5	0	0.5	1			
R/R	0	1	1.5	2	2.5	3	3.5	4

## Tires

Front \_\_\_\_\_ Rear \_\_\_\_\_

Brand Sorex Sorex

Compound 36R 36R

Insert Spec Spec

Wheel Spec Spec

Tire Treatment none none

## Chassis

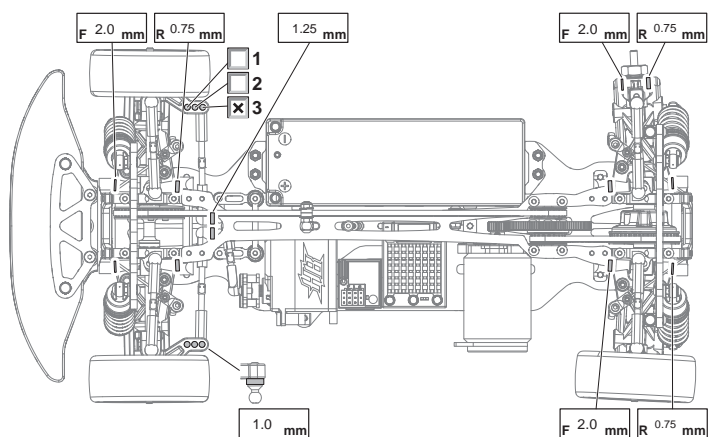

Tamiya rear hub. OP 2.25mm main chassis.

Note

## Diff

Front \_\_\_\_\_ Rear \_\_\_\_\_

Type Spool Gear

Note P.O.M outrives #2000

## Motor

Motor Reedy Spur Gear 115

Battery Reedy Pinion Gear 28

Body PF LTC-R ESC HW V3

Wing Ride Note