

# TC10/3

## 1/10 EP TOURING CAR CHASSIS

Sheet Ver.1.1

DRIVER: Kazuma Murai

DATE: 2024.8.22

RACE: Open Class Setup

TRACK: GPSW

PLACE: ☐ Indoor ☒ Outdoor ☒ Asphalt ☐ Carpet / ☐ Flat ☒ Bump

TRACTION: ☐ High ☐ Medium ☒ Low TEMP AIR: 35°C TEMP TRACK: 56 °C

TRACK LAYOUT: ☐ Technical ☒ Mixed ☐ High speed

QF POSITION:

FINAL POSITION:

BEST LAPTIME:

FRONT

### Damper Stay

SCREW: ☐ Alu ☒ Ti ☐ SPS(Steel)  
8mm  
SHIM: 1.5mm

### Bulkhead Stiffener

Graphite ☐ NONE ☐ 1mm ☒ 2mm

Ride Height : 5.2mm

Droop :

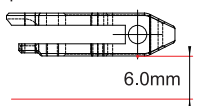

Toe Angle : Out 1.2°

Camber Angle : 2.0°

Anti Roll Bar : ☐ 1.2 ☒ 1.3

### Front Suspension

#### ALU Body Stopper



☐ C-clip ☒ Oring

FF: SUS 1.0mm

FR: SUS 1.0mm

#### Lower arm Alu plate:

☒ Upper ☐ Lower

REAR

### Damper Stay

☒ Std  
☐ Wide  
SCREW: ☐ Alu ☒ Ti ☐ SPS(Steel)  
8 mm  
SHIM: 1.2 mm

Ride Height : 5.8 mm

Droop :

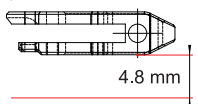

Toe Angle : In 2.5°

Camber Angle : 2.2°

Anti Roll Bar : ☐ 1.2 ☒ 1.3

### Gear Diff Oil

AXON 6000 cst 1.4 g

### Rear Suspension

☐ C-clip ☒ Oring

RF: SUS 1.2 mm

RR: SUS 1.0 mm

#### Lower arm Alu plate:

☒ Upper ☒ Lower

### Bell Crank

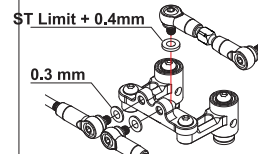

Wheel Hubs ☐ 3.5 ☒ 4.0

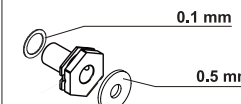

### Caster Block

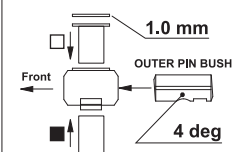

### Servo Horn Ball Position

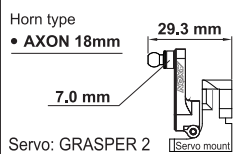

### SHOCK ABSORBER

Spring: HLS SS c2.7

Oil : AXON 32.5wt

Piston : ☐ 3H ☒ 4H

Hole : std 1.1 mm

Bladder : ☐ V1 ☒ V2

Shock cap Hole : 1.0 mm

Length : 7.2 mm

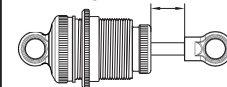

### Motor Mount

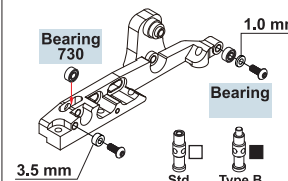

Wheel Hubs ☐ 3.5 ☒ 4.0

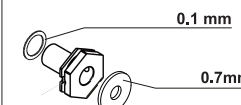

### Caster Block

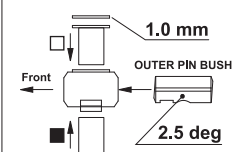

### SHOCK ABSORBER

Spring: HLS SS c2.75

Oil : AXON 32.5wt

Piston : ☐ 3H ☒ 4H

Hole : std 1.1 mm

Bladder : ☐ V1 ☒ V2

Shock cap Hole : 1.0 mm

Length : 8.6 mm

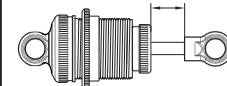

### Rear Body Mount Stay



### Rear Bulkhead Stiffener

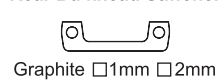

### Battery Mount

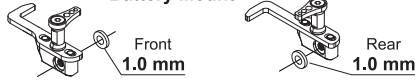

### <<Balance Weight Setting>>

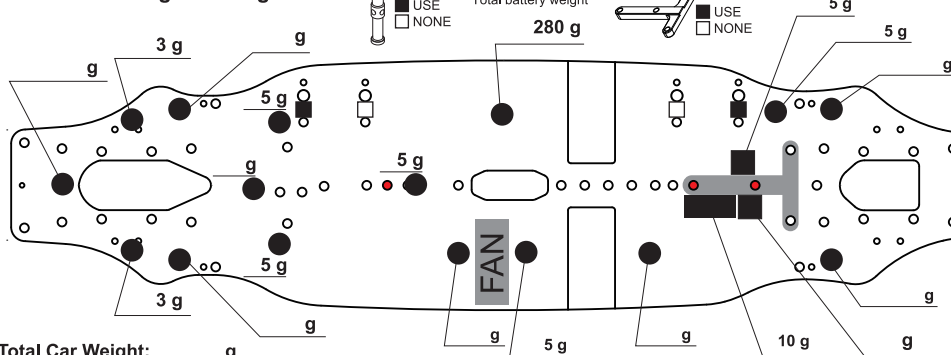

Total Car Weight: g

Main Chassis: ☐ Carbon 2.25mm ☒ Alu 2.0mm

Top Deck: ☐ Carbon 2.0mm ☒ Carbon 2.25mm

Motor: HW 17.5T

Spur Gear: 108T Pinion Gear: 35T

Battery: Fido 5900

ESC: HW

Body: ETREME TWISTER SP UL

Wing: TWISTER

### FRONT

Tire: Control Tire

Insert:

Wheel:

Additive: Yellow V3

Notes: 5min

### REAR

Tire: Control Tire

Insert:

Wheel:

Additive: Yellow V3

Notes: 5min

### Screw setting <<Button Head>>

Top deck : 8pcs	6mm	<input checked="" type="checkbox"/> Alu <input type="checkbox"/> Ti <input type="checkbox"/> Steel
Upper bulkhead : FF 2pcs:	8mm	<input type="checkbox"/> Alu <input checked="" type="checkbox"/> Ti <input type="checkbox"/> Steel
Upper bulkhead : FR 2pcs:	6mm	<input type="checkbox"/> Alu <input checked="" type="checkbox"/> Ti <input type="checkbox"/> Steel
Upper bulkhead : RF 2pcs:	6mm	<input type="checkbox"/> Alu <input checked="" type="checkbox"/> Ti <input type="checkbox"/> Steel
Upper bulkhead : RR 2pcs:	8mm	<input type="checkbox"/> Alu <input checked="" type="checkbox"/> Ti <input type="checkbox"/> Steel
Front Damper stay 4pcs:	5mm	<input type="checkbox"/> Alu <input checked="" type="checkbox"/> Ti <input type="checkbox"/> Steel
Rear Damper stay 4pcs:	5mm	<input type="checkbox"/> Alu <input checked="" type="checkbox"/> Ti <input type="checkbox"/> Steel

### Screw setting <<Flat Head>>

Lower bulkhead 8pcs:	6mm	<input type="checkbox"/> Alu <input checked="" type="checkbox"/> Ti <input type="checkbox"/> Steel
Sus-balls ALL:	6mm	<input type="checkbox"/> Alu <input checked="" type="checkbox"/> Ti <input type="checkbox"/> Steel
Bell crank post:	6mm	<input type="checkbox"/> Alu <input checked="" type="checkbox"/> Ti <input type="checkbox"/> Steel
Servo mount:	6mm	<input type="checkbox"/> Alu <input checked="" type="checkbox"/> Ti <input type="checkbox"/> Steel
Motor mount:	6mm	<input type="checkbox"/> Alu <input checked="" type="checkbox"/> Ti <input type="checkbox"/> Steel

### Notes :

- X10 ball bearings are used
- Axon spring titanium screws are used
- Kingpin screws are optional titanium M4 screws are used
- 6mm BALL BUSH ORING is used
- FRONT ROLL POST & REAR ROLL POST / Type B are used
- Alu Body Stopper is used
- Rear T Brace is used