

NAME **Michael Hanulec**  
 COUNTRY **USA**  
 RACE **Season Opener**  
 TRACK **Jackson RC**

DATE **1 May 2021** TEMP. °C AIR / TRACK **65 / 70**  
 ASPHALT  OUTDOOR  INDOOR  CARPET   
 TRACK CONDITION TECHNICAL  MIXED  FAST   
 TRACTION LOW  MEDIUM  HIGH

### FRONT

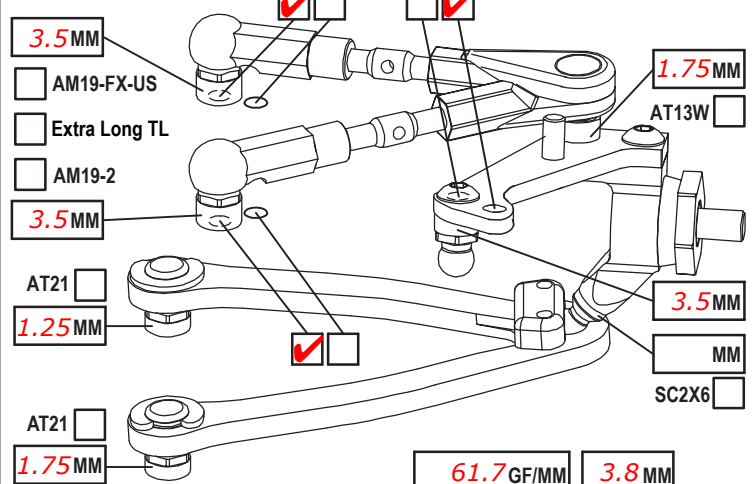

CAMBER ANGLE / °	2
CASTER ANGLE / °	4
TOE ANGLE / °	-1
RIDE HEIGHT / MM	5
DOWNSTOP / MM	5.2
UPWNSSTOP / MM	
STABILIZER Ø / MM	1.1
LOW ARM C04M1+9.0	<input checked="" type="checkbox"/>
STEER. ARM AM14LS	<input checked="" type="checkbox"/>
WHEEL SPACER / MM	NA
FRONT DRIVE SPOOL	<input checked="" type="checkbox"/>
DIFF. OIL	
DIFF WASHERS	
WHEELHUB AM06WL	<input checked="" type="checkbox"/>

SHOCKS SET	
ROTOR STD	<input checked="" type="checkbox"/>
SPRING STD	<input checked="" type="checkbox"/>
DAMPER D2.2	<input checked="" type="checkbox"/>
SRS/RHS ARR. I	<input type="checkbox"/>
PSS SETUP 25%	<input checked="" type="checkbox"/>

### REAR

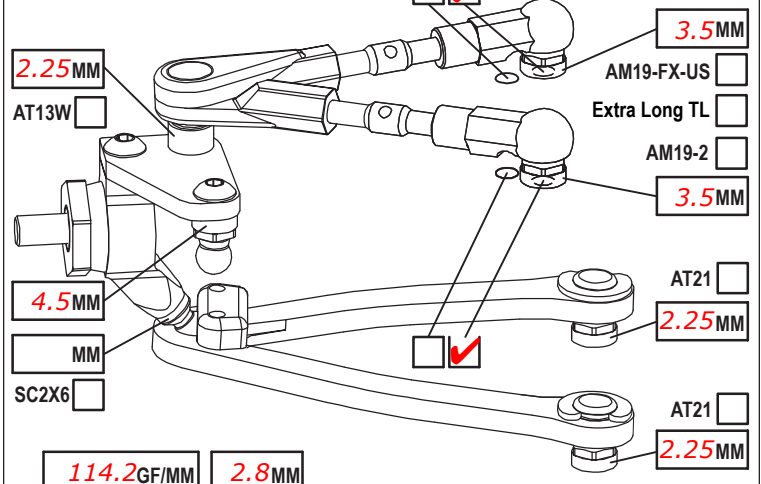

CAMBER ANGLE / °	2
CASTER ANGLE / °	-2
TOE ANGLE / °	2.5
RIDE HEIGHT / MM	5.5
DOWNSTOP / MM	4.6
UPWNSSTOP / MM	
STABILIZER Ø / MM	1.1
LOW ARM C04M1+8.0	<input checked="" type="checkbox"/>
STEER. ARM AM23-1	<input checked="" type="checkbox"/>
WHEEL SPACER / MM	NA
REAR DRIVE GB2B	<input checked="" type="checkbox"/>
DIFF. OIL 5K	
DIFF WASHERS Stock	
WHEELHUB AM06WL	<input checked="" type="checkbox"/>

SHOCKS SET	
ROTOR STD	<input checked="" type="checkbox"/>
SPRING STD	<input checked="" type="checkbox"/>
DAMPER D2.2	<input checked="" type="checkbox"/>
SRS/RHS ARR. I	<input checked="" type="checkbox"/>
PSS SETUP 25%	<input type="checkbox"/>

### CHASSIS FLEX AND WEIGHT SETTINGS

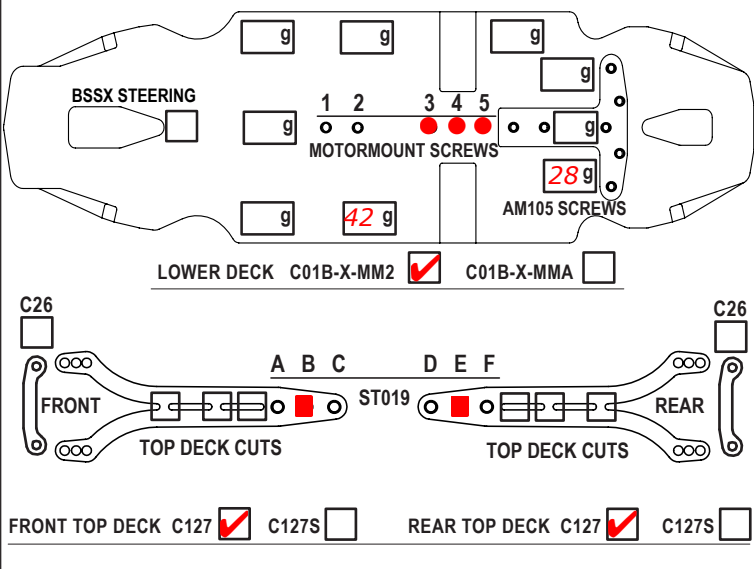

TIRES	TP 34U V2
INSERTS	
WHEELS	
ADDITIVE	MGV3 Yellow
TOTAL WEIGHT	1335
WEIGHT DISTRIBUTION	F % R %
NOTES:	

MOTOR LATERAL SHIFT / MM	
MOTOR	R1 V21 21.5
SPUR	95 PINION 47 RATIO 3.84
BODY	MonTech MonteCarlo L
WING	MonTech MonteCarlo L
ESC	Tekin RS Pro
ESC SETTING	Blinky
BEST LAP TIME	14.6
ACKERMANN POSITION	FWD
SERVO	Tekin T-180
STEER TRAVEL	IN OUT
BATTERY	Sunpadow Platin 8K
RECEIVER	Sanwa RX493
RADIO	Sanwa M17
FRONT TOP DECK	C127 <input checked="" type="checkbox"/> C127S <input type="checkbox"/>
REAR TOP DECK	C127 <input checked="" type="checkbox"/> C127S <input type="checkbox"/>

Building off my 01 August 2021 setup -- increasing dampening A-gap +0.4 front/rear was faster, might go back to AE 50 or try MR33 650. Ran HRB (with body in same position as 2020) and BDL. Body was heavier La Leggera instead of Super Leggera  
 Tires gave up after 5/6 runs - and same setup on new tires (ran in Amain) pushed equally on entry/exit (14.8)  
 Post racing - swap to C27MMX+F hole improved center/exit steering and lowered laptime to \*14.6)