

NAME **Marcel Geiger**
 COUNTRY **Netherlands**
 RACE **ETS**
 TRACK **AMCA Apeldoorn**

DATE **19.9.2021** TEMP. °C AIR / TRACK /
 ASPHALT OUTDOOR INDOOR CARPET
 TRACK CONDITION TECHNICAL MIXED FAST
 TRACTION LOW MEDIUM HIGH

FRONT

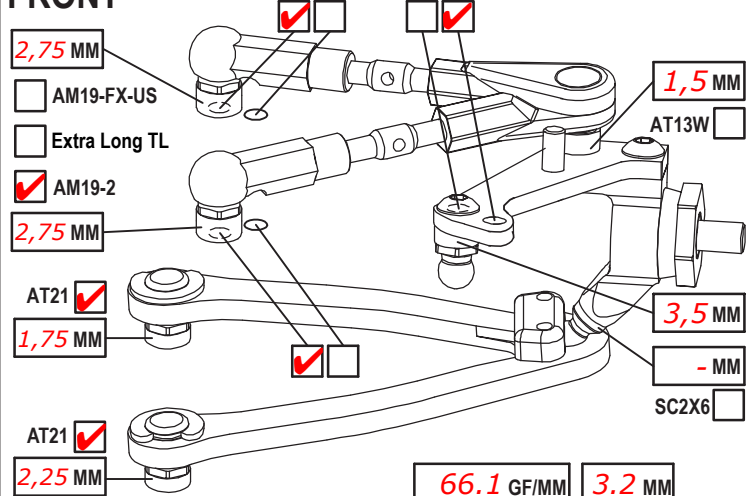

CAMBER ANGLE / °	1,0
CASTER ANGLE / °	7
TOE ANGLE / °	1,0
RIDE HEIGHT / MM	5,4
DOWNSTOP / MM	5,2
UPWNSSTOP / MM	-
STABILIZER Ø / MM	1,0
LOW ARM C04M1+9.0	<input checked="" type="checkbox"/> 0 <input type="checkbox"/>
STEER. ARM AM14LS	<input checked="" type="checkbox"/> <input type="checkbox"/>
WHEEL SPACER / MM	-
FRONT DRIVE SPOOL	<input checked="" type="checkbox"/> GB2B <input type="checkbox"/> LOW <input type="checkbox"/> HIGH <input checked="" type="checkbox"/>
DIFF. OIL	DIFF WASHERS
WHEELHUB AM06WL	<input checked="" type="checkbox"/> <input type="checkbox"/>

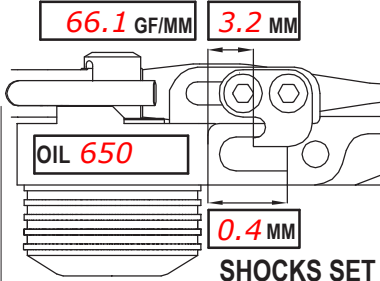

ROTOR	STD	<input checked="" type="checkbox"/>	<input type="checkbox"/>
SPRING	STD	<input type="checkbox"/>	S <input checked="" type="checkbox"/>
DAMPER	D2.2	<input checked="" type="checkbox"/>	<input type="checkbox"/>
SRS/RHS ARR.	I	<input checked="" type="checkbox"/>	II <input type="checkbox"/>
PSS SETUP	25%	<input checked="" type="checkbox"/>	15% <input type="checkbox"/>

REAR

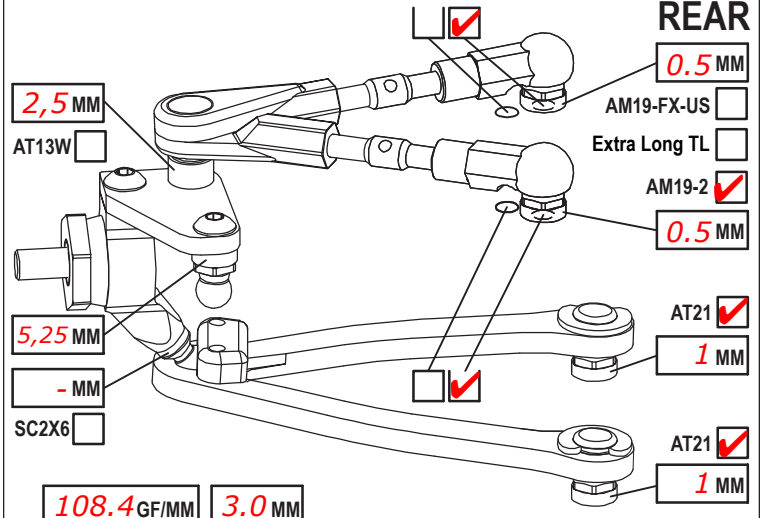

CAMBER ANGLE / °	1,0
CASTER ANGLE / °	-2
TOE ANGLE / °	2,5
RIDE HEIGHT / MM	5,8
DOWNSTOP / MM	4,2
UPWNSSTOP / MM	-
STABILIZER Ø / MM	1,0
LOW ARM C04M1+8.0	<input checked="" type="checkbox"/> <input type="checkbox"/>
STEER. ARM AM23-1	<input type="checkbox"/> AM14LS <input checked="" type="checkbox"/>
WHEEL SPACER / MM	-
REAR DRIVE	GB2B <input checked="" type="checkbox"/> LOW <input checked="" type="checkbox"/> HIGH <input type="checkbox"/>
DIFF. OIL 7000	DIFF WASHERS Big shims
WHEELHUB AM06WL	<input checked="" type="checkbox"/> <input type="checkbox"/>

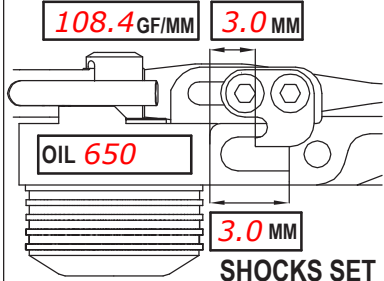

ROTOR	STD	<input checked="" type="checkbox"/>	<input type="checkbox"/>
SPRING	STD	<input checked="" type="checkbox"/>	S <input type="checkbox"/>
DAMPER	D2.2	<input checked="" type="checkbox"/>	<input type="checkbox"/>
SRS/RHS ARR.	I	<input checked="" type="checkbox"/>	II <input type="checkbox"/>
PSS SETUP	25%	<input type="checkbox"/>	15% <input type="checkbox"/>

CHASSIS FLEX AND WEIGHT SETTINGS

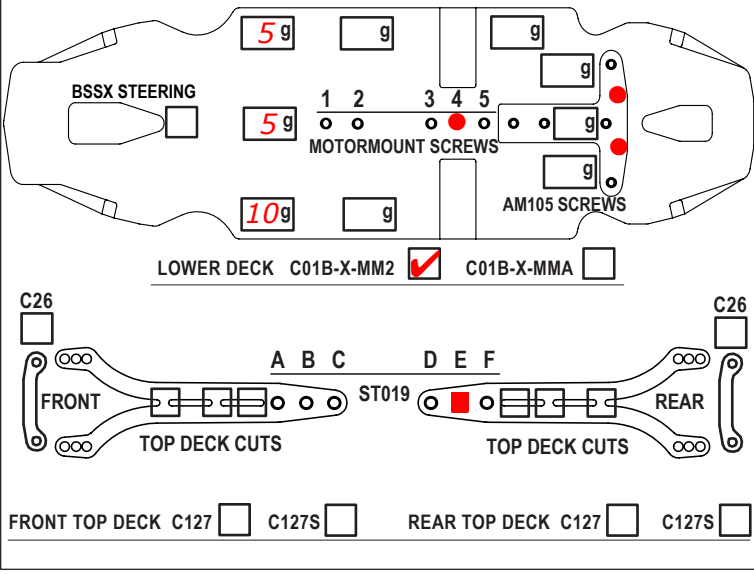

TIRES	MATRIX ETS
INSERTS	-
WHEELS	-
ADDITIVE	MR33
TOTAL WEIGHT	1335
WEIGHT DISTRIBUTION	F % R %
NOTES:	applied additive one time.

MOTOR LATERAL SHIFT / MM	ACKERMANN POSITION max. forward
MOTOR HW 4.5t	SERVO MKS HBL575 SL
SPUR 14 PINION 29 RATIO 7.47	STEER TRAVEL IN 23 OUT
BODY Wolverine (60mm)	BATTERY Sunpadow 5300
WING Std.	RECEIVER Sanwa
ESC HW	RADIO Sanwa M12
ESC SETTING Yes	
BEST LAP TIME 14,3	QUALIF./FINAL POSITION 16 / 13

C27MMX
 - AM14LS on rear. Used outer hole
 - ADC Damper cups
 - AM105 brace with 0,3mm shims.