

NAME *Jesper Rasmussen*
 COUNTRY *Denmark*
 RACE *DRCMU RD3 Tinglev TiMo*
 TRACK *Tinglev TiMo*

DATE *14/11-2021* TEMP. °C AIR / TRACK /
 ASPHALT OUTDOOR INDOOR CARPET
 TRACK CONDITION TECHNICAL MIXED FAST
 TRACTION LOW MEDIUM HIGH

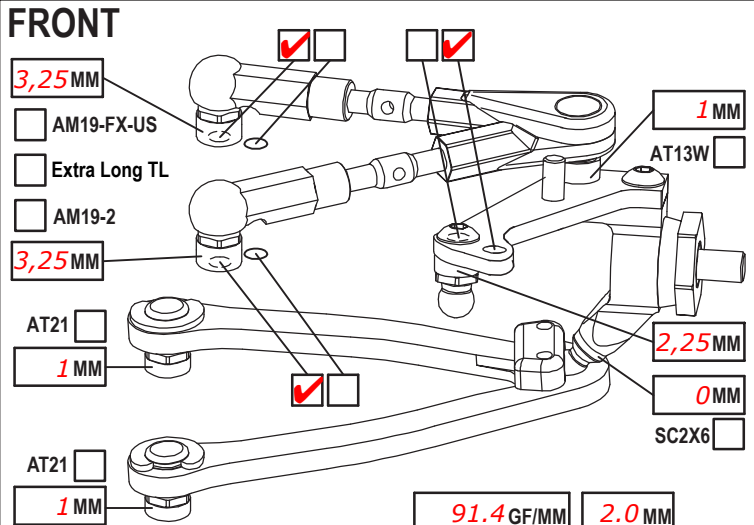

CAMBER ANGLE / °	-2
CASTER ANGLE / °	4
TOE ANGLE / °	+1
RIDE HEIGHT / MM	4,6
DOWNSTOP / MM	6
UPWNSTOP / MM	
STABILIZER Ø / MM	1,2
LOW ARM C04M1+9.0	<input checked="" type="checkbox"/>
STEER. ARM AM14LS	<input checked="" type="checkbox"/>
WHEEL SPACER / MM	
FRONT DRIVE SPOOL	<input checked="" type="checkbox"/> GB2B <input type="checkbox"/>
DIFF. OIL	
DIFF WASHERS	
WHEELHUB	AM06WL <input checked="" type="checkbox"/>

SHOCKS SET		
ROTOR	STD <input checked="" type="checkbox"/>	<input type="checkbox"/>
SPRING	STD <input type="checkbox"/>	S <input checked="" type="checkbox"/>
DAMPER	D2.2 <input type="checkbox"/>	
SRS/RHS ARR.	I <input checked="" type="checkbox"/>	II <input type="checkbox"/>
PSS SETUP	25% <input type="checkbox"/>	15% <input type="checkbox"/>

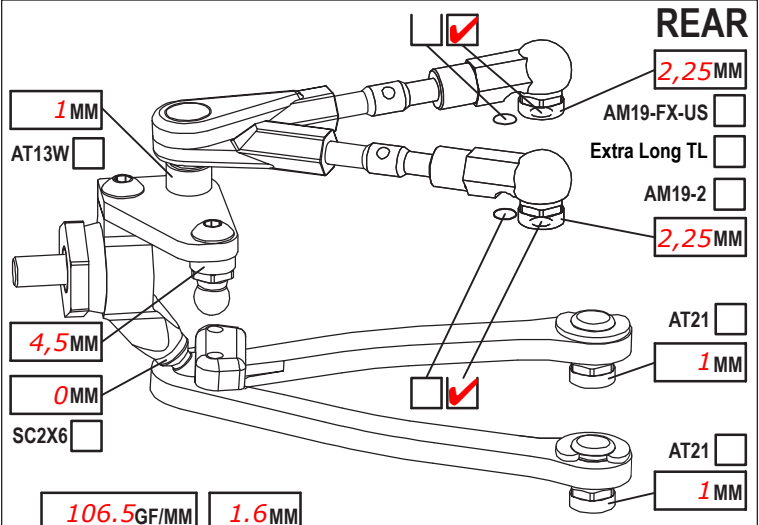

CAMBER ANGLE / °	-2
CASTER ANGLE / °	-3
TOE ANGLE / °	2,5
RIDE HEIGHT / MM	4,8
DOWNSTOP / MM	4,8
UPWNSTOP / MM	
STABILIZER Ø / MM	1,1
LOW ARM C04M1+8.0	<input checked="" type="checkbox"/>
STEER. ARM AM23-1	<input checked="" type="checkbox"/>
WHEEL SPACER / MM	
REAR DRIVE	GB2B <input checked="" type="checkbox"/>
DIFF. OIL	10k
DIFF WASHERS	Small shim
WHEELHUB	AM06WL <input checked="" type="checkbox"/>

SHOCKS SET		
ROTOR	STD <input checked="" type="checkbox"/>	<input type="checkbox"/>
SPRING	STD <input type="checkbox"/>	S <input checked="" type="checkbox"/>
DAMPER	D2.2 <input type="checkbox"/>	
SRS/RHS ARR.	I <input checked="" type="checkbox"/>	II <input type="checkbox"/>
PSS SETUP	25% <input type="checkbox"/>	15% <input type="checkbox"/>

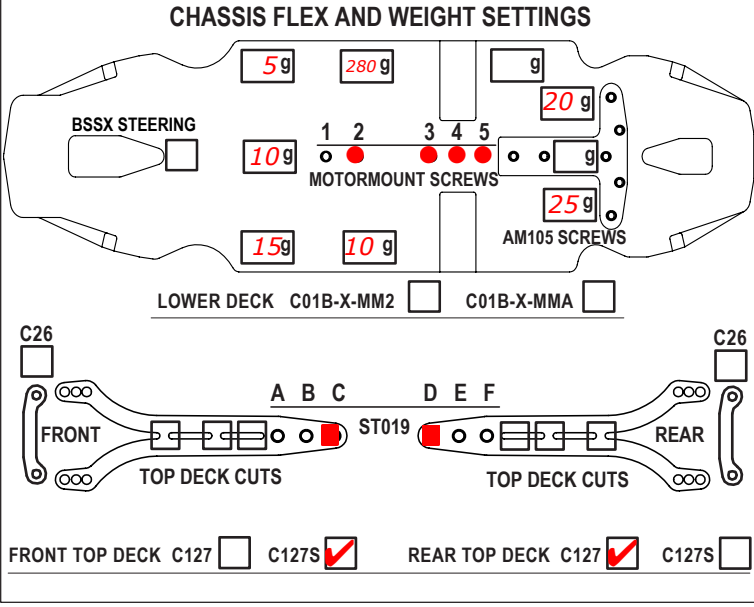

TIRES *Volante*

INSERTS

WHEELS

ADDITIVE *MR33 V4* TIME - FR *15min* RR *15min*

TOTAL WEIGHT *1325* WEIGHT DISTRIBUTION F % R %

NOTES:

MOTOR LATERAL SHIFT / MM *1.75*

MOTOR *13.5 ORCA Control*

SPUR *100* PINION *38* RATIO *5.00*

BODY *Twister 0.7 86g*

WING *STD*

ESC *ETS Limit*

ESC SETTING *Max Outdoor setup, 55% brake*

BEST LAPTIME *11,4* QUALIF./FINAL POSITION *2nd / 1st*

ACKERMANN POSITION *Back*

SERVO *Reedy*

STEER TRAVEL IN *24* OUT

BATTERY *Reedy 6000mah*

RECEIVER *RX493*

RADIO *M17 Red Edition*

lowerdeck C01MMA, AM180EVO HRB Body mount, Alu fan front of motor, Alu screws in top and stainless in button, alu wheels nuts, MR33 white belts, axon bearings and oil.