

NAME *Jesper Rasmussen*
 COUNTRY *Germany, Hann, Munden*
 RACE *ETS RD5 2022-23*
 TRACK *Hann Munden*

DATE *25-27/11 22* TEMP. °C AIR / TRACK /
 ASPHALT OUTDOOR INDOOR CARPET
 TRACK CONDITION TECHNICAL MIXED FAST
 TRACTION LOW MEDIUM HIGH

FRONT

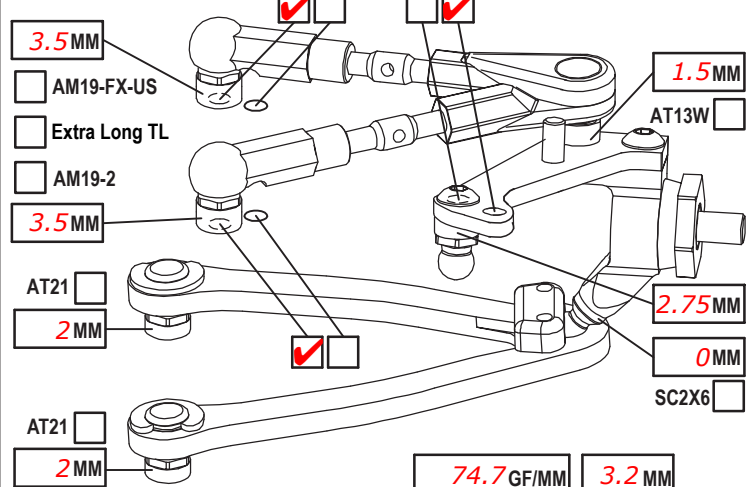

CAMBER ANGLE / °	<i>2</i>
CASTER ANGLE / °	<i>4</i>
TOE ANGLE / °	<i>1 out</i>
RIDE HEIGHT / MM	<i>5</i>
DOWNSTOP / MM	<i>5.6</i>
UPWNSSTOP / MM	
STABILIZER Ø / MM	<i>1.2</i>
LOW ARM C04M1+9.0	<input checked="" type="checkbox"/>
STEER. ARM AM14LS	<input checked="" type="checkbox"/>
WHEEL SPACER / MM	
FRONT DRIVE SPOOL	<input checked="" type="checkbox"/> GB2B <input type="checkbox"/>
DIFF. OIL	DIFF WASHERS
WHEELHUB	AM06WL <input type="checkbox"/>

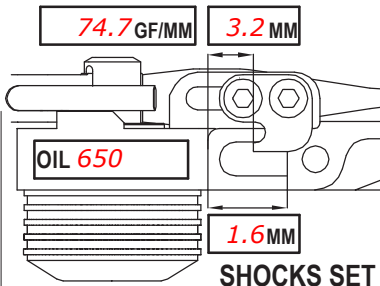

SHOCKS SET	
ROTOR	STD <input checked="" type="checkbox"/> S <input type="checkbox"/>
SPRING	STD <input type="checkbox"/> S <input checked="" type="checkbox"/>
DAMPER	D2.2 <input type="checkbox"/>
SRS/RHS ARR.	I <input checked="" type="checkbox"/> II <input type="checkbox"/>
PSS SETUP	25% <input type="checkbox"/> 15% <input type="checkbox"/>

REAR

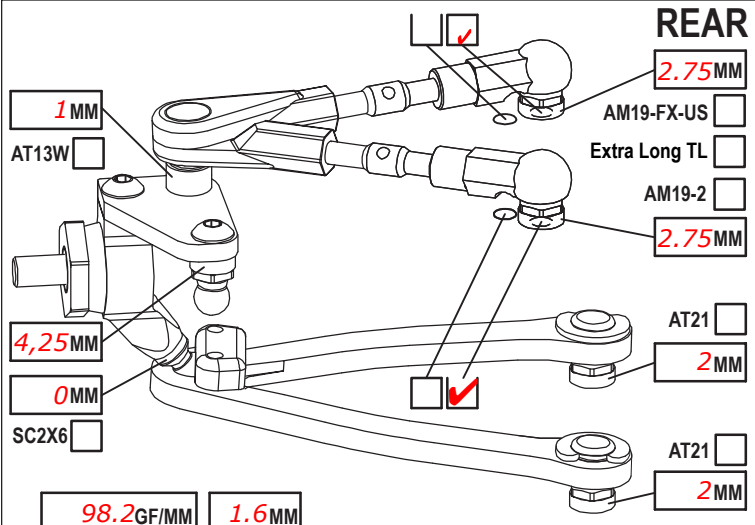

CAMBER ANGLE / °	<i>2</i>
CASTER ANGLE / °	<i>-2</i>
TOE ANGLE / °	<i>2 in</i>
RIDE HEIGHT / MM	<i>5.2</i>
DOWNSTOP / MM	<i>4.2</i>
UPWNSSTOP / MM	
STABILIZER Ø / MM	<i>1.1</i>
LOW ARM C04M1+8.0	<input checked="" type="checkbox"/>
STEER. ARM AM23-1	<input checked="" type="checkbox"/>
WHEEL SPACER / MM	
REAR DRIVE	GB2B <input type="checkbox"/> LOW <input checked="" type="checkbox"/> HIGH <input type="checkbox"/>
DIFF. OIL <i>10k</i>	DIFF WASHERS <i>small</i>
WHEELHUB	AM06WL <input type="checkbox"/>

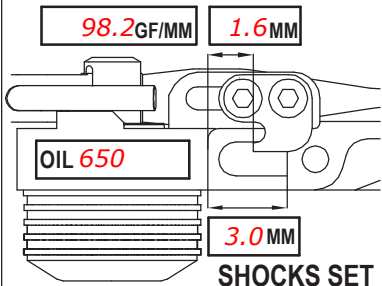

SHOCKS SET	
ROTOR	STD <input checked="" type="checkbox"/> S <input type="checkbox"/>
SPRING	STD <input type="checkbox"/> S <input checked="" type="checkbox"/>
DAMPER	D2.2 <input type="checkbox"/>
SRS/RHS ARR.	I <input checked="" type="checkbox"/> II <input type="checkbox"/>
PSS SETUP	25% <input type="checkbox"/> 15% <input type="checkbox"/>

CHASSIS FLEX AND WEIGHT SETTINGS

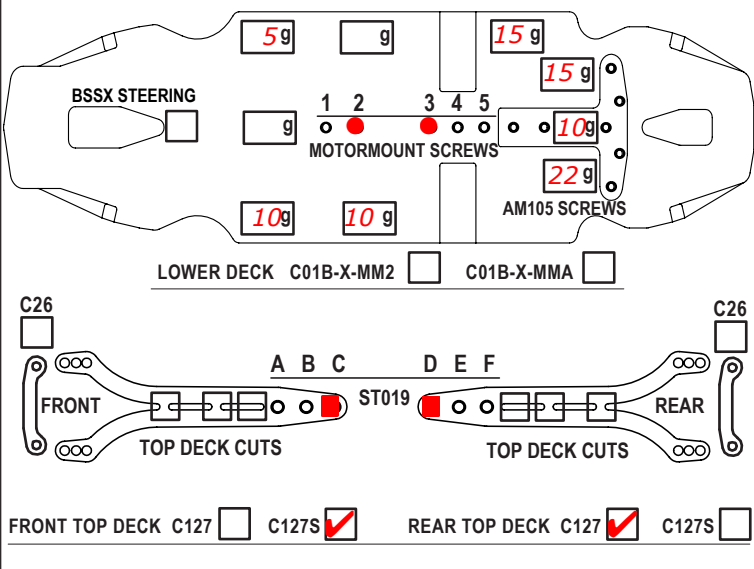

FRONT TOP DECK C127 C127S REAR TOP DECK C127 C127S

TIRES *Matrix ETS*
 INSERTS
 WHEELS
 ADDITIVE *MR33 V4* TIME - FR *15* RR *15*
 TOTAL WEIGHT *1300* WEIGHT DISTRIBUTION F *49* % R *51* %
 NOTES:

MOTOR LATERAL SHIFT / MM *1mm* ACKERMANN POSITION *back*
 MOTOR *ETS ORCA 13.5* SERVO *Reedy*
 SPUR *100* PINION *38* RATIO *5.00* STEER TRAVEL IN *24* OUT
 BODY *wolverine 0.5 (58mm)* BATTERY *Reedy 6000*
 WING *std* RECEIVER *'Sanwa*
 ESC *ORCA ETS* RADIO *Sanwa*
 ESC SETTING
 BEST LAP TIME *13.4* QUALIF./FINAL POSITION *10 / 9*

AT15, HRB, BDL, ADC, Axon oil.