

NAME **Oliver Kaufmann**

COUNTRY **Germany**

RACE

TRACK **Meckenheim**

DATE **08.06.2020**

TEMP. °C AIR / TRACK /

COMPOSITION ASPHALT  (OUTDOOR  INDOOR  CARPET

LAYOUT TECHNICAL  MIXED  FAST

TRACTION LOW  MEDIUM  HIGH

### FRONT

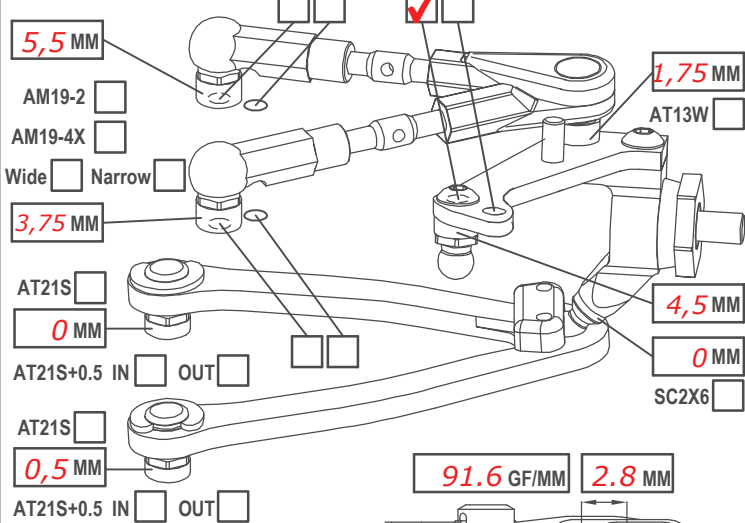

CAMBER ANGLE / °	<b>2</b>
CASTER ANGLE / °	<b>5</b>
TOE ANGLE / °	<b>1,0</b>
RIDE HEIGHT / MM	<b>5,2</b>
DOWNSTOP / MM	<b>5,0</b>
UPWNSTOP / MM	
STABILIZER Ø / MM	<b>1.0</b>
LOW ARM C04M1+0.5	<input type="checkbox"/> <b>+9</b> <input checked="" type="checkbox"/>
STEER. ARM AM14LS	<input type="checkbox"/>
WHEEL SPACER / MM	
FRONT DRIVE SPOOL	<input type="checkbox"/> GB2B <input checked="" type="checkbox"/> LOW <input type="checkbox"/> HIGH <input checked="" type="checkbox"/>
DIFF. OIL <b>100k</b>	DIFF WASHERS
DOGBONE DRIVE ST02	WHEELHUB AM06WL <input checked="" type="checkbox"/>

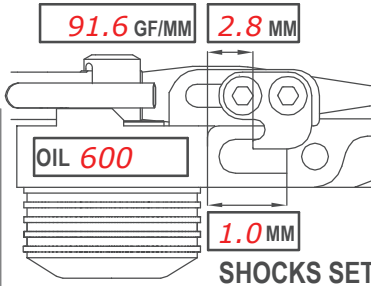

ROTOR	STD <input checked="" type="checkbox"/>	<input type="checkbox"/>
SPRING	STD <input checked="" type="checkbox"/>	S <input type="checkbox"/>
DAMPER	D2.2 <input type="checkbox"/>	<input type="checkbox"/>
SRS/RHS ARR.	I <input checked="" type="checkbox"/>	II <input type="checkbox"/>
PSS SETUP	MM 25% <input type="checkbox"/>	15% <input type="checkbox"/>

### REAR

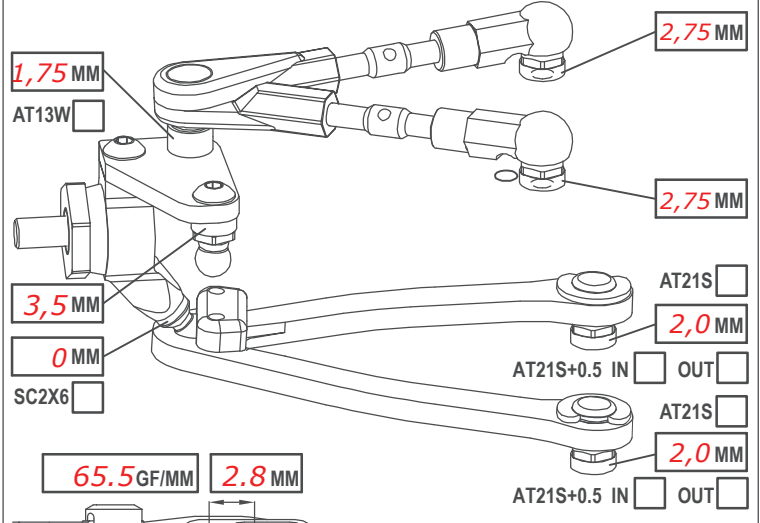

CAMBER ANGLE / °	<b>1,5</b>
CASTER ANGLE / °	<b>-2</b>
TOE ANGLE / °	<b>2,0</b>
RIDE HEIGHT / MM	<b>5,4</b>
DOWNSTOP / MM	<b>4,6</b>
UPWNSTOP / MM	
STABILIZER Ø / MM	<b>1.1</b>
LOW ARM C04M1+0.5	<input type="checkbox"/> <b>+8</b> <input checked="" type="checkbox"/>
STEER. ARM AM23	<input type="checkbox"/>
WHEEL SPACER / MM	<b>0</b>
WHEELHUB AM06WL	<input type="checkbox"/>

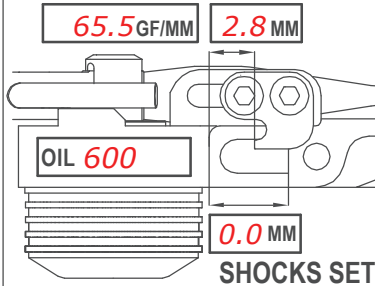

ROTOR	STD <input checked="" type="checkbox"/>	<input type="checkbox"/>
SPRING	STD <input type="checkbox"/>	S <input checked="" type="checkbox"/>
DAMPER	D2.2 <input checked="" type="checkbox"/>	<input type="checkbox"/>
SRS/RHS ARR.	I <input checked="" type="checkbox"/>	II <input type="checkbox"/>
PSS SETUP	MM 25% <input type="checkbox"/>	15% <input type="checkbox"/>

### CHASSIS FLEX AND WEIGHT SETTINGS

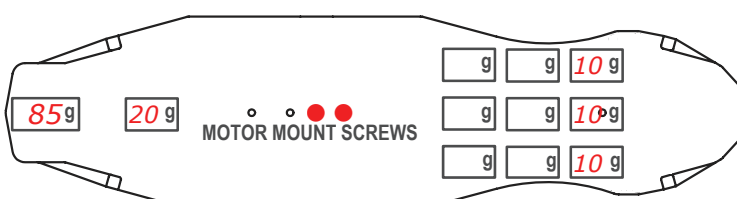

LOWER DECK C01B-FXC  C01B-FXA

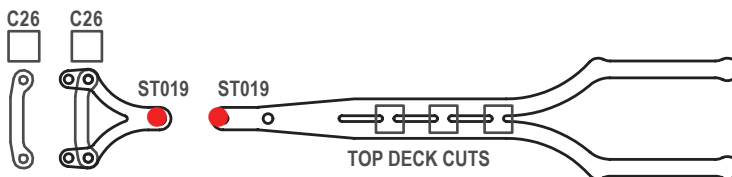

TOP DESK C27FX

TIRES	<b>Ride ETS</b>	
INSERTS	<b>Standard</b>	
WHEELS	<b>Standard</b>	
ADDITIVE	<b>MR33 V3</b>	TIME - FR <b>10 min</b> RR <b>10 min</b>
TOTAL WEIGHT	WEIGHT DISTRIBUTION FR	% - RR %

MOTOR LATERAL SHIFT / MM	<b>1</b>	ACKERMANN SHIMS / MM	<b>0</b>
MOTOR	<b>17,5 Hobbywing ETS</b>	SERVO	
SPUR/PINION	<b>102 43 RATIO 4.51</b>	STEER TRAVEL IN	<b>26</b> OUT
BODY	<b>HCF</b>	BATTERY	
WING	<b>Original</b>	RECEIVER	
ESC	<b>Hobbywing ETS</b>	RADIO	
ESC SETTING			
BEST LAPTIME	<b>14,6</b>	QUALIF./FINAL POSITION	/

ADC Cups uses / AT15 bearing spacer / AT21ST-A in FF and FR position!  
 Extra long toplinks used. (Screwed on Bulkhead and Topdeck)  
 Needed to use 2x AT25-44 and 2x AT25-2