

NAME *Isaac Cuevas*
 COUNTRY *Spain*
 RACE *ETS #3 Madrid*
 TRACK *Asoger RC*

DATE *04.- 07.04.2019* TEMP. °C AIR / TRACK *5-12 / colder*
 ASPHALT (OUTDOOR INDOOR) CARPET
 TRACK CONDITION TECHNICAL MIXED FAST
 TRACTION LOW MEDIUM HIGH

FRONT

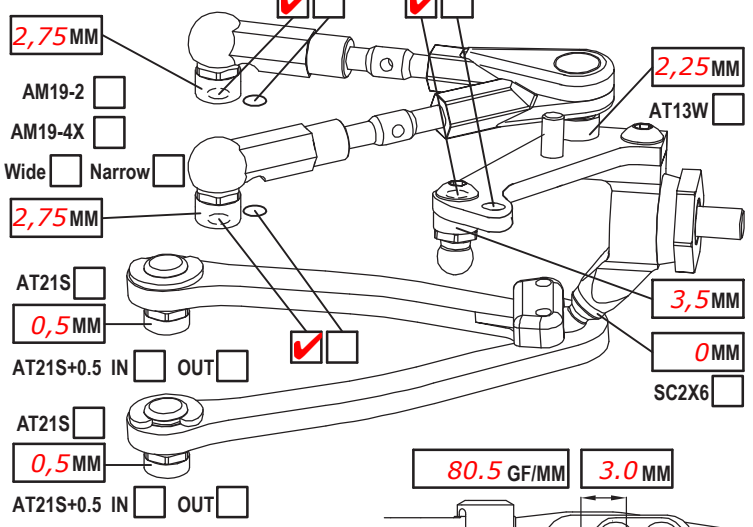

CAMBER ANGLE / °	<i>1,75</i>
CASTER ANGLE / °	<i>5</i>
TOE ANGLE / °	<i>1 (per side)</i>
RIDE HEIGHT / MM	<i>5,2</i>
DOWNSTOP / MM	<i>5,4</i>
UPWNSSTOP / MM	<i>-</i>
STABILIZER Ø / MM	<i>1,1</i>
LOW ARM C04M1+0.5	<input checked="" type="checkbox"/>
STEER. ARM AM14LS	<input checked="" type="checkbox"/>
WHEEL SPACER / MM	
FRONT DRIVE SPOOL	<input checked="" type="checkbox"/> GB2B <input type="checkbox"/>
DIFF. OIL	
DOG BONE DRIVE ST02	<input type="checkbox"/>
WHEELHUB AM06WL	<input checked="" type="checkbox"/>

SHOCKS SET	
ROTOR STD	<input checked="" type="checkbox"/>
SPRING STD	<input type="checkbox"/>
DAMPER D2.2	<input type="checkbox"/>
SRS/RHS ARR. I	<input checked="" type="checkbox"/>
PSS SETUP 4.0	MM A <input checked="" type="checkbox"/> B <input checked="" type="checkbox"/>
LOW	<input type="checkbox"/>
HIGH	<input checked="" type="checkbox"/>

REAR

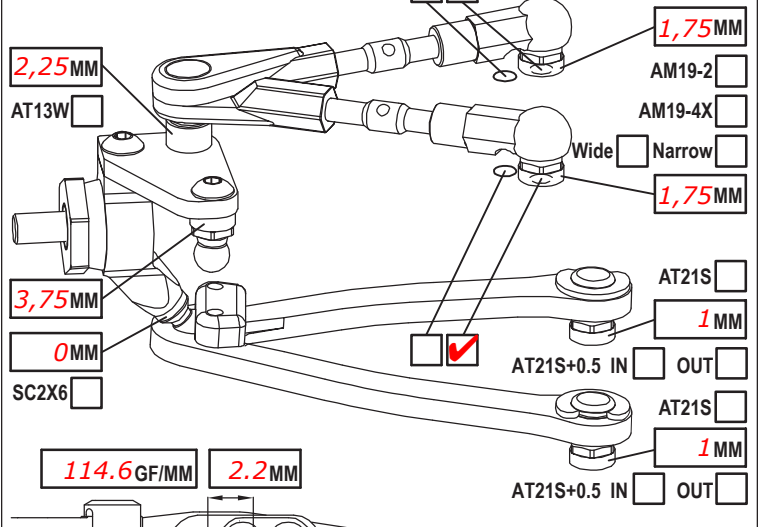

CAMBER ANGLE / °	<i>2°</i>
CASTER ANGLE / °	<i>0</i>
TOE ANGLE / °	<i>2</i>
RIDE HEIGHT / MM	<i>5,4</i>
DOWNSTOP / MM	<i>4,6</i>
UPWNSSTOP / MM	<i>-</i>
STABILIZER Ø / MM	<i>1,1</i>
LOW ARM C04M1+0.5	<input checked="" type="checkbox"/>
STEER. ARM AM23	<input checked="" type="checkbox"/>
WHEEL SPACER / MM	
REAR DRIVE	GB2B <input type="checkbox"/>
DIFF. OIL 7000	
DOG BONE DRIVE EVD	<input type="checkbox"/>
WHEELHUB AM06WL	<input checked="" type="checkbox"/>

SHOCKS SET	
ROTOR STD	<input checked="" type="checkbox"/>
SPRING STD	<input checked="" type="checkbox"/>
DAMPER D2.2	<input type="checkbox"/>
SRS/RHS ARR. I	<input checked="" type="checkbox"/>
PSS SETUP	MM A <input type="checkbox"/> B <input type="checkbox"/>
LOW	<input type="checkbox"/>
HIGH	<input checked="" type="checkbox"/>

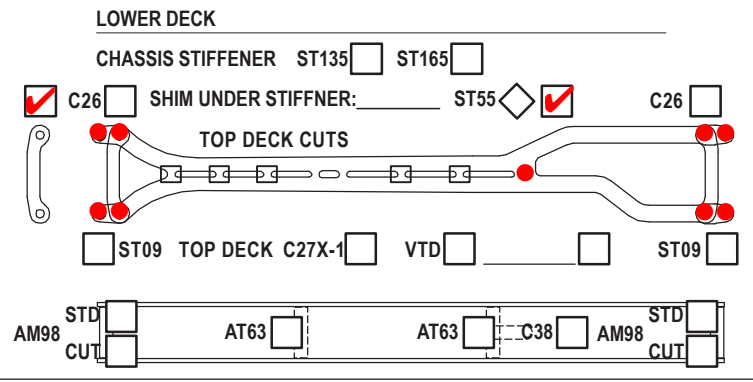
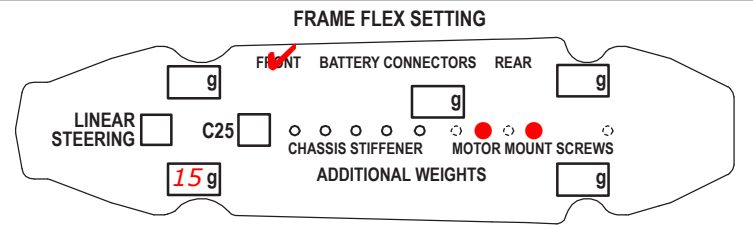

TIRES *Volante V36 (ETS)*
 INSERTS *handout*
 WHEELS *handout*
 ADDITIVE *MR33 V3 (ETS)* TIME - FR 20+10 RR 20+10

NOTES

MOTOR LATERAL SHIFT / MM	ACKERMANN SHIMS / MM <i>1.0</i>
MOTOR <i>Muchmore V2 13,5T</i>	SERVO <i>Futaba BLS551</i>
SPUR 102 PINION 43 RATIO 4.51	STEER TRAVEL IN 22 OUT
BODY <i>ZooRacing Zoolilla</i>	BATTERY <i>RcProstyle 8400</i>
WING <i>STD.</i>	RECEIVER <i>Sanwa 451R</i>
ESC <i>Muchmore V2 (ETS)</i>	RADIO <i>Sanwa M11x</i>
ESC SETTING <i>RPM-Limit (ETS)</i>	
BEST LAP TIME <i>21,634</i>	QUALIF./FINAL POSITION <i>12 / 11</i>

*Rear Springs 115°
 40 gr under RX and ESC.
 No central Chassis Stiffener.
 Front PSS 4.0 mm A position.*