

NAME **Ethan Erchinger**

COUNTRY **NorCal Hobbies**

RACE **Club race**

TRACK **Outdoor asphalt**

SETUP SHEET

DATE **March 10, 2012**

TEMP. °C **AIR / TRACK 66 F** / 84 F

CARPET ☐ ASPHALT ☒

TRACK CONDITION TECHNICAL ☐ MIXED ☒ FAST ☐

TRACTION LOW ☐ MEDIUM ☒ HIGH ☐

FRONT

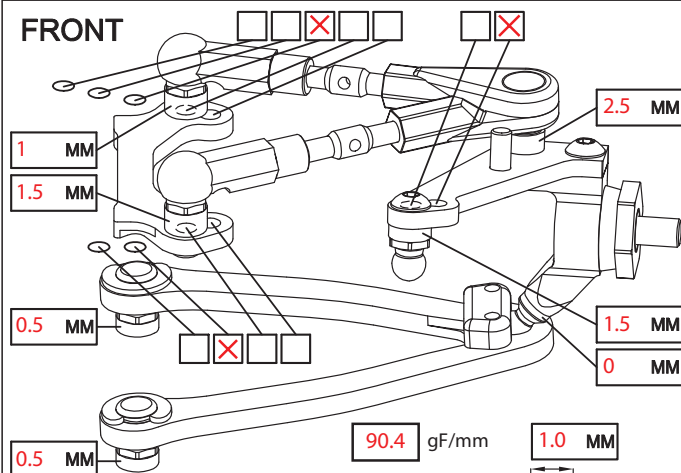

CAMBER ANGLE / ° **2**

CASTER ANGLE / ° **4**

TOE ANGLE / ° **-1**

RIDE HEIGHT / MM **5**

DOWNSTOP / MM **6.4**

UPSTOP / MM **0**

STABILIZER Ø / MM **1**

LOW ARM STD ☒

STEERING ARM STD ☒

WHEEL SPACER / MM

FRONT DRIVE BALL DIFF ☐ GEAR DIFF ☐ SPOOL ☒ ONE-WAY ☐

DIFF SET LOOSE ☐ MEDIUM ☐ TIGHT ☐ OIL ☐ #

DOGBONE DRIVE BUSHING ☒ C-DRIVE ☐ BB ☐ EVD ☐

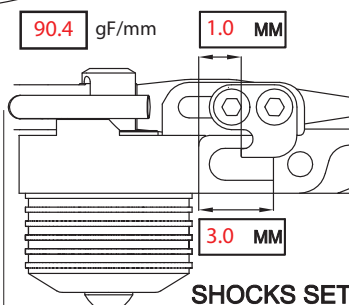

SHOCKS SET

SPRING STD ☒
DAMPER STD ☒
ACTION SYM. ☒ ASYM. ☐
SRS/RHS ARR. I ☐ II ☒

REAR

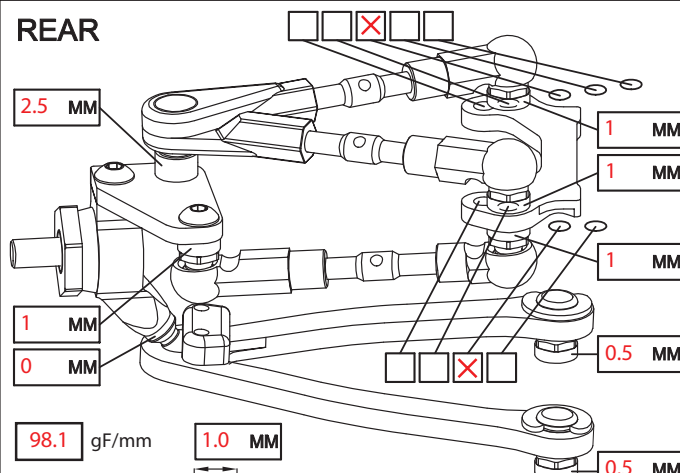

CAMBER ANGLE / ° **2**

CASTER ANGLE / ° **4**

TOE ANGLE / ° **2.5**

RIDE HEIGHT / MM **5**

DOWNSTOP / MM **5.4**

UPSTOP / MM **0**

STABILIZER Ø / MM **0**

LOW ARM STD ☒

STEERING ARM STD ☒

WHEEL SPACER / MM

SPRING STD ☒
DAMPER STD ☒
ACTION SYM. ☒ ASYM. ☐
SRS/RHS ARR. I ☐ II ☒

REAR DRIVE BALL DIFF ☐ GEAR DIFF ☒

DIFF SET LOOSE ☐ MEDIUM ☐ TIGHT ☐ OIL ☒ # **2000**

DOGBONE DRIVE BUSHING ☒ C-DRIVE ☐ BB ☐ EVD ☐

FL	FR	RL	RR	TIRES	FRONT	REAR
				BRAND	Team Powers 36R	Team Powers 36R
				INSERTS		
				WHEELS		
				ADDITIVE	Paragon 2	Paragon 2

MOTOR LAYOUT	LONG.	<input checked="" type="checkbox"/>	TRANS.	<input type="checkbox"/>	MOTOR	Team Powers 4.5				
SERVO LAYOUT	LEFT	<input checked="" type="checkbox"/>	RIGHT	<input type="checkbox"/>	SERVO	Futaba bls551				
ESC LAYOUT	LEFT	<input checked="" type="checkbox"/>	RIGHT	<input type="checkbox"/>	ESC	Team Powers XLS				
BAT. LAYOUT	R1	<input type="checkbox"/>	R2	<input checked="" type="checkbox"/>	F1	<input type="checkbox"/>	F2	<input type="checkbox"/>	BATTERY	Protek
SPUR	73	PINION	18	RECEIVER	Futaba R614FF					
FINAL DRIVE RATIO	8.44	MOTOR OFFSET / MM	0	WING	<----					
BODY	PF Speed 6 Regular									

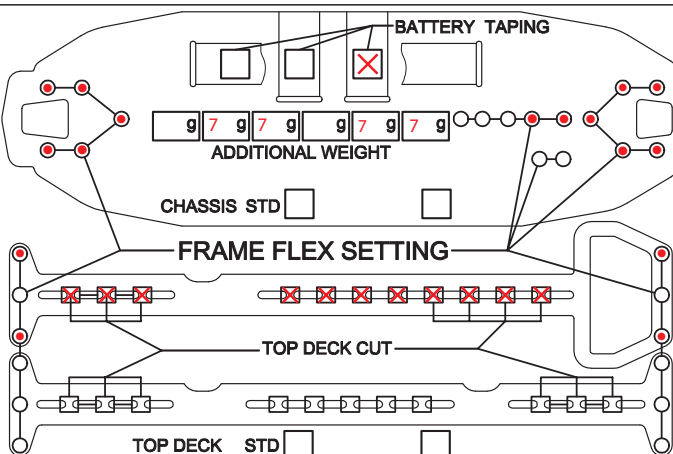

STEERING POST

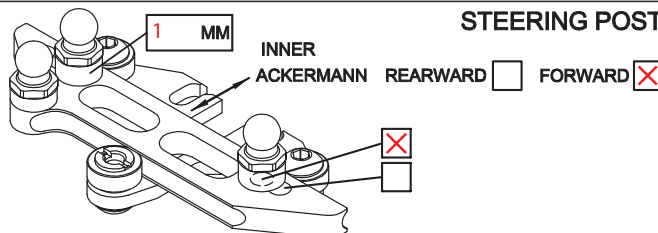

BEST LAPTIME **QUALIF. / FINAL POSITION** /
ESC SETTING **Some timing and turbo boost, no "punch"**
COMMENTS / IMPRESSIONS **IAS used, installed post racing in practice, I think it woke the car up a bit on initial steering.**
Need to try less angle on the upper links, in front at least, get more roll in the car.
Early attempts at using LG[12] sauce proved ineffective, need more testing.
CONTACT