

NAME **Viljami Kutvonen**
 COUNTRY **Finland**
 RACE **FinTrack Tour 2013 Round 2**
 TRACK **Kuusankoski Indoor**

DATE **27.01.2013** TEMP. °C AIR / TRACK °C / °C
 TRACK CONDITION TECHNICAL CARPET ASPHALT
 MIXED FAST
 TRACTION LOW MEDIUM HIGH

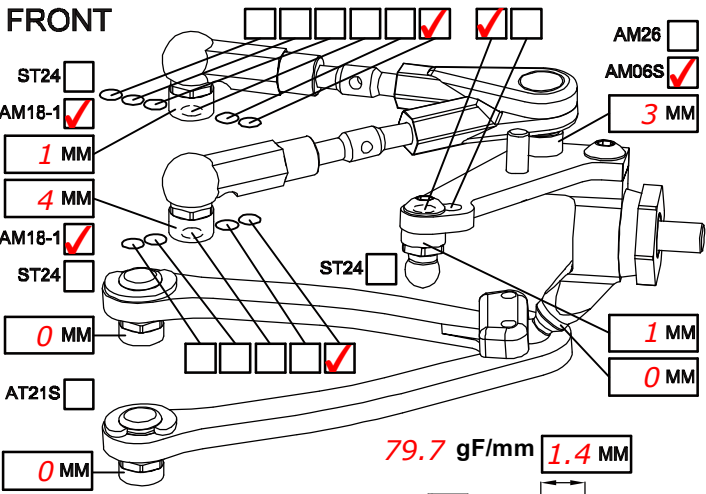

79.7 gF/mm 1.4 MM

CAMBER ANGLE / ° **1.5**
 CASTER ANGLE / ° **6**
 TOE ANGLE / ° **-1.5**
 RIDE HEIGHT / MM **5**
 DOWNSTOP / MM **6.4**
 UPSTOP / MM **max**

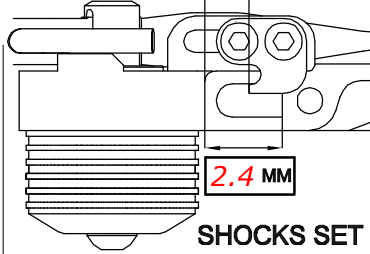

STABILIZER Ø / MM **1.1** SPRING STD S
 LOW ARM STD DAMPER #6 #3
 STEERING ARM STD ACTION SYM. ASYM.
 WHEEL SPACER / MM **0** SRS/RHS ARR. I II
 FRONT DRIVE BALL DIFF GEAR DIFF SPOOL ONE-WAY
 DIFF SET LOOSE MEDIUM TIGHT OIL #
 DOGBONE DRIVE BUSHING C-DRIVE BB EVD

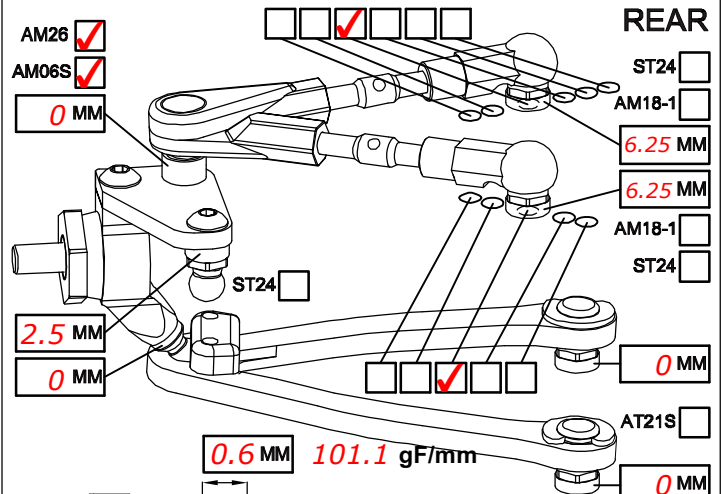

0.6 MM 101.1 gF/mm

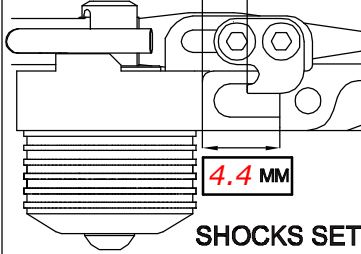

CAMBER ANGLE / ° **1.5**
 CASTER ANGLE / ° **0**
 TOE ANGLE / ° **3**
 RIDE HEIGHT / MM **5.2**
 DOWNSTOP / MM **5.4**
 UPSTOP / MM **max**

STABILIZER Ø / MM **1.1** SPRING STD S
 LOW ARM STD DAMPER #6 #3
 STEERING ARM STD ACTION SYM. ASYM.
 WHEEL SPACER / MM **0** SRS/RHS ARR. I II
 REAR DRIVE BALL DIFF GEAR DIFF
 DIFF SET LOOSE MEDIUM TIGHT OIL # **3000**
 DOGBONE DRIVE BUSHING C-DRIVE BB EVD

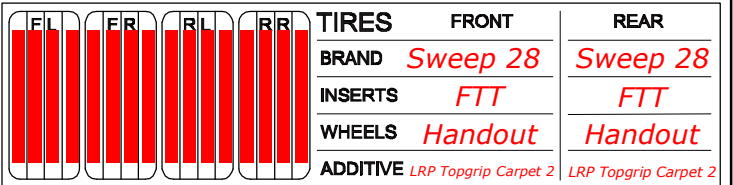
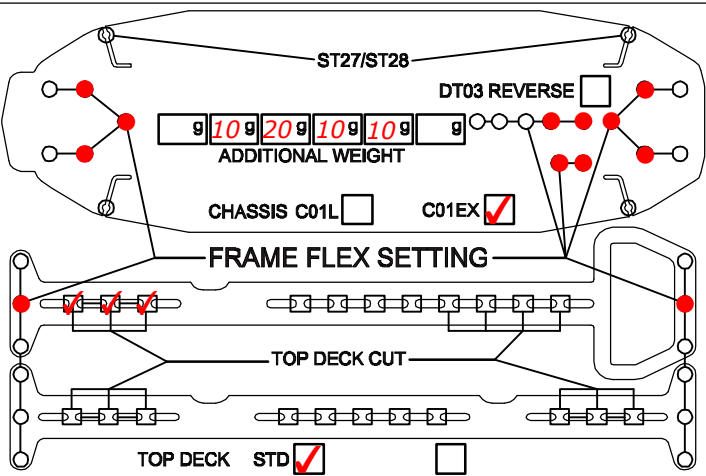

MOTOR LAYOUT LONG. TRANS. MOTOR **LRP X20 5.0T**
 SERVO LAYOUT LEFT RIGHT SERVO **Sanwa SRG-BLS**
 ESC LAYOUT LEFT RIGHT ESC **LRP Flow WorksTeam**
 BAT. LAYOUT R1 R2 F1 F2 BATTERY **LRP 6900**
 SPUR **96** PINION **22** RECEIVER **Sanwa 451R**
 FINAL DRIVE RATIO MOTOR OFFSET / MM
 BODY **Protoform Speed6 LW** WING

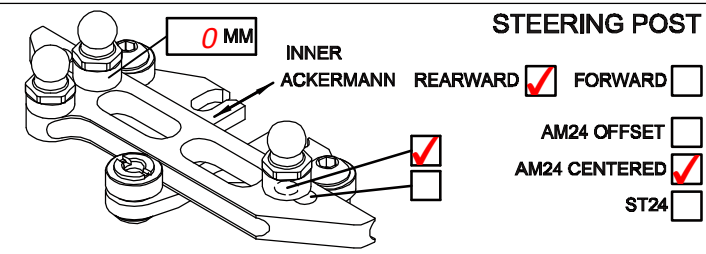

BEST LAPTIME QUALIF. / FINAL POSITION **1 / 1**
 ESC SETTING
 COMMENTS / IMPRESSIONS **Upper shims measured from Topdeck level. Shims under suspension arms measured from milled level. Overall - toe front is 3**
 CONTACT **v.kutvonen(a)luukka.com**