

RACE	High Traction Base Setup	
TRACK	BeachLine	
NAME		DATE
LAPS		BEST LAP TIME
QUALIFYING POSITION		FINAL POSITION
TRACK		
SIZE	<input type="checkbox"/> OPEN	<input type="checkbox"/> MEDIUM <input checked="" type="checkbox"/> TIGHT
TRACTION	<input type="checkbox"/> V LOW <input type="checkbox"/> LOW <input type="checkbox"/> MEDIUM <input checked="" type="checkbox"/> HIGH <input type="checkbox"/> V HIGH	
SURFACE	<input type="checkbox"/> SMOOTH <input checked="" type="checkbox"/> MEDIUM <input type="checkbox"/> BUMPY	
TYPE	<input type="checkbox"/> CARPET <input type="checkbox"/> ASTRO <input type="checkbox"/> GRASS <input checked="" type="checkbox"/> CLAY <input type="checkbox"/> WOOD	
CONDITION	<input type="checkbox"/> BLUE GROOVE <input checked="" type="checkbox"/> HARD PACKED <input type="checkbox"/> DRY <input checked="" type="checkbox"/> DUSTY <input type="checkbox"/> LOAMY <input type="checkbox"/> WET	
TRANSMISSION		
DIFFERENTIAL	BALL DIFF <input type="checkbox"/> GEAR DIFF <input checked="" type="checkbox"/>	OIL 3k <input checked="" type="checkbox"/> csl
SATELLITE GEARS	COMPOSITE <input checked="" type="checkbox"/> STEEL <input type="checkbox"/>	
SLIPPER	ADJUSTMENT	<input checked="" type="checkbox"/> 1 mm
GEARING		
PINION	22	SPUR GEAR 81
SHOCKS		
FRONT	ae black	REAR
	32.5	32.5
	0	0
2 HOLES <input checked="" type="checkbox"/>	PISTONS	2 HOLES <input checked="" type="checkbox"/>
3 HOLES <input type="checkbox"/>	<input type="checkbox"/> ø1.0mm <input type="checkbox"/>	3 HOLES <input type="checkbox"/>
6 HOLES <input type="checkbox"/>	<input type="checkbox"/> ø1.1mm <input type="checkbox"/>	6 HOLES <input type="checkbox"/>
	<input type="checkbox"/> ø1.2mm <input type="checkbox"/>	
	<input type="checkbox"/> ø1.3mm <input type="checkbox"/>	
	<input type="checkbox"/> ø1.4mm <input checked="" type="checkbox"/>	
	<input type="checkbox"/> ø1.7mm <input type="checkbox"/>	
	<input type="checkbox"/> ø1.7mm <input checked="" type="checkbox"/>	
DOWNSTOP SHIM	<input checked="" type="checkbox"/> 1 mm	DOWNSTOP SHIM
LENGTH		LENGTH
UPSTOP SHIM	<input checked="" type="checkbox"/> 2 mm	UPSTOP SHIM
BALL JOINT		BALL JOINT
SHOCK TOWER		
FRONT	SHOCK TOWER	REAR
GRAPHITE <input type="checkbox"/>	COMPOSITE <input checked="" type="checkbox"/>	GRAPHITE <input type="checkbox"/>
REAR ANTI ROLL BAR		
YES <input type="checkbox"/>	THICKNESS	NO <input checked="" type="checkbox"/>
TIRES		
FRONT	Smoothies	REAR
	JC	Smoothies
	JC 2.2	JC
	Gold	JC 2.2
		Gold
ELECTRONICS		
MOTOR	Orion 7.5	
SPEEDO	Airtronics Super Votex	
BATTERIES	Orion	
ELECTRONICS LAYOUT		
MOTOR POSITION	<input checked="" type="checkbox"/> FRONT <input type="checkbox"/> MIDDLE <input type="checkbox"/> REAR	
	<input type="checkbox"/> LEFT <input checked="" type="checkbox"/> RIGHT	
BATTERY POSITION	<input type="checkbox"/> FRONT <input type="checkbox"/> MIDDLE <input checked="" type="checkbox"/> REAR	
BODY		
STANDARD <input checked="" type="checkbox"/>	LIGHT <input type="checkbox"/>	WING XRay

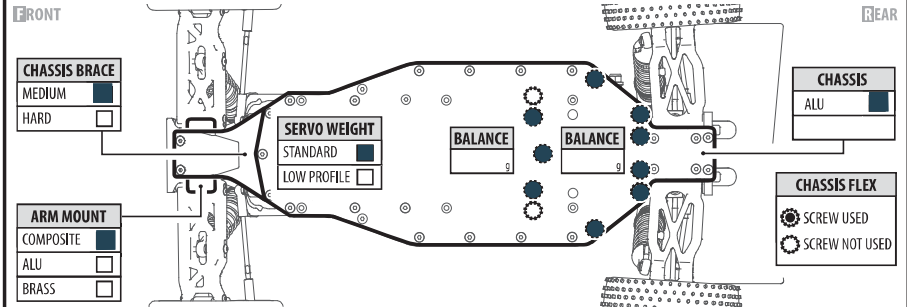
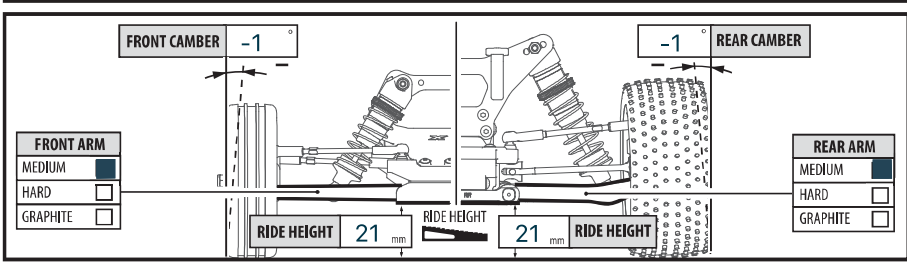
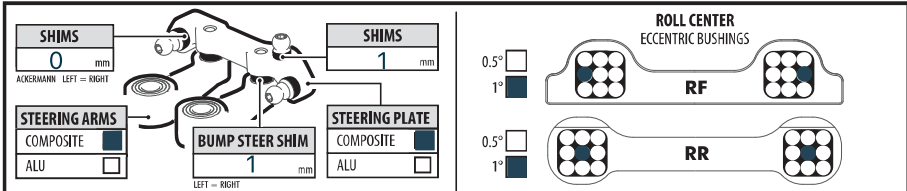
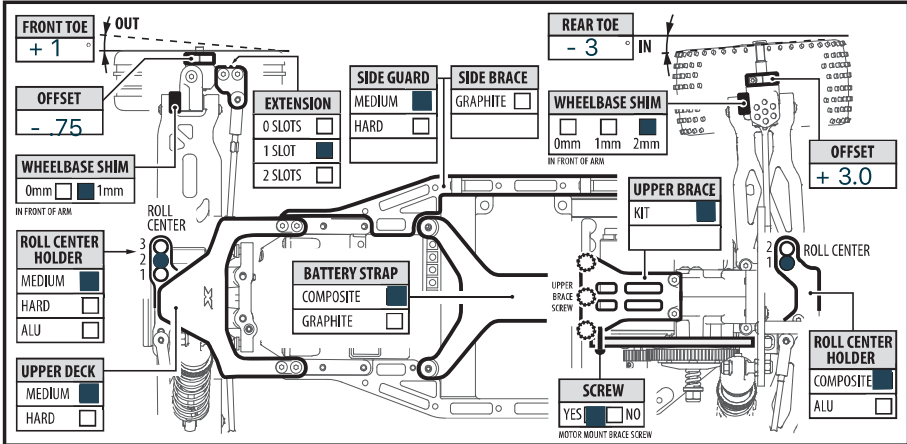
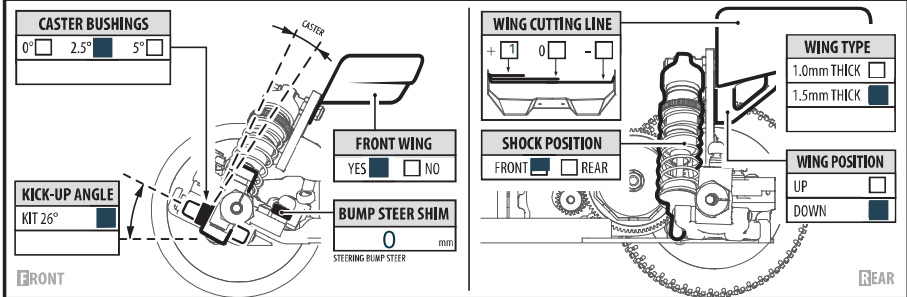
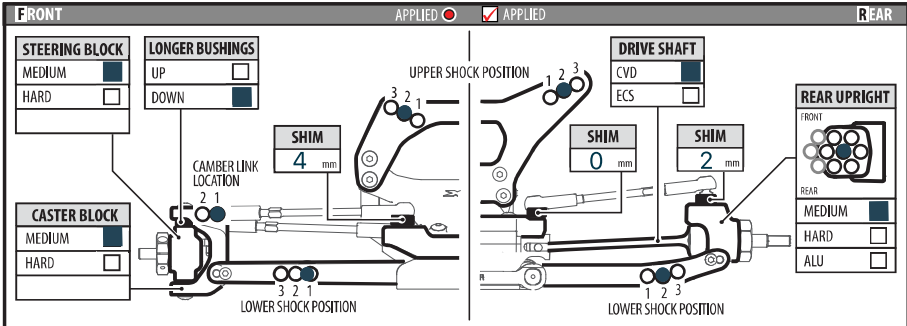

NOTES: Using Schelle pistons. Even with the black ae springs. The car needs to have a softer shock package. In general, the car is very stable, corners very smooth and does a decent job squaring up after a corner. Suggestions: Try a piston that has less 'pack' or drop the shock fluid down 2 steps in the front and 1 in the rear. Reason, in the tight technical switchbacks, the car needs faster steering response and tighter radius. In a couple corners: first corner onto the main straight and after the in-field double entering the switchback, the car will brake loose. Tried moving the rear shocks upper all the way in and the lower all the way out. Do not suggest tuning the side bite. Car will be too stiff in corners.