

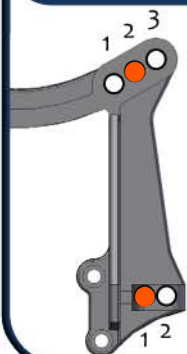

Driver: Yuichi Ajishi Date: 29.07.2009  
 Track / Event: Japan Nationals - Yatabe Arena  
 Layout:  Open /  Tight Surface:  Smooth /  Bumpy  
 Grip: Low     High Weather: Dry

### Front Suspension



Ride Height: 22 mm  
 Camber: -2° Toe: 0°  
 Ackerman:  Forward  Back

Servo:  Fwd  Back  
 Axles:  Trailing  Inline  
 Caster Block:  
 20°  25°  30°

# Washers 1

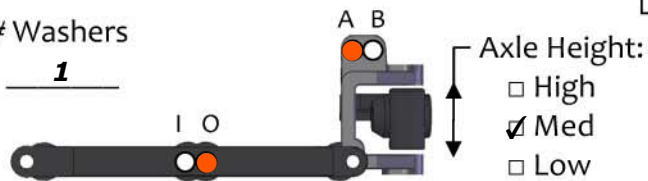

Axle Height:  
 High  
 Med  
 Low



# Washers 0.05"  
 Position:  
 Fwd  Back

### Shocks & Tires

Brand	Spring	Piston	Oil
<b>HB</b>	<b>HB Black</b>	<b>3</b>	<b>35 AE</b>

Limiter - Top: 0 Bottom: 0  
 Shock Length: 21.5 mm  
 Compressed Length: \_\_\_\_\_  
 Front Tire: **HB Fullshot Soft**  
 Insert: **Standard**

### Rear Suspension

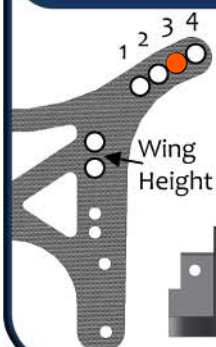

Ride Height: 23 mm  
 Camber: -2°  
 Transmission Height: 0 mm

Sway Bar: **No**

# Washers 1

Wing Height

OE-Speed High  
 OE-Speed Low

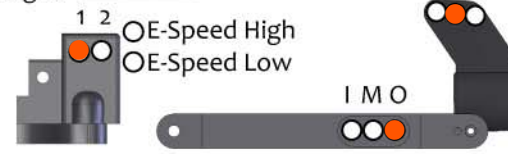

Arm Position:  
 Back  Mid  Fwd

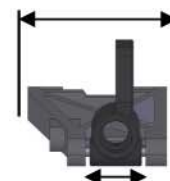

Hub Position:  
 Back  Mid  Fwd



Anti-Squat: 1.5 mm

### Shocks & Tires

Brand	Spring	Piston	Oil
<b>HB</b>	<b>HB White</b>	<b>2</b>	<b>30 AE</b>

Limiter - Top: 0 Bottom: 0  
 Shock Length: 30 mm  
 Compressed Length: \_\_\_\_\_  
 Rear Tire: **Panther Switch 2.0 Soft**  
 Insert: **Yokomo B-Max4C**

### Weight

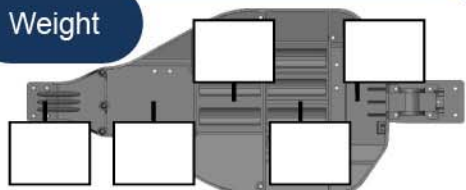

Total Weight: \_\_\_\_\_  
 F/R Bias: \_\_\_\_\_ / \_\_\_\_\_

### Notes / Rants / Excuses

Front aluminum brace, Team AJ Toe-In bar

TEAM AJ Main Chassis with machined battery slot

ESC: Speed Passion GT2.0 Pro

Wing: JConcepts V6.5

Battery: Atlantis 4500 Motor: Speed Passion 8.5T Gearing: 25 / 81