

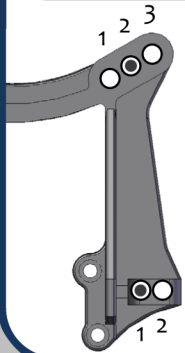

Driver: US X Factory Team Date: Aug 2009  
 Track/Event: Starting Set-Up

### Front Suspension



Ride Height: Arms Level 25mm  
 Camber: -1 ° Toe: in 1 °  
 Ackerman:  Forward  Back

Servo:  Fwd  Back  
 Axles:  Trailing  Inline  
 Caster Block:  
 20°  25°  30°

# Washers  
2



Axle Height:  
 High  
 Med  
 Low

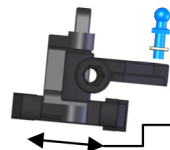

# Washers  
2

Position:  
 Fwd  Back

### Front Shocks

	Spring	Piston	Oil
AE	Brown	#2	30wt
Losi	Orange	red 56	30wt
Kyosho	Orange 55	2C	30wt

Shock Length: 76.7mm

Compressed Length: 58.0 mm

### Rear Suspension

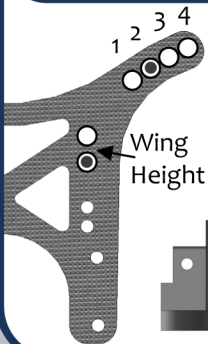

Ride Height: 24 mm  
 Camber: -1 °  
 Transmission Height: 0.060"

Sway Bar: no

# Washers  
0

Wing Height

E-Speed High  
 E-Speed Low

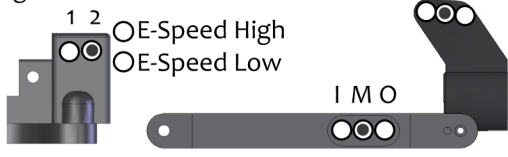

Anti-Squat:

Arm Position:  
 Back  Mid  Fwd

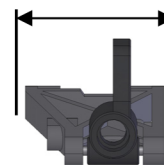

Hub Position:  
 Back  Mid  Fwd

### Rear Shocks

	Spring	Piston	Oil
AE	Silver	#2	27.5
Losi	Pink	Red 56	30wt
Kyosho	Blue 68	2C	25wt

Shock Length: 92.0 mm

Compressed Length: 64.6 mm

### Weight

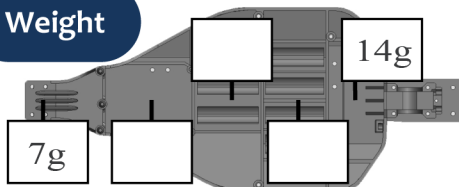

Total Weight: 1520g

F/R Bias: 35 / 65

### Notes/Rants/Excuses

Long CVD Axles Fitted (XF #5660)

If the track is smooth, try more pack in the rear: smaller piston, ~2.5 wt lighter oil.

Wing: X - 6 wing very cut down, mounted forward.

Battery: \_\_\_\_\_ Motor: \_\_\_\_\_ Gearing: \_\_\_\_\_ / \_\_\_\_\_ 78