



Driver: Craig Harris Date: 04.07.2009
 Track / Event: MBV Kampenhout - Belgian GP
 Layout: Open / Tight Surface: Smooth / Bumpy
 Grip: Low High Weather: Dry

Front Suspension



Ride Height: Wishbones level
 Camber: -2° Toe: 0°
 Ackerman: Forward Back

Servo: Fwd Back
 Axles: Trailing Inline
 Caster Block:
 20° 25° 30°

Washers 3



Axle Height:
 High
 Med
 Low



Washers 3
 Position:
 Fwd Back

Shocks & Tires

Brand	Spring	Piston	Oil
<u>Losi</u>	<u>Black</u>	<u>Red</u>	<u>37.5</u>

Limiter - Top: None Bottom: 2 mm
 Shock Length: _____
 Compressed Length: _____

Front Tire: Schumacher MiniSpike Slim Yellow
 Insert: Snee Blue

Rear Suspension



Ride Height: Driveshafts level
 Camber: -1°
 Transmission Height: Low

Sway Bar: AE Black

Arm Position:
 Back Mid Fwd

Washers 0

Wing Height
 E-Speed High
 OE-Speed Low



Anti-Squat:
3°

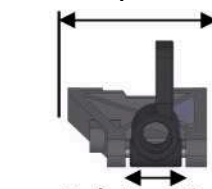

Hub Position:
 Back Mid Fwd

Shocks & Tires

Brand	Spring	Piston	Oil
<u>Losi</u>	<u>Pink</u>	<u>Red</u>	<u>30</u>

Limiter - Top: None Bottom: 4 mm
 Shock Length: _____
 Compressed Length: _____

Rear Tire: 4wd Front Mini Pins Yellow
 Insert: Snee Blue

Weight

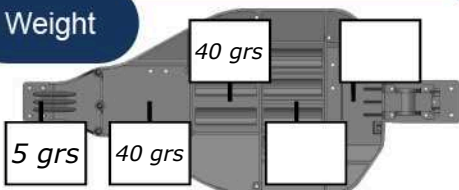

Total Weight: 1633 grs

F/R Bias: /

Notes / Rants / Excuses

ESC: LRP Sphere

Wing: X6 Stock w medium rear Gurnay, Azarashi front wing

Battery: TrackPower 4900 mAh LiPo Motor: 7.5 Gearing: 24 / 78