

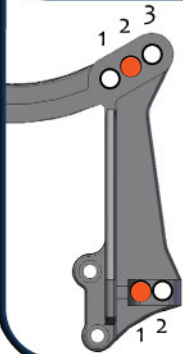

Driver: Ashley Caunt Date: 16.01.2010
 Track / Event: Maritime Raceway - Petit Race
 Layout: Open / Tight Surface: Smooth / Bumpy
 Grip: Low High Weather: _____

Front Suspension



Ride Height: 19 mm

Camber: -1° Toe: _____°

Ackerman: Forward Back

Washers
4

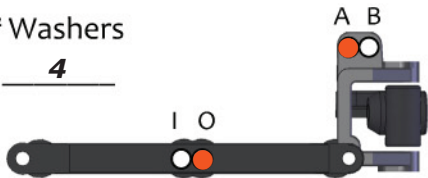

Axle Height:
 High
 Med
 Low

Servo: Fwd Back

Axles: Trailing Inline

Caster Block:
 20° 25° 30°

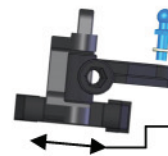

Washers
2
 Position:
 Fwd Back

Shocks & Tires

Brand	Spring	Piston	Oil
Losi	Black	Red	40 wt

Limiter - Top: _____ Bottom: _____

Shock Length: _____

Compressed Length: _____

Front Tire: Schuey Mini Pins Yellow
 Insert: Schumacher Green

Rear Suspension



Ride Height: 19 mm

Camber: -1°

Transmission Height: Low

Washers
-

Wing Height

OE-Speed High
 OE-Speed Low

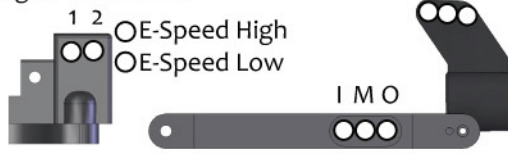

Sway Bar: 1.3mm

Arm Position:
 Back Mid Fwd

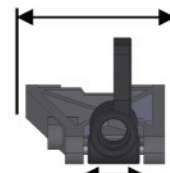

Hub Position:
 Back Mid Fwd



Anti-Squat:
1.5

Shocks & Tires

Brand	Spring	Piston	Oil
Losi	Pink	Red	35 wt

Limiter - Top: _____ Bottom: _____

Shock Length: _____

Compressed Length: _____

Rear Tire: Schuey Mini Pin Yellow
 Insert: Schumacher Blue

Weight

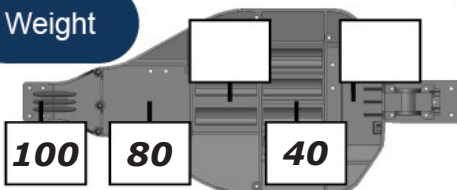

Total Weight: 1900

F/R Bias: _____ / _____

Notes / Rants / Excuses 4th E-Final Finishing

setup very stable and seems to work on most tracks

Wing: X-Factory X6 heavy Duty

Battery: Vampire 5200 35C Motor: Epic Duo 8.5 Gearing: 25 / 78