

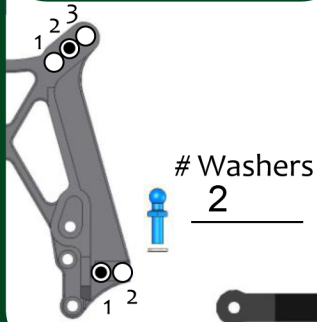

Driver: \_\_\_\_\_ Date: 2012

Track/Event: Starting Setup

**Front Suspension**



Ride Height: Arms Level  
 Camber: -1 ° Toe: 0 °  
 Ackerman:  Forward  Back

Servo:  Fwd  Back  
 Axles:  Trailing  Inline  
 Caster Block:  
 20°  25°  30°

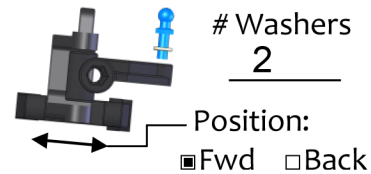
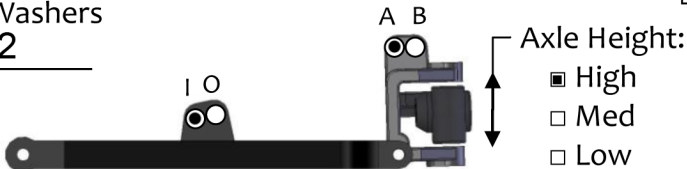

**Front Shocks**

	Spring	Piston	Oil
AE	Gold	#3	30
Losi			
Kyosho			

Shock Length: 5 limiters inside

Compressed Length: \_\_\_\_\_

**Rear Suspension**

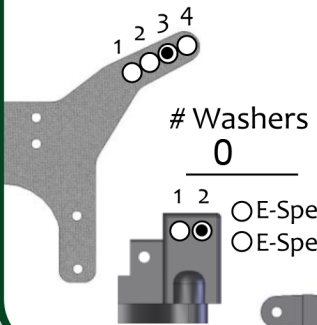

Ride Height: CVD's slightly above  
 Camber: -1 °  
 Transmission Height: .030"

Sway Bar: no  
 Arm Position:  
 Back  Mid  Fwd

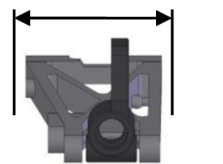
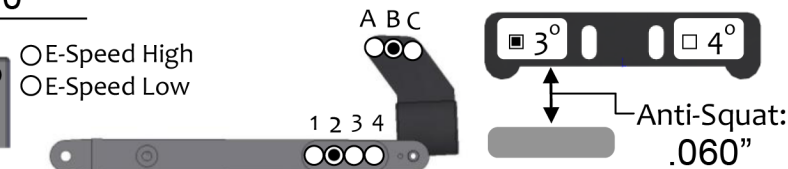

**Rear Shocks**

	Spring	Piston	Oil
AE	Green	#1	27.5
Losi			
Kyosho			

Shock Length: 2 limiters inside

Compressed Length: \_\_\_\_\_

**Weight**

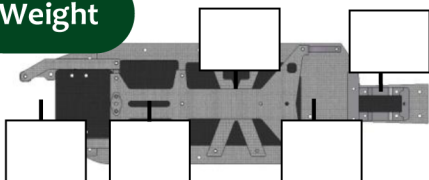

Total Weight: \_\_\_\_\_

F/R Bias: \_\_\_\_\_ / \_\_\_\_\_

**Notes/Rants/Excuses**

Setup for saddle packs. If you run a "shorty" battery, add weight in the rear to suit (probably ~35 to 50 grams)

Battery: \_\_\_\_\_ Motor: \_\_\_\_\_ Gearing: \_\_\_\_\_ / \_\_\_\_\_