



BUILDING
INSTRUCTIONS



INTRODUCTION



Thank you for purchasing the Tekno RC EB48.4 1/8th Scale 4WD Competition Electric Buggy Kit. We are always working on new projects, so please check our website at www.teknorc.com or our Facebook page at www.facebook.com/teknorc regularly for the latest news, parts, and kits.

Take your time! When you work your way through these building instructions, keep an eye out for the following important indicators below:

- **RED TEXT** - *This indicates important areas of the build process that should be observed.*



Thread Lock icons

Thread lock is always used when a screw is inserted into any metal part. (Included with kit)



Grease icons

Grease is usually used on areas with movement and for sealing. (Included with kit)

- **YOUTUBE** - *We also have many useful build videos on Youtube, so be sure to check these out!*
<https://www.youtube.com/c/teknorc>

Additional equipment and parts needed:

- Paint for body
- 1/8th scale ESC and motor system
- High torque steering servo (at least 300 oz/in)
- 4s (4 cell, 14.8v) LiPo battery (at least 5000mAh)
- 1/8th scale tires, wheels & CA glue (or premounts)
- MOD1 Pinion 15 tooth - 25 tooth (TKR4175 - TKR4185)

Tools needed:

- Hex drivers 1.5mm (TKR1104), 2.0mm (TKR1105), 2.5mm (TKR1106)
- Nut drivers 5.0mm (TKR1107), 5.5mm (TKR1108), 7.0mm (TKR1109)
- Hobby knife
- Needle-nose pliers
- Shock tool (TKR1115) OR adjustable (Crescent) wrench (for shock assembly)
- 17mm Wheel Wrench (TKR1116)
- 4mm turnbuckle wrench (TKR1103) - 5.5/7.0 two sided wrench (TKR1119)
- 4mm arm reamer (or #19 drill bit)

Disclaimer: Tekno RC is not responsible or liable for any property or personal damage, loss, or injury incurred as a result of using this product. This kit is meant for use by persons 14 years of age or older and in the strict confines of a legally permitted RC track or facility.

Warnings: Always double-check that your radio gear is working properly before operating vehicle. Never operate the vehicle indoors (unless the RC track is an indoor facility). Use caution while operating vehicle so as not to collide with people who may be turn marshalling or who might otherwise not be aware that a fast moving RC vehicle is in the vicinity.

Warranty: We warrant that the parts included in this kit are free from defects. If you find a defective part in your kit, please contact us @ info@teknorc.com and we will help you to resolve the issue. We do not warranty parts that may be broken during operation of the vehicle or otherwise. Refer to the end of this instruction manual for a listing of spare/replacement and option parts. All spare parts and other info are available on our website (www.teknorc.com) and through our network of domestic and international dealers and distributors.

BAG C

FRONT GEARBOX (OVERVIEW)

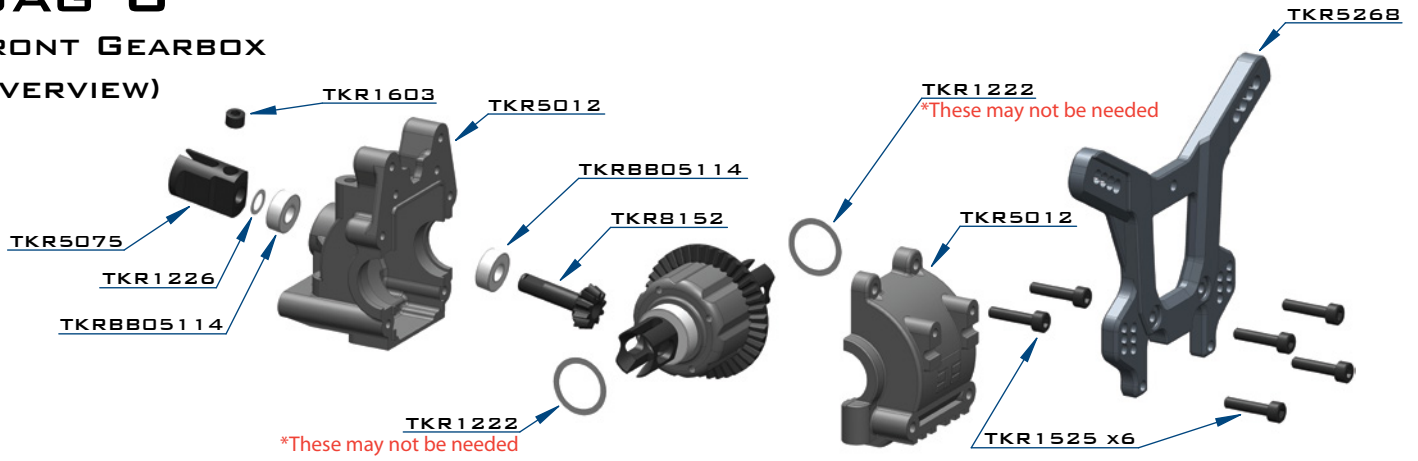

STEP C-1

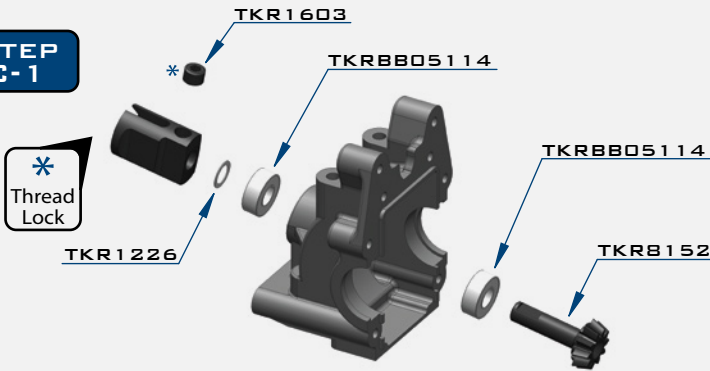

INNER BULKHEADS

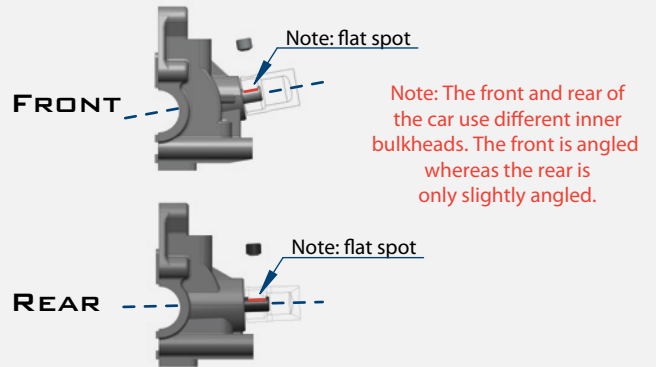

Note Step C-2: To properly shim the diff, start by test fitting the diff with no shims and check for side to side play. If no (or very little) play is present, then continue on to the next step. If you feel excessive side to side play, then start by adding one shim on the gear side of the diff assembly. This will move the mesh tighter and remove any play. If the mesh is too tight at this point, move the shim to the other side. In some rare cases, two shims may be necessary.

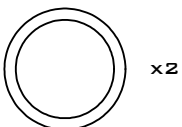

x2
TKR1222
13X16XD.1MM DIFF SHIM



x1
TKR1226
5X7XD.2MM SHIM

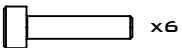

x6
TKR1525
M3X14MM CAP HEAD SCREW



x1
TKR1603
M5X4MM SET SCREW



x2
TKRBB05114
BALL BEARING (5X11X4)

STEP C-2

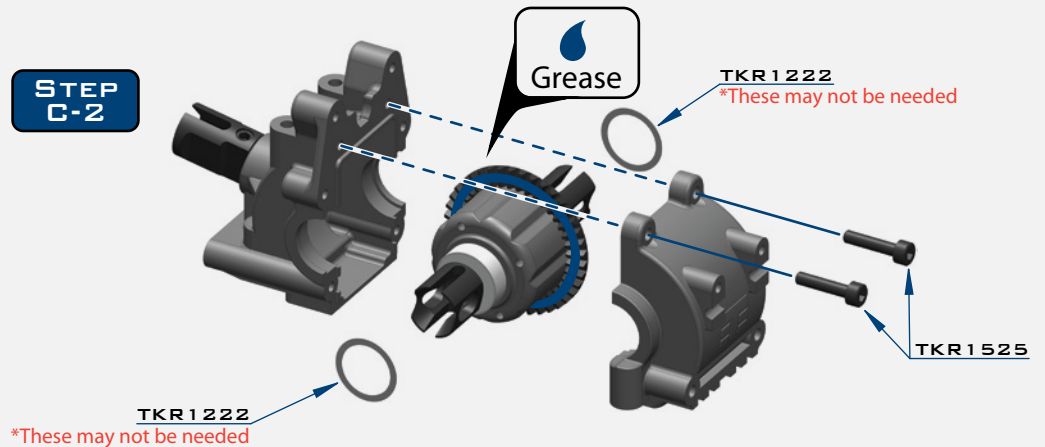

STEP C-3

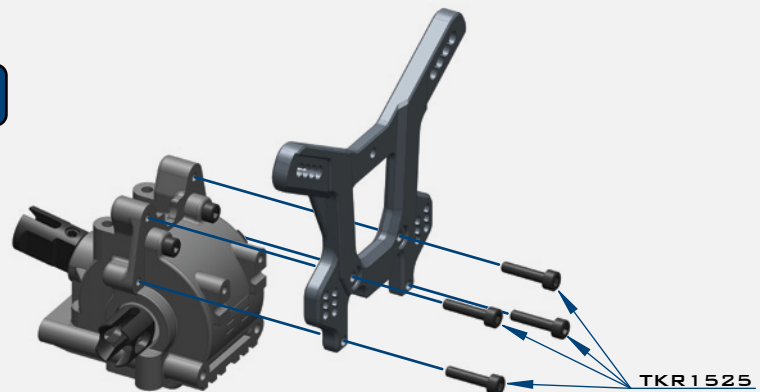

BAG D

REAR GEARBOX (OVERVIEW)

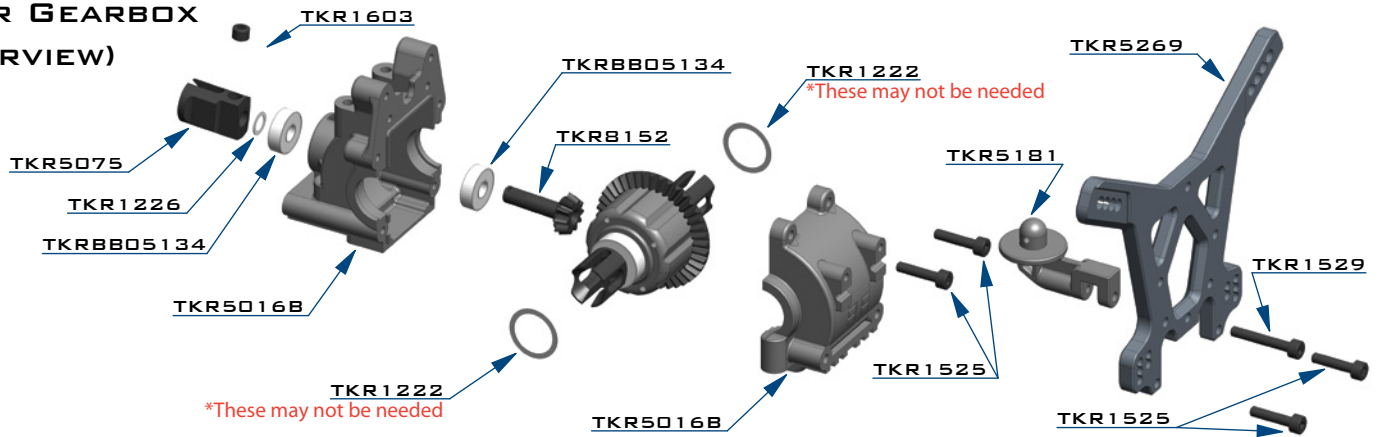

STEP D-1

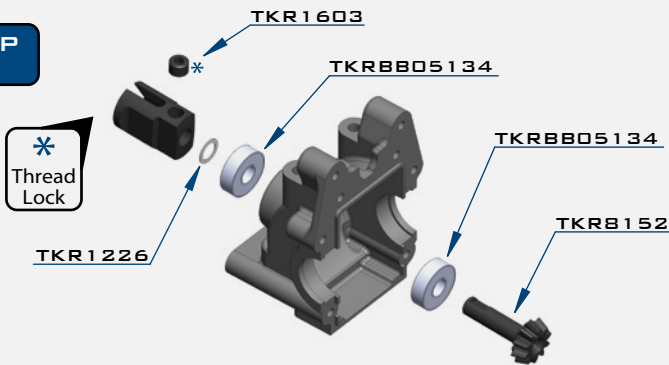

INNER BULKHEADS

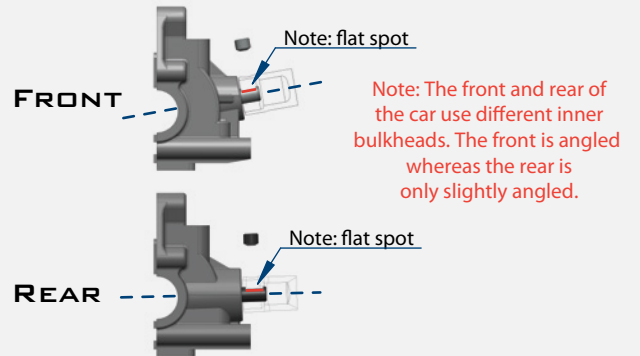

Note Step D-2: To properly shim the diff, start by test fitting the diff with no shims and check for side to side play. If no (or very little) play is present, then continue on to the next step. If you feel excessive side to side play, then start by adding one shim on the gear side of the diff assembly. This will move the mesh tighter and remove any play. If the mesh is too tight at this point, move the shim to the other side. In some rare cases, two shims may be necessary.

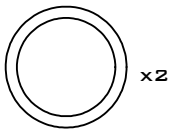

TKR1222
13X16X0.1MM DIFF SHIM



TKR1226
5X7X0.2MM SHIM

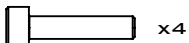

TKR1525
M3X14MM CAP HEAD SCREW

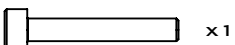

TKR1529
M3X20MM CAP HEAD SCREW



TKR1603
M5X4MM SET SCREW

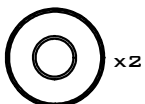

TKRBB05134
BALL BEARING (5X13X4)

STEP D-2

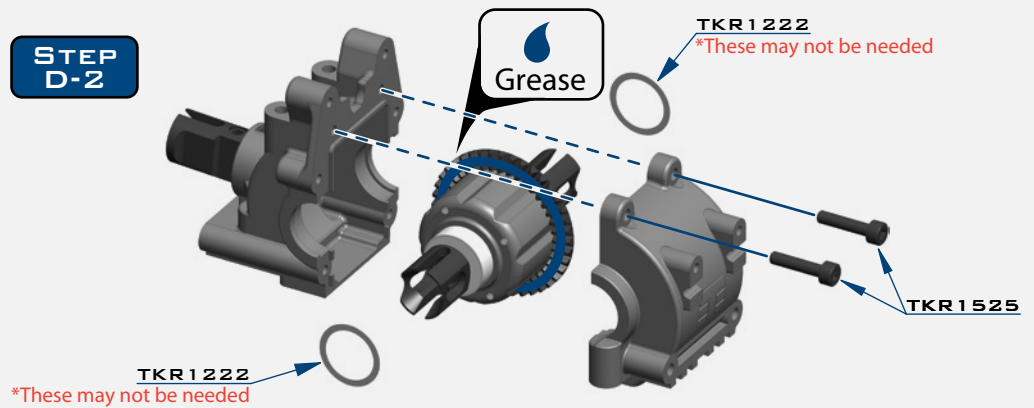

STEP D-3

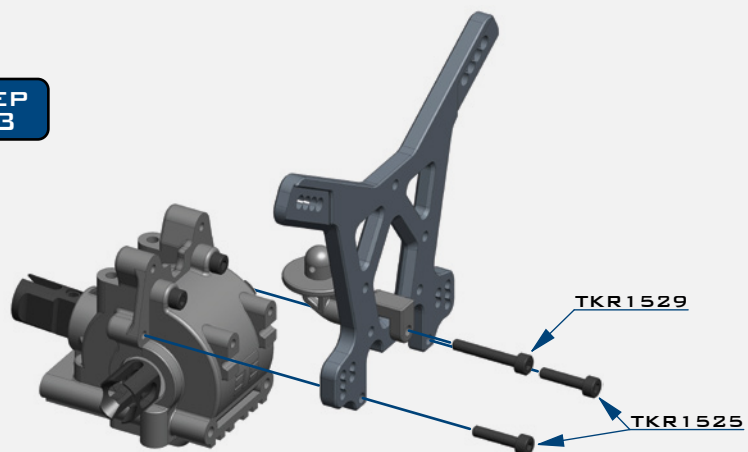

BAG E

LOW PROFILE WING MOUNT

SETTINGS

POSITION SETTINGS

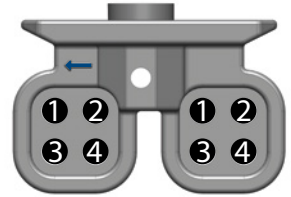

- 1 - REARWARD LOW
- 2 - FORWARD LOW
- 3 - REARWARD HIGH
- 4 - FORWARD HIGH

Note: Stock position setting is #2, Forward Low

DOWNFORCE SETTINGS

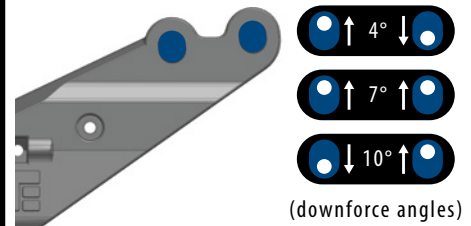

(downforce angles)

Note: Stock downforce setting is 4°

STEP E-1

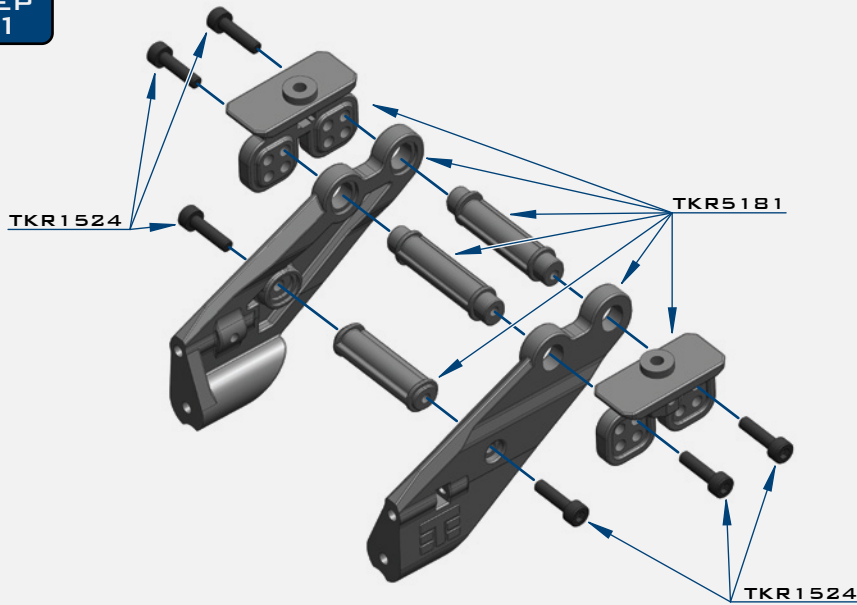

STEP E-2

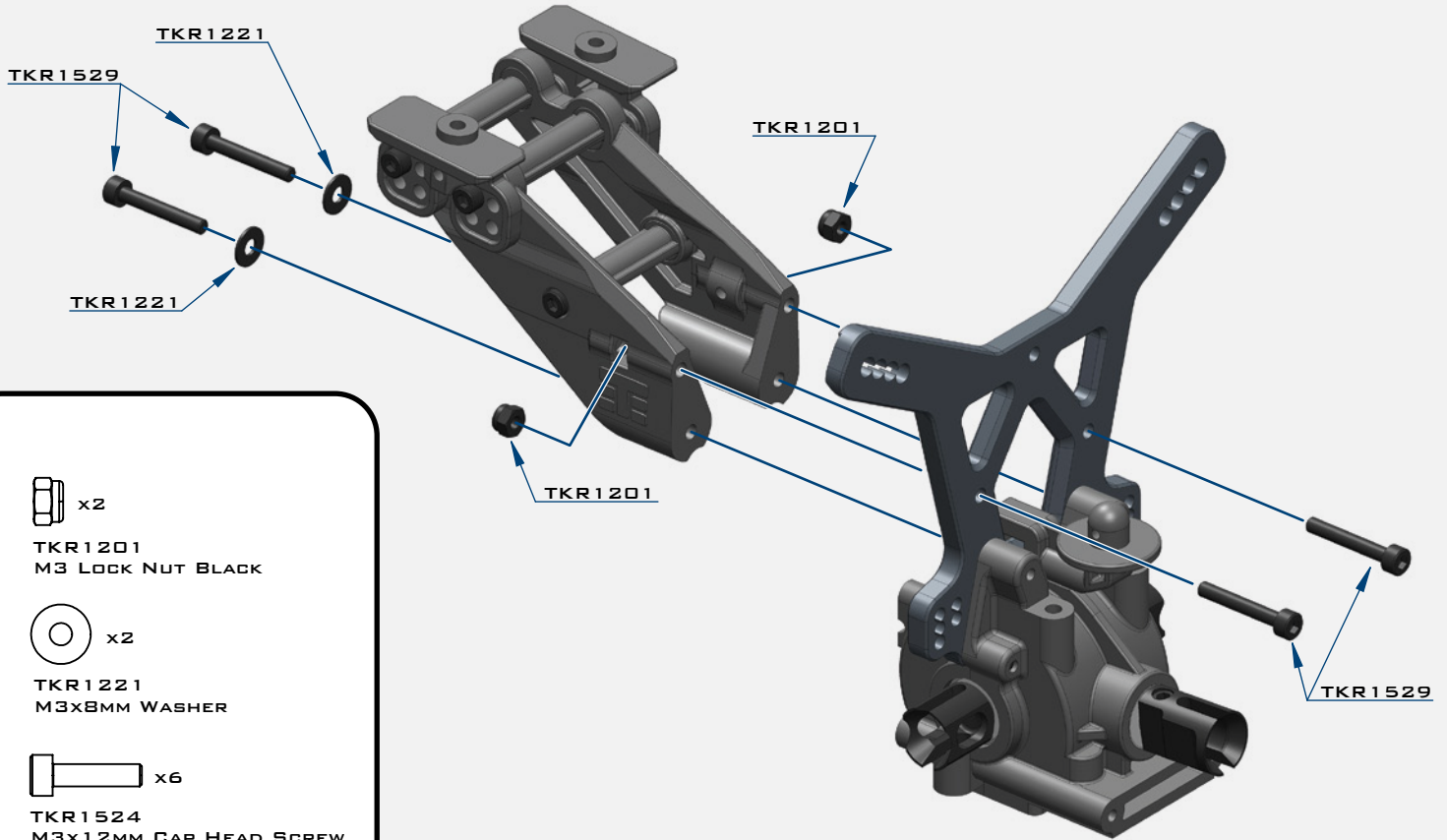

 x2
TKR1201
M3 LOCK NUT BLACK

 x2
TKR1221
M3X8MM WASHER

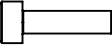
 x6
TKR1524
M3X12MM CAP HEAD SCREW

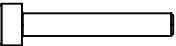
 x4
TKR1529
M3X20MM CAP HEAD SCREW

BAG F

REAR END

STEP F-1

- TKR5491 - 2.4MM
- *TKR5490 - 2.3MM
- *TKR5492 - 2.5MM
- *TKR5493 - 2.6MM
- *TKR5494 - 2.8MM
- *TKR5495 - 3.0MM (OPTION)

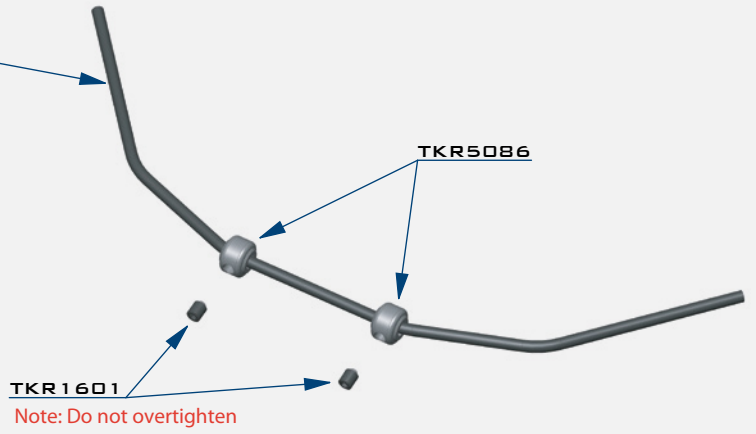
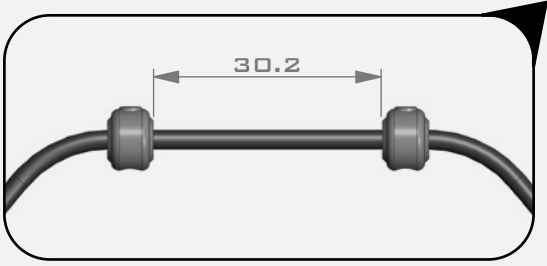

STEP F-2

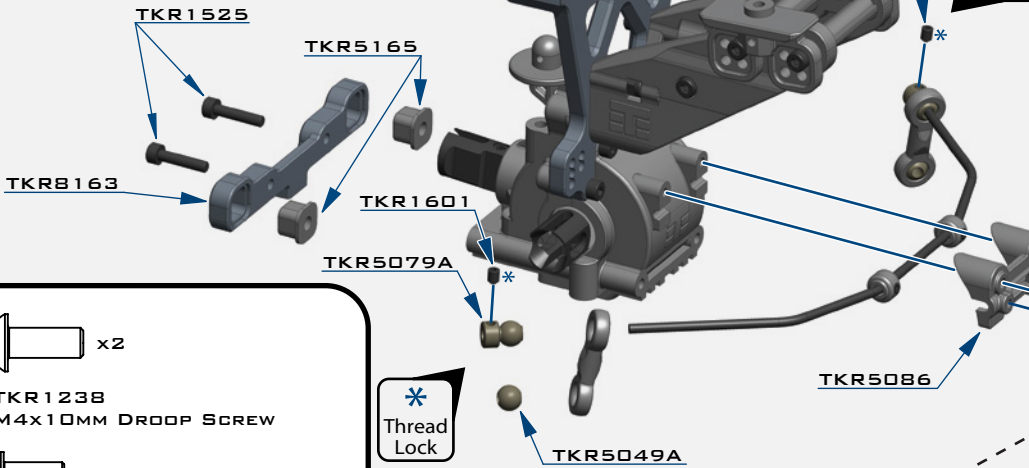

Pivot Ball Orientation

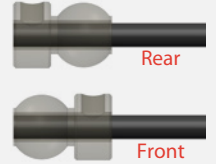

Install the sway bar ball onto the sway bar wire until the end of the wire is flush with the ball collar as pictured above.

("C" Block)



Stock Position

TKR1522

TKR1601

Note: Loosen the M3x4 set screw (TKR1601) if the sway bar does not turn freely.

("D" Block)



Stock Position

Note: With these stock settings, Anti-Squat = 2° / Rear Toe = 2.5°
For reference, with center dot inserts in both braces, Toe = 3° / Anti-Squat = 2°

STEP F-3

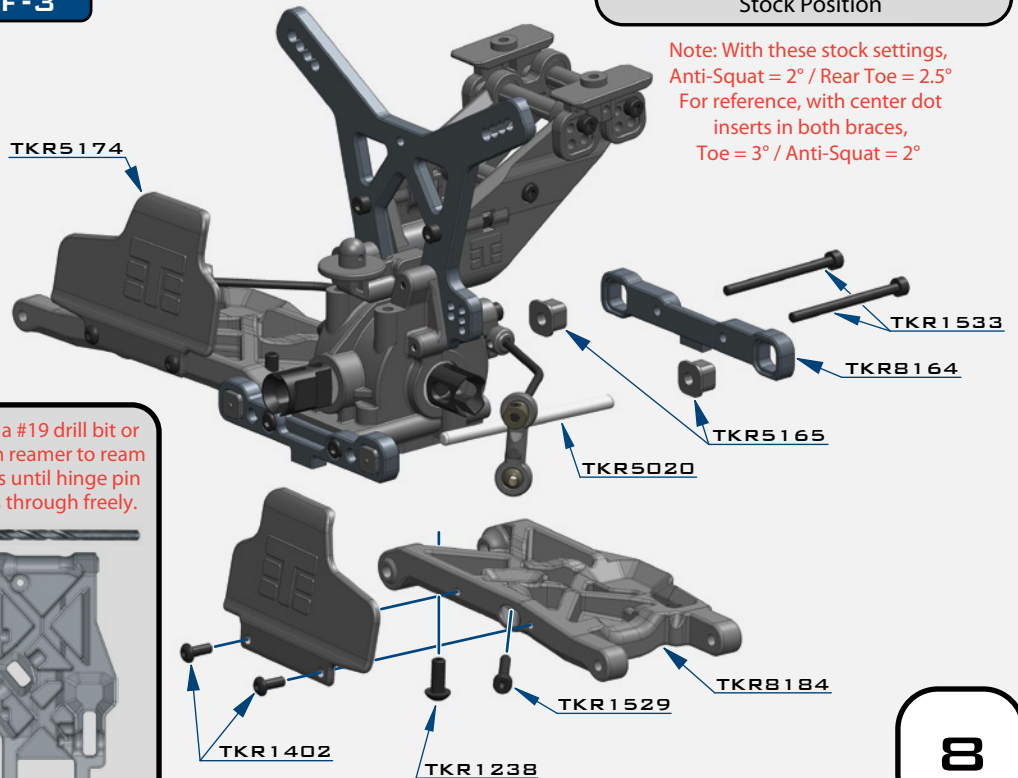

Use a #19 drill bit or 4mm reamer to ream arms until hinge pin falls through freely.

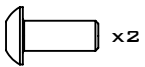
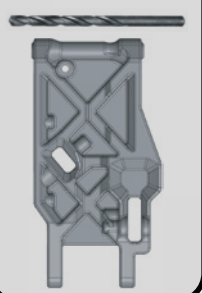

TKR1238
M4x10MM DROOP SCREW

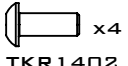

TKR1402
M3x8MM BUTTON HEAD SCREW



TKR1522
M3x8MM CAP HEAD SCREW

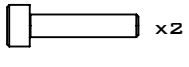

TKR1525
M3x14MM CAP HEAD SCREW

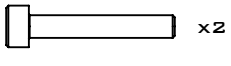

TKR1529
M3x20MM CAP HEAD SCREW

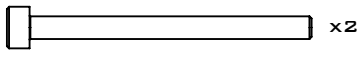

TKR1533
M3x40MM CAP HEAD SCREW



TKR1601
M3x4MM SET SCREW



TKR5049A
PIVOT BALL SWAY BAR



TKR5079A
STABILIZER BALL

BAG G

REAR HUB/CVA ASSEMBLY

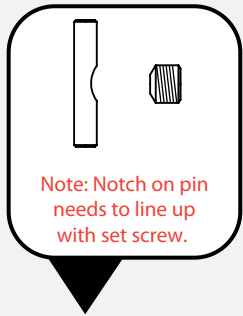



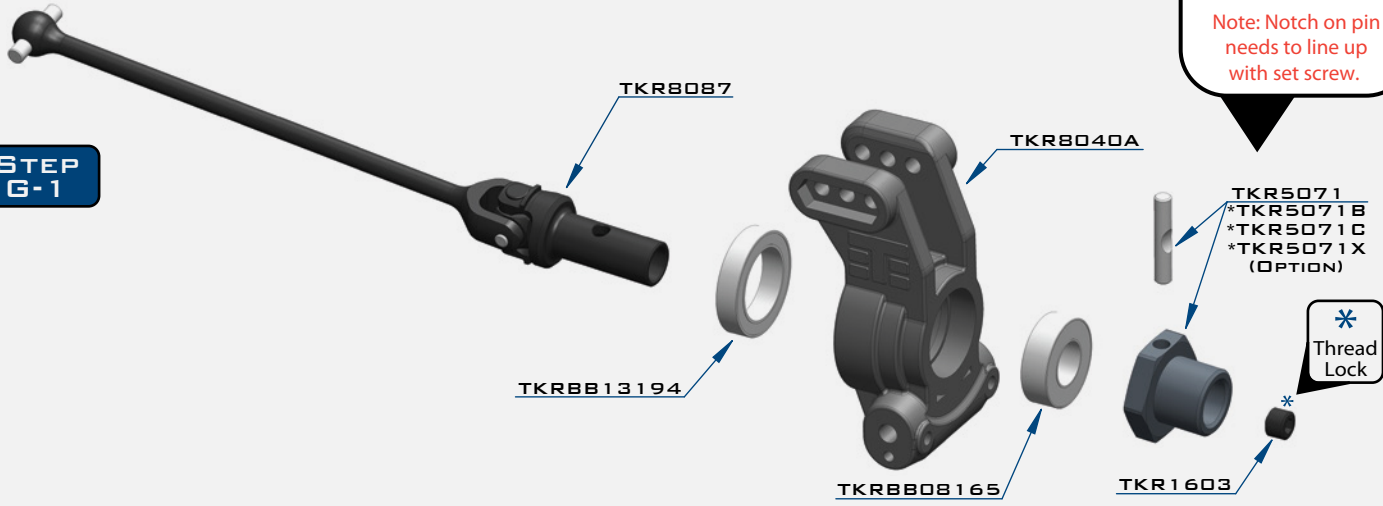

STEP G-1

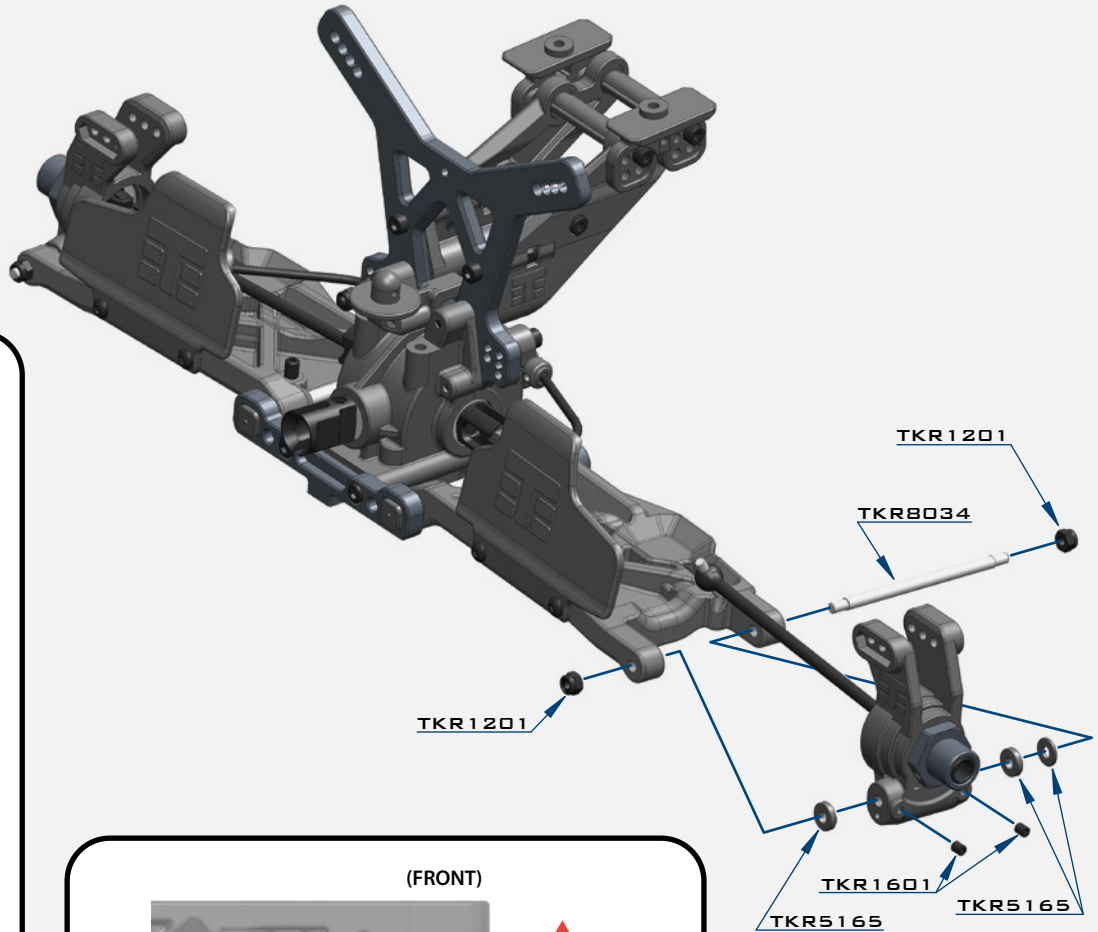

STEP G-2

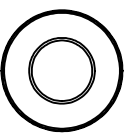
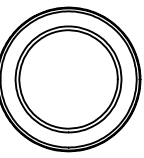

-  x4
TKR1201
M3 LOCKNUT BLACK
-  x4
TKR1601
M3X4MM SET SCREW
-  x2
TKR1603
M5X4MM SET SCREW
-  x2
TKR5071
M3X16.8MM PIN
-  x2
TKRBB08165
BALL BEARING (8X16X5)
-  x2
TKRBB13194
BALL BEARING (13X19X4)

(FRONT)

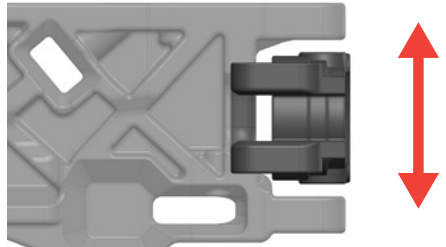

(REAR)

Changes to the wheelbase have a dramatic effect on handling, since it shifts the distribution of weight over the rear wheels. This adjusts traction. By shortening the wheelbase at the rear, you are placing more weight over the rear wheels.

Changes to the wheelbase also change the amount of sweep the rear driveshaft will have. More driveshaft sweep creates an effect similar to anti-squat, where the rear end gets pushed upwards on throttle. This helps reduce chassis slap when landing jumps on throttle.

BAG G

REAR CAMBER LINKS

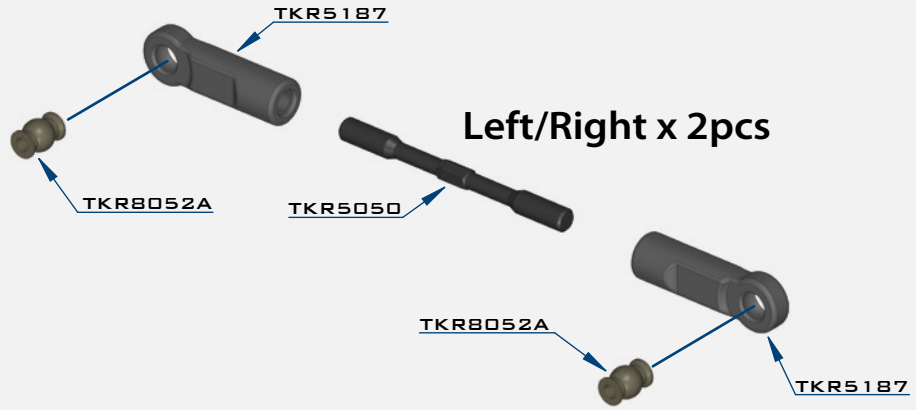

STEP
G-3

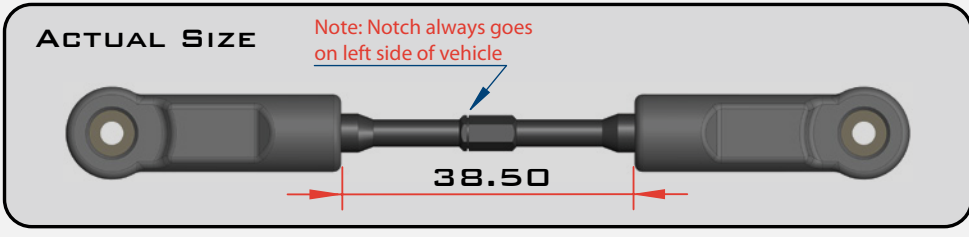

STEP
G-4

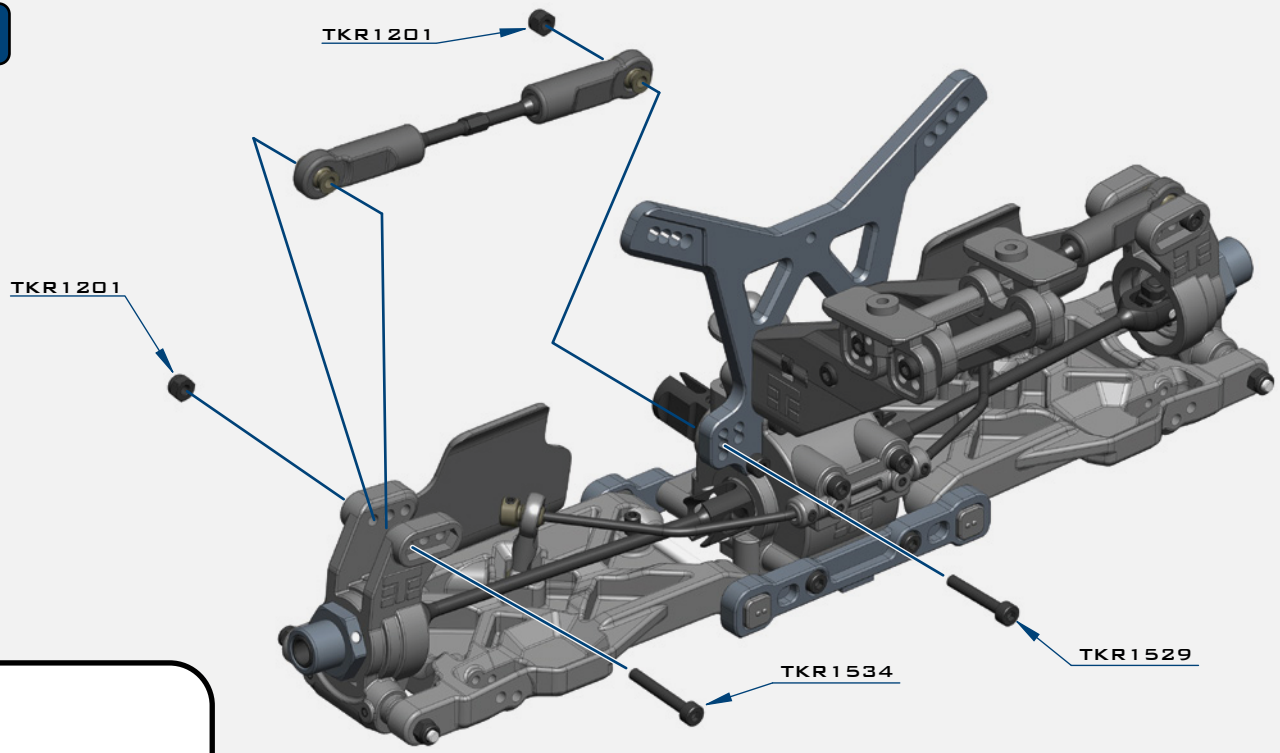

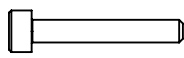
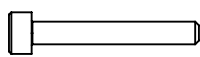
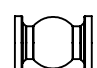
-  x4
TKR1201
M3 LOCKNUT BLACK
-  x2
TKR1529
M3X20MM CAP HEAD SCREW
-  x2
TKR1534
M3X22MM CAP HEAD SCREW
-  x2
TKR8052A
PIVOT BALL M3X6.8MM

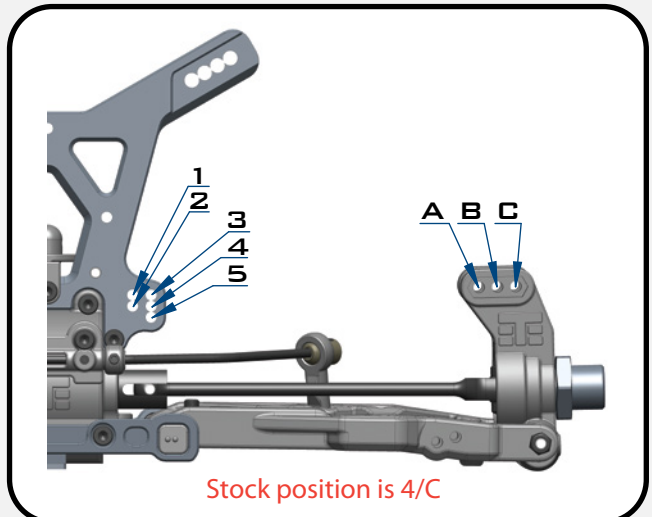

BAG H

FRONT END

STEP H-1

- TKR5081 - 2.3MM
- *TKR5080 - 2.2MM
- *TKR5082 - 2.4MM
- *TKR5083 - 2.5MM
- *TKR5084 - 2.6MM
- *TKR5085 - 2.8MM
- *TKR5087 - 3.0MM (OPTION)

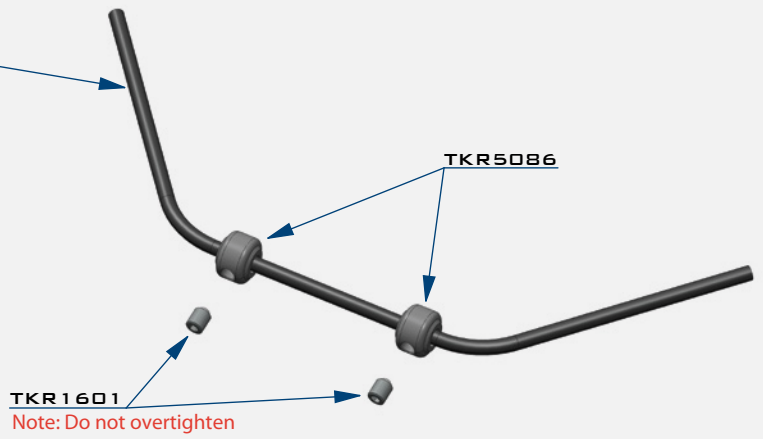
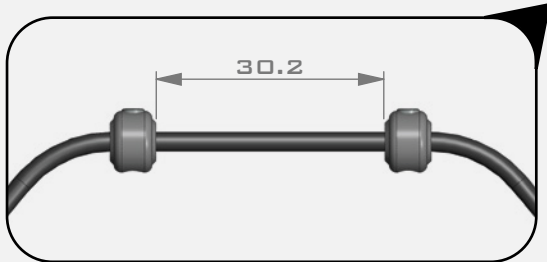

STEP H-2

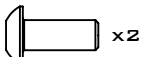
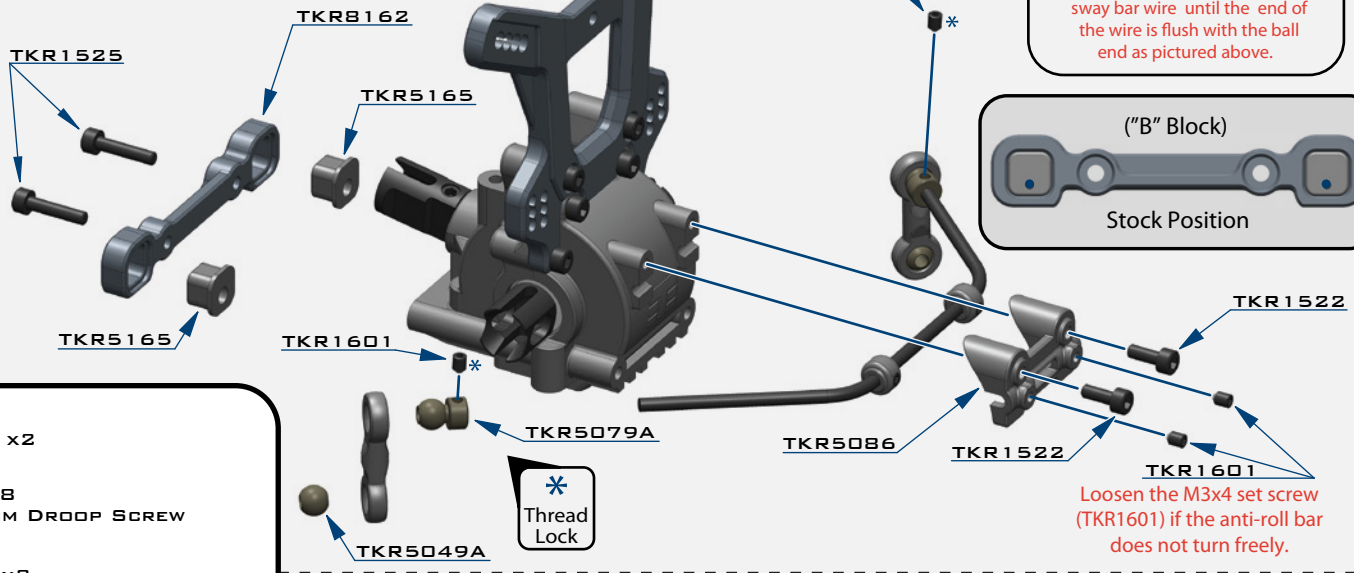

x2
TKR1238
M4X10MM DROOP SCREW



x2
TKR1522
M3X8MM CAP HEAD SCREW

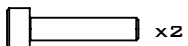

x2
TKR1525
M3X14MM CAP HEAD SCREW

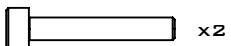

x2
TKR1529
M3X20MM CAP HEAD SCREW

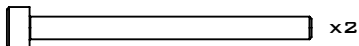

x2
TKR1533
M3X40MM CAP HEAD SCREW



x6
TKR1601
M3X4MM SET SCREW



x2
TKR5049A
PIVOT BALL SWAY BAR

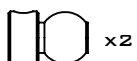

x2
TKR5079A
STABILIZER BALL

STEP H-3

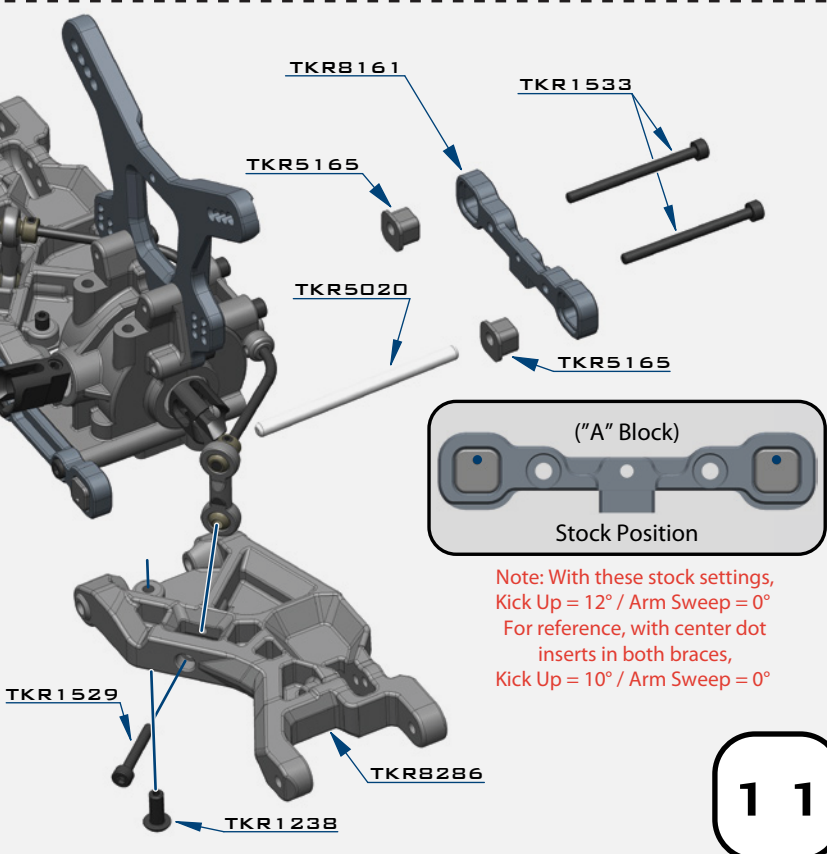

BAG I

FRONT SPINDLE / CVA ASSEMBLY

STEP I-1

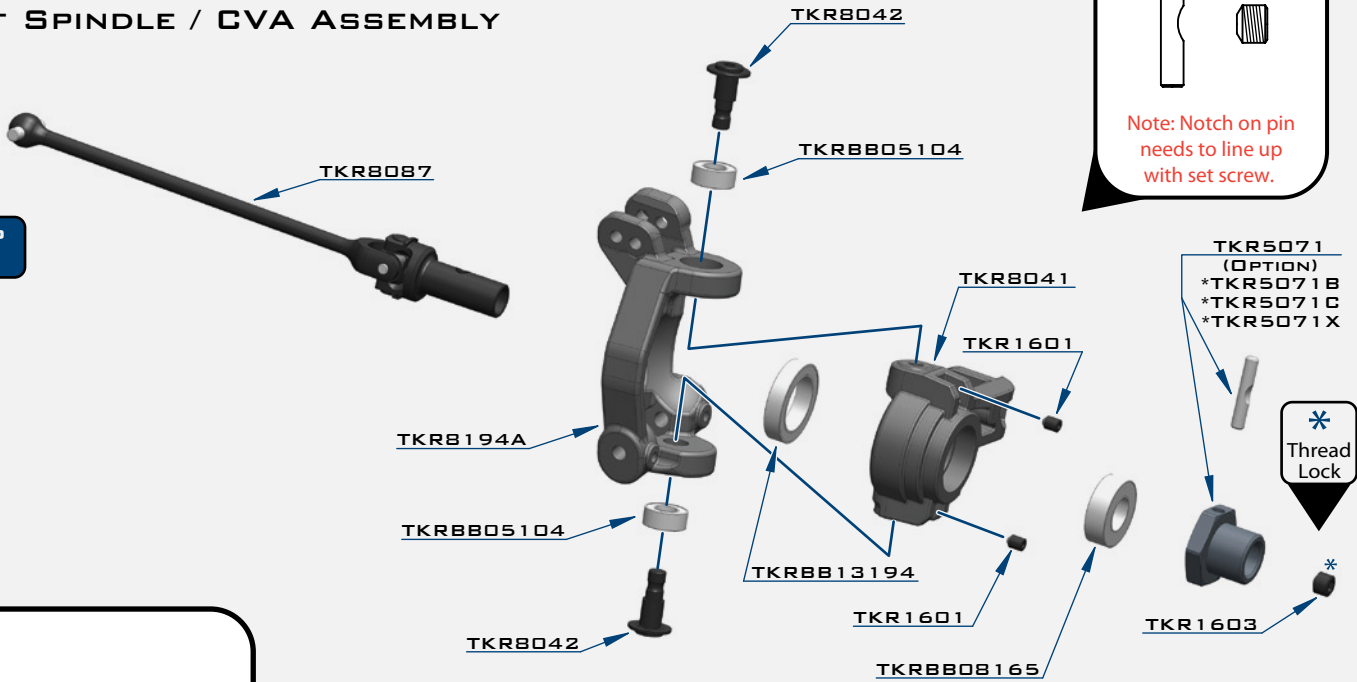

 x4
TKR1201
M3 LOCKNUT BLACK

 x2
TKR1221
M3x8MM WASHER

 x2
TKR1401
M3x6MM BUTTON HEAD SCREW

 x8
TKR1601
M3x4MM SET SCREW

 x2
TKR1603
M5x4MM SET SCREW

 x2
TKR5071
M3x16.8MM PIN

 x4
TKRBB05104
BALL BEARING (5x10x4)

 x2
TKRBB08165
BALL BEARING (8x16x5)

 x2
TKRBB13194
BALL BEARING (13x19x4)

Note: The TKR1601 set screws are meant to keep the TKR8042 screws from coming loose. After installing TKR8042 and ensuring the steering action is free, install TKR1601 in the locations indicated. Very slowly tighten the screws until you feel some resistance from contacting the TKR8042 screws. DO NOT OVERTIGHTEN. Also be sure to loosen TKR1601 before unscrewing TKR8042 or you will damage the screws and the parts.

DO NOT SKIP THIS STEP!

STEP I-2

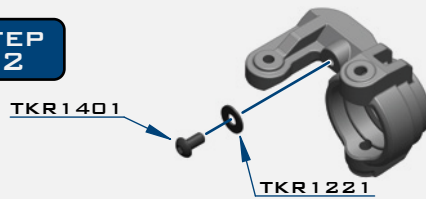

Note: The steering stops provide adjustable travel limiters to control overall steering throw. We recommend 1 washer on each side. With too much steering travel, the rear end will lose traction around corners, the vehicle will be very hard to drive and it will be more prone to breaking parts.

STEP I-3

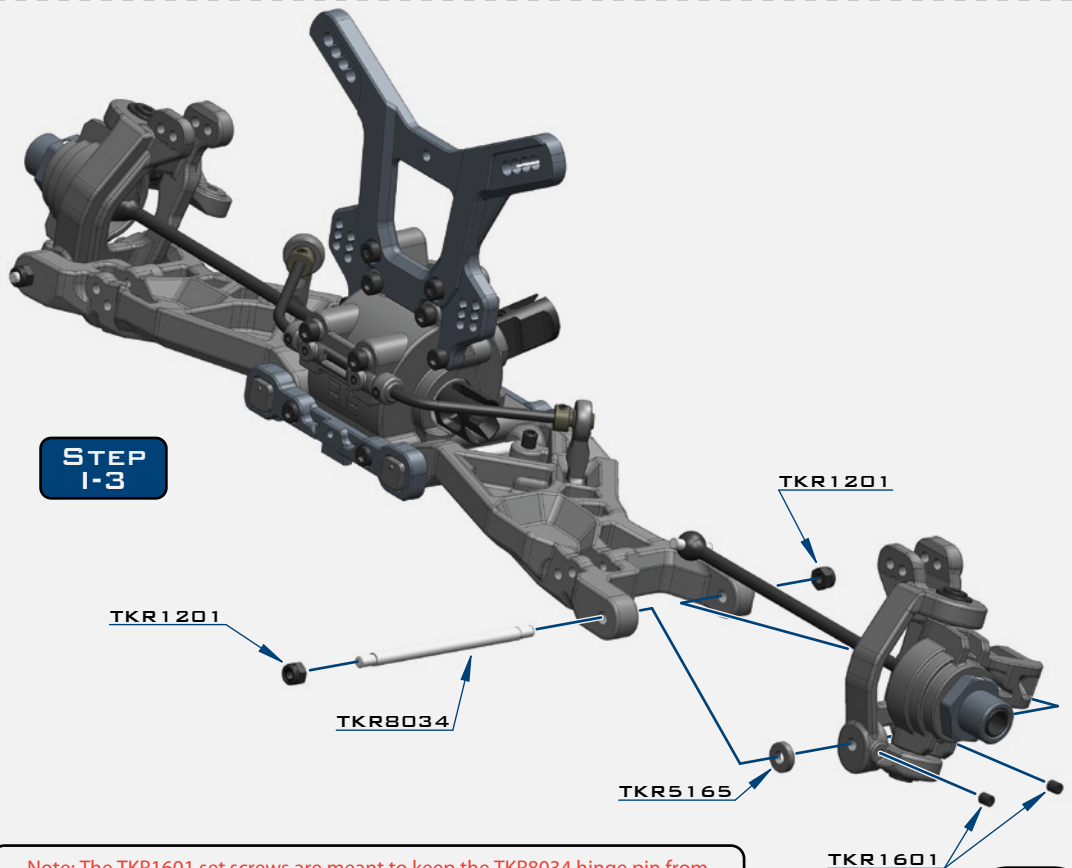

Note: The TKR1601 set screws are meant to keep the TKR8034 hinge pin from rotating. After installing TKR8034, install the TKR1601 in the locations indicated. Very slowly tighten the screws until you feel some resistance from contacting the TKR8034 hinge pin. DO NOT OVERTIGHTEN. Also be sure to loosen TKR1601 before removing TKR8034 or you will damage the hinge pin.

BAG I

FRONT CAMBER LINKS

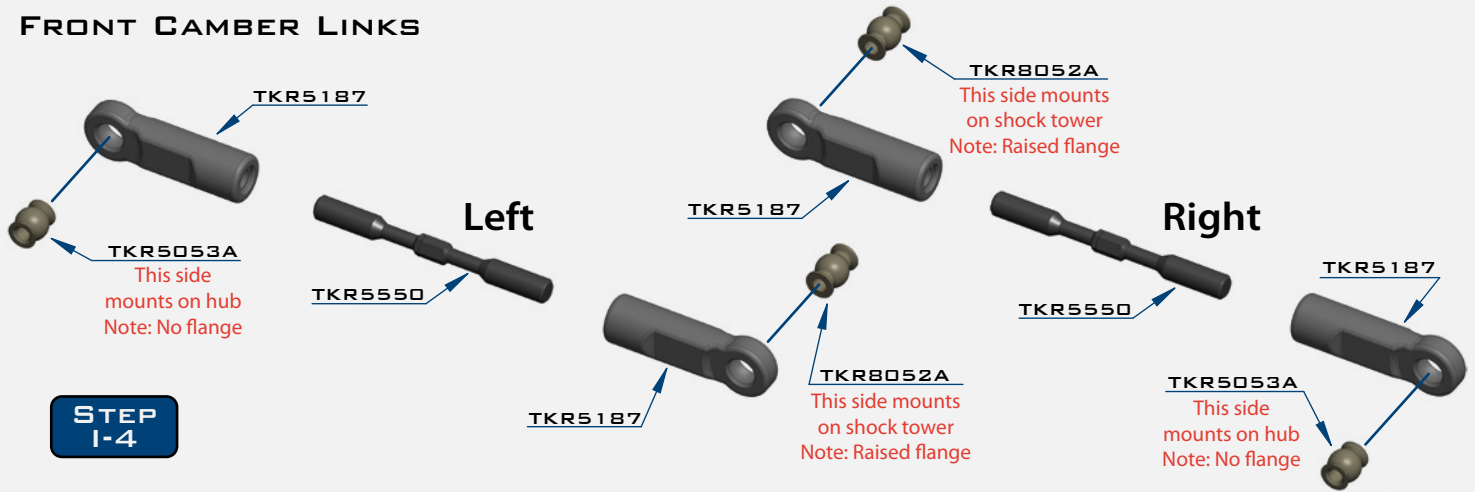

STEP
1-4

STEP
1-5

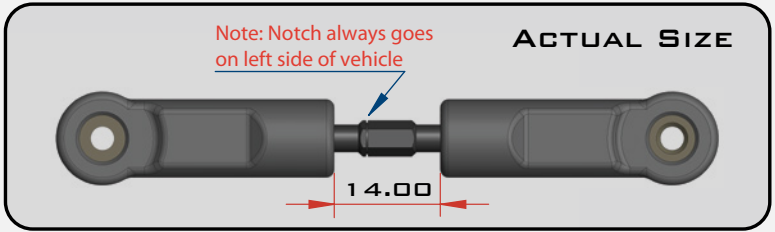
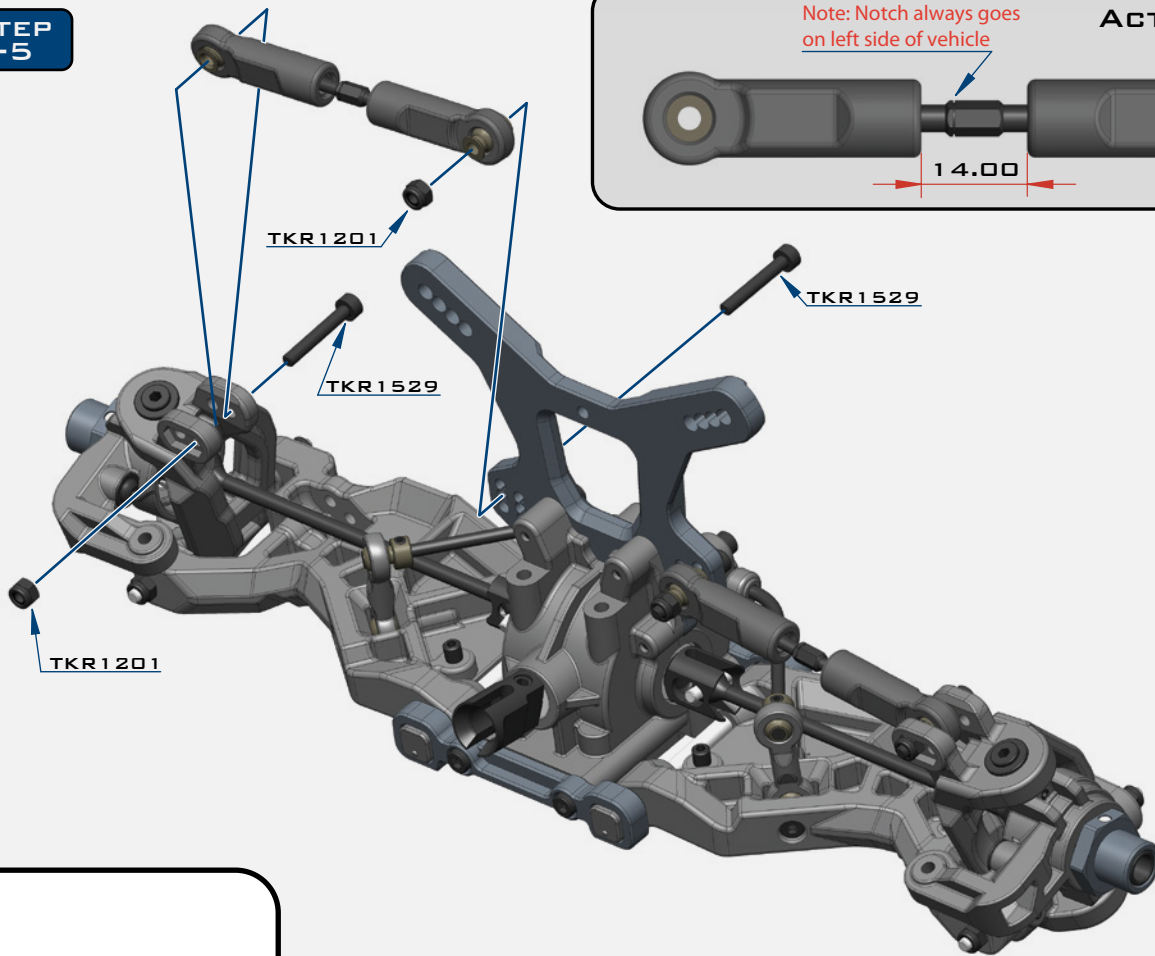

x4
TKR1201
M3 LOCK NUT BLACK

x4
TKR1529
M3X20MM CAP HEAD SCREW

x2
TKR5053A
PIVOT BALL M3X6.8MM
NO FLANGE

x2
TKR8052A
PIVOT BALL M3X6.8MM

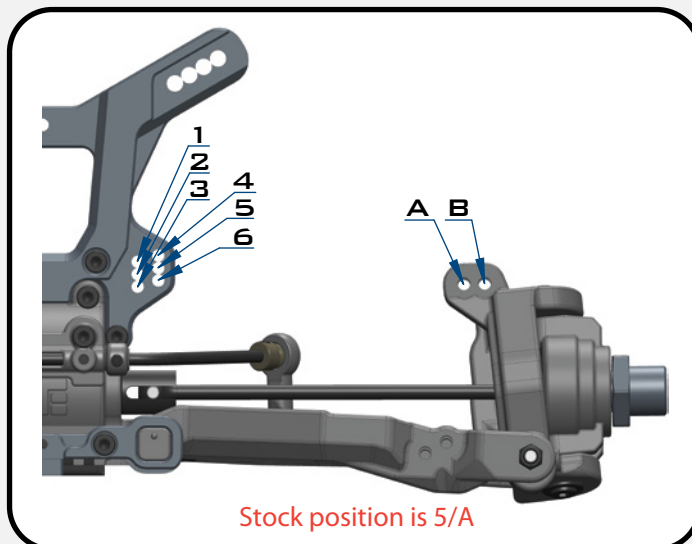

BAG J

STEERING ASSEMBLY (OVERVIEW)

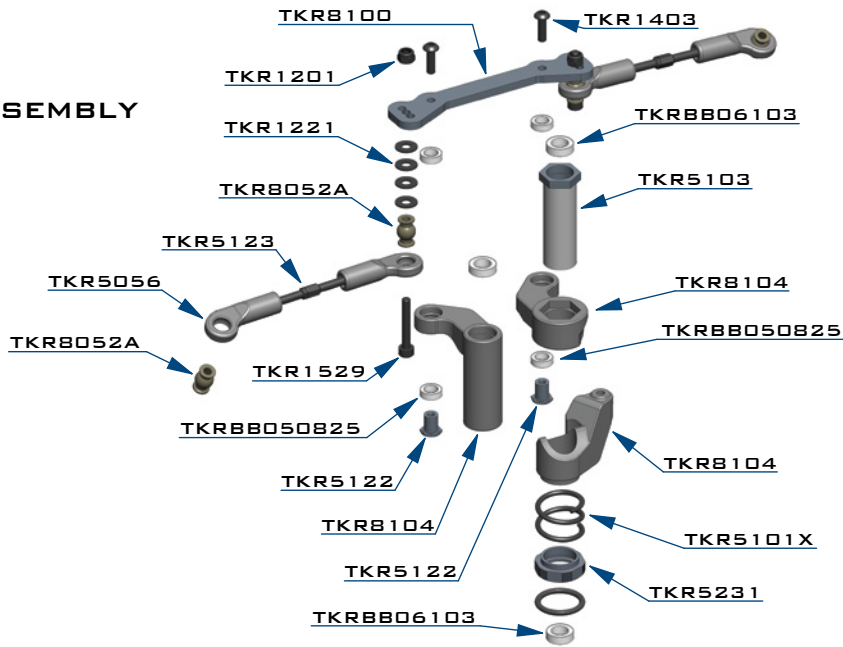

STEP J-1





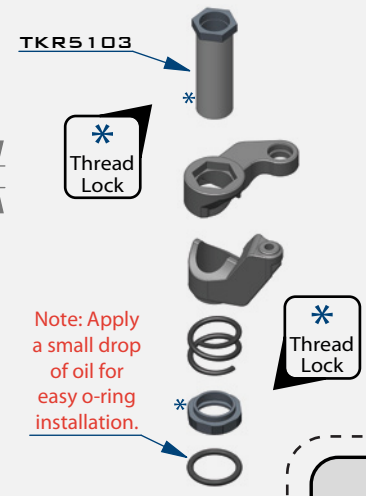



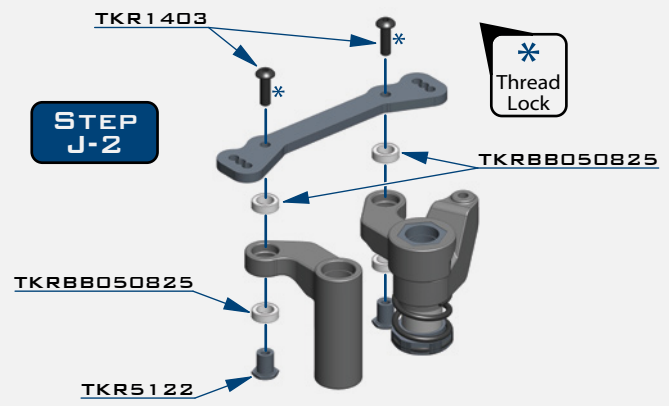

Note: Tighten nut all the way down, then back it off 3 full turns



Note: Apply a small drop of oil for easy o-ring installation.

STEP J-2



-  x2
TKR1201
M3 LOCK NUT BLACK
-  x8
TKR1221
M3X8MM WASHER
-  x2
TKR1403
M3X10MM BUTTON HEAD SCREW
-  x2
TKR1529
M3X20MM CAP HEAD SCREW
-  x4
TKR8052A
PIVOT BALL M3X6.8MM
-  x1
TKR5231
O-RING 16X12X2
-  x4
TKRBB050825
BALL BEARING (5X8X2.5)
-  x4
TKRBB06103
BALL BEARING (6X10X3)

STEP J-3

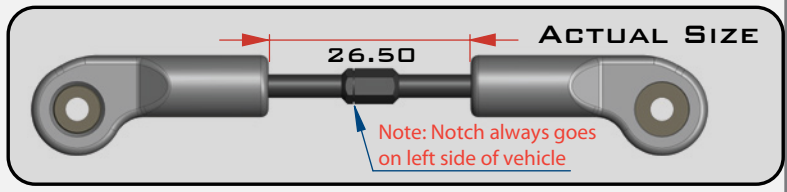

Left/Right x 2pcs

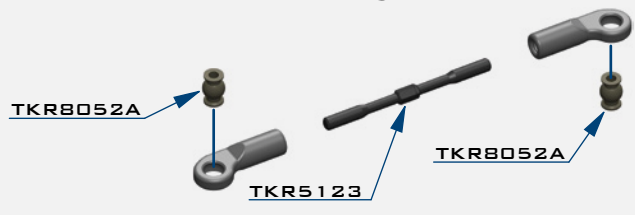

STEP J-4

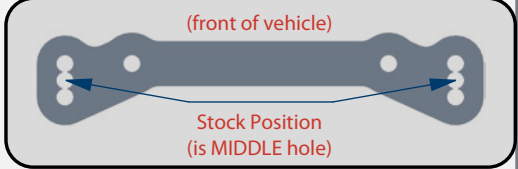
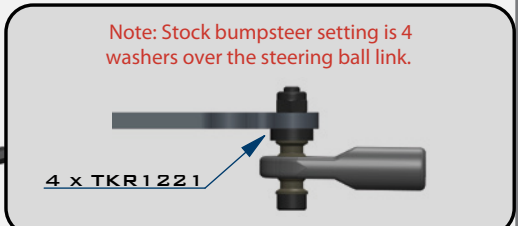
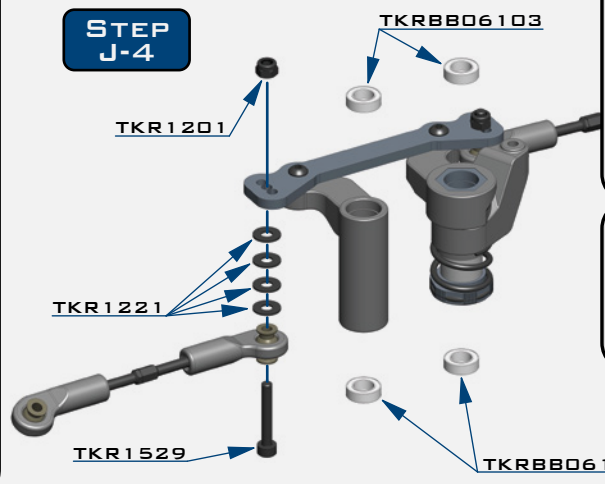

BAG K

FRONT END ASSEMBLY

STEP K-1

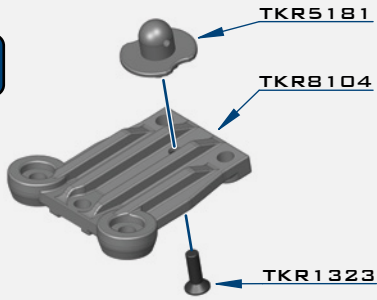

STEP K-2

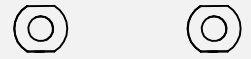
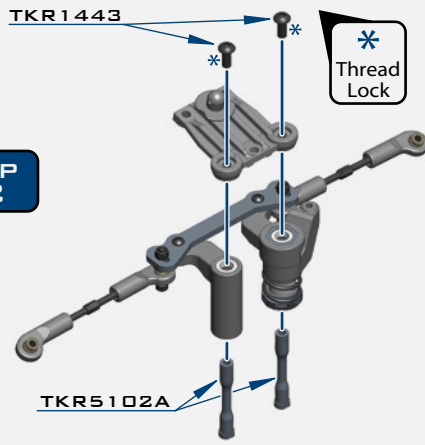

Note: On step K-4:
Line up the bottom of the steering posts (TKR5102A) with the corresponding recess cut in the chassis.

STEP K-3

Note: Initial bumpsteer setting is four washers below the steering ball link.

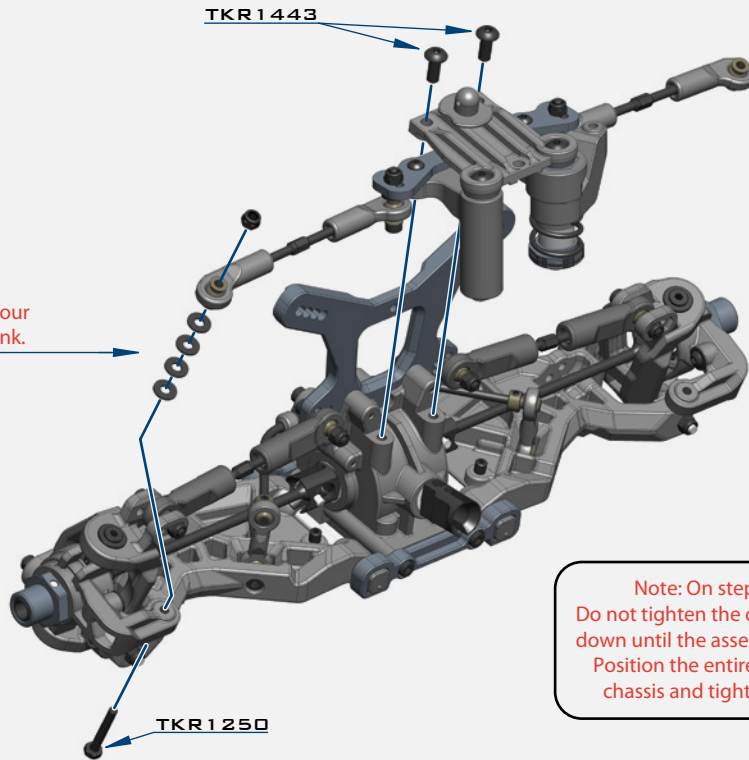

Note: On steps K-2, K-3 and K-4:
Do not tighten the chassis screws all the way down until the assembly steps are complete. Position the entire front assembly on the chassis and tighten each screw evenly.

x2
TKR1201
M3 LOCK NUT BLACK

x8
TKR1221
M3x8MM WASHER

x2
TKR1250
M3 STEERING LINK SCREW

x1
TKR1323
M3x10MM FLAT HEAD SCREW

x2
TKR1343
M4x10MM FLAT HEAD SCREW

x6
TKR1344
M4x12MM FLAT HEAD SCREW

x5
TKR1443
M4x10MM BUTTON HEAD SCREW

x1
TKR1522
M3x8MM CAP HEAD SCREW

STEP K-4

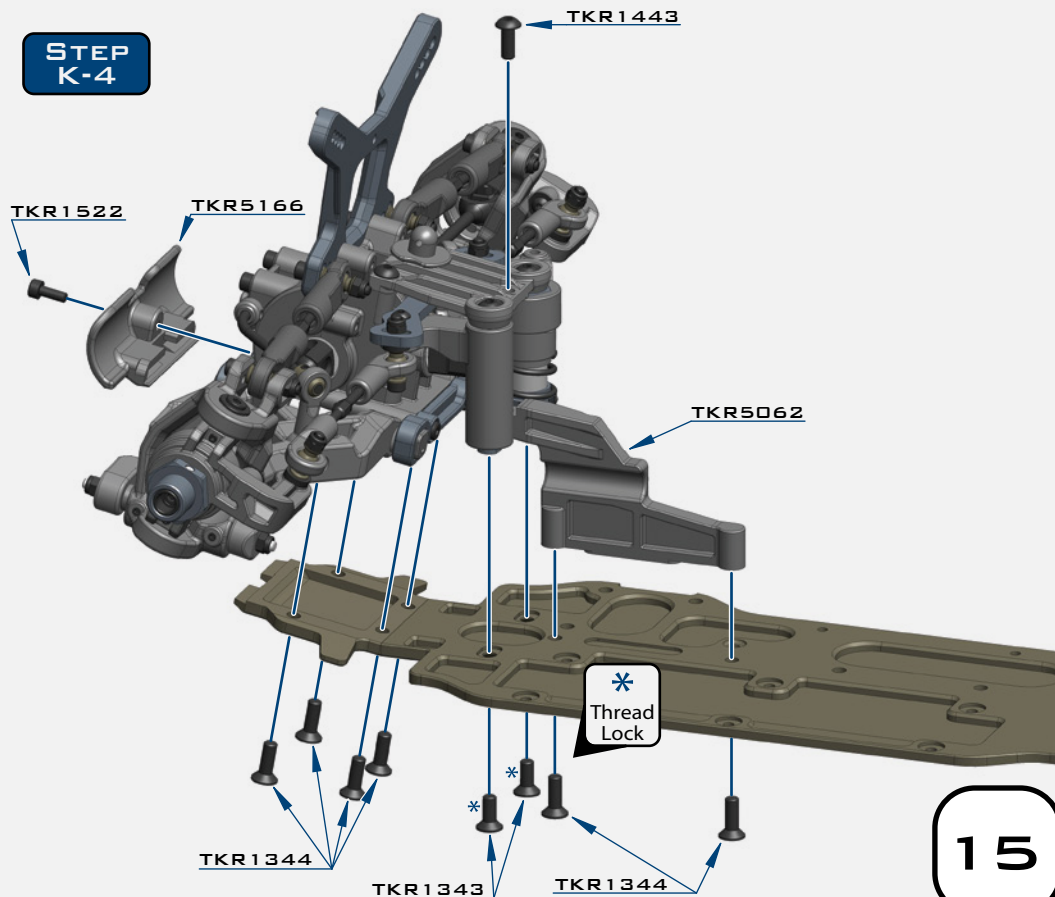

BAG L

CENTER/REAR ASSEMBLY

STEP L-1

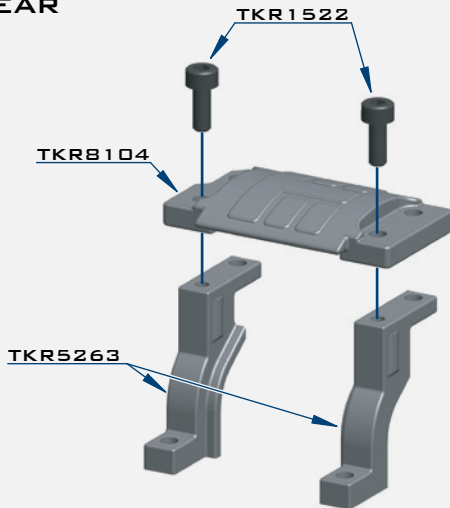

STEP L-2

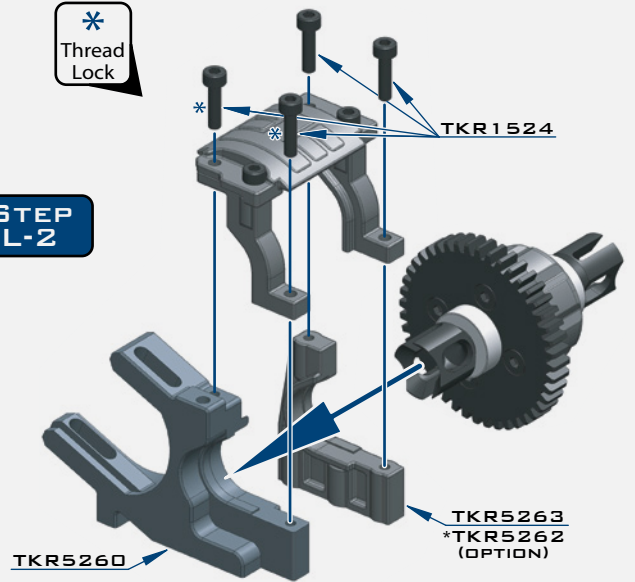

STEP L-3

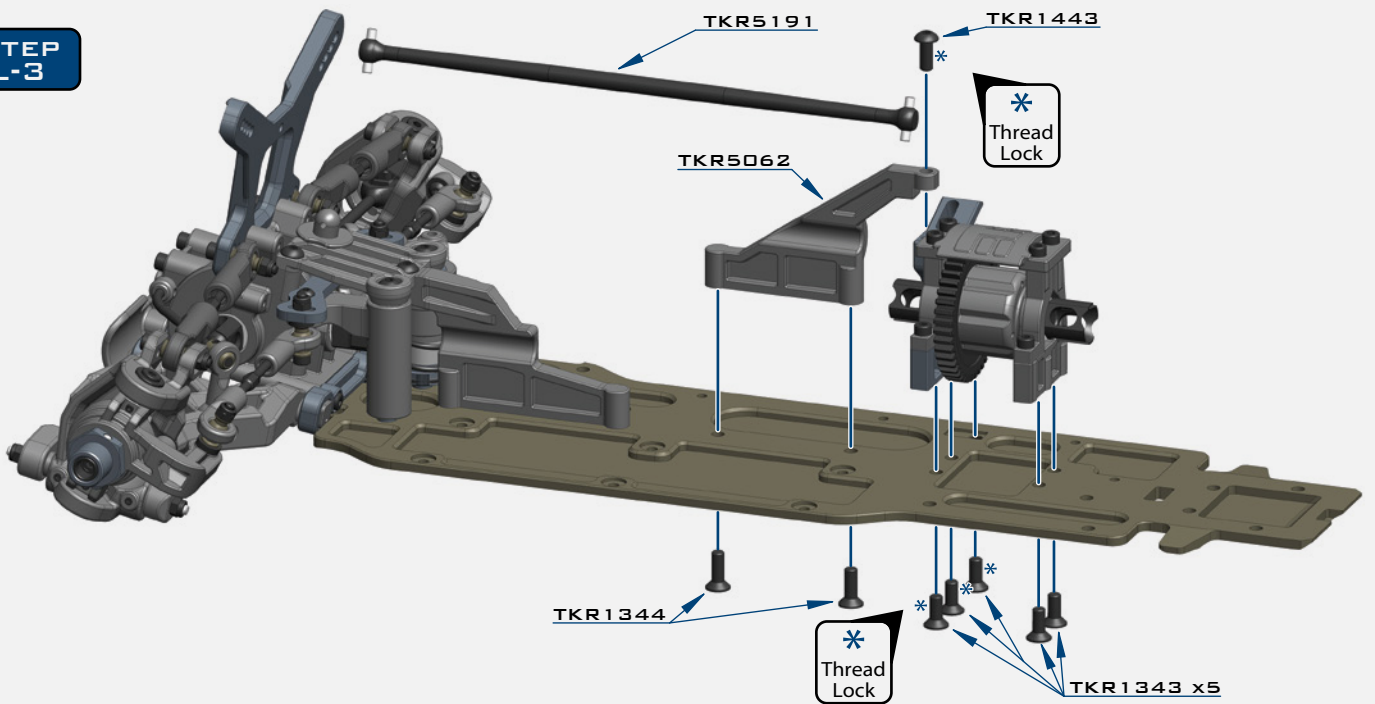

STEP L-4

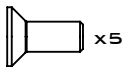

x5
TKR1343
M4x10MM FLAT HEAD SCREW



x7
TKR1344
M4x12MM FLAT HEAD SCREW

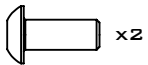

x2
TKR1443
M4x10MM BUTTON HEAD SCREW

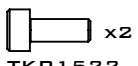

x2
TKR1522
M3x8MM CAP HEAD SCREW

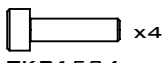

x4
TKR1524
M3x12MM CAP HEAD SCREW

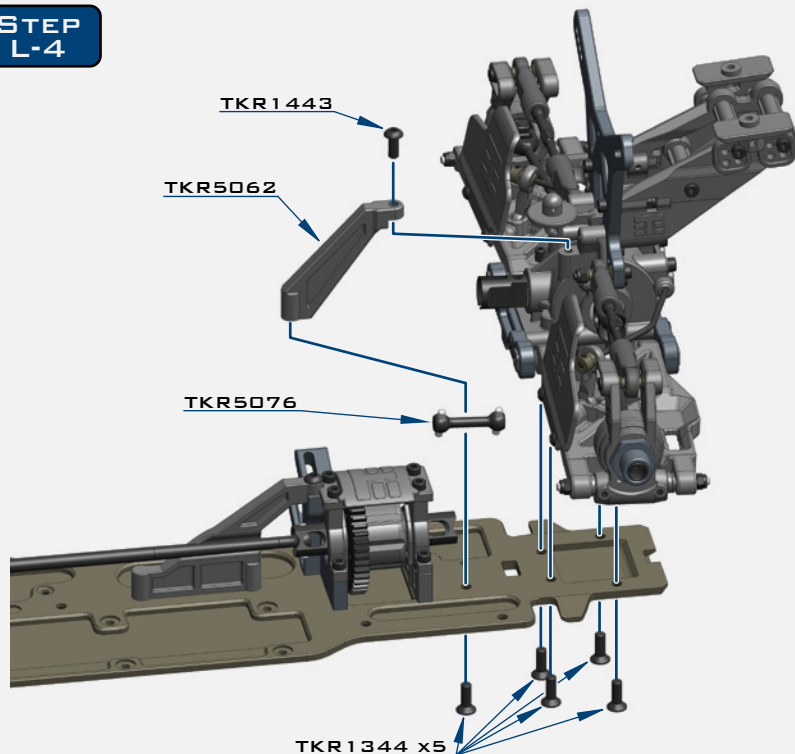

BAG M

FRONT SHOCK ASSEMBLY

STEP M-1

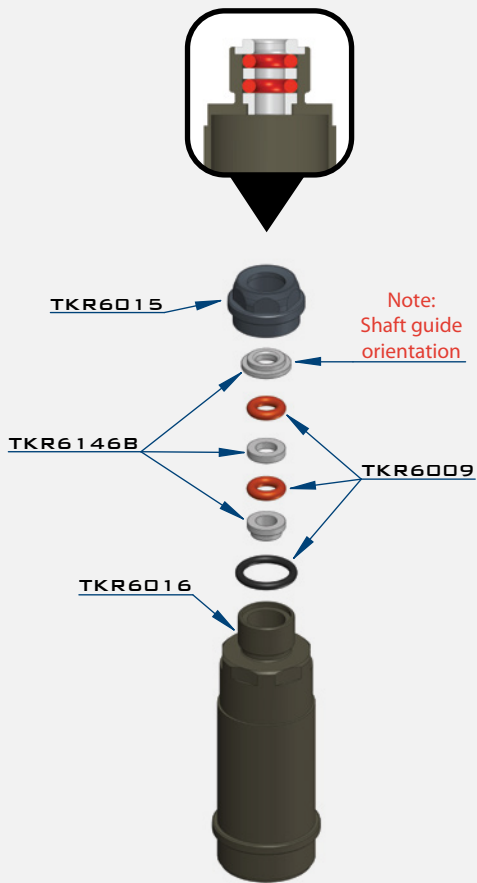

STEP M-2



STEP M-3

Refer to filling instructions on page 19 during this step.

Use #550wt oil FRONT

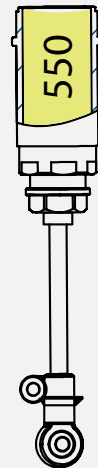

STEP M-4

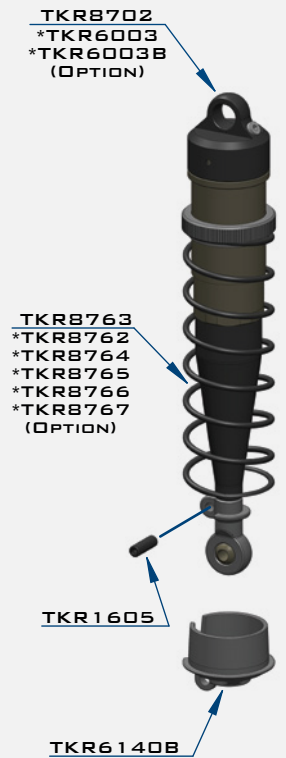

 x2
TKR1200
M2.5 LOCK NUT ZINC

 x2
TKR1202
M4 LOCK NUT BLACK

 x2
TKR1211
M3 LOCK NUT FLANGE BLACK

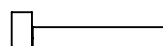
 x2
TKR1240
M3X18MM SHOCK MNT SCREW

 x2
TKR1248
M2X4MM EMULSION SCREW

 x2
TKR1605
M3X10MM SET SCREW

STEP M-5

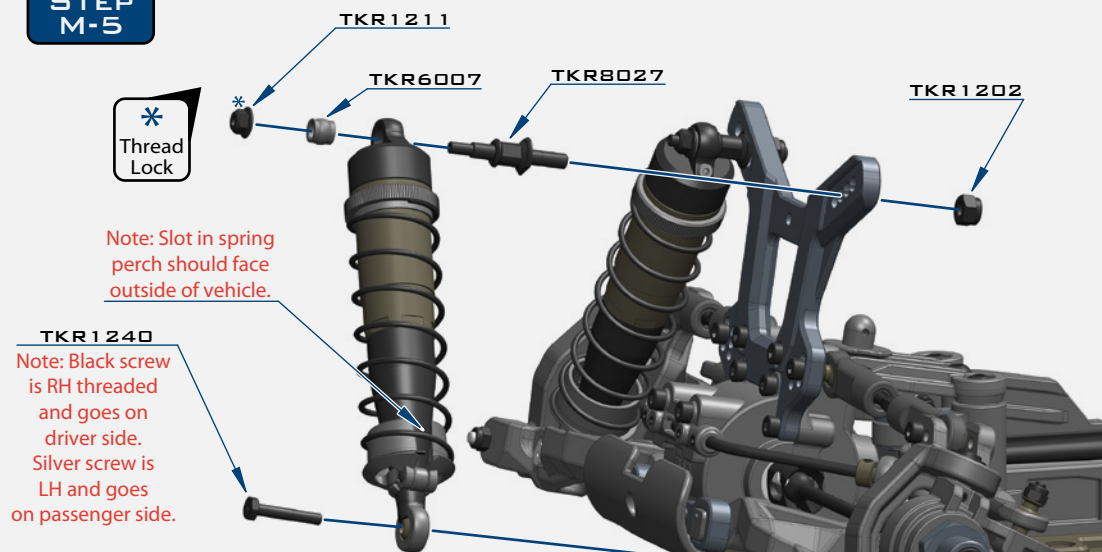

Note: Slot in spring perch should face outside of vehicle.

Note: Black screw is RH threaded and goes on driver side. Silver screw is LH and goes on passenger side.

- Stock shock position is inside hole on the arm and 2nd from inside hole on the tower
- Stock front ride height is 27mm
- Shock length (droop) is 120mm

BAG N

REAR SHOCK ASSEMBLY

STEP N-1

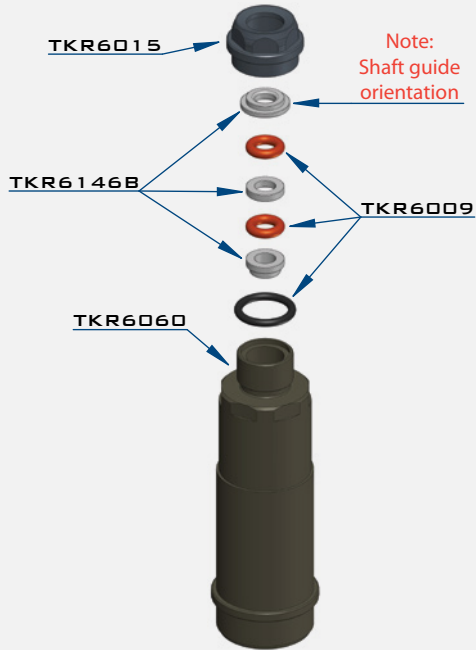
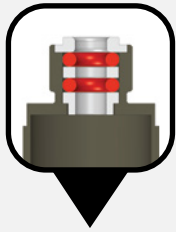

STEP N-2



STEP N-3

Refer to filling instructions on page 19 during this step.

Use #450wt oil REAR



STEP N-4

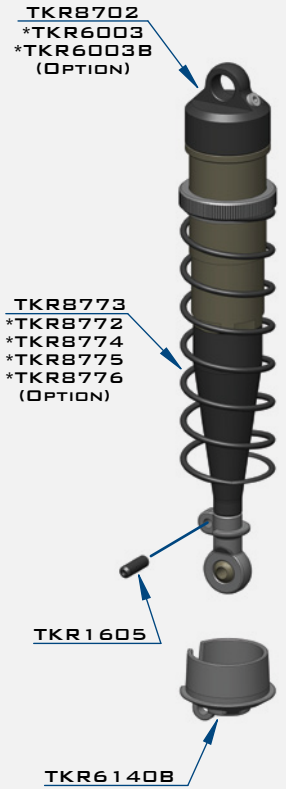

 x2
TKR1200
M2.5 LOCK NUT ZINC

 x2
TKR1202
M4 LOCK NUT BLACK

 x2
TKR1211
M3 LOCK NUT FLANGE BLACK

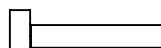
 x2
TKR1240
M3X18MM SHOCK MNT SCREW

 x2
TKR1248
M2X4MM EMULSION SCREW

 x2
TKR1605
M3X10MM SET SCREW

STEP N-5

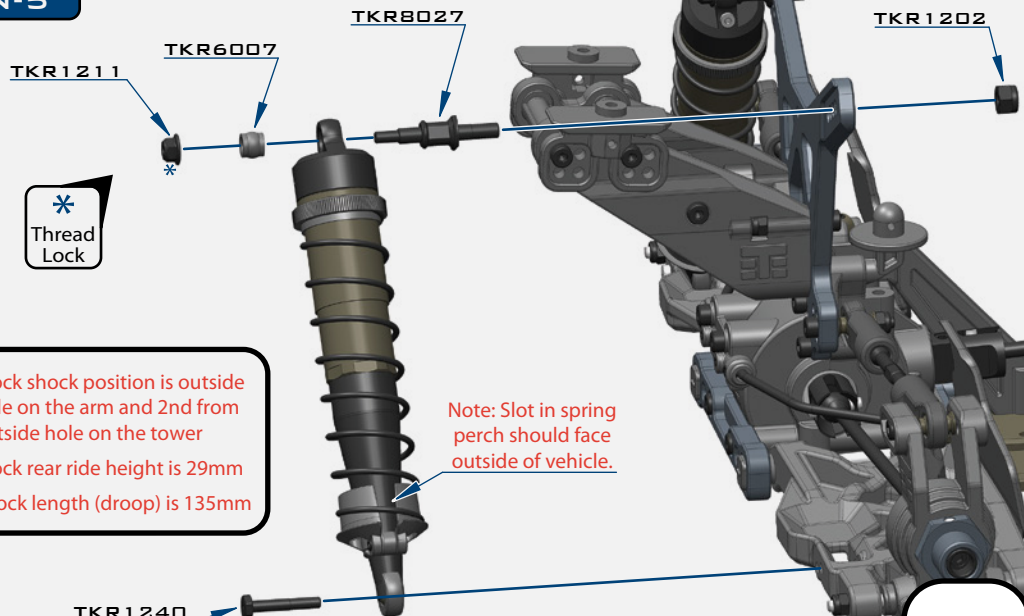

Note: Black screw is RH threaded and goes on passenger side. Silver screw is LH and goes on driver side.

SHOCK FILLING INSTRUCTIONS

FOR BOTH FRONT AND REAR SHOCKS

We've found it's easiest to complete steps 1 & 2 on each shock before moving on to step 3. By the time you've finished step 2 on the last shock, the first one will be ready for step 3.

Step 1. Insert all four larger o-rings into the emulsion caps and set aside. Install the small o-rings onto the small emulsion screws by placing the o-rings on a pit mat or towel and pressing the screws into the o-rings.

Step 2. Fill shock with oil all the way to the top and pump the shock shaft up and down 3-5 times.

Step 3. Screw on the cap all the way tight (shock tool TKR1115 is helpful in tightening completely).

Step 4. With the shock at about a 45° angle, push and hold the shock shaft to the top and insert the prepared emulsion screw/seal. Oil will leak out during this process. Tighten the screw until snug (do not overtighten).

Step 5. Pump the shock shaft up and down about 30 times vigorously. This emulsifies the oil.

Step 6. With the shock shaft fully extended, remove the emulsion screw from the cap to do the final bleed.

Step 7. With the shock at about a 45° angle, push and hold the shock shaft to the top and insert the prepared emulsion screw/seal again. Oil will leak out during this process. Tighten the screw until snug (do not overtighten).

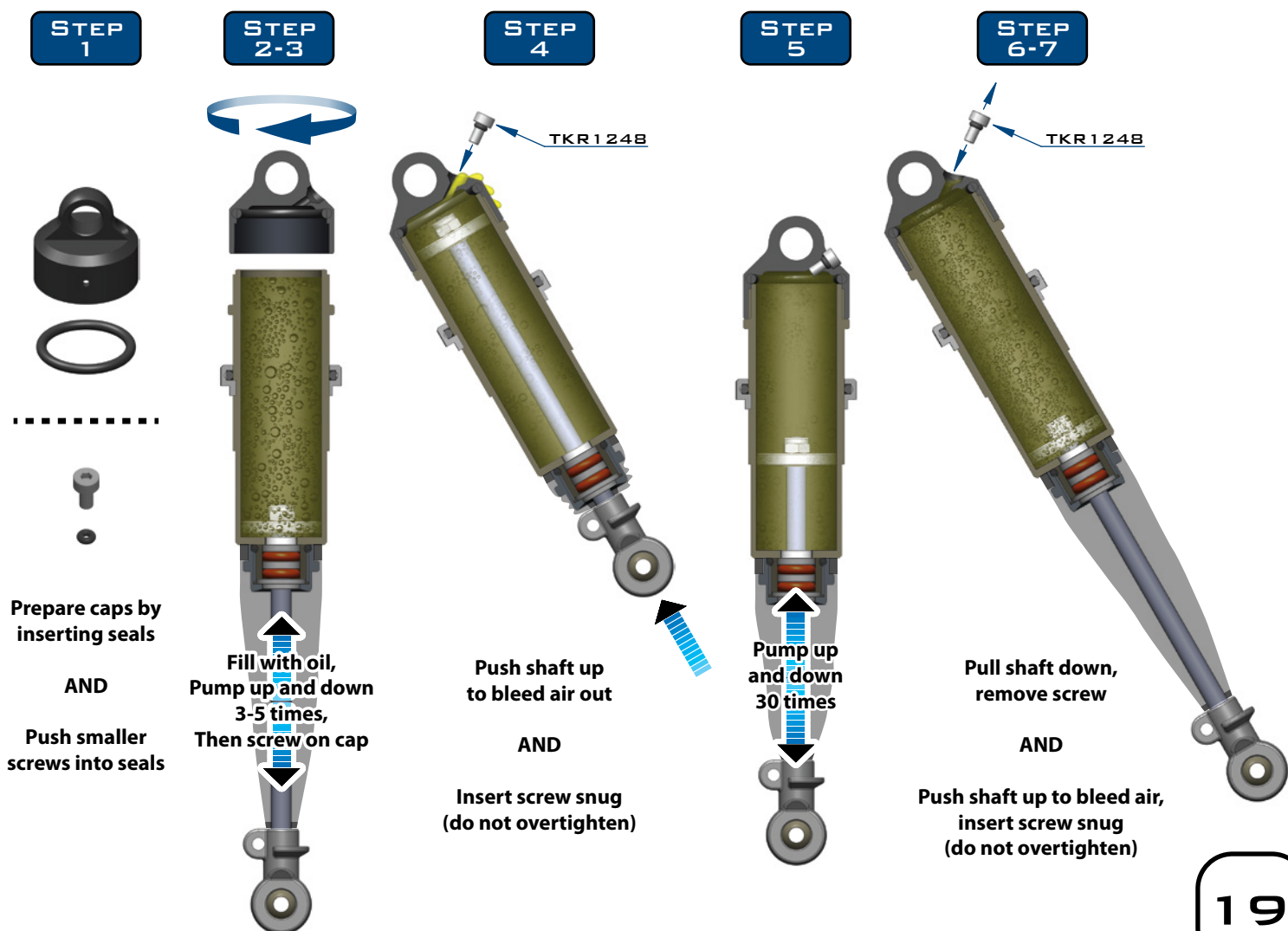

BAG 0

FINAL ASSEMBLY

Steering servo (not included)
 Note: we recommend using a servo with at least 300 oz/in torque.

STEP 0-1

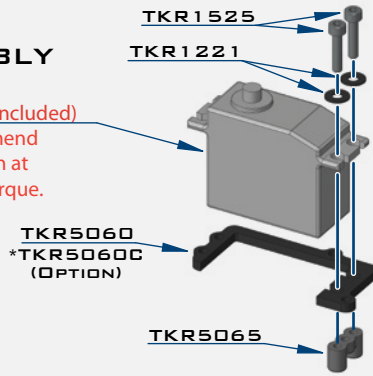

Electronic Speed Control (not included)

STEP 0-2

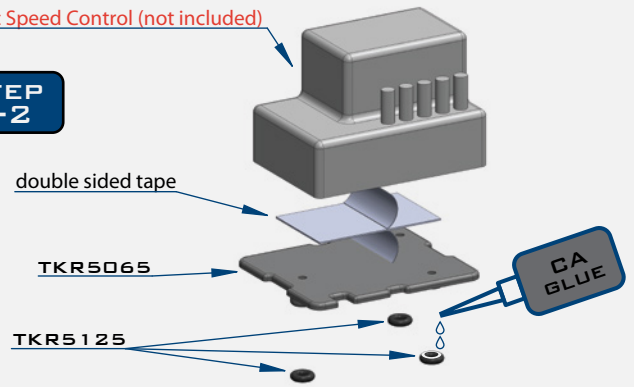

Note: CA glue 3 black o-rings (TKR5125) to the bottom legs of the ESC tray.

STEP 0-3

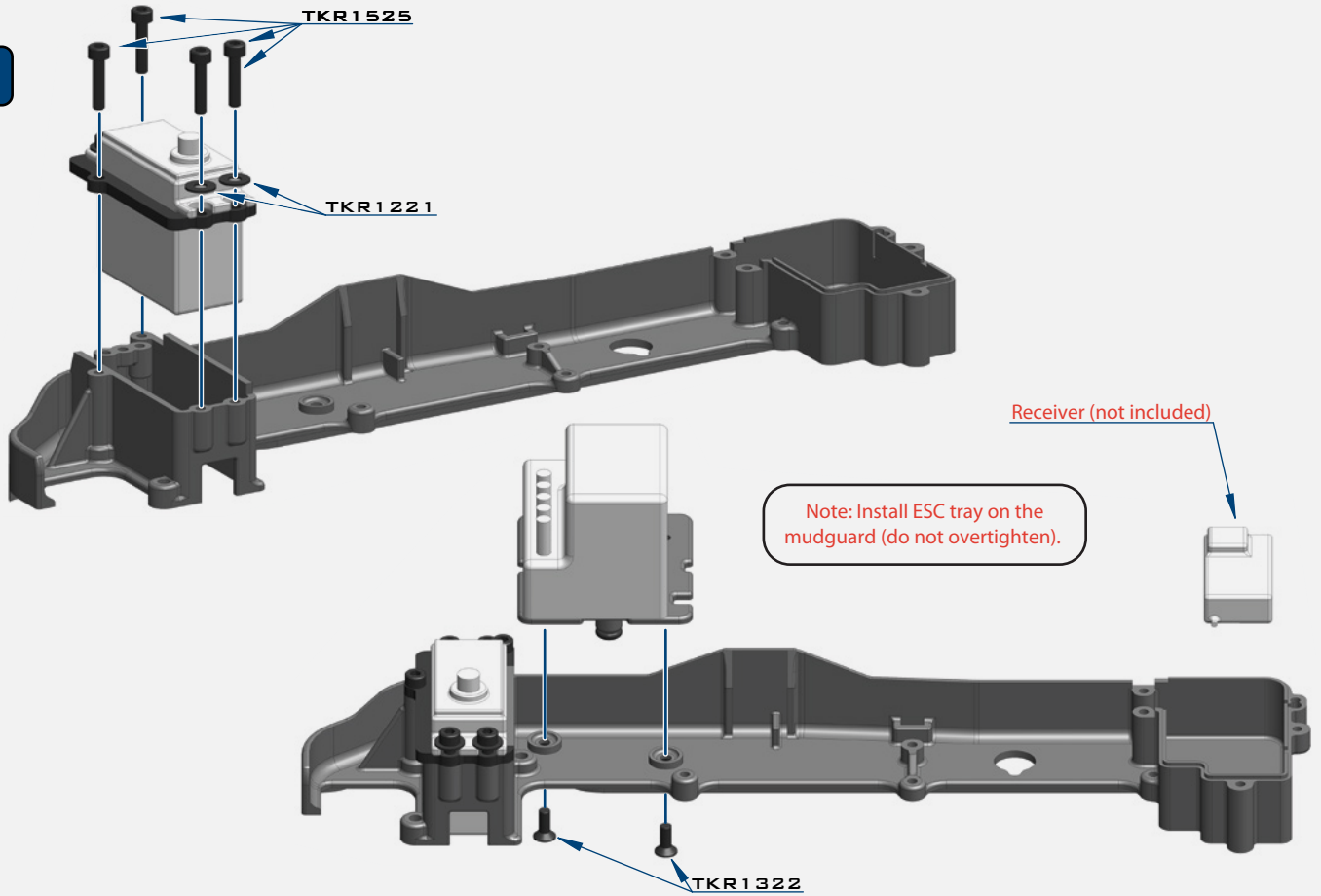

Note: Install ESC tray on the mudguard (do not overtighten).

STEP 0-4

Note: Feed the servo wire underneath the esc tray in between the mounting screws on the mud guard, then feed both ESC and servo wires into the RX box as shown. Install wire retainers (TKR5065) to secure them properly.

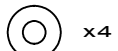
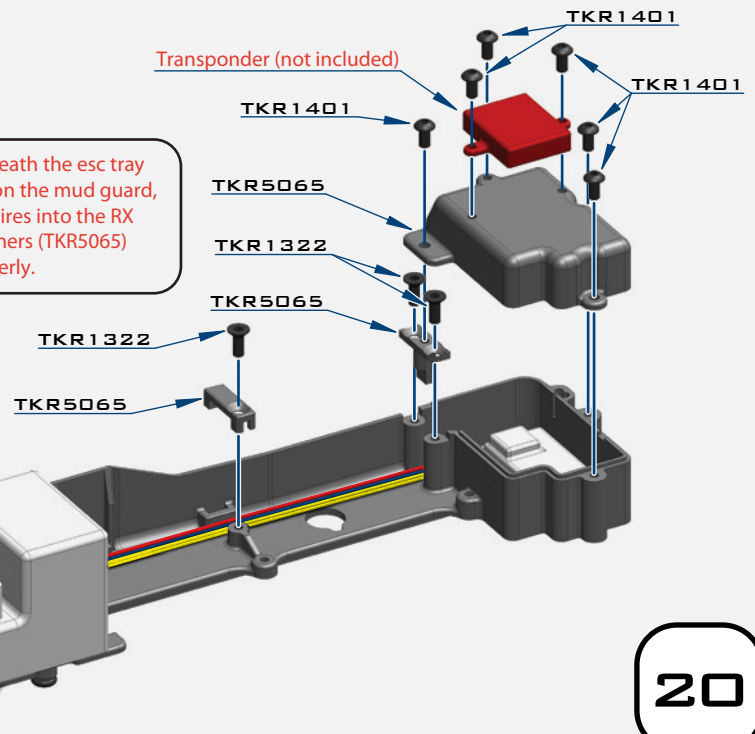

x4

TKR1221
M3x8MM WASHER

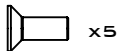

x5

TKR1322
M3x8MM FLAT HEAD SCREW

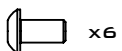

x6

TKR1401
M3x6MM BUTTON HEAD SCREW

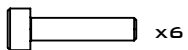

x6

TKR1525
M3x14MM CAP HEAD SCREW



x3

TKR5125
O-RING 3x7MM

BAG P

FINAL ASSEMBLY

STEP P-1

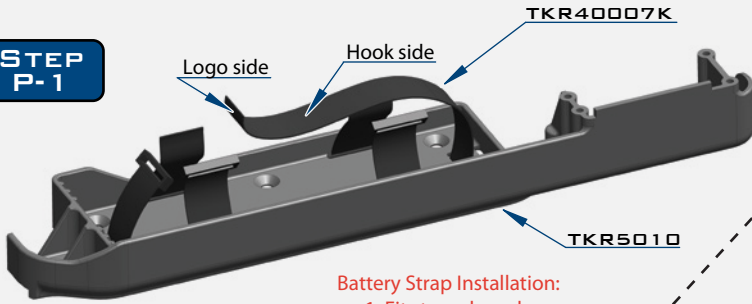

Battery Strap Installation:
 1. Fit straps loosely
 2. Position on chassis
 3. Proceed to step P-2

Motor (not included)

STEP P-2

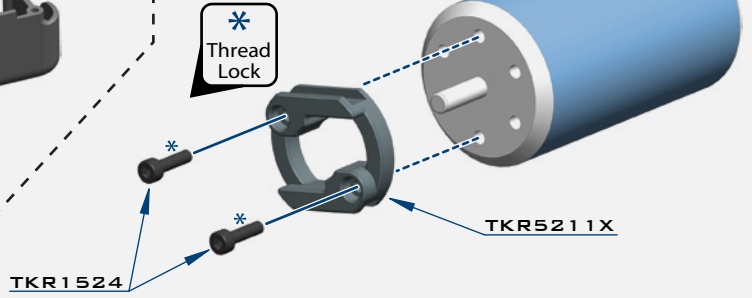

STEP P-3

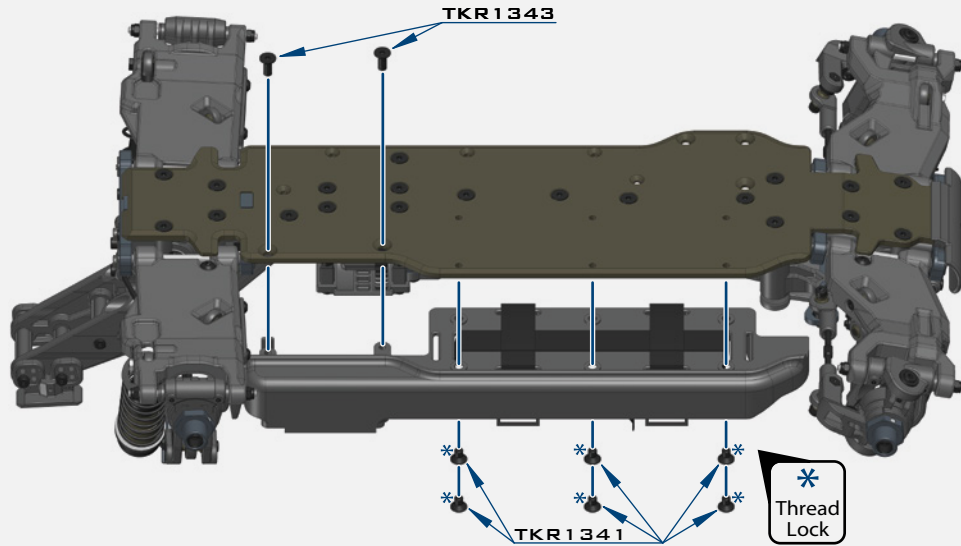

STEP P-4

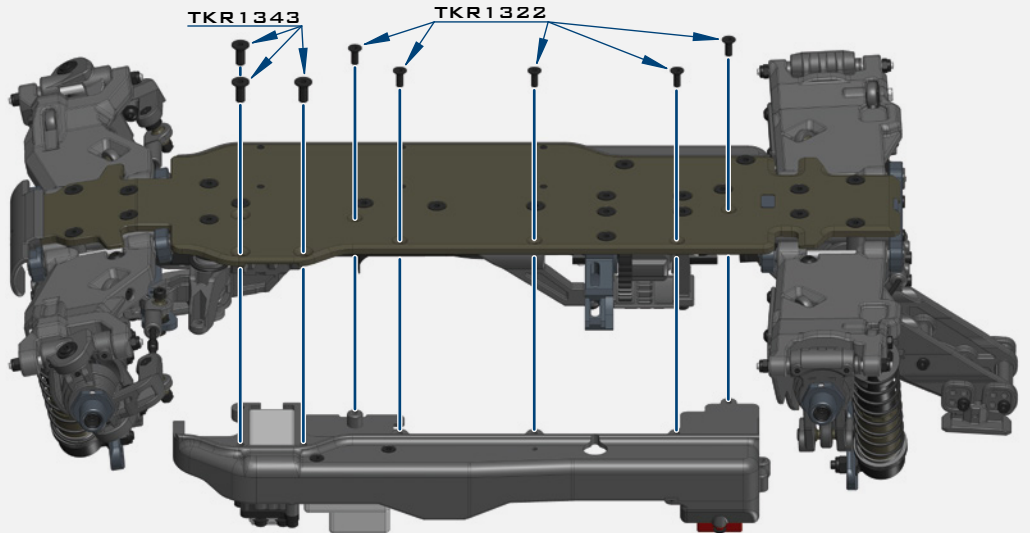

STEP P-5

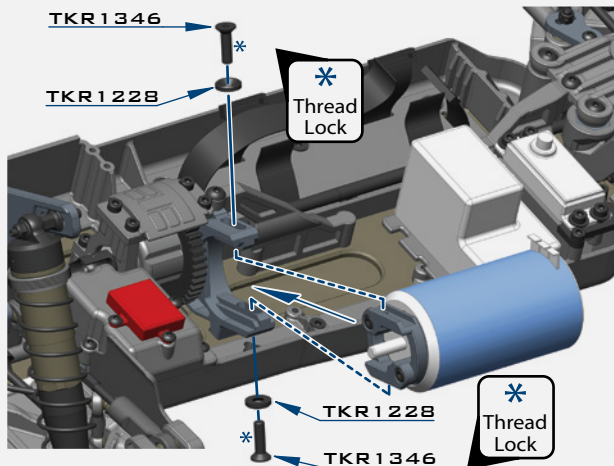

Note: Install MOD1 pinion 15t-25t (TKR4175-4185) at this step. Adjust gear mesh and tighten screws (TKR1346) well. *Use thread lock.

 X2
 TKR1228
 M4 COUNTERSUNK WASHER

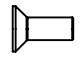
 X5
 TKR1322
 M3X8MM FLAT HEAD SCREW

 X6
 TKR1341
 M4X6MM FLAT HEAD SCREW

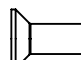
 X5
 TKR1343
 M4X10MM FLAT HEAD SCREW

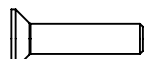
 X2
 TKR1346
 M4X15MM FLAT HEAD SCREW

 X2
 TKR1524
 M3X12MM CAP HEAD SCREW

BAG P

FINAL ASSEMBLY

STEP P-6

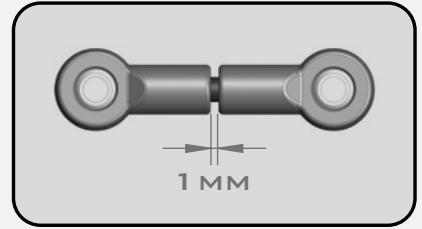
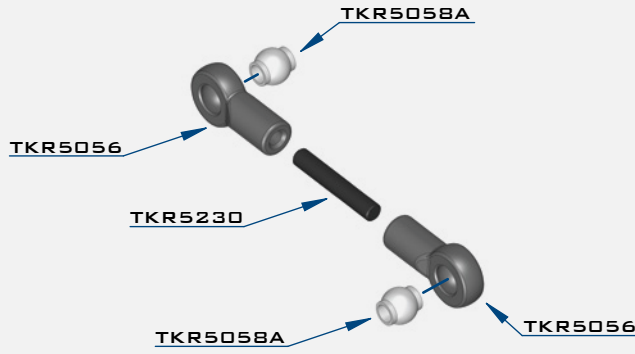

STEP P-7

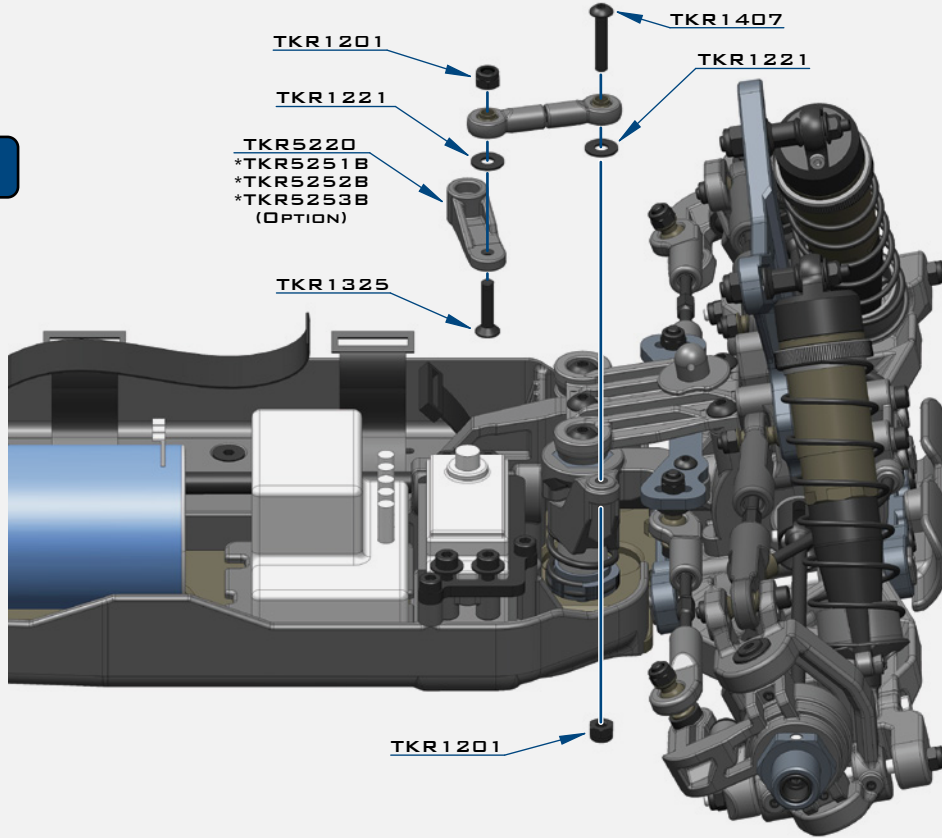

 x2
TKR1201
M3 LOCK NUT BLACK

 x2
TKR1221
M3X8MM WASHER

 x1
TKR1325
M3X14MM FLAT HEAD SCREW

 x1
TKR1407
M3X16MM BUTTON HEAD SCREW

 x2
TKR5058A
PIVOT BALL M3X5.8MM
NO FLANGE

 x1
TKR5230
M3X18 THREADED ROD

STEP P-8

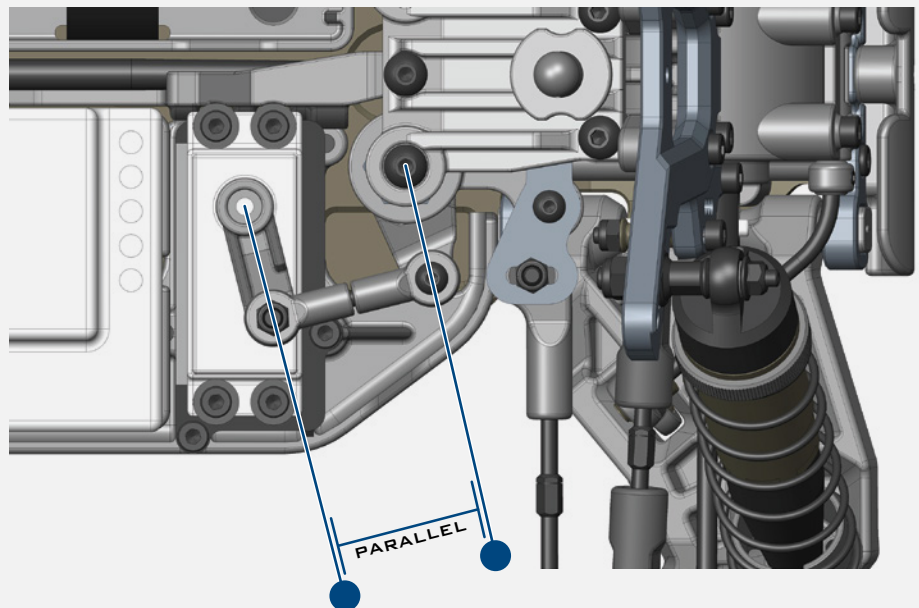

Note: Offset servo arm so it is parallel with the connecting arm at neutral or zero servo position.

BAG Q

WING/WHEELS/BODY

STEP Q-1

WING HOLE OPTIONS

(Use Dimples as Hole Cutting Guides)

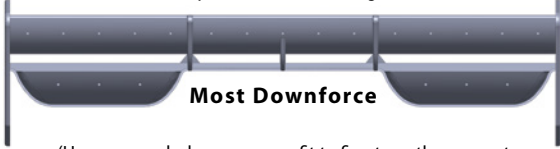

(Use as many holes as you see fit to fine tune the amount of downforce the wing creates.)

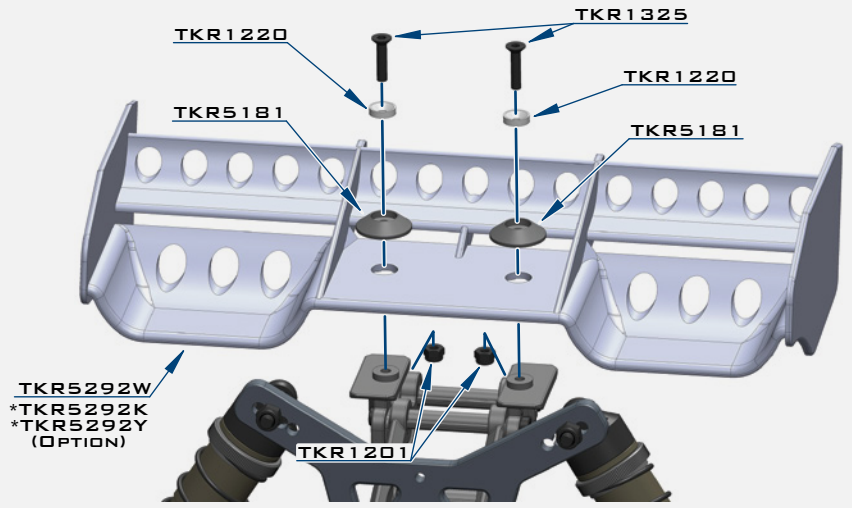

STEP Q-2

Wheels/Tires (not included)

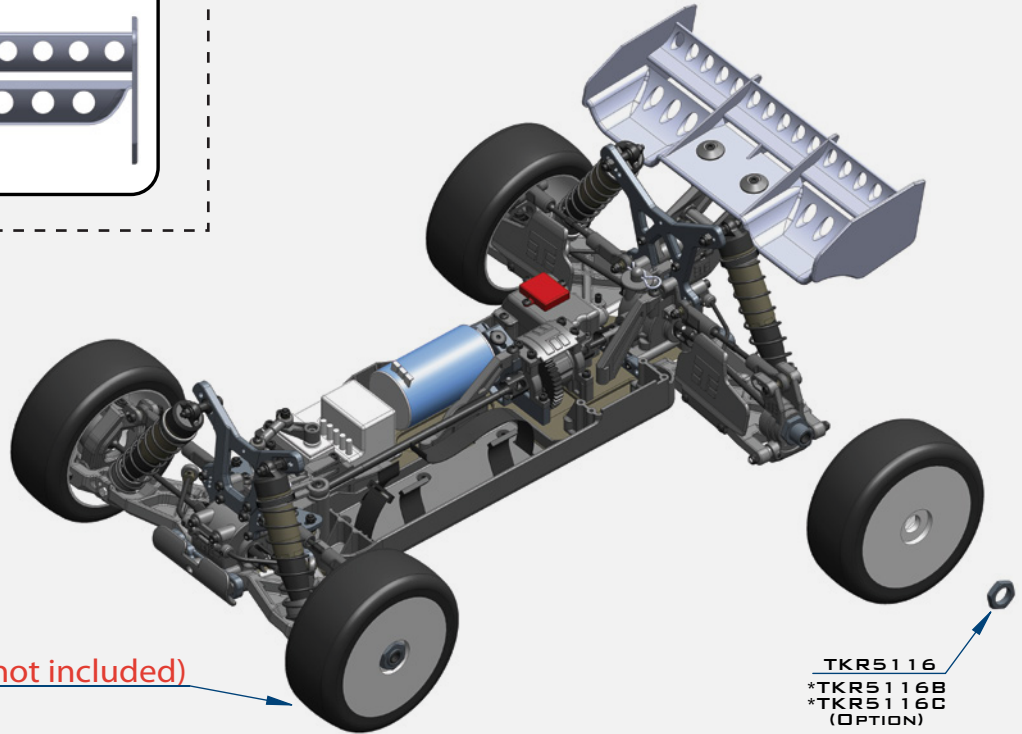

Note: It may be necessary to cut holes in the body for ventilation.

STEP Q-3



x2

TKR1201
M3 LOCK NUT BLACK



x2

TKR1220
M4 COUNTERSUNK WASHER

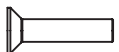

x2

TKR1325
M3X14MM FLAT HEAD SCREW



x2

TKR1235
BODY CLIP

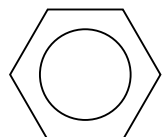

x4

TKR5116
WHEEL NUT

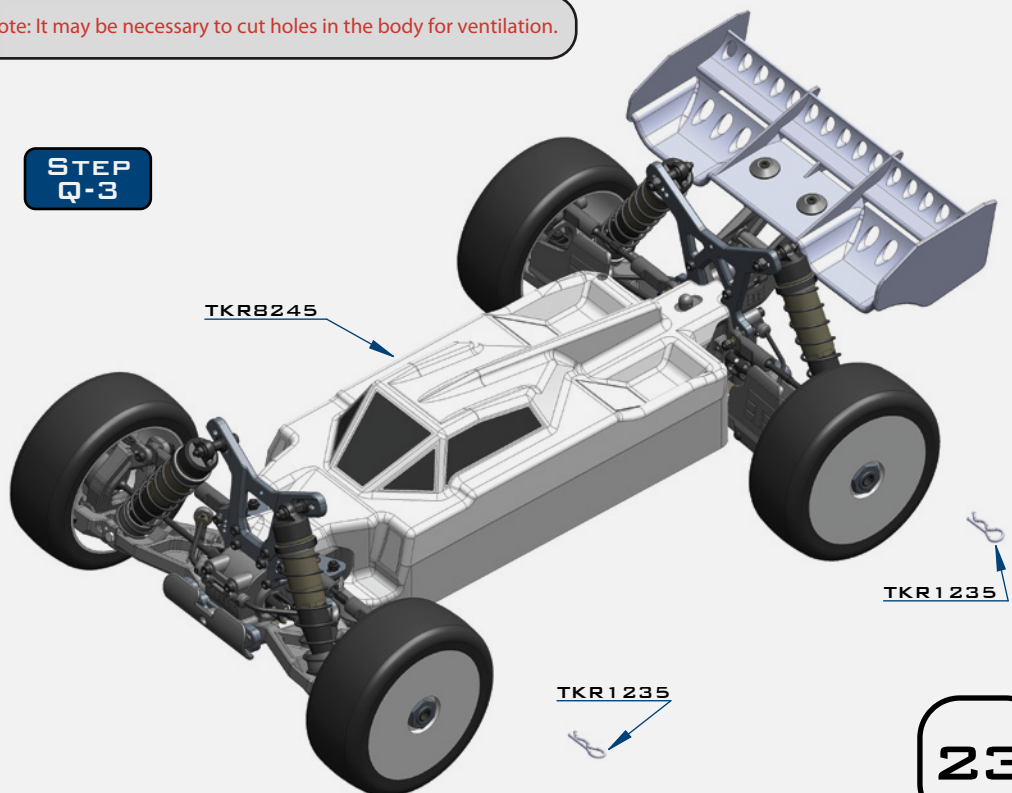

TKR8000 - EB48.41/8th Competition Electric Buggy Kit

Parts List

TKR40007K – Battery Straps (EB48, black, 4 cell, 3pcs)
TKR5010 – Battery Tray, Mud Guard (EB48, left side)
TKR5011 – Radio Tray, Mud Guard (EB48, right side)
TKR5012 – Gearbox (front)
TKR5016B – Gearbox (rear, angled)
TKR5020 – Hinge Pins (inner, front/rear)
TKR5049A – Pivot Balls (6.8mm, no flng, sway bar, shck ends, almmn, 4pcs)
TKR5050 – Turnbuckle (camber link, front/rear, 2pcs)
TKR5053A – Pivot Balls (6.8mm, flanged, outside camber, aluminum, 4pcs)
TKR5056 – Rod Ends (5.8mm, brake/steering/sway bar linkage, 8pcs)
TKR5058A – Pivot Balls (5.8mm, no flange, brake/steering link, aluminum, 4pcs)
TKR5060 – Steering Servo Brace (aluminum, gun metal ano)
TKR5062 – Chassis Brace Set (front/rear/center)
TKR5065 – ESC Tray and Radio/Battery Tray Accessories
TKR5070 – Stub Axles (hardened steel, 2pcs)
TKR5071 – Wheel Hubs (17mm, aluminum, gun metal ano, w/pins, 2pcs)
TKR5075 – Diff Coupler (f/r, hardened steel)
TKR5076 – Driveshaft (center, rear, hardened steel)
TKR5079A – Stabilizer Balls (6.8mm, sway bars, aluminum, 4pcs)
TKR5081 – Sway Bar (2.3mm, front)
TKR5086 – Sway Bar Mounts
TKR5101X – Servo Saver Spring (HD, EB48, SCT410, NB48)
TKR5102A – Steering Posts (aluminum)
TKR5103 – Servo Saver Post (aluminum, gun metal ano)
TKR5116 – Wheel Nuts (17mm, serrated, gun metal ano, M12x1.0, 4pcs)
TKR5122 – Steering Rack Bushings (aluminum, gun metal ano, 2pcs)
TKR5123 – Turnbuckle (steering links, 2pcs)
TKR5125 – O-Ring (ESC tray, 3pcs)
TKR5126 – Antenna tube (universal, w/ caps, 5pcs)
TKR5165 – V2 Hinge Pin Inserts, Wheelbase Shims (EB/NB/ET/NT/SCT)
TKR5166 – Front Bumper (revised, EB/NB/ET/NT48)
TKR5174 – Rear Arm Mud Guards (for TKR5184, EB/NB)
TKR5181 – Low Profile Wing Mount and Body Mounts (EB/NB48/EB48SL)
TKR5187 – Rod Ends (straight, 6.8mm, EB/NB/ET/NT48, 8pcs)
TKR5191 – Tapered Driveshaft (EB48, ET48, center, front, 7075 aluminum, black ano)
TKR5211X – Motor Mount Insert (aluminum, gun metal anodized, lightened)
TKR5220 – Servo Horns (steering, brakes)
TKR5230 – Steering linkage (M3x18mm threaded rod, 10pcs)
TKR5231 – Servo Saver Nut and Spring
TKR5260 – CNC Split Cntr Diff Mount (mtr mnt only, 7075, gun metal ano, EB/ET/SCT)
TKR5263 – Split Cntr Diff Mount (composite, requires TKR5260, EB/ET/SCT/SL)
TKR5268 – Shock Tower (front, 7075 CNC, gun metal ano, EB/NB48.3)
TKR5269 – Shock Tower (rear, 7075 CNC, gun metal ano, EB/NB48.3)
TKR5292W – Wing (high downforce, hole guides, white)
TKR5491 – Sway Bar (2.4mm, rear)
TKR5550 – Turnbuckle (camber link, front, 2pcs)
TKR8006 – Chassis (7075, hard ano, EB48.4)
TKR8027 – Shock Standoffs (fits TKR8702, TKR6018, TKR6003, 2pcs)
TKR8034 – Hinge Pins (outer, f/r, EB/NB48.4)
TKR8040A – Rear Hubs (L/R, 0 RC offset, EB/NB48.4)
TKR8041 – Spindles (L/R, EB/NB48.4)
TKR8042 – Kingpin Shoulder Screws (EB/NB48.4, 4pcs)
TKR8052A – Pivot Balls (6.8mm, camber, str links, almmn, centered, 4pcs)
TKR8087 – Universal Driveshaft Set (f/r, 96.5mm, EB/NB.4, 2 pcs)
TKR8100 – Ackerman Plate (7075, EB/NB48.4)
TKR8104 – Bell Cranks and Top Plates (ALL, requires TKR8100)
TKR8161 – Hinge Pin Brace (CNC, 7075, EB/NB48.4, A Block)
TKR8162 – Hinge Pin Brace (CNC, 7075, EB/NB48.4, B Block)
TKR8163 – Hinge Pin Brace (CNC, 7075, EB/NB48.4, C Block)
TKR8164 – Hinge Pin Brace (CNC, 7075, EB/NB48.4, D Block)
TKR8184 – Suspension Arms (rear, EB/NB48.4)
TKR8194A – Spindle Carriers (L/R, 15 degree, 0 RC offset, EB/NB.4)
TKR8245 – Body (.040 lexan, EB48/48.3/48.4, SL, w/ window mask)
TKR8286 – Suspension Arms (front, EB/NB48.4)

Differential List

TKR5113 – Differential Case (f/c/r)
TKR5114XB – Differential Outdrives (f/r, lightened, revised)
TKR5143 – Differential Seals (3pcs)
TKR5144 – Differential O-Rings (6pcs)
TKR5145B – Differential Shims (revised, 6x17mm, 6pcs)
TKR5149 – Differential Cross Pins (steel, 6pcs)
TKR5150 – Differential Gear Set (internal gears only)
TKR5237K – Spur Gear (44t, black, composite)
TKR8151 – Differential Ring Gear (CNC, 40t, use with TKR8152)
TKR8152 – Diff Pinion (12t, CNC, use with TKR8151)

Shocks List

TKR6007 – Shock Cap Bushings (4pcs, EB/NB/ET/NT/SCT)
TKR6009 – Shock O-Ring and Bladder Set (for 2 shocks)
TKR6013 – Shock Adjustment Nuts (aluminum, gun metal ano, 2pcs)
TKR6015 – Shock Cartridge Caps (aluminum, gun metal ano, 2pcs)
TKR6016 – Shock Body (rear, aluminum, hard ano, 2pcs)
TKR6017 – Shock Shafts (rear, steel, 2pcs)
TKR6060 – Shock Body (rear, x-long, aluminum, hard ano, 2pcs)
TKR6061 – Shock Shafts (rear, x-long, steel, 2pcs)
TKR6140B – Locking Shock Rod End and Spring Perch Set (revised, EB/NB/ET/NT/SCT)
TKR6144 – Shock Boots (long length, EB/NB, 2pcs)
TKR6145 – Shock Boots (X-long length, rear EB/NB, 2pcs)
TKR6146B – Shock Cartridge Set (revised, CNC, Delrin, EB/NB/ET/NT/SCT)
TKR6165 – Shock Pistons (CNC, flat/flat, 4x1.9, 11.3mm2)
TKR8702 – Shock Caps (7075, emulsion/vented/standard, black ano, 2pcs)
TKR8725 – Emulsion O-ring Set (4x cap seals, 8x emulsion o-rings, for 16mm shocks)
TKR8763 – Shock Spring Set (front, 1.6x11.6, 3.58lb/in, 75mm, black)
TKR8773 – Shock Spring Set (rear, 1.6x14.5, 2.75lb/in, 85mm, orange)

Bearings List

TKRBB050825 – Ball Bearing (5x8x2.5mm, 4pcs)
TKRBB05104 – Ball Bearing (5x10x4, 4pcs)
TKRBB05114 – Ball Bearing (5x11x4, 4pcs)
TKRBB05134 – Ball Bearing (5x13x4, 4pcs)
TKRBB06103 – Ball Bearing (6x10x3, 4pcs)
TKRBB08165 – Ball Bearing (8x16x5, 4pcs)
TKRBB13194 – Ball Bearing (13x19x4, 4pcs)

Hardware List

TKR1200 – M2.5 Locknuts (zinc finish, 10pcs)
TKR1201 – M3 Locknuts (black, 10pcs)
TKR1202 – M4 Locknuts (black, 10pcs)
TKR1211 – M3 Locknuts (flanged, black, 10pcs)
TKR1220 – M3 Countersunk Washers (aluminum, natural, 10pcs)
TKR1221 – M3x8mm Washer (black, 10pcs)
TKR1222 – 13x16x.1mm Diff Shims (10pcs)
TKR1226 – 5x7x.2mm shims (10pcs)
TKR1228 – M4 Countersunk Washer (black, 10pcs)
TKR1235 – Body Clips (10pcs)
TKR1238 – Droop Adjustment Screws (M4x10mm, 8pcs)
TKR1240 – Lower Shock Mount Screws (2 CW thread, 2 CCW thread, EB/NB/SCT)
TKR1248 – M2x4mm Cap Head Screws (black, 10pcs)
TKR1250 – Steering Link Screws (black, steel, 2pcs)
TKR1322 – M3x8mm Flat Head Screws (black, 10pcs)
TKR1323 – M3x10mm Flat Head Screws (black, 10pcs)
TKR1325 – M3x14mm Flat Head Screws (black, 10pcs)
TKR1341 – M4x6mm Flat Head Screws (black, 10pcs)
TKR1343 – M4x10mm Flat Head Screws (black, 10pcs)
TKR1344 – M4x12mm Flat Head Screws (black, 10pcs)
TKR1346 – M4x15mm Flat Head Screws (black, 10pcs)
TKR1401 – M3x6mm Button Head Screws (black, 10pcs)
TKR1402 – M3x8mm Button Head Screws (black, 10pcs)
TKR1403 – M3x10mm Button Head Screws (black, 10pcs)
TKR1407 – M3x16mm Button Head Screws (black, 10pcs)
TKR1443 – M4x10mm Button Head Screws (black, 10pcs)
TKR1522 – M3x8mm Cap Head Screws (black, 10pcs)
TKR1524 – M3x12mm Cap Head Screws (black, 10pcs)
TKR1525 – M3x14mm Cap Head Screws (black, 10pcs)
TKR1529 – M3x20mm Cap Head Screws (black, 10pcs)
TKR1533 – M3x40mm Cap Head Screws (black, 10pcs)
TKR1534 – M3x22mm Cap Head Screws (black, 10pcs)
TKR1601 – M3x4mm Set Screws (black, 10pcs)
TKR1603 – M5x4mm Set Screws (black, 10pcs)
TKR1605 – M3x10mm Set Screws (black, 10pcs)

Option Parts

TKR1103 – Turnbuckle Wrench (4mm, 5mm, hardened steel)
TKR1104 – XT Hex Wrench (1.5mm, adjustable length, 4mm shank)
TKR1105 – XT Hex Wrench (2.0mm, adjustable length, 4mm shank)
TKR1106 – XT Hex Wrench (2.5mm, adjustable length, 4mm shank)
TKR1107 – XT Nut Driver (5.0mm, adjustable length, 4mm shank)
TKR1108 – XT Nut Driver (5.5mm, adjustable length, 4mm shank)
TKR1115 – Pivot Ball and Shock Multi-tool (aluminum)
TKR1116 – 17mm Wheel Wrench, Shock Cap Tool
TKR1119 – 5.5mm / 7.0mm Wrench (hardened steel)
TKR5060C – Steering Servo Brace (carbon fiber)
TKR5071B – Wheel Hubs (17mm, alum, ltnd, gun metal ano, 1mm off, w/pins, 2pcs)
TKR5071C – Wheel Hubs (17mm, alum, ltnd, gun metal ano, 2mm off, w/pins, 2pcs)
TKR5071X – Wheel Hubs (aluminum, lightened, gun metal ano, w/pins, 2pcs)
TKR5080 – Sway Bar (front, 2.2mm)
TKR5082 – Sway Bar (front, 2.4mm)
TKR5083 – Sway Bar (front, 2.5mm)
TKR5084 – Sway Bar (front, 2.6mm)
TKR5085 – Sway Bar (front, 2.8mm)
TKR5087 – Sway Bar (front, 3.0mm)
TKR5092 – Sway Bar (front, 2.0mm, EB.3/NB.3/SL/SCT.3)
TKR5093 – Sway Bar (front, 2.1mm, EB.3/NB.3/SL/SCT.3)
TKR5094 – Sway Bar (front, 2.7mm, EB.3/NB.3/SL/SCT.3)
TKR5095 – Sway Bar (front, 2.9mm, EB.3/NB.3/SL/SCT.3)
TKR5149A – Diff Cross Pins (aluminum, 6pcs, requires TKR5150)
TKR5237 – Spur Gear (44t, composite, natural color)
TKR5251B – Aluminum Servo Horn (23t spline, M3 clamp, double hole arm)
TKR5252B – Aluminum Servo Horn (24t spline, M3 clamp, double hole arm)
TKR5253B – Aluminum Servo Horn (25t spline, M3 clamp, double hole arm)
TKR5262 – CNC Split Cntr Diff Mount (diff mounts only, 7075, gun metal ano, EB/ET/SCT)
TKR5292K – Wing (high down force, hole guides, ROAR/IFMAR legal, black)
TKR5292Y – Wing (high down force, hole guides, ROAR/IFMAR legal, yellow)
TKR5490 – Sway Bar (rear, 2.3mm)
TKR5492 – Sway Bar (rear, 2.5mm)
TKR5493 – Sway Bar (rear, 2.6mm)
TKR5494 – Sway Bar (rear, 2.8mm)
TKR5495 – Sway Bar (rear, 3.0mm)
TKR5496 – Sway Bar (rear, 2.1mm, EB.3/NB.3/SL/SCT.3, ET48, NT48)
TKR5497 – Sway Bar (rear, 2.2mm, EB.3/NB.3/SL/SCT.3, ET48, NT48)
TKR5498 – Sway Bar (rear, 2.7mm, EB.3/NB.3/SL/SCT.3, ET48, NT48)
TKR5499 – Sway Bar (rear, 2.9mm, EB.3/NB.3/SL/SCT.3, ET48, NT48)
TKR6003 – Shock Caps (aluminum, gun metal ano, 2pcs, EB48)
TKR6003B – Shock Caps (aluminum, non-vented top, 2pcs)
TKR6009B – Shock O-Ring Set (16pcs)
TKR6017T – Shock Shafts w/ TiNi coating (rear, steel, 2pcs)
TKR6061T – Shock Shafts w/ TiNi coating (rear, x-long, steel, 2pcs)
TKR6152 – Full Option Shock Kit (122mm, no springs, no pistons)
TKR6153 – Full Option Shock Kit (137mm, no springs, no pistons)
TKR6159 – Shock Pistons (CNC, flat/tapered, 4x1.8mm)
TKR6160 – Shock Piston Blanks (CNC, flat/tapered, 16 dimples)
TKR6162 – Shock Pistons (CNC, flat/tapered, 3x2.1, 10.4mm2, 4pcs)
TKR6163 – Shock Piston Blanks (CNC, flat/flat, 16 dimples)

Name: Box Stock Date: _____ Event: _____

Track: Indoor Outdoor Size: Small Medium Large Traction: Low Med High

Surface: Smooth Bumpy Rutted Type: Loose/Loamy Hard Pack Blue Groove Clay

Bumpsteer/Ackerman/Servo Saver/Steering Stop: _____ Condition: Dusty Dry Wet Muddy

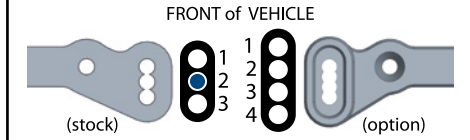

Shocks:

	FRONT	REAR
OIL	550	450
BRAND		
PISTON	4x 1.9 flat	4x 1.9 flat
SPRING	black	orange
REBOUND	0 %	0 %
STD/EMUL/VENT	emul	emul
NOTES:		

Front End:

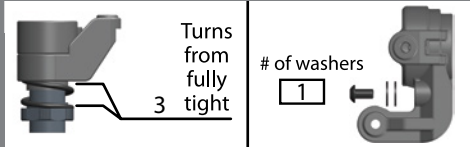
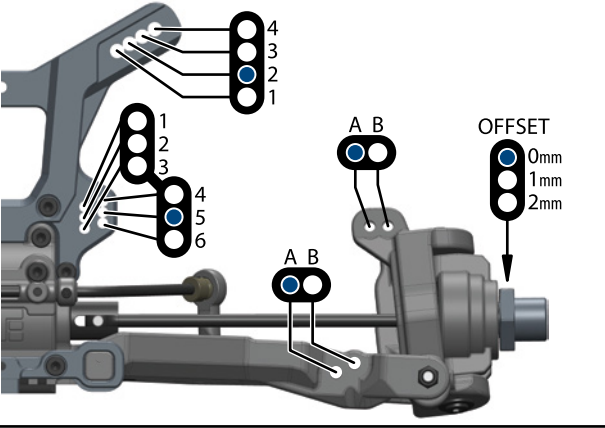

Suspension:

	FRONT	REAR
RIDE HEIGHT	27	29
CAMBER	-2 deg	-2 deg
CASTER	15 deg	
SWEEP	0 deg	
KICK UP	12 deg	
ANTI-SQUAT		2 deg
TOE (in/out)	.5 deg out	2.5 deg
SWAY BAR	2.3mm	2.4mm
SHOCK LENGTH (DROOP)	120	135

Tires / Wheels:

	FRONT	REAR
BRAND/TREAD		
COMPOUND		
INSERT		
WHEEL		
NOTES:		

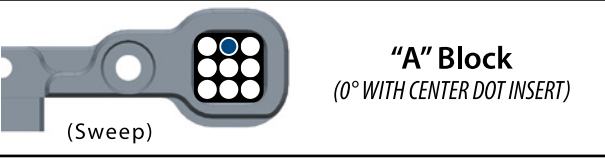

Rear End:

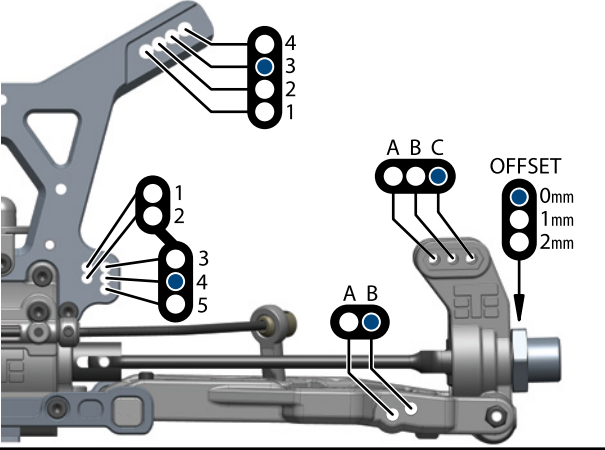

Body/Wing:

BODY MAKE	stock
WING MAKE	stock

Differential Oil:

FRONT	CENTER	REAR
10k	10k	7k

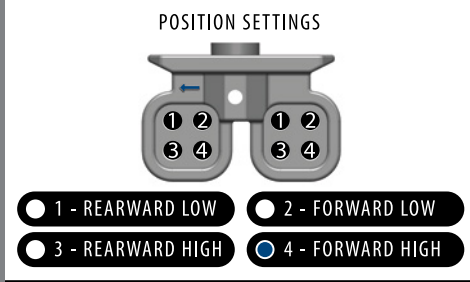

Electronics:

ESC:	
BATTERY:	
MOTOR:	
RADIO:	
SERVO:	300oz/in min

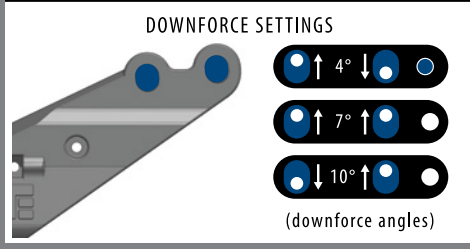
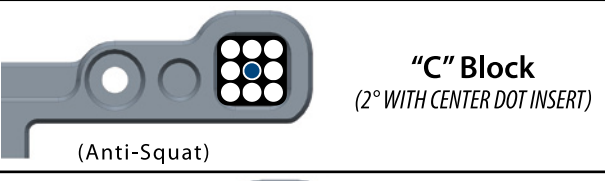

Drivetrain:

PINION SIZE		(teeth)
-------------	--	---------

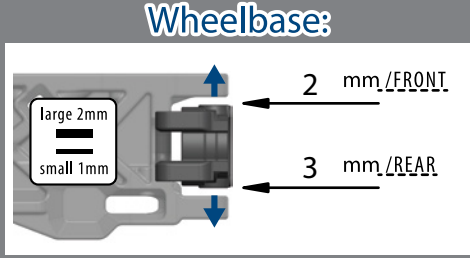
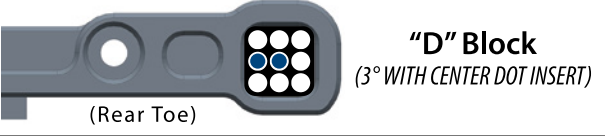

Chassis Braces:

Front	<input checked="" type="radio"/>	Middle	<input type="radio"/>	Rear	<input type="radio"/>
(front brace is always recommended)					



Notes:

Name: _____ Date: _____ Event: _____

Track: Indoor Outdoor Size: Small Medium Large Traction: Low Med High

Surface: Smooth Bumpy Rutted Type: Loose/Loamy Hard Pack Blue Groove Clay

Bumpsteer/Ackerman/Servo Saver/Steering Stop: _____ Condition: Dusty Dry Wet Muddy

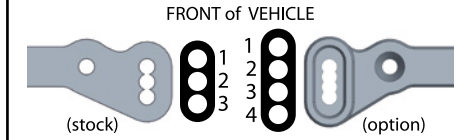

Shocks:

	FRONT	REAR
OIL		
BRAND		
PISTON		
SPRING		
REBOUND	%	%
STD/EMUL/VENT		
NOTES:		

Front End:

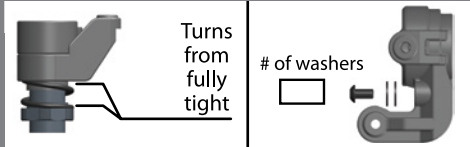
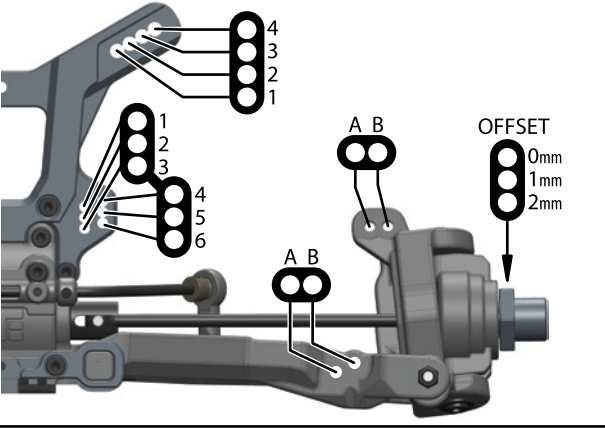

Suspension:

	FRONT	REAR
RIDE HEIGHT		
CAMBER		
CASTER		
SWEEP		
KICK UP		
ANTI-SQUAT		
TOE (in/out)		
SWAY BAR		
SHOCK LENGTH (DROOP)		

Tires / Wheels:

	FRONT	REAR
BRAND/TREAD		
COMPOUND		
INSERT		
WHEEL		
NOTES:		

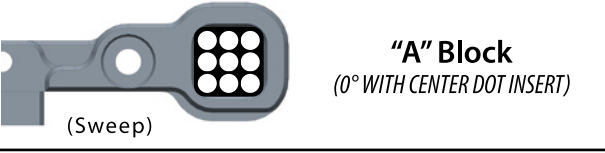

Differential Oil:

	FRONT	CENTER	REAR

Rear End:

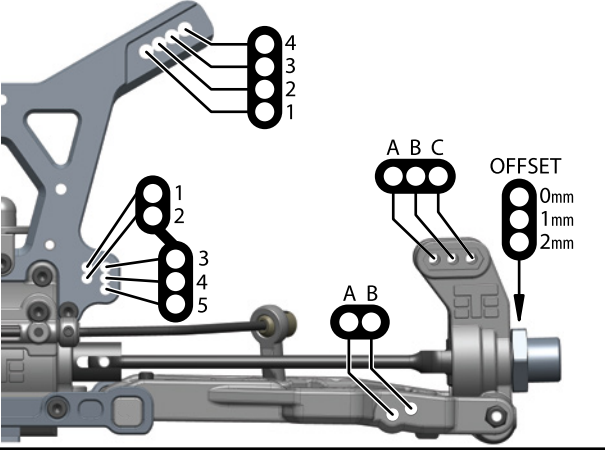

Body/Wing:

BODY MAKE	
WING MAKE	

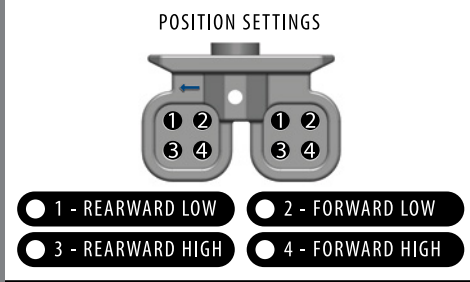

Electronics:

ESC:	
BATTERY:	
MOTOR:	
RADIO:	
SERVO:	

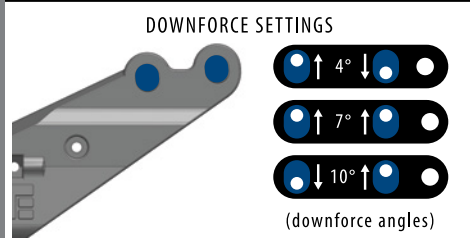

Drivetrain:

PINION SIZE		(teeth)
-------------	--	---------

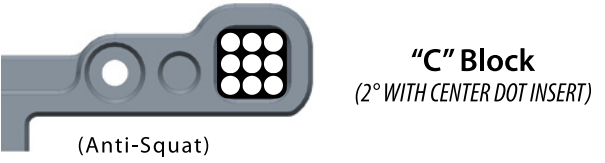

Chassis Braces:

Front Middle Rear

(front brace is always recommended)

Wheelbase:

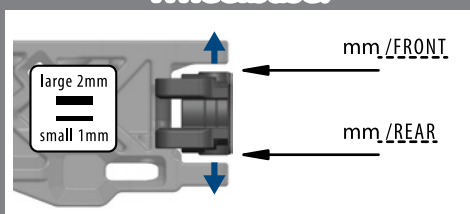

Notes:



Name: _____ Date: _____ Event: _____

Track: Indoor Outdoor Size: Small Medium Large Traction: Low Med High

Surface: Smooth Bumpy Rutted Type: Loose/Loamy Hard Pack Blue Groove Clay

Bumpsteer/Ackerman/Servo Saver/Steering Stop: _____ Condition: Dusty Dry Wet Muddy

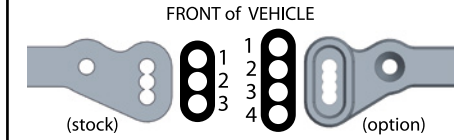

Shocks:

	FRONT	REAR
OIL		
BRAND		
PISTON		
SPRING		
REBOUND	%	%
STD/EMUL/VENT		
NOTES:		

Front End:

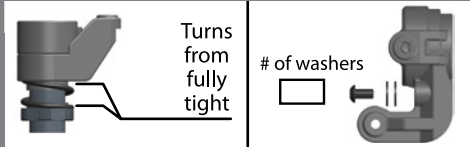
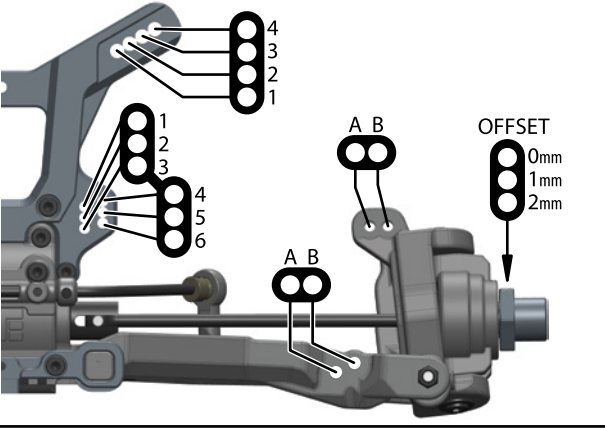

Suspension:

	FRONT	REAR
RIDE HEIGHT		
CAMBER		
CASTER		
SWEEP		
KICK UP		
ANTI-SQUAT		
TOE (in/out)		
SWAY BAR		
SHOCK LENGTH (DROOP)		

Tires / Wheels:

	FRONT	REAR
BRAND/TREAD		
COMPOUND		
INSERT		
WHEEL		
NOTES:		

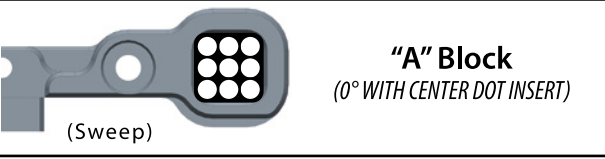

Rear End:

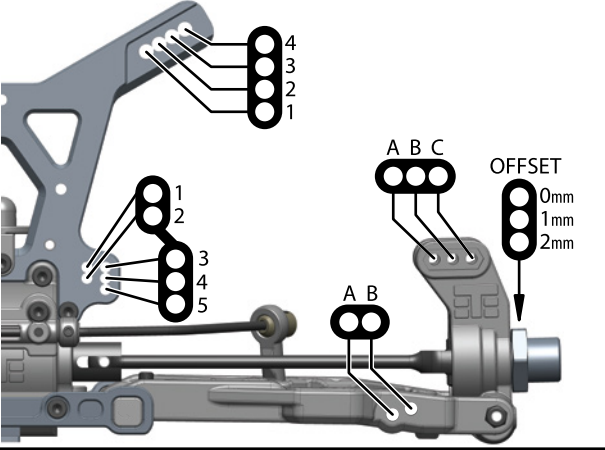

Body/Wing:

BODY MAKE	
WING MAKE	

Differential Oil:

	FRONT	CENTER	REAR

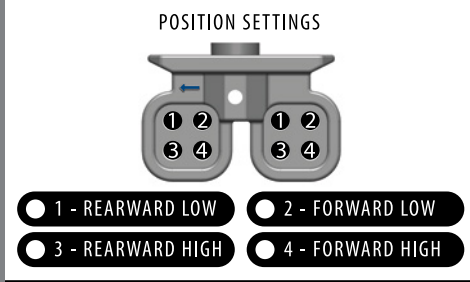

Electronics:

ESC:	
BATTERY:	
MOTOR:	
RADIO:	
SERVO:	

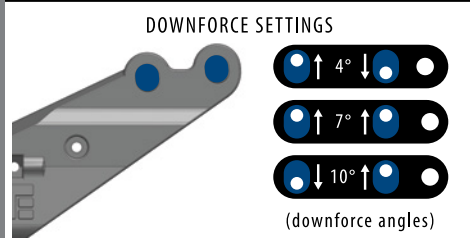
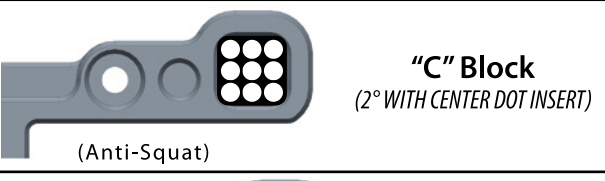

Drivetrain:

PINION SIZE		(teeth)
-------------	--	---------

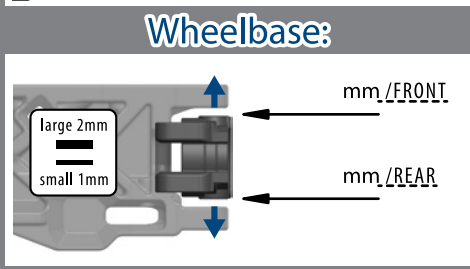
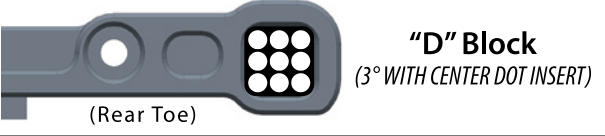

Chassis Braces:

Front Middle Rear

(front brace is always recommended)



Notes:



Tekno RC
10755 Scripps Poway Pkwy #598
San Diego CA 92131
USA

www.teknorc.com

