

TRF 511

TAMIYA RACING FACTORY

SETTING SHEET

RESET Ver 1.00

Date **1-3 April 2011**

Driver **Otto Ausfelt**

Track **EOS Pilot Event**

Track condition **Low-bite hard packed Clay, indoor.**

«Front»

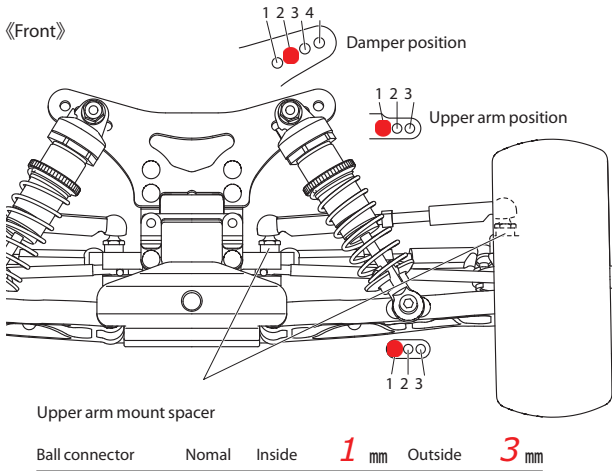

Ground clearance **21 mm**

Camber angle **1°**

Toe angle **0°**

Front drive **Diff One-way**

Pulley **stock T**

Stabilizer **none**

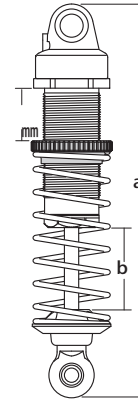

Damper length **a** mm
b mm

Piston **1,3** hole(s)

Oil **32,5 Losi #**

Spring **Blue**

«Rear»

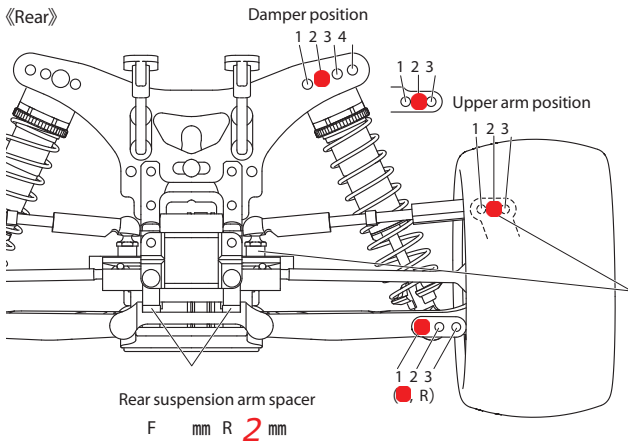

Ground clearance **22 mm**

Camber angle **1,5°**

Stabilizer **none**

Upper arm mount spacer

Ball connector Nomal

Inside **2 mm** Outside **3 mm**

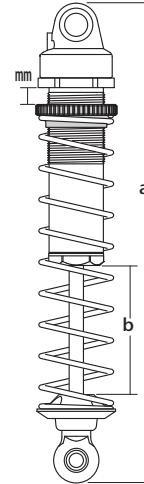

Damper length **a** mm
b mm

Piston **1,4** hole(s)

Oil **27,5 Losi #**

Spring **Blue 1.5coil cut**

«Front Tire»

Type **Taper-Pin** Compound **Pink**

Tire insert

Wheel **LOSI**

Air holes

«Rear Tire»

Type **BK-Bar** Compound **Pink**

Tire insert

Wheel **LOSI**

Air holes

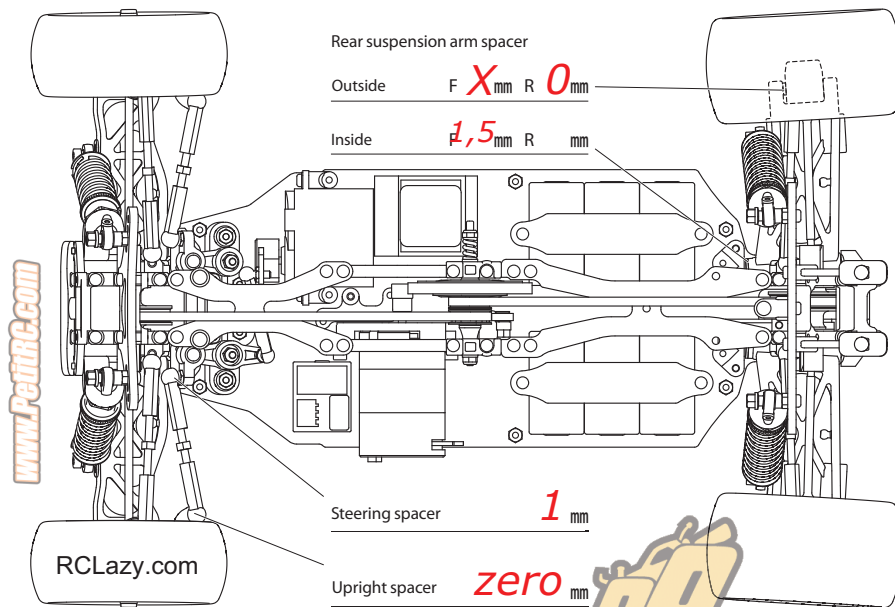

Motor **LRP X12 7.5**

Spur gear **91 T** Pinion gear **17 T**

Slipper clutch

Center one-way **no**

Battery **LRP 5000**

Body **511**

Wing **511 Big**

Wing-Lip

Standard casterblocks (10degree). 0.5 hubs wrong way around (-2.5toe) should have gone in on tower for the rear shocks. Fredrik Emilsson belt covers. Lacked a bit of mid-corner steering other than that it was perfect, just my driving that needs adjusting :) Thanks to Lars Nordin www.procar.se

Comments