

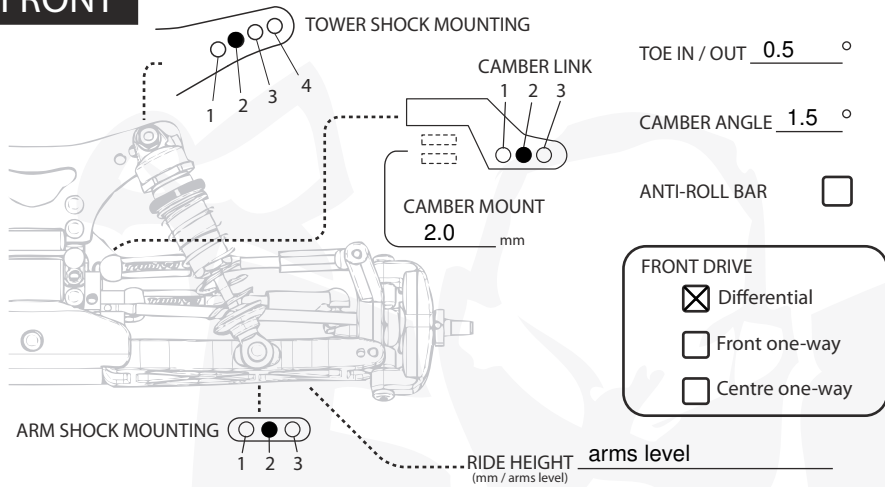

セッティングシート  
SETTING SHEET

DRIVER Jason Wakefield  
 DATE 21/4/07 TRACK Ipswich - Australia  
 EVENT club meeting

**FRONT**



**SHOCKS**

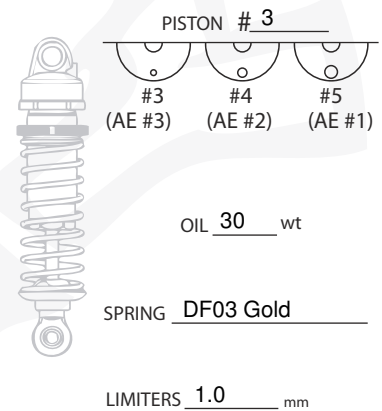

**REAR**

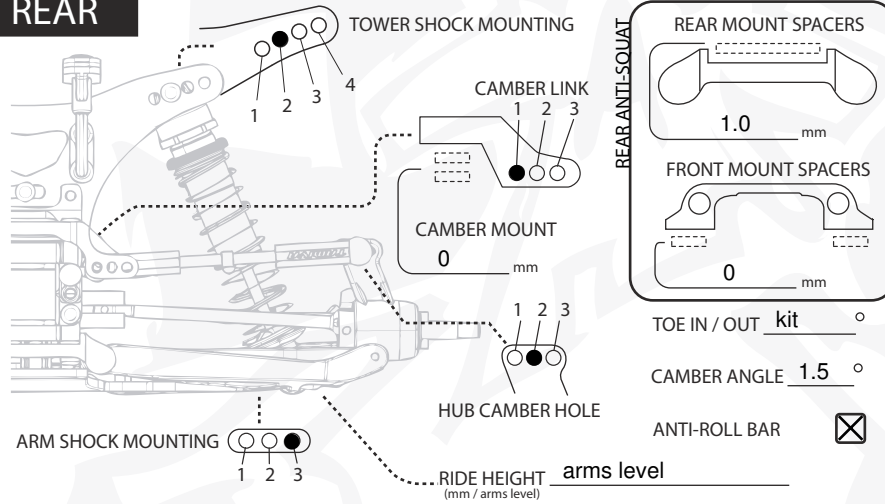

**SHOCKS**

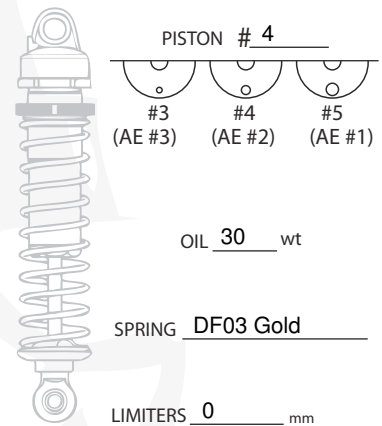

**FRONT WHEELS**

TYRES Proline Holeshot M3 INSERTS standard WHEELS Tamiya HOLES 2 x 3 mm

**REAR WHEELS**

TYRES Proline Holeshot M3 INSERTS standard WHEELS Proline HOLES 2 x 1 mm

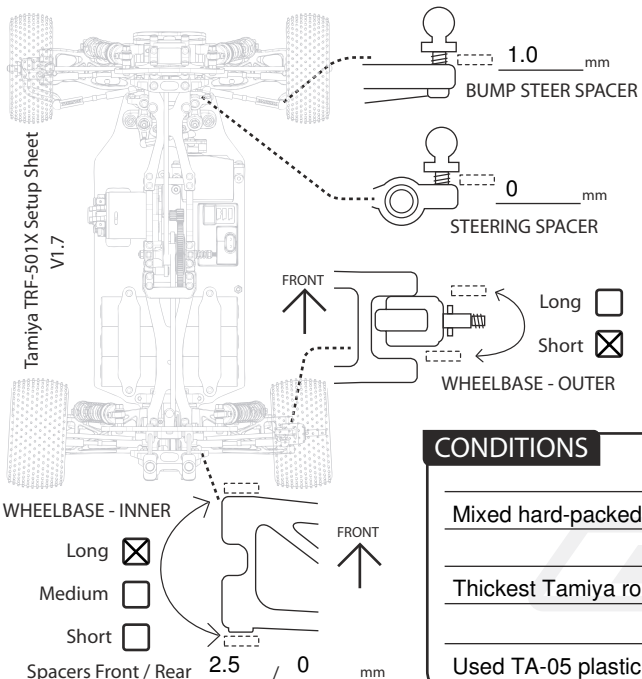

**ELECTRICS**

SERVO GM ESC Novak  
 BATTERIES Harris IB4200 RECEIVER Futaba 2.4

**MOTOR**

MOTOR & WIND DC 13x2  
 BRUSHES std SPRING std  
 PINION / SPUR 18 T / 87 T

**OTHER**

BODY kit WING ANGLE SHIM  
  
 WING kit FRONT

**CONDITIONS**

SMOOTH  SANDY  
 BUMPY  SOFT DIRT  
Mixed hard-packed dirt and astroturf track  LOW TRACTION  GRASS  
 MED TRACTION  BLUE GROOVE  
Thickest Tamiya roll bar on rear  HIGH TRACTION  CLAY  
 WET  DUSTY  
Used TA-05 plastic front diff outrives.  DRY  OTHER