

Conditions: Indoor Outdoor Dry Wet Blue Groove Hard Packed
 Composition: Astroturf Clay Carpet Dirt Grass Other: _____
 Size: Open Medium Tight Traction: High Medium Low Surface: Smooth Medium Bumpy

Diff. Oil
 Front: 5k Center: 200k Rear: 3k

Electronics
 Motor: HW V10 6.5 Spur/Pinion: 87/20
 Battery: Pro Amps 4200mAh Shorty
 Battery Position: Forward
 ESC: Hobbywing Xerun XR10 pro
 ESC settings: Mode 8, Punch at 5, no timing
 Servo: PA BLS108 Receiver: _____

Tire & Inserts

Front	Rear
Tire: <u>AKA Impact SS</u>	<u>AKA Impact SS</u>
Insert: <u>AKA Red</u>	<u>AKA Red</u>
Notes: _____	

Front Suspension

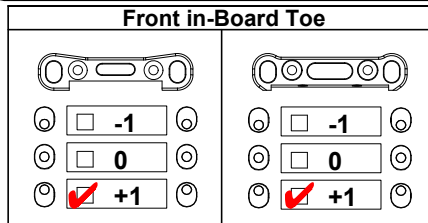

Front Shocks
 Oil: TLR 35
 Piston: 2x 1.4mm
 Spring: Kyosho Yellow
 Limiter: 2mm external

Body: Kit
 Wing: SW-250042
 Notes: Bezerk carbon Steering plates.

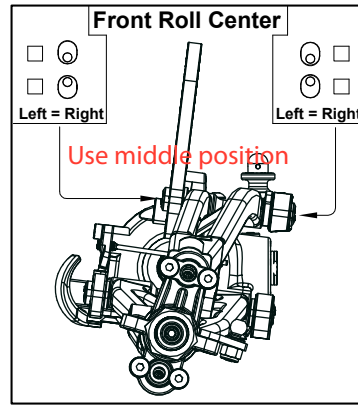
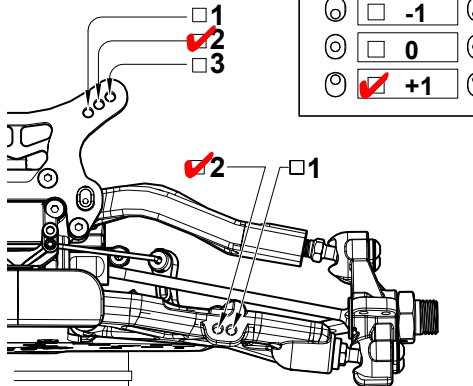

Track Width: Kit Hexes
 Caster: minimum
 Camber: -1 degree
 Toe: 2 degree Out
 Rebound Stop: _____
 Ride Height: 21mm
 Sway Bar: 1.3mm

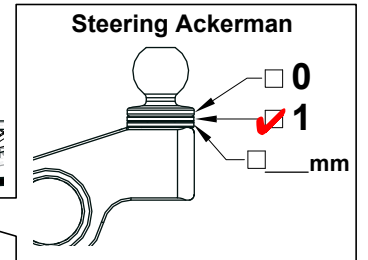
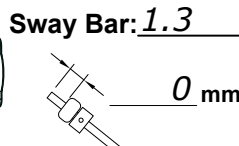
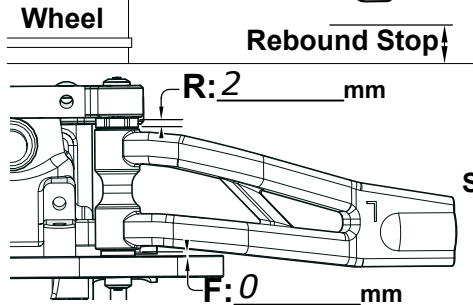

Rear Suspension

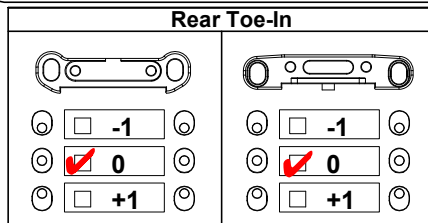

Rear Shocks
 Oil: TLR 30
 Piston: 2x 1.5mm
 Spring: Losi Yellow
 Limiter: 3mm external

Sway Bar: 1.5mm

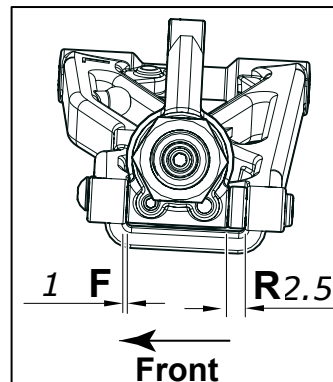
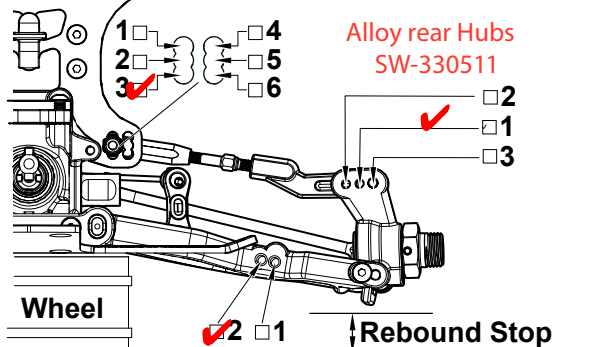

Track Width: Kit Hexes
 Camber: -1 degree
 Rebound Stop: _____
 Ride Height: 21mm
 Notes: cut down top decks, 20g ballast at rear, wing wicker 1st line up, rear shocks in hole 3 on tower. using TLR shocks with Sworkz cups

**remove washer between ALL shock o-rings if using Sworkz shocks