



INSTRUCTION MANUAL

& REFERENCE GUIDE



Welcome to Serpent

You are now part of the worldwide network of Serpent drivers, which gives you superior technical support and access to many benefits that only Serpent drivers can enjoy.

The Serpent Spyder offers state of the art specifications and leads the way in 1/10 buggy design, using all the knowledge we have gathered since 1980. Continuously pushing the performance envelope, Serpent's engineers have added many new and innovative features that can help take your Serpent Spyder into the winner's circle.

INSTRUCTIONS

Serpent's long tradition of excellence extends to their instruction manuals, and this instruction manual is no exception. The easy-to-follow layout is richly illustrated with 3D-rendered full-color images to make your building experience quick and easy. A default set-up sheet is added to have a good base set-up. Following the instructions will result in a well-built, high-performance racecar that will soon be able to unleash its full potential at the racetrack.

This instruction manual has been divided into sections that will logically lead you through the assembly process of your Serpent Spyder. Follow the assembly steps in the order presented to ensure that no problems occur during assembly. Each step indicates all the fasteners and small

parts used. Bag numbers identify the kit bag(s) that contains the appropriate parts.

EXPLODED VIEWS AND PARTS LIST

The exploded views and parts lists for the Serpent Spyder are included in the back of this manual. The exploded views show all the parts of a particular assembly step along with the Serpent part number. The parts lists indicate the part number and name of each part for easy reference when ordering.

Below you will find some information on safety; read those well before using the car. Also some info on how to use the manual best.

The worldwide network of Serpent drivers, dealers and distributors will help you to get the maximum out of your Serpent Spyder.

Join the free Serpent forum for support, use our social media like Twitter and Facebook to follow all info and meet other Serpent drivers, watch the Serpent Youtube channel for video's, the Serpent Teamblog for race reports around the globe and the Serpent website for all other info and news.

Enjoy racing !

Team Serpent

SAFETY

Read and take note of the 'Read this First section' before proceeding to assemble the car-kit. This car-kit is intended for persons aged 16 or older.

CUSTOMER SERVICE

Serpent has made a strong effort to make this manual as complete and clear as possible.

Additional info may be published in our website: www.serpent.com or you may ask your dealer or the Serpent distributor for advice, or email Serpent direct: info@serpent.com

The Serpent Facebook, Twitter and Youtube pages give additional means of support and communications.

INSTRUCTIONS, HOW TO USE

The kit includes bags, with bag numbers, which refer to the same step in the manual. Open only the indicated bag(s) per step and finish that part of the assembly.

Remaining parts will be needed later on in

the assembly process.

SETUP

In many assembly steps you mount specific parts that suit the default set-up. We advise to keep the separate default set-up sheet alongside the manual, during all assembly.

Other finetuning of the set-up, must be done at the track.

CONTENTS

| | |
|-----------------------|----|
| FRONT ASSEMBLY | 4 |
| REAR ASSEMBLY | 9 |
| BALL DIFF ASSEMBLY | 10 |
| TRANSMISSION ASSEMBLY | 11 |
| SHOCKS ASSEMBLY | 14 |
| FINAL ASSEMBLY | 17 |
| REFERENCE GUIDE | 18 |
| PARTS LISTS | 26 |

Read this first!

- This is a highly technical hobby product, intended to be used in a safe racing environment. This car is capable of speeds in excess of 80 km/h or 50mph. Please follow these guidelines when building and operating this model.
- Parental guidance is required when the builder/user of this car is under 16.
- Follow the building instructions. If in doubt, contact your dealer or importer.
- Be sure to use the proper tools when assembling the car. Always exercise caution when using electric tools, knives and other sharp objects.
- Be careful when using liquids like lubrication oil, fuel or glue. Do not swallow.
- Follow the manufacturer's instruction in case you experience irritation after using the product.
- Be careful when operating the car. Stay away from any rotating parts such as wheels, gears and transmission. Stay away from motor, engine and exhaust pipe system or speedo during and immediately after use, as these parts may be very hot. We advise to use protective hand gloves.
- Only operate this car in a safe environment, like a special racing track or a closed parking lot. Avoid using

- this car on public roads, crowded places or near infants.
- Before operating this car, always check the mechanical status of the car. Also check that the transmitter and receiver frequencies correspond and are not used by any other racer at the same time.
 - Check that the batteries of the transmitter and receiver are fully charged.
 - After use, always check all the mechanics of the car. We advise to clean the car immediately after use, and inspect the parts for wear or fractures. Replace when necessary. Do not use water, methanol, thinner or other solvents to clean the car.
 - Empty the fuel tank (depending on model) if needed and disconnect the receiver battery.
 - Store the car in a dry and heated place to avoid corrosion of metal parts.
 - Avoid using this car in wet conditions as the water will cause corrosion on the metal parts and bearings and these parts will cease to function properly.
- If driven in the wet, ensure that all the electric equipment is waterproofed and after use, that all moving parts are dried immediately.

USING THE MANUAL

Each step contains a variety of numbers, lines, and symbols. The numbers represent the order in which the parts should be assembled. The lines and symbols are described below.

| | |
|--|---|
| | Step number; the order in which you should assemble the indicated parts |
| | Length after assembly |
| | Assembly path of one item into another |
| | Group of items (within lines) should be assembled first |
| | Direction the item should be moved |
| | Glue one item to another |
| | Press/Insert one item into another |
| | Connect one item to another |
| | Gap between two items |
| | Apply graphite grease (Grey), |
| | Apply threadlock (Blue), |
| | Apply silicone grease (Orange), |
| | Apply silicone oil, |

FRONT ASSEMBLY

STEP
1

Bag
1

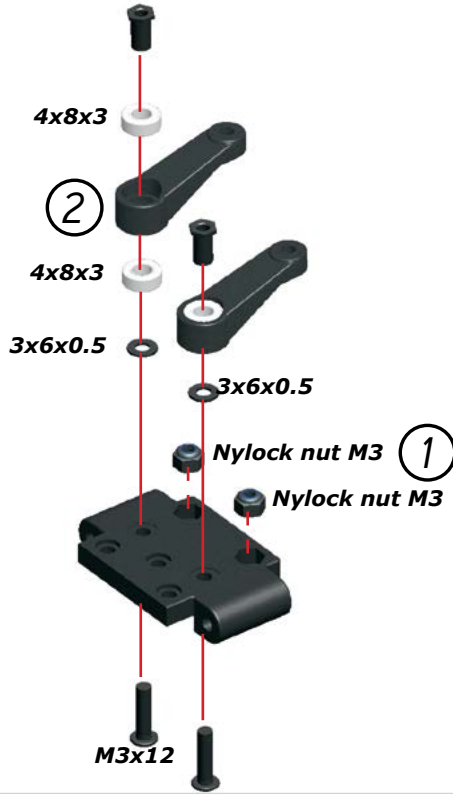

STEP
2

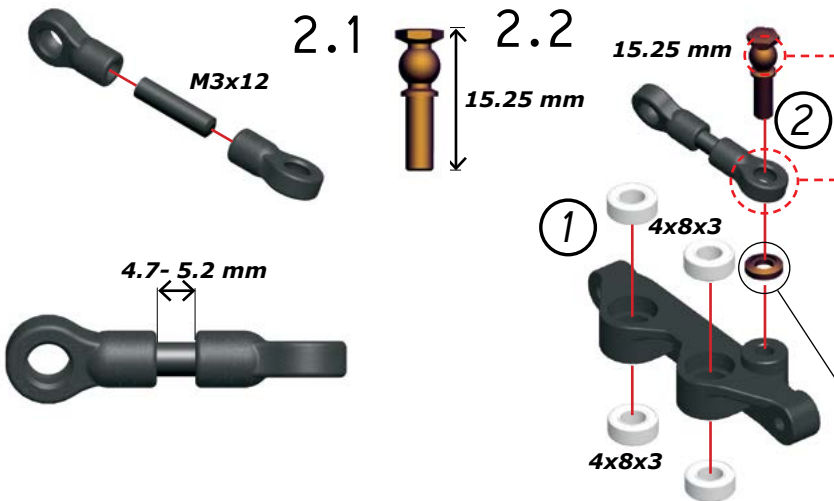

NOTE:
Make sure to
assemble the
ballstud through
the conical shim
in the direction
indicated by the
red arrow.

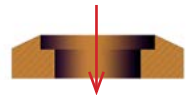

STEP
3

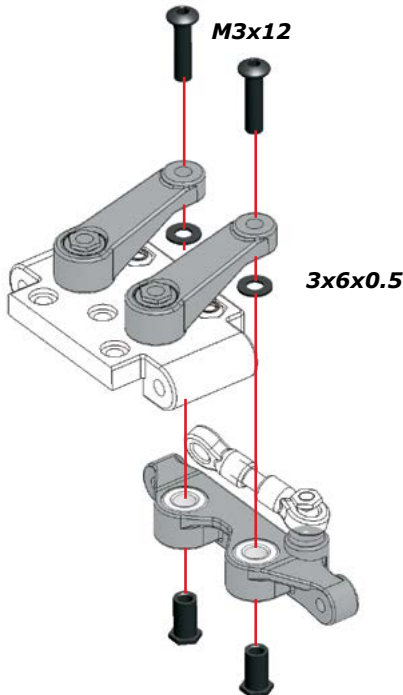

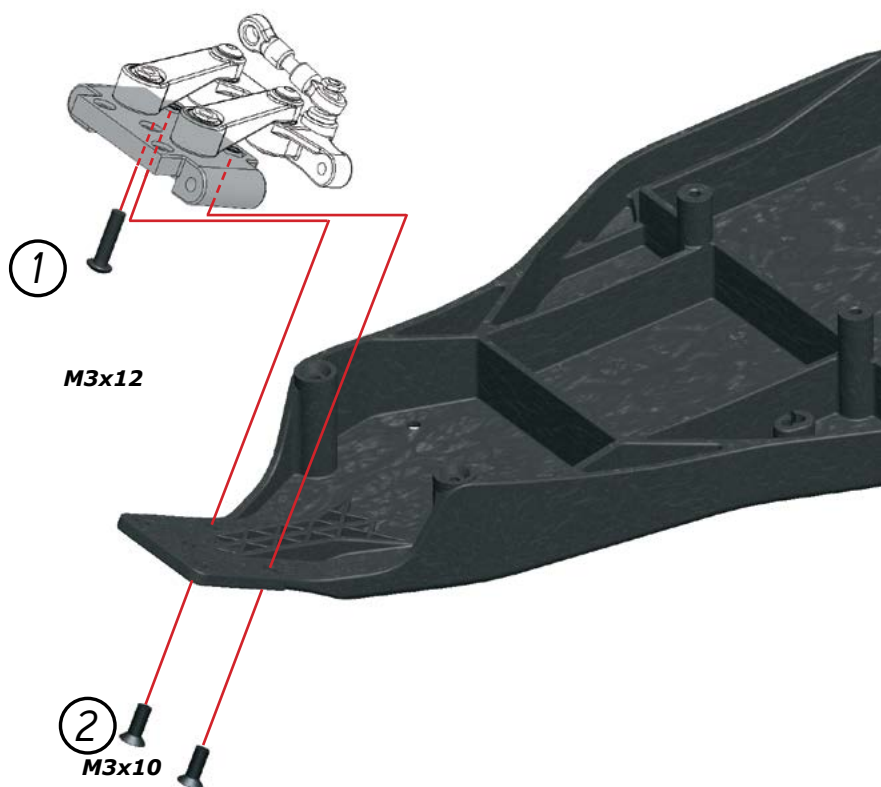

5.1

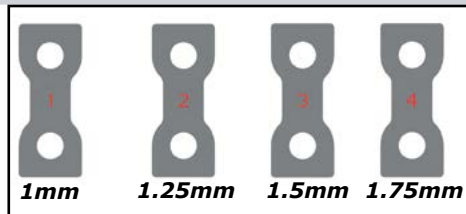
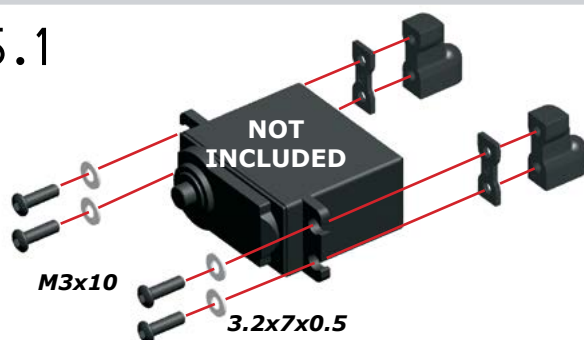

| Servo Manufacturer | Spacer |
|--------------------|--------|
| Airtronics | 1+3+4 |
| Futaba | 3+4 |
| Hitec | 2 |
| JR | 2 |
| KO Propo | 1+2 |
| Spektrum | 1+2+3 |

5.2

Use the following servo horns with this brand of servos:
 23 Sanwa / KO / JR
 24 Hitec
 25 Futaba / Hitec / Savox

NOTE:
 Make sure to put servo in neutral before mounting the steering lever

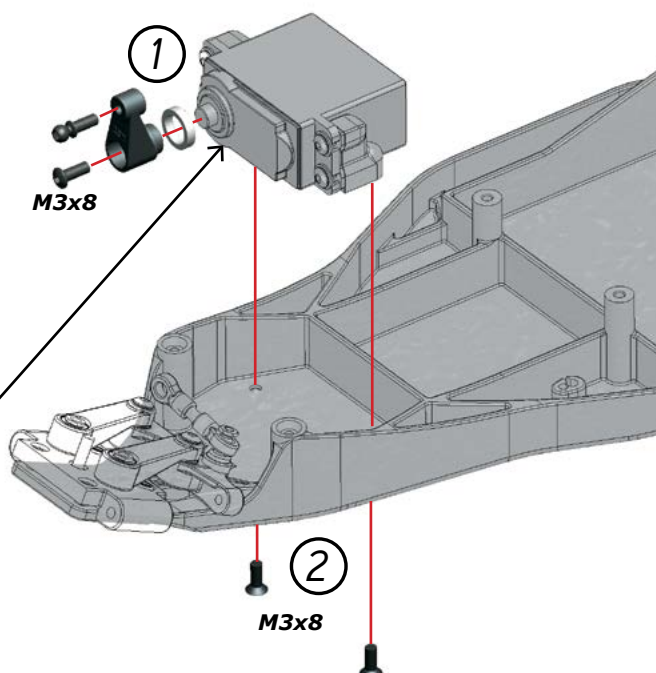

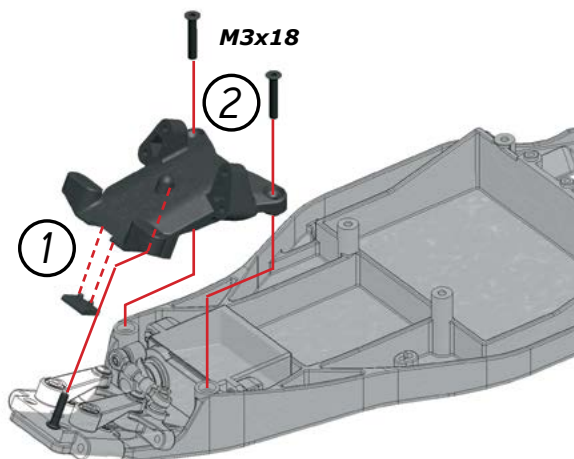

7.1

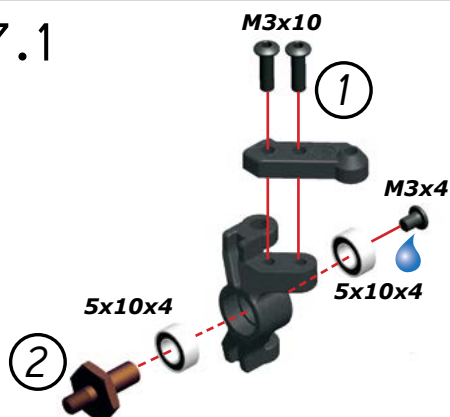

7.2

NOTE
Place the caster shims and the bushings in the steering block first. Then slide the assembly onto the casterblock

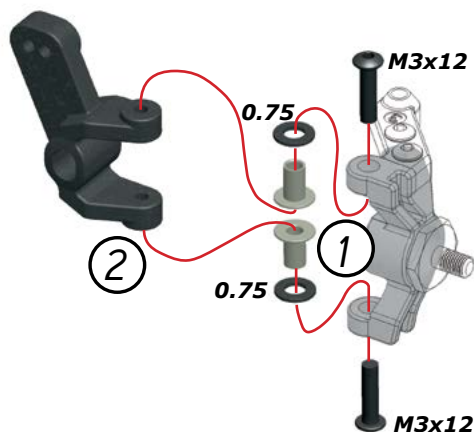

NOTE

There are three types of steering arms. Please, assemble number **2** as default

MORE ACKERMAN ← → LESS ACKERMAN

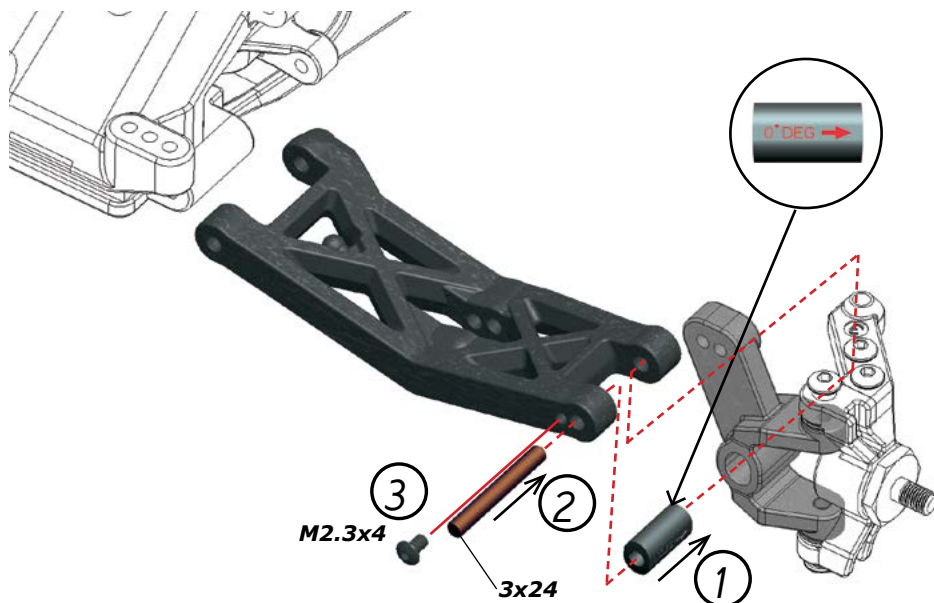
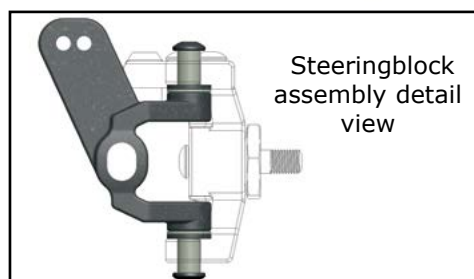

STEP
9

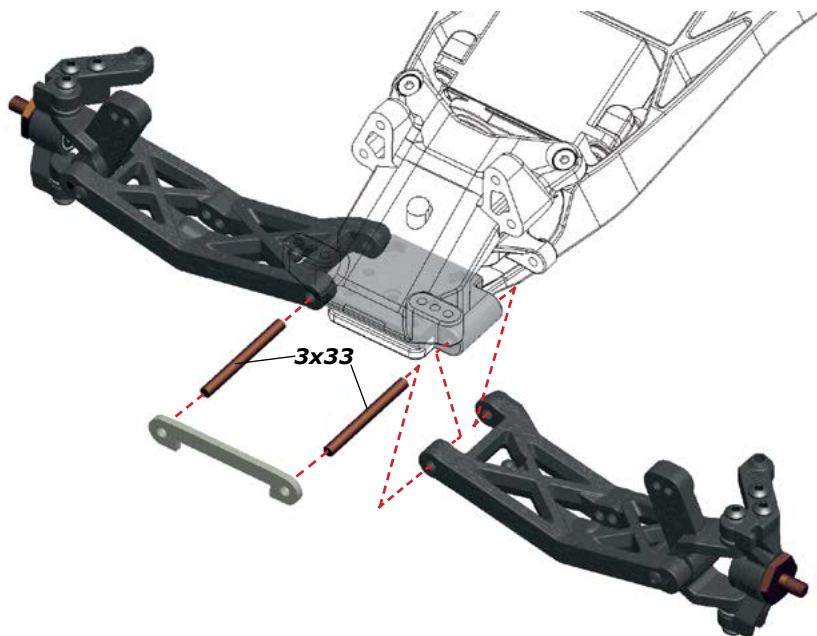

STEP
10

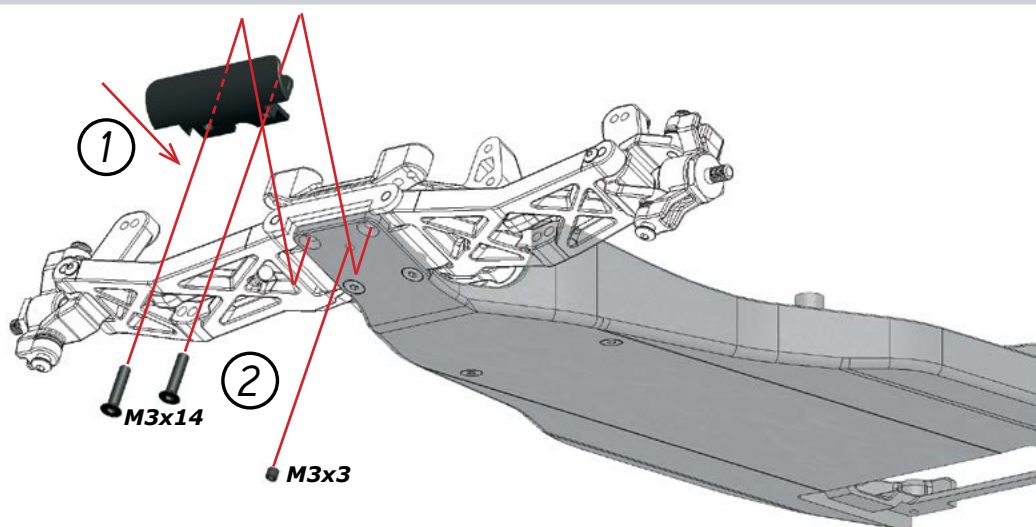

STEP
11



11.2

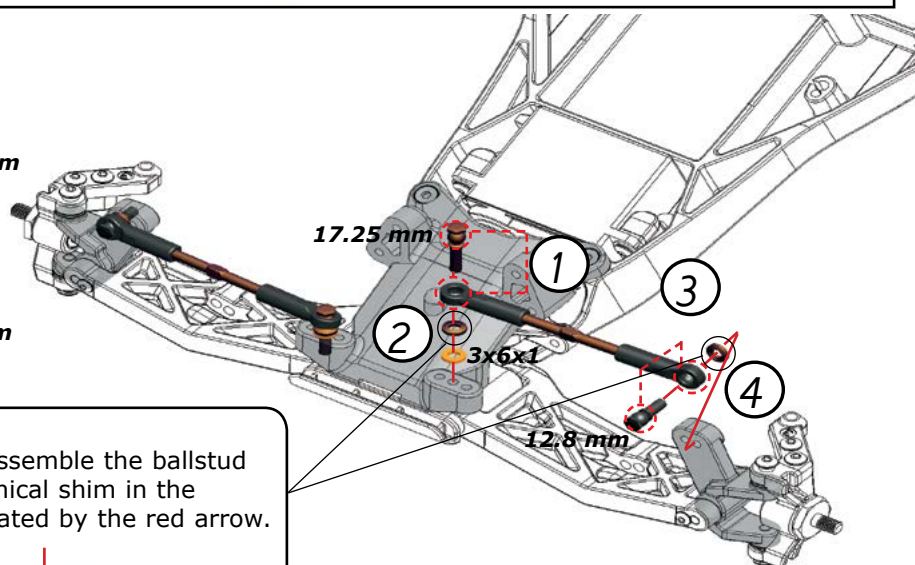
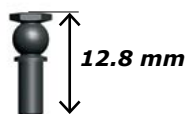
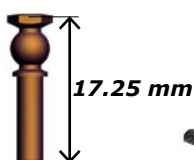

NOTE:
Make sure to assemble the ballstud through the conical shim in the direction indicated by the red arrow.

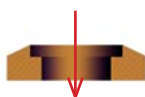

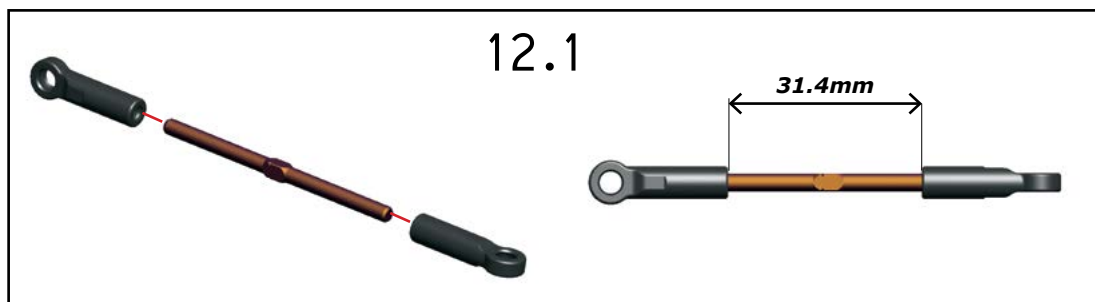

12.2

NOTE:
Make sure to assemble the ballstud
through the conical shim in the
direction indicated by the red
arrow.

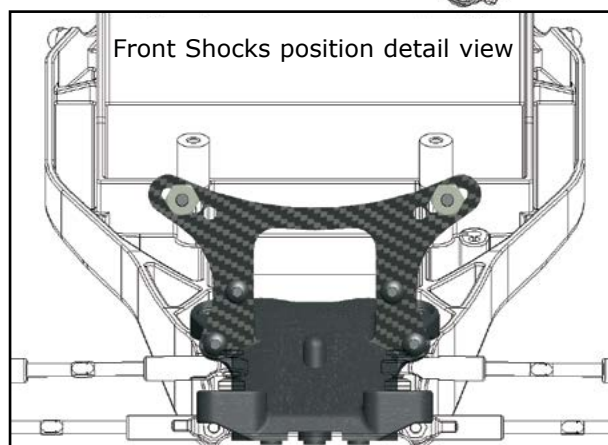
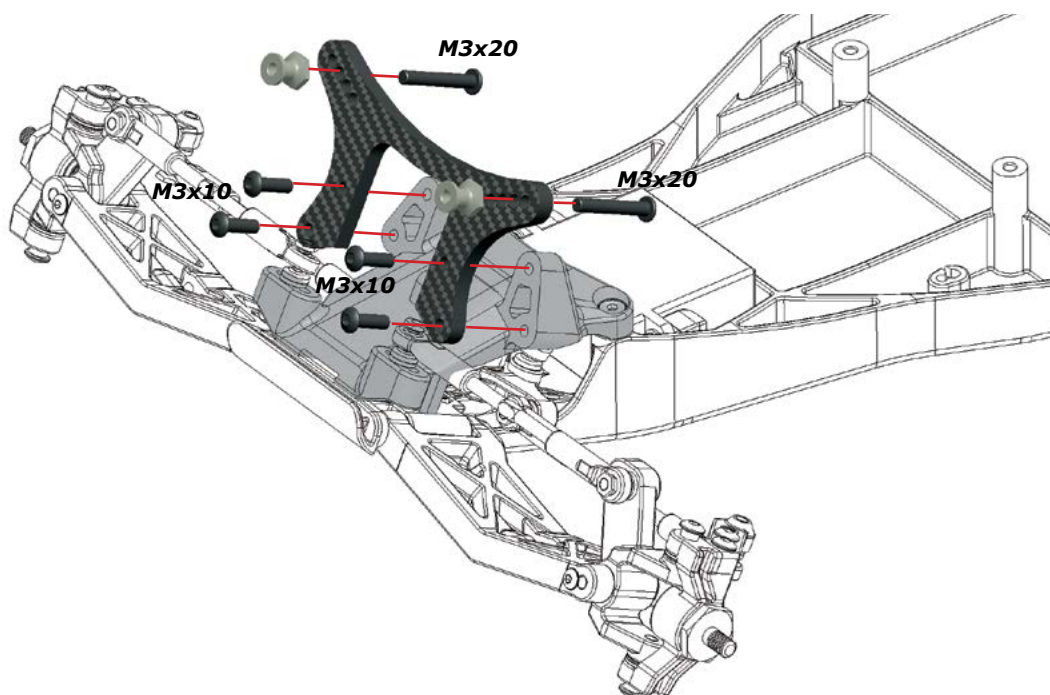
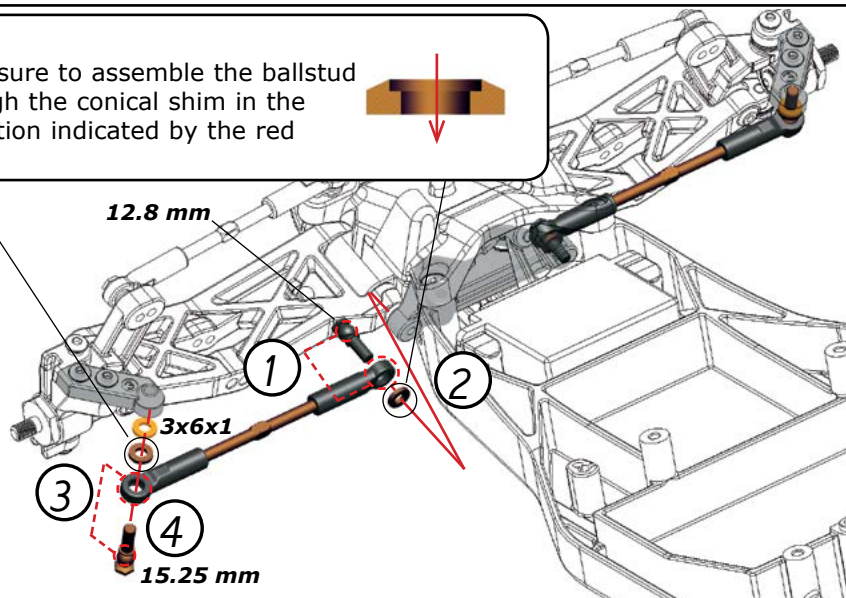
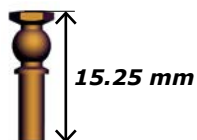
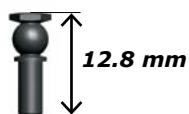
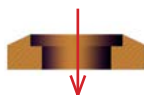

REAR ASSEMBLY

STEP
14

Bag
3

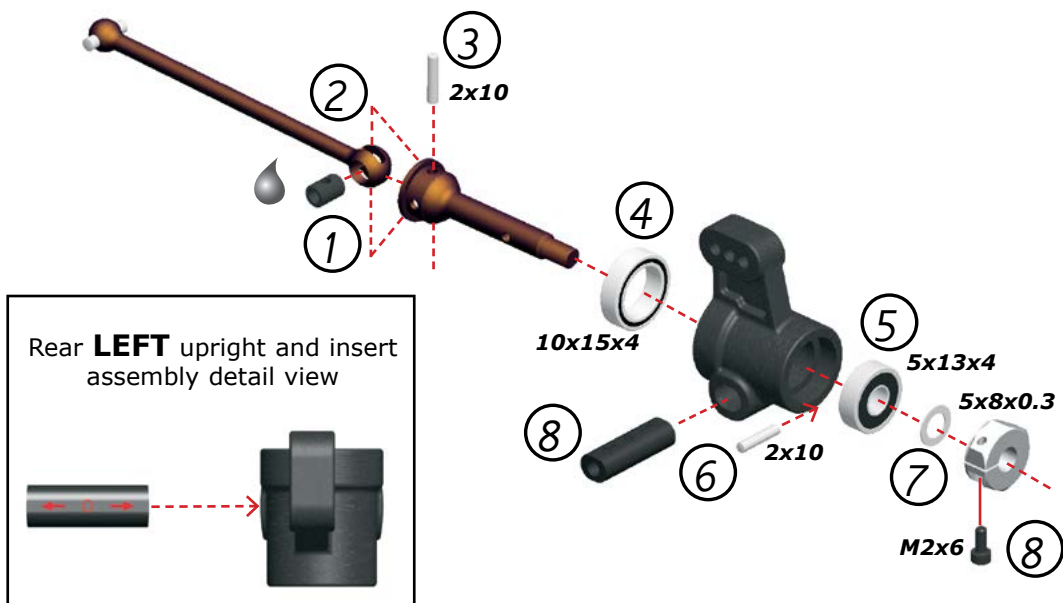

STEP
15

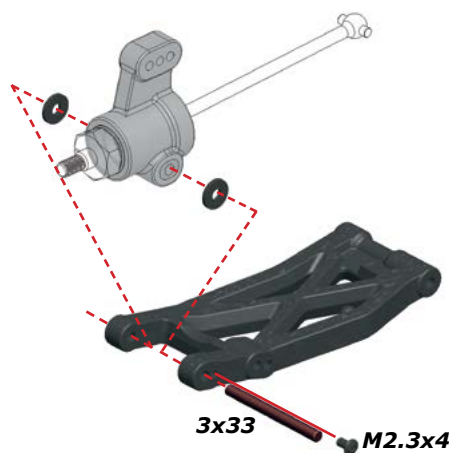

STEP
16

ASSEMBLY CORRECT ORDER:

- 1) Introduce the pin in the wishbone
- 2) Place the rear insert in the rear part of the toe block
- 3) Place the wishbone and pin in the rear toe block
- 4) Place the inserts in the front toe block
- 5) Assemble the front toe block.
- 6) Assemble rear bumper.

Front Inserts detail view (use number 2 also in the front block)

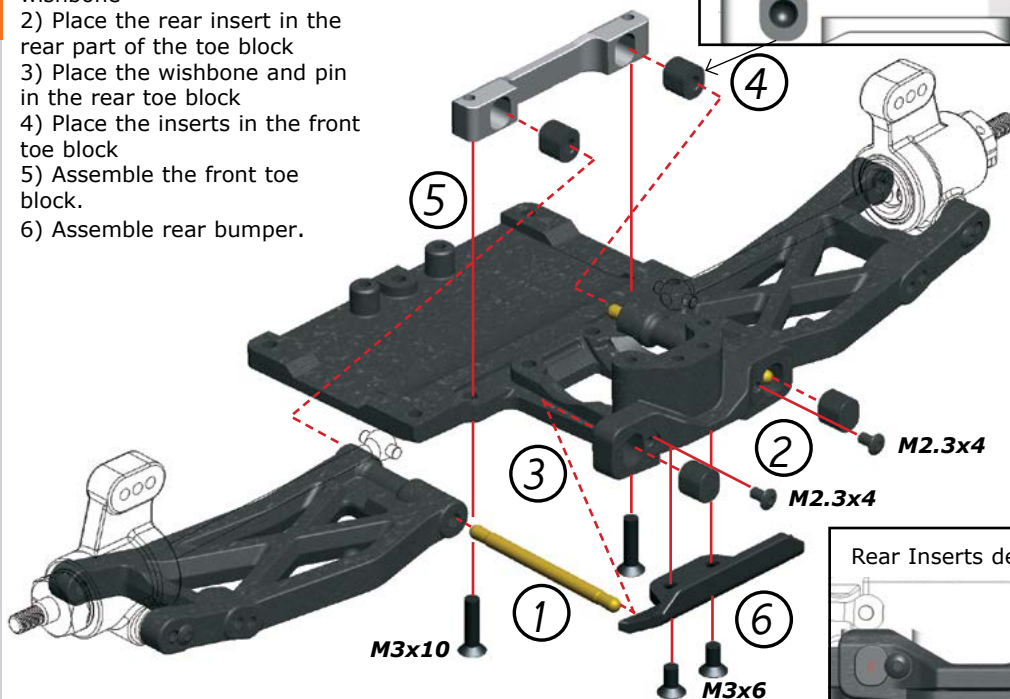

Rear Inserts detail view

STEP
17

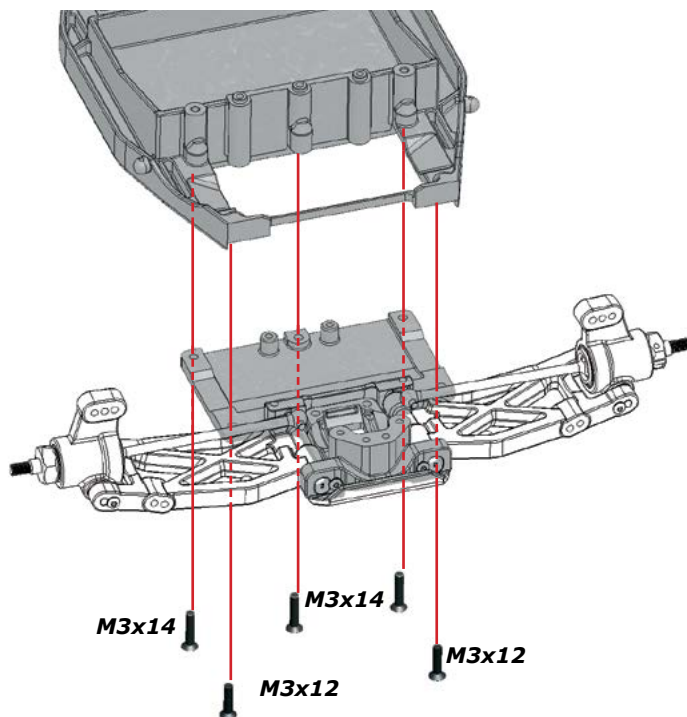

BALL DIFF ASSEMBLY

STEP
18

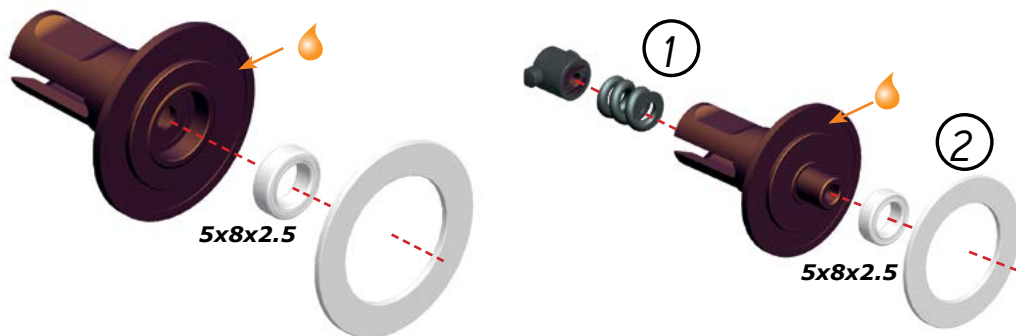

Bag
4

STEP
19

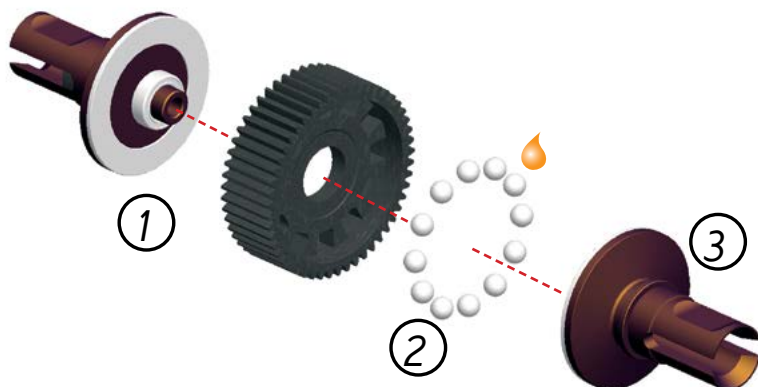

STEP
20

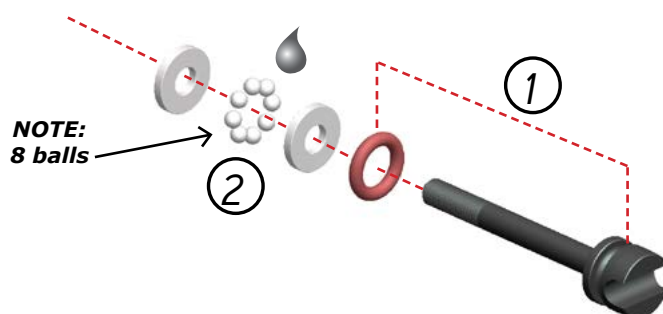

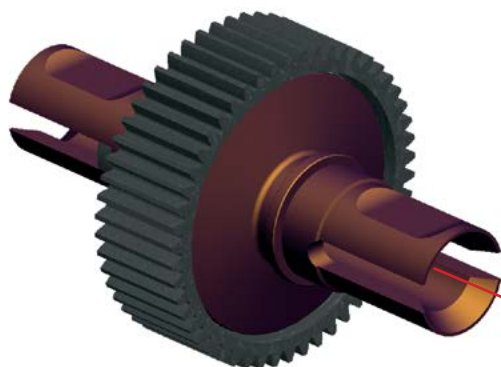

HOW TO ADJUST THE DIFF
As default setting screw all the way in, and back out ¼ turn.

Make small adjustments depending on the track condition.

NOTE:
Lubricate o-ring with grease



TRANSMISSION ASSEMBLY

22.1

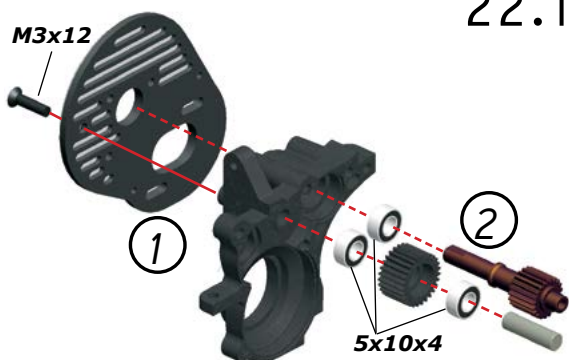

22.2

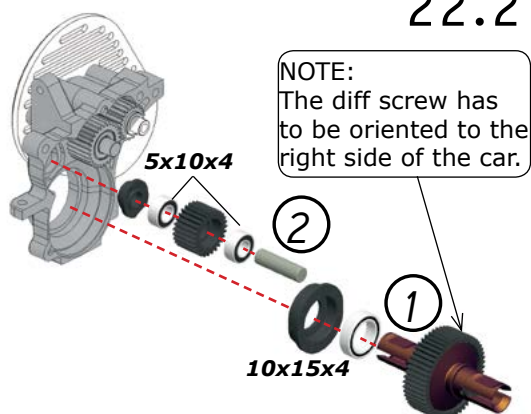

NOTE:
The diff screw has to be oriented to the right side of the car.

22.3

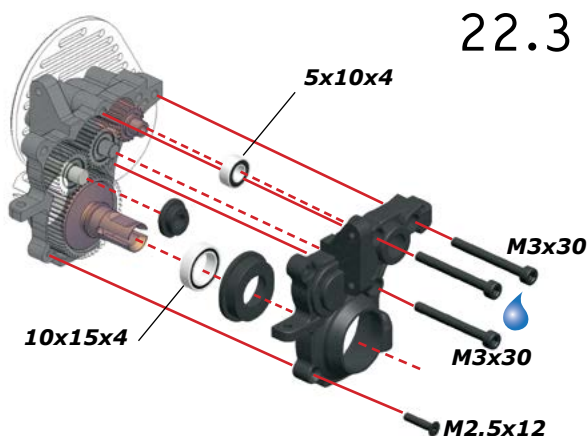

DIFF HEIGHT SETTING:
Change the indicated inserts to move the diff up or down. Adapt the diff and idler insert accordingly.
Default position mid diff.

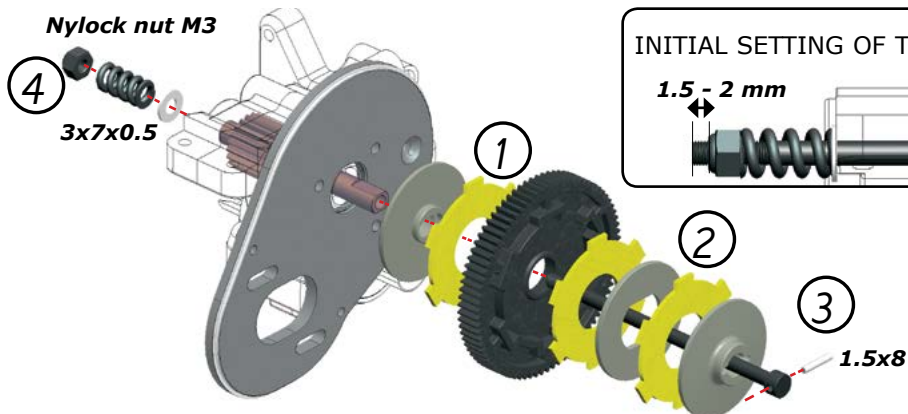
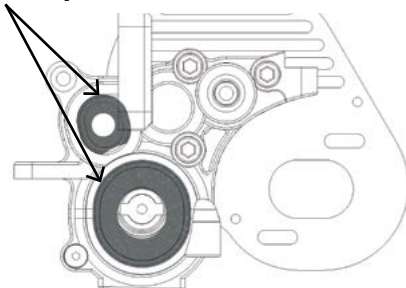

INITIAL SETTING OF THE SLIPPER

1.5 - 2 mm

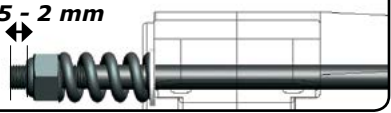

STEP 24

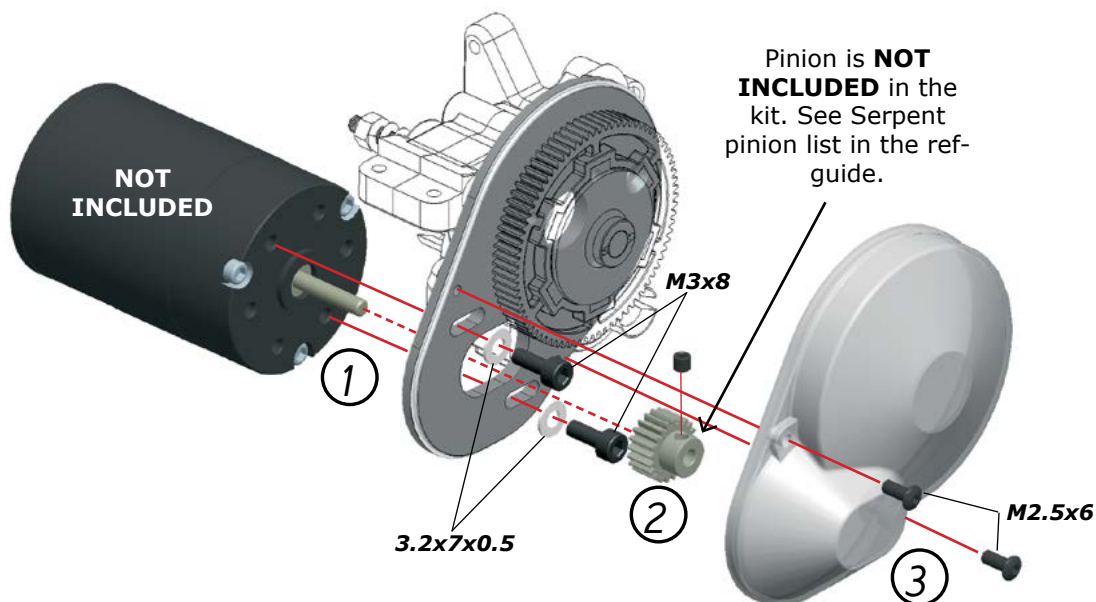

STEP 25

Bag
7

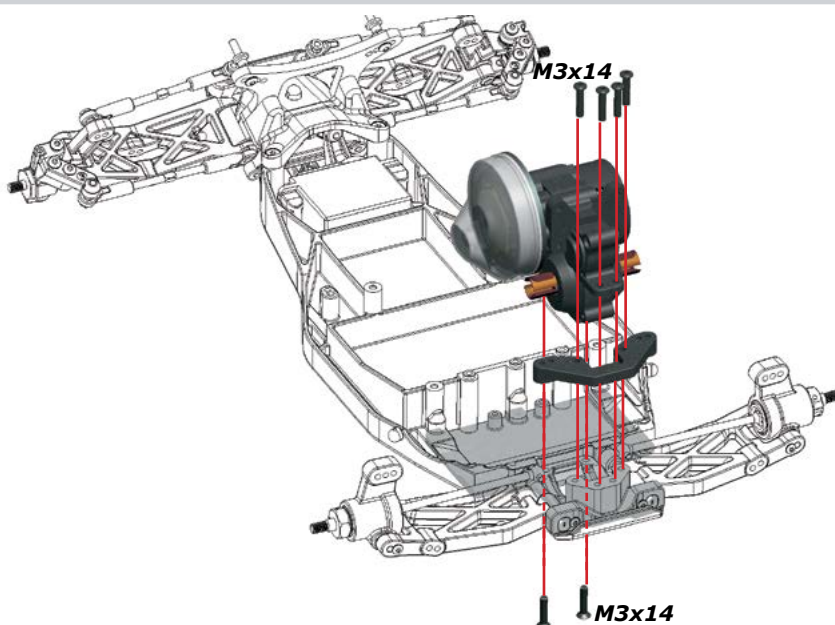

STEP 26

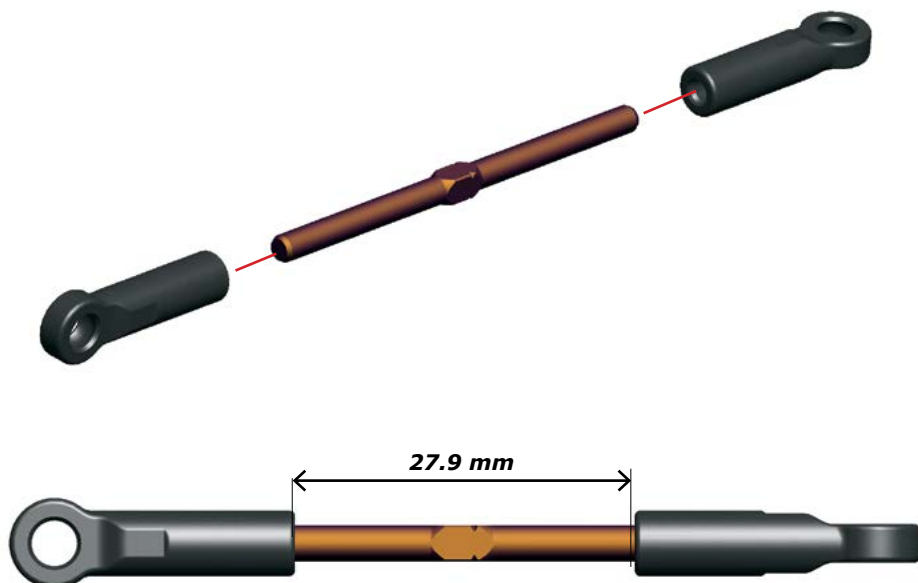

STEP 27

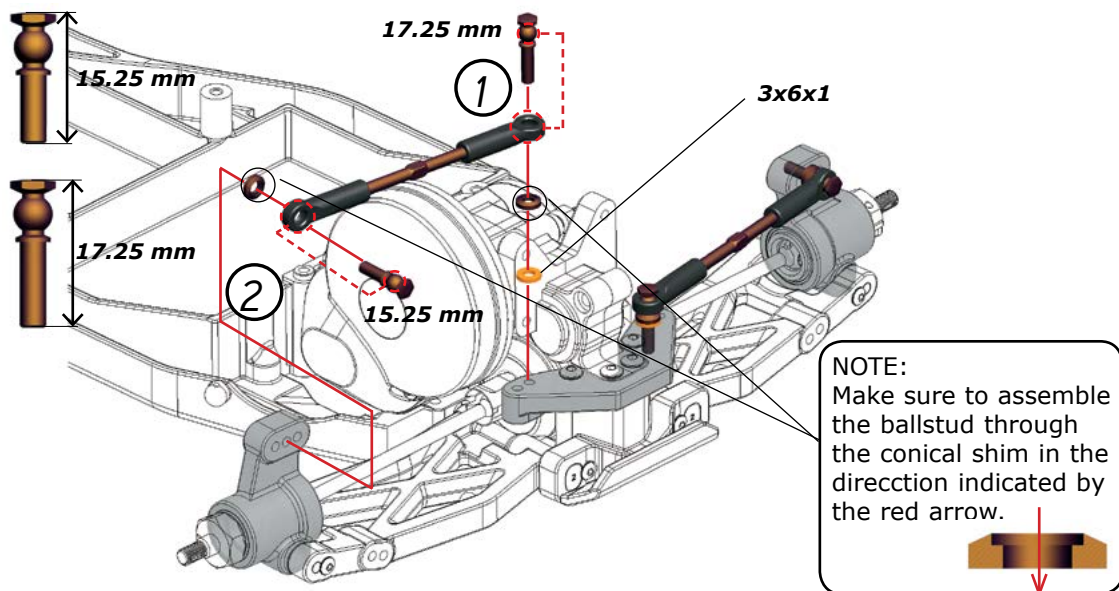

STEP 28

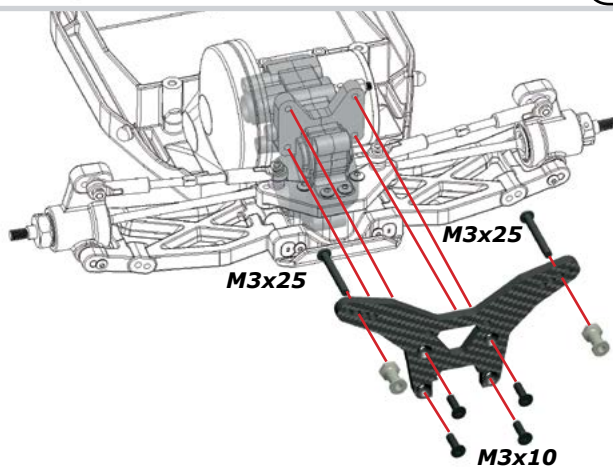

STEP 29

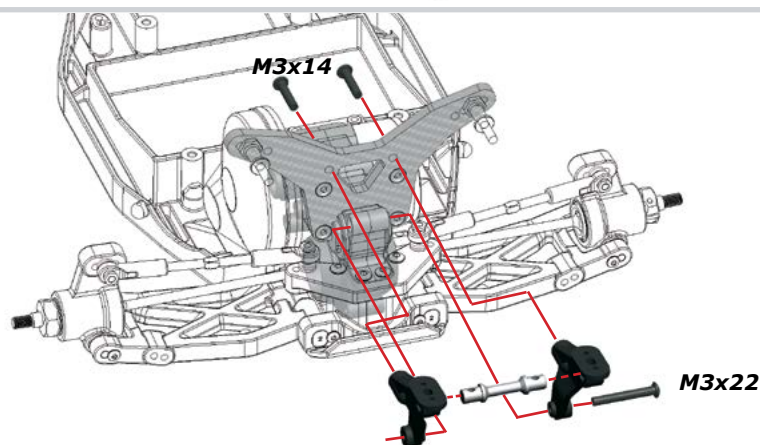

STEP 30

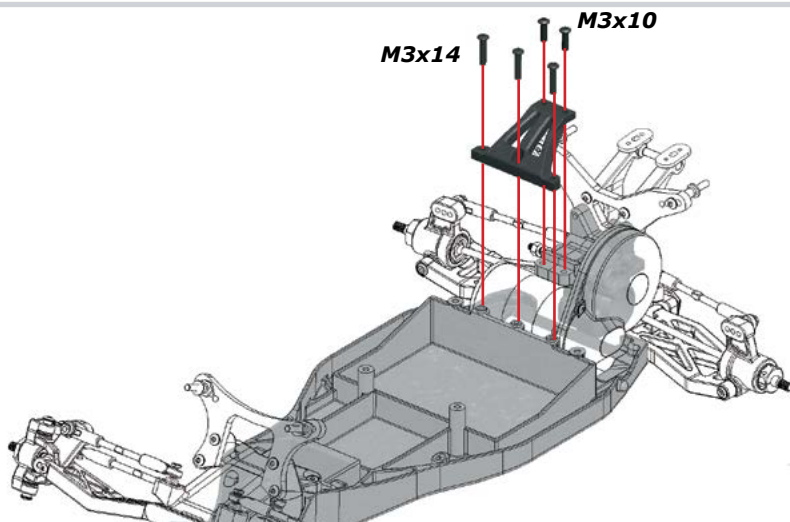

SHOCK ABSORBERS ASSEMBLY

STEP
31

Bag
8
REAR
SHOCKS

Bag
9
FRONT
SHOCKS

31.1

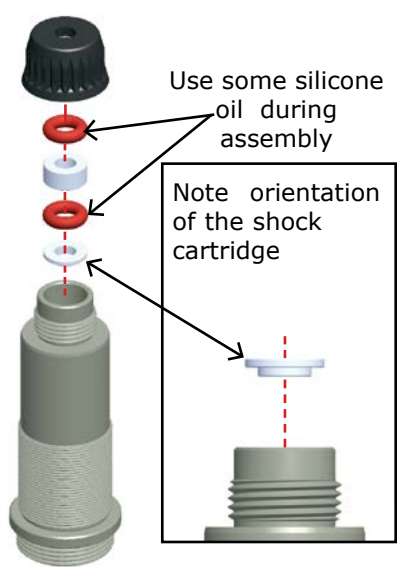

31.2

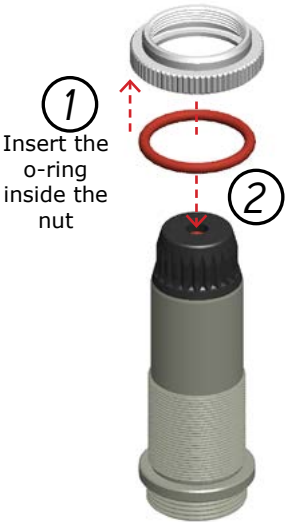

31.3

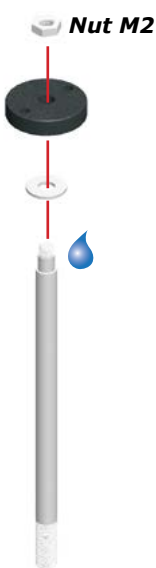

31.4 REAR SHOCKS

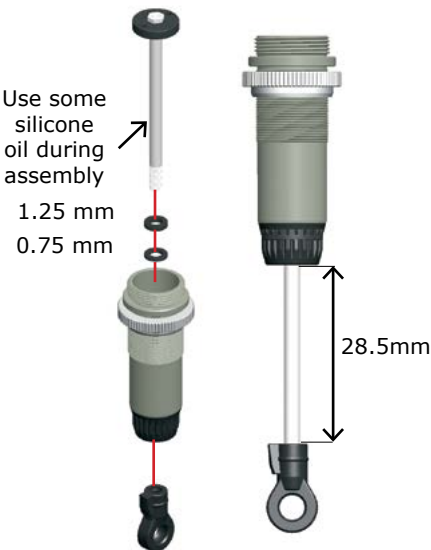

31.4 FRONT SHOCKS

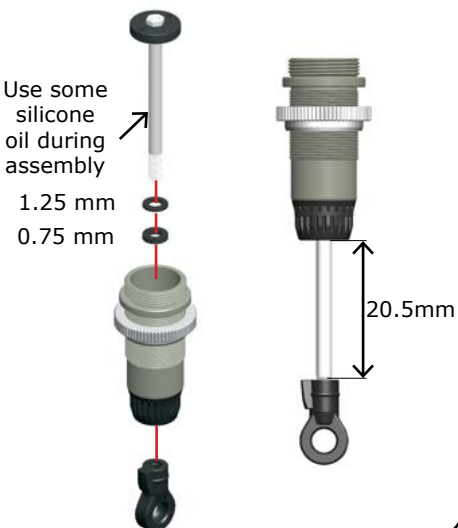

31.5

Fill the shockbody with silicone oil fully.

Move the shockrod up and down slowly to let airbubles escape



31.6

Apply the gasket and cap and close fully.

Bleed: push the shockrod all the way in slowly, to allow excessive oil to escape.



31.7

With shockrod fully in, mount the o-ring and screw.

M2.3x4



31.8

Assemble the spring and spring-cup (align correctly) to complete the shock.



FRONT SHOCKS

HIGH

REAR SHOCKS

LOW

STEP 32

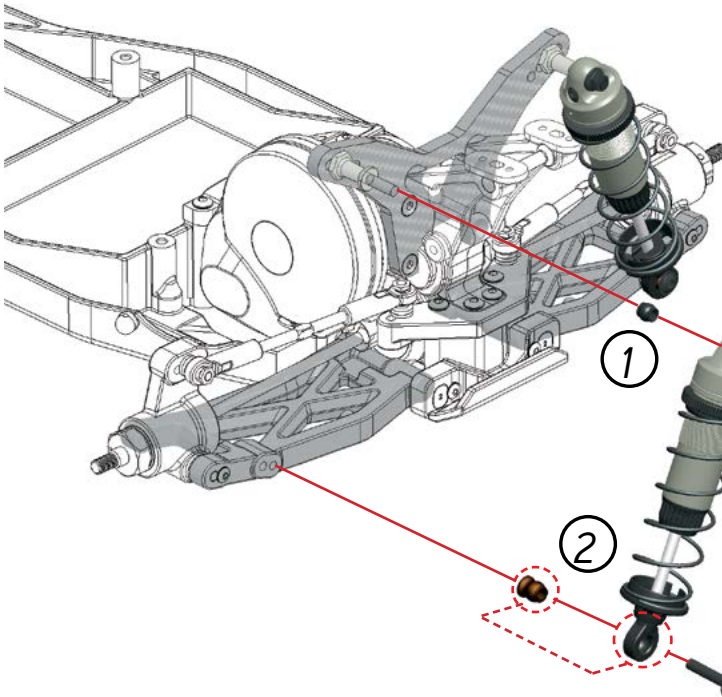

NOTE:

Do not overtighten and smash bushing with the nut and note orientation of the lower shock pivot ball

STEP 33

NOTE:

Do not overtighten and smash bushing with the nut and note orientation of the lower shock pivot ball

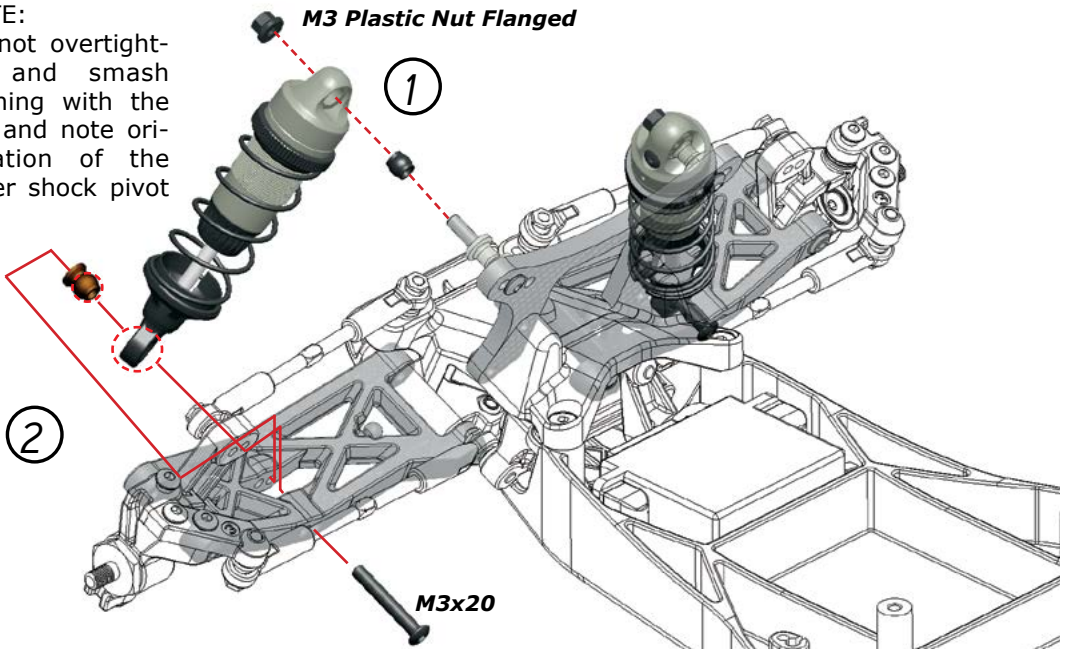

ELECTRONICS ASSEMBLY

STEP

34

Bag

10

Tip: Use double sided tape to mount the ESC and RX to the chassis.

NOT INCLUDED

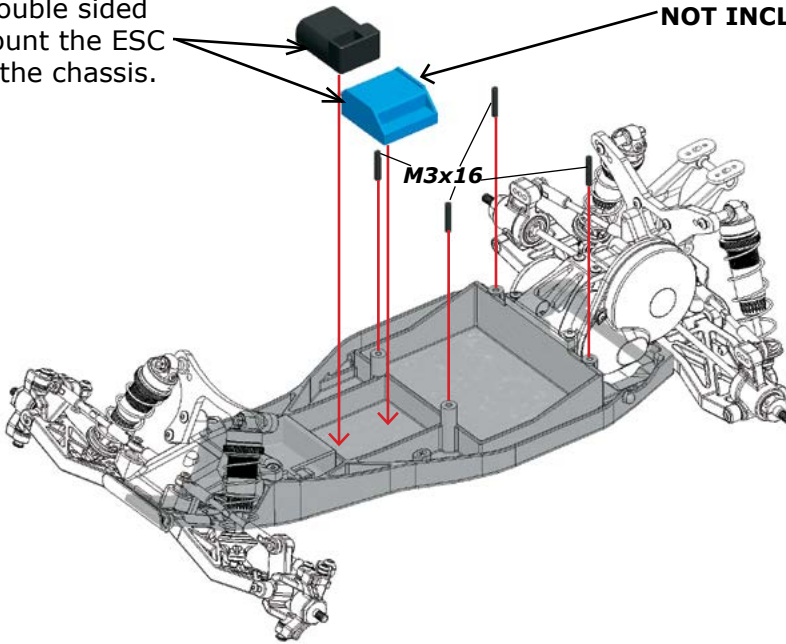

STEP

35

34.1

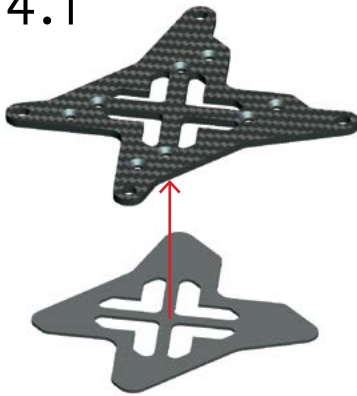

34.2

NOTE:
Only assemble this
parts if you are going
to use shorty lipos.

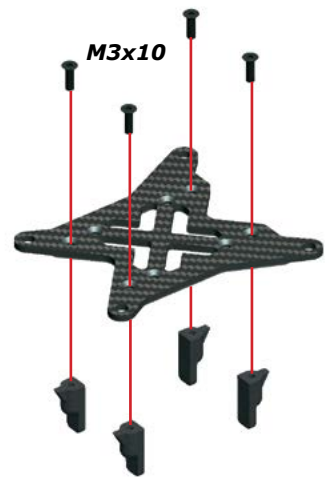

STEP

36A

Default Battery Configuration:
SADDLE LIPOS

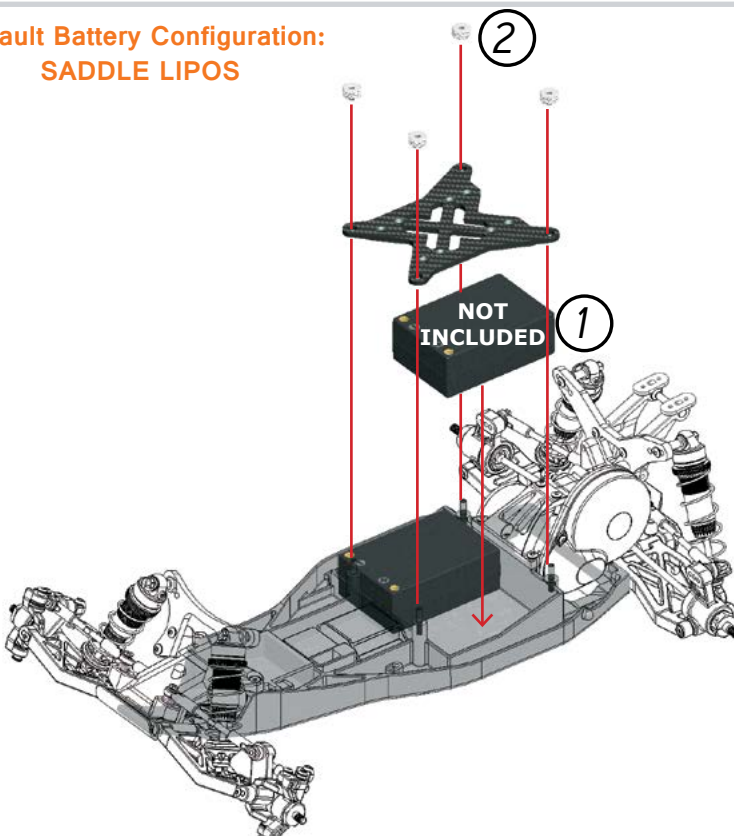

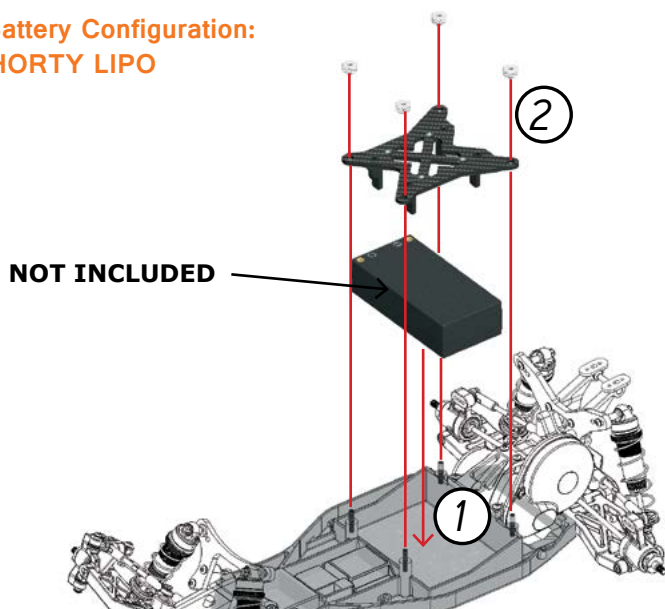

STEP 37

Two sets of wing angle platforms available in the kit, 2 and 4 degrees. Please match them and assemble them in the same orientation.

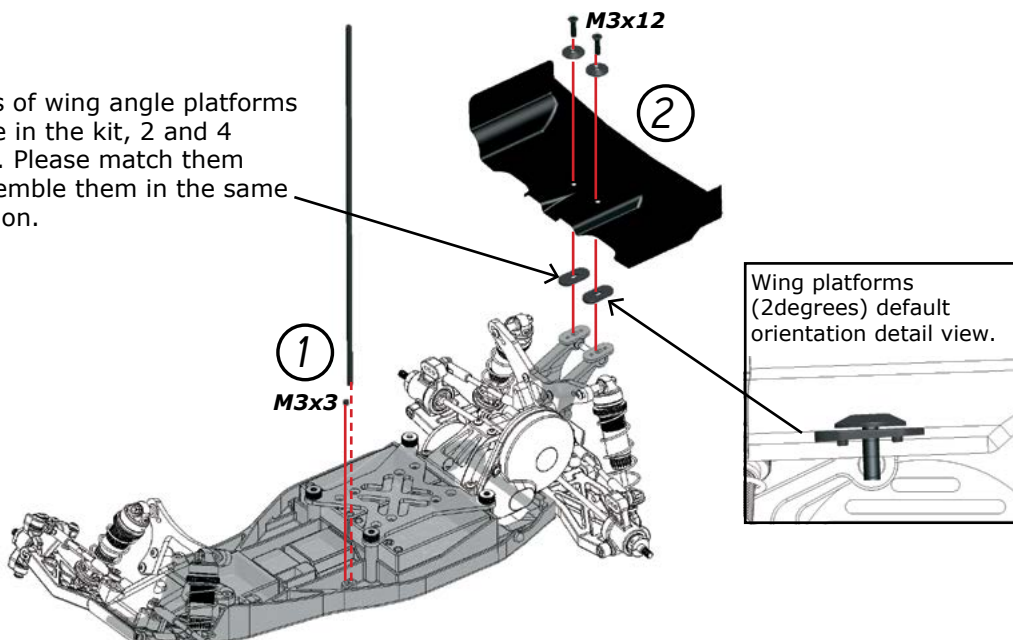

NOTE:

- Rims included in the kit
- Rubber tyres not included in the kit
- Be sure to glue your rubber tyres to the wheels using Cyanoacrylate glue.

- 1) Apply the masking sheet provided and paint the body on the inside.
- 2) Cut the body along the provided cutting lines on the body for a perfect fit. Same for the body mounting holes.
- 3) Remove the body protection film on the outside of the body.
- 4) Apply the provided Serpent and Spyder decals, and mount the body on the bodyposts, with the provided bodyclips.

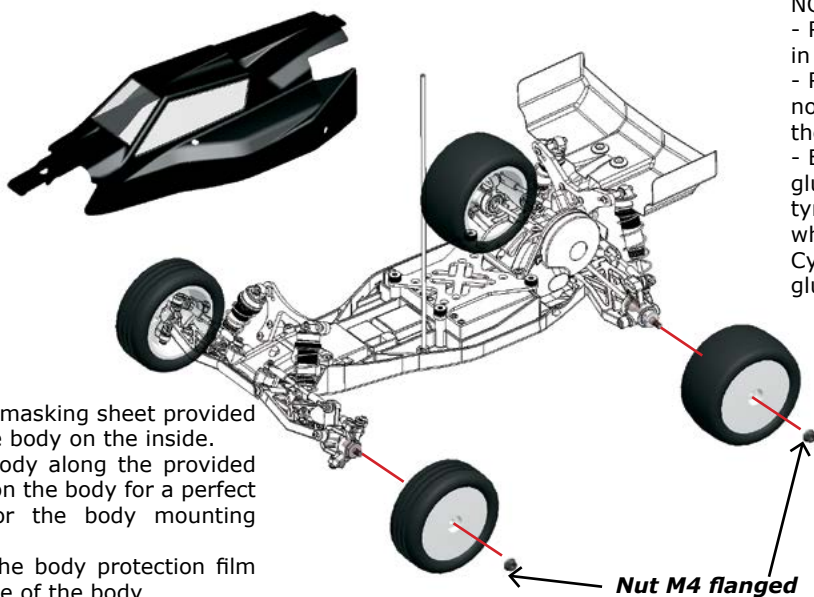

REF GUIDE:

EXPLODED VIEWS and PARTS-LIST

Contents

| | |
|------------------------------|-----------|
| FRONT ASSEMBLY I | 19 |
| FRONT ASSEMBLY II | 20 |
| BALL DIFF ASSEMBLY | 21 |
| TRANSMISSION ASSEMBLY | 22 |
| REAR ASSEMBLY | 23 |
| SHOCKS ASSEMBLY | 24 |
| FINAL ASSEMBLY | 25 |
| PARTS-LIST | 26 |



FRONT ASSEMBLY I

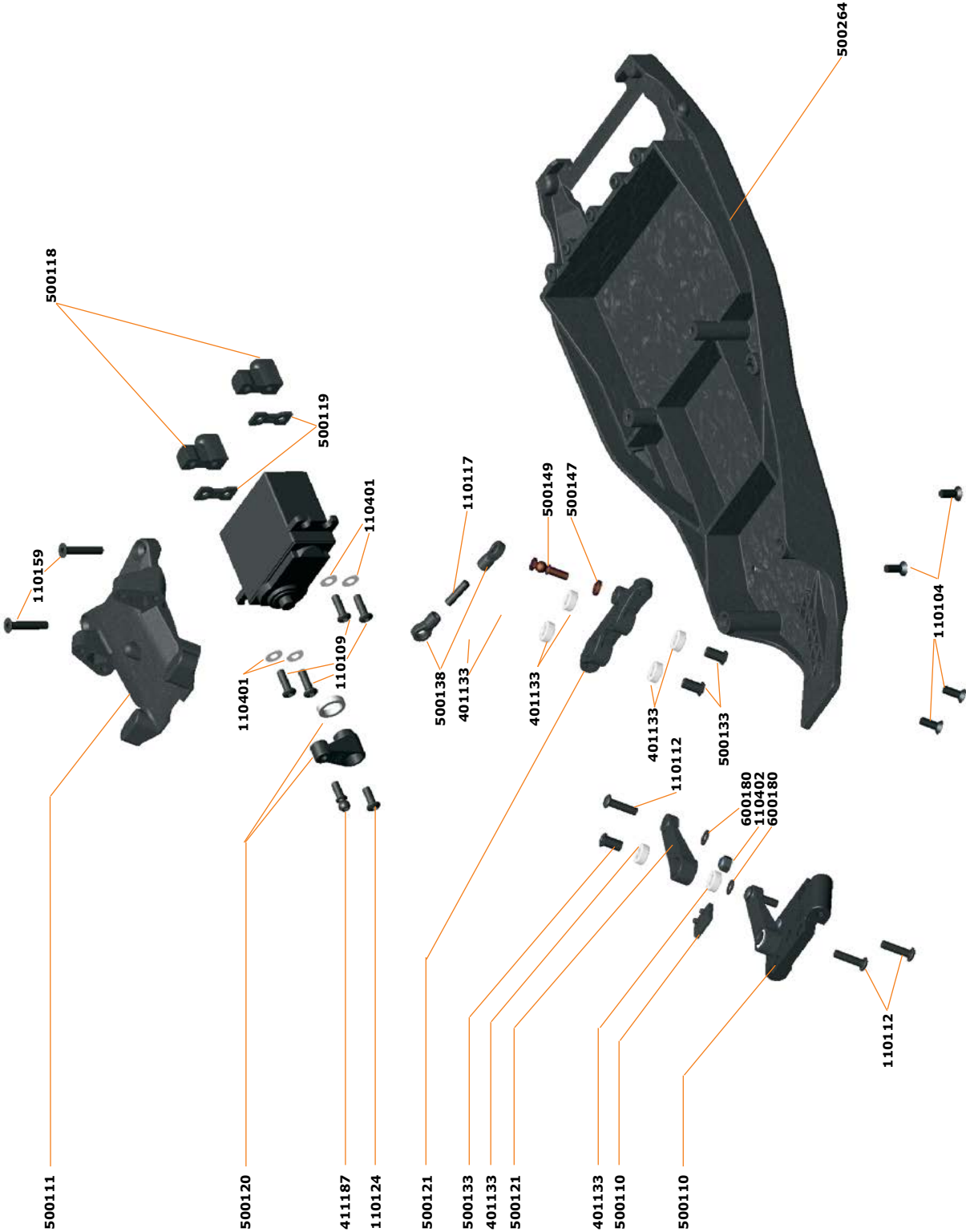

FRONT ASSEMBLY II

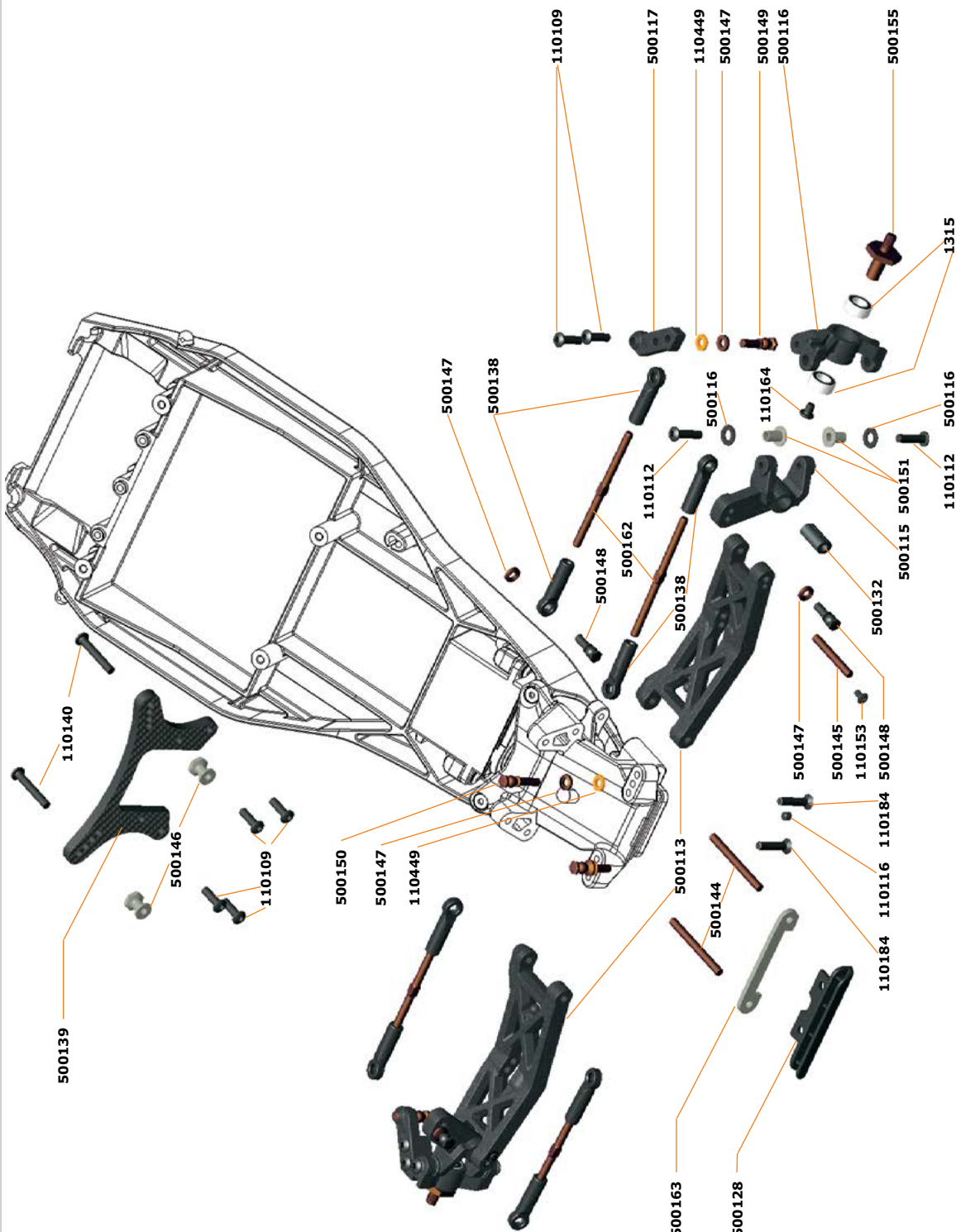

BALL DIFF ASSEMBLY

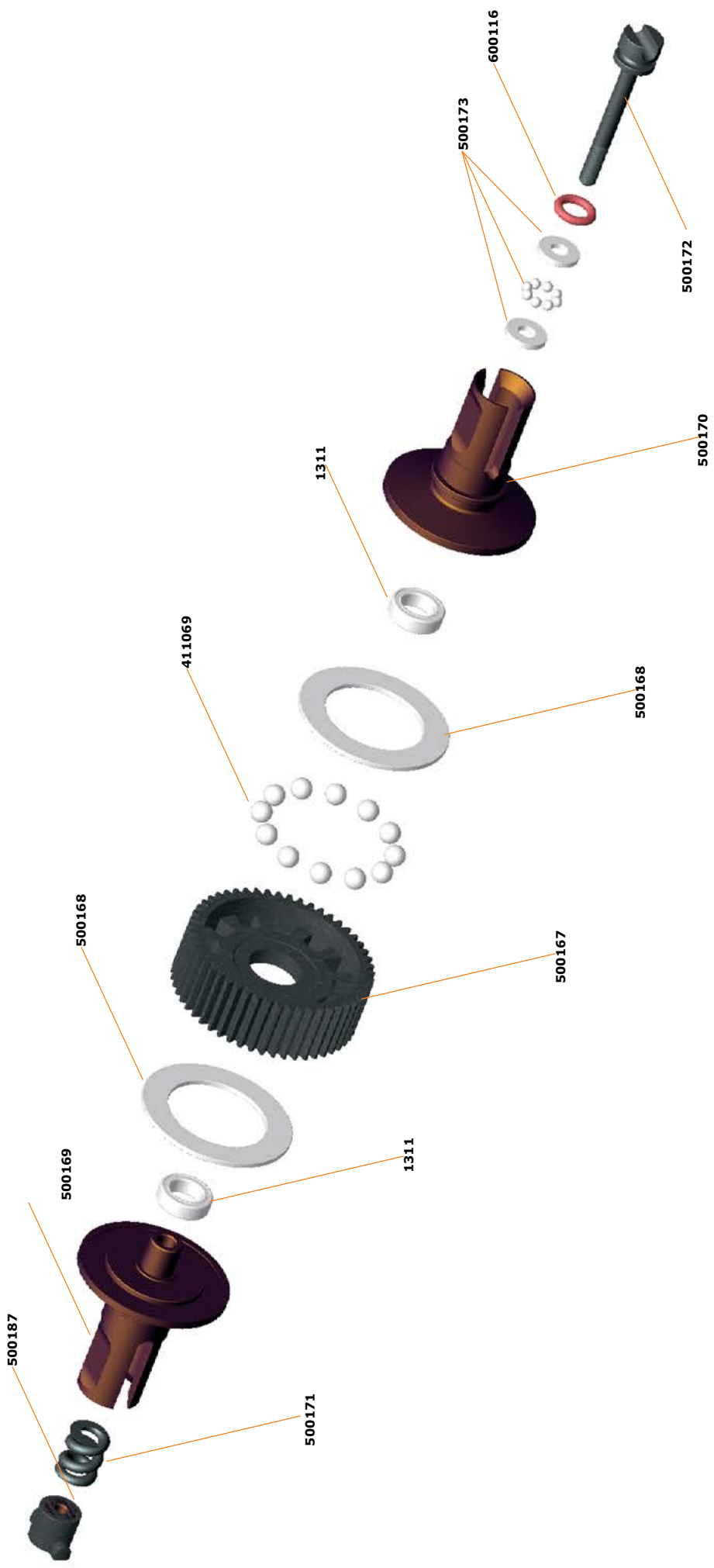

TRANSMISSION ASSEMBLY

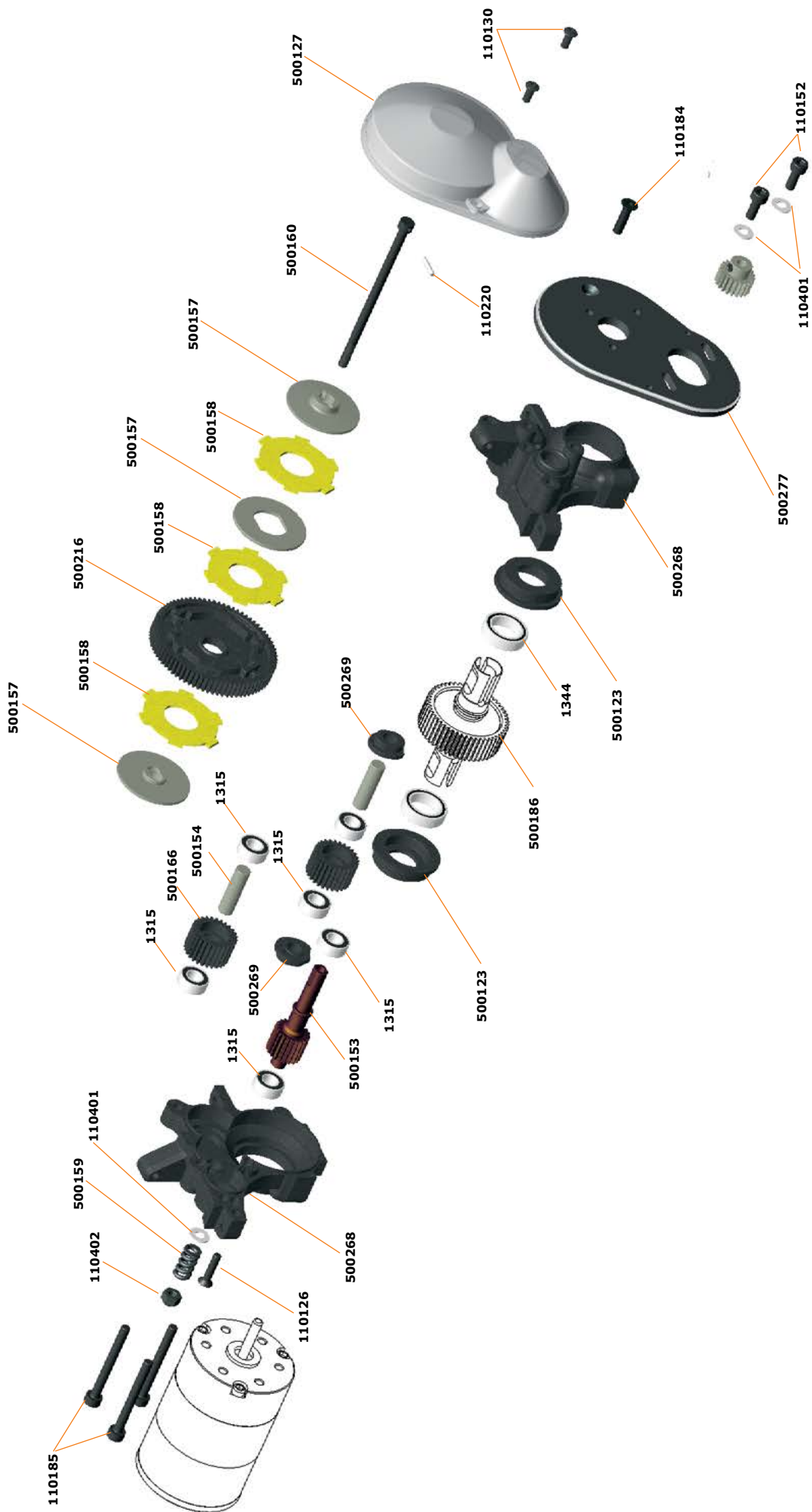

REAR ASSEMBLY

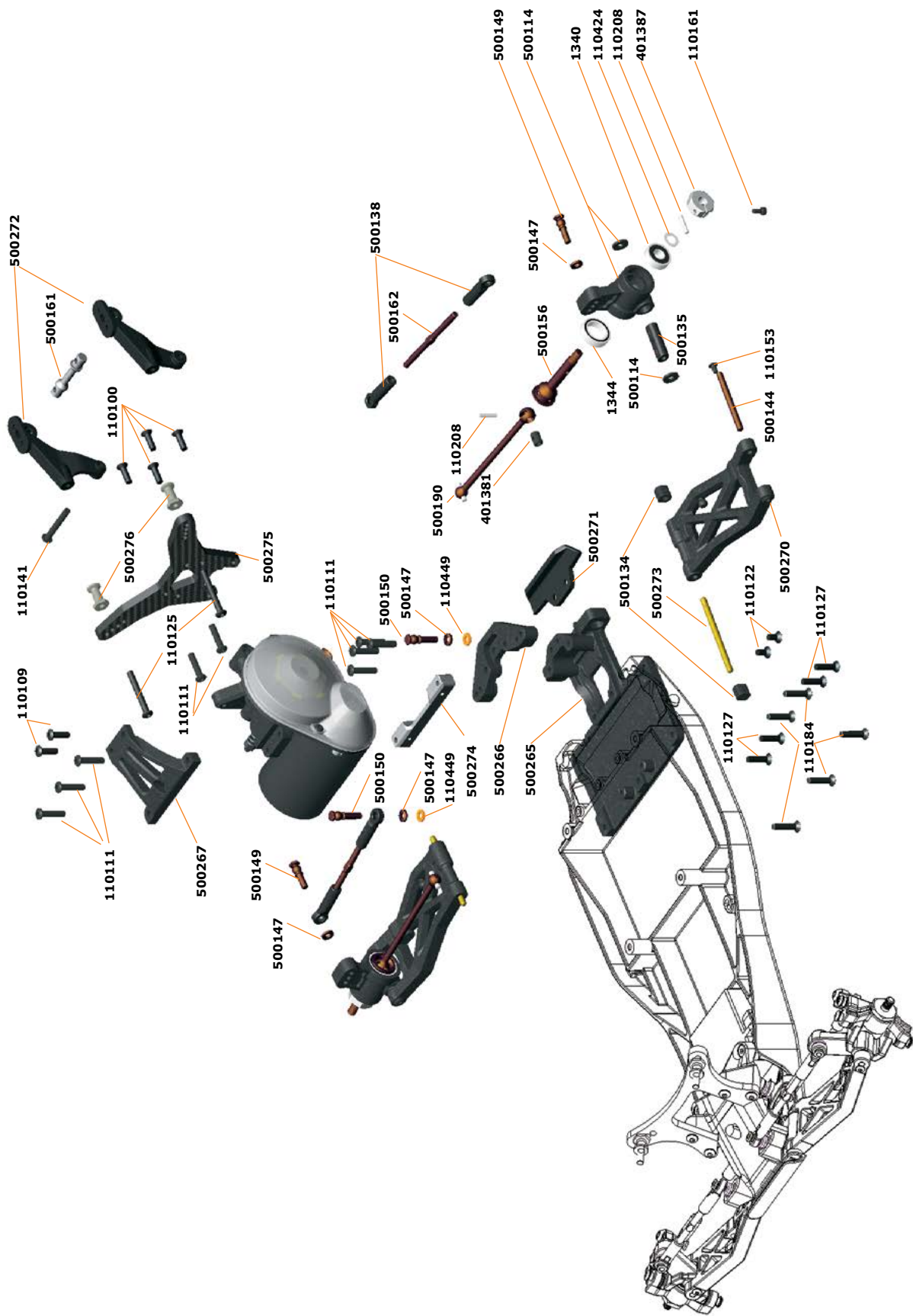

SHOCKS ASSEMBLY

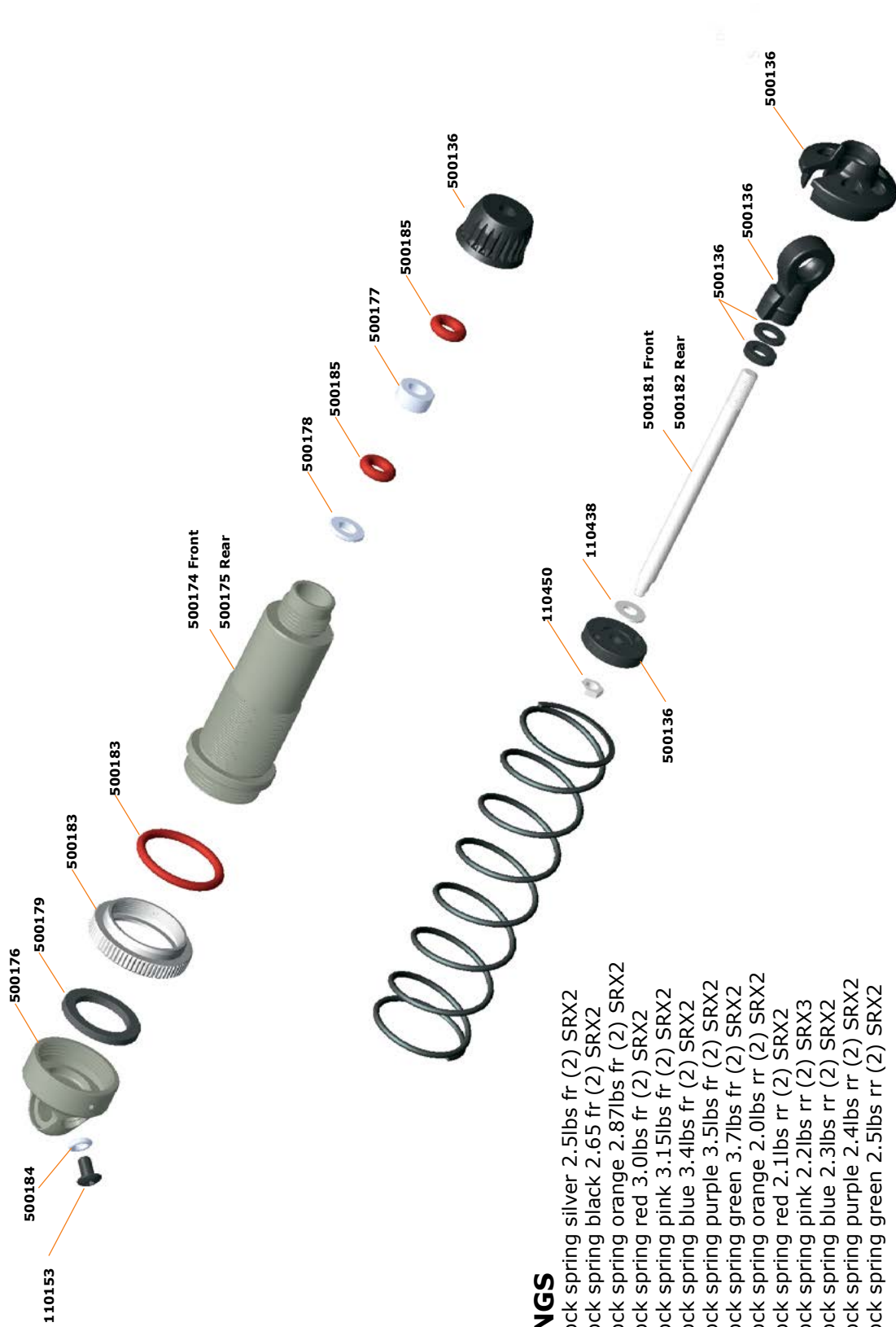

SHOCK SPRINGS

- 500222 Shock spring silver 2.5lbs fr (2) SRX2
- 500223 Shock spring black 2.65 fr (2) SRX2
- 500224 Shock spring orange 2.87lbs fr (2) SRX2
- 500225 Shock spring red 3.0lbs fr (2) SRX2
- 500226 Shock spring pink 3.15lbs fr (2) SRX2
- 500227 Shock spring blue 3.4lbs fr (2) SRX2
- 500228 Shock spring purple 3.5lbs fr (2) SRX2
- 500229 Shock spring green 3.7lbs fr (2) SRX2
- 500230 Shock spring orange 2.0lbs rr (2) SRX2
- 500231 Shock spring red 2.1lbs rr (2) SRX2
- 500232 Shock spring pink 2.2lbs rr (2) SRX3
- 500233 Shock spring blue 2.3lbs rr (2) SRX2
- 500234 Shock spring purple 2.4lbs rr (2) SRX2
- 500235 Shock spring green 2.5lbs rr (2) SRX2

FINAL ASSEMBLY

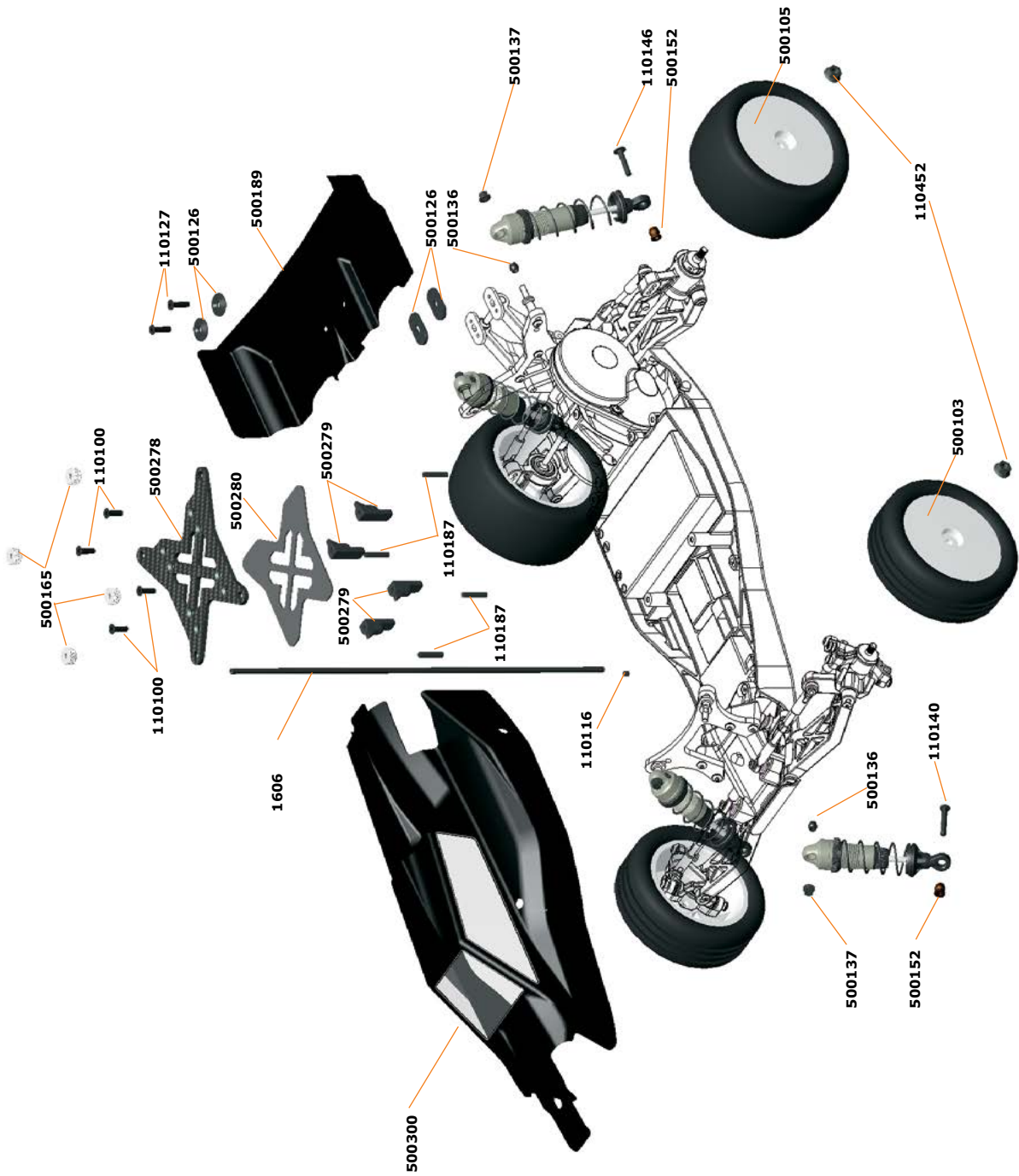

PARTS-LIST

| Part no | Description | | |
|---------|--|--------|--|
| 500003 | Serpent Spyder Buggy SXR-2 MM 2wd 1/10 | 500229 | Shock spring green 3.7lbs fr (2) SRX2 |
| | | 500230 | Shock spring orange 2.0lbs rr (2) SRX2 |
| | | 500231 | Shock spring red 2.1lbs rr (2) SRX2 |
| | | 500232 | Shock spring pink 2.2lbs rr (2) SRX3 |
| | | 500233 | Shock spring blue 2.3lbs rr (2) SRX2 |
| | | 500234 | Shock spring purple 2.4lbs rr (2) SRX2 |
| | | 500235 | Shock spring green 2.5lbs rr (2) SRX2 |

DECALS

| | |
|--------|------------------------------------|
| 1886 | Decal Serpent black/white 1/10 (2) |
| 1888 | Decal Serpent chrome 1/10 (2) |
| 500102 | Decal sheet Spyder black/white (2) |

RADIO INSTALLATION / BATTERY

| | |
|--------|-----------------------------|
| 1606 | Antenna rod black (2) |
| 500165 | Battery plate nut (4) SRX2 |
| 500278 | Batteryplate carbon SRX2 MM |
| 500279 | Battery holders (4) SRX2 MM |
| 500280 | Battery plate foam SRX2 MM |

Optionals

| | |
|--------|---------------------------------------|
| 500284 | Battery case inserts foam (3) SRX2 MM |
|--------|---------------------------------------|

SERVO SAVER AND STEERING

| | |
|--------|-----------------------------------|
| 411187 | Pivotball with shaft (2) |
| 500117 | Steeringarms L+R (3) SRX2 |
| 500118 | Servomount (2) SRX2 |
| 500119 | Servomount spacers (8) SRX2 |
| 500120 | Steeringlever (3) SRX2 |
| 500121 | Steeringrack (3) SRX2 |
| 500133 | Steeringrack bold (4) SRX2 |
| 500147 | Pivotball shim conical (10) SRX2 |
| 500149 | Pivotball with shaft med (5) SRX2 |
| 600180 | Washer shock shaft (4) |

Optionals

| | |
|--------|-----------------------------|
| 500197 | Servomount alu (2) SRX2 |
| 500236 | Steeringrack alu (3) SRX2 |
| 500287 | Steering arm nr 1 brass L+R |
| 500288 | Steering arm nr 2 brass L+R |
| 500289 | Steering arm nr 3 brass L+R |

SHOCK ABSORBERS

| | |
|--------|---|
| 500136 | Shock parts frame (44) SRX2 |
| 500137 | Nut nylon M3 flanged (8) |
| 500152 | Pivotball shock (4) SRX2 |
| 500174 | Shock body fr (2) SRX2 |
| 500175 | Shock body rr (2) SRX2 |
| 500176 | Shock top (2) SRX2 |
| 500177 | Shock cartridge spacer (4) SRX2 |
| 500178 | Shock cartridge spacer stepped (4) SRX2 |
| 500179 | Shock top gasket (4) SRX2 |
| 500181 | Shock shaft fr (2) SRX2 |
| 500182 | Shock shaft rr (2) SRX2 |
| 500183 | Shock adjust nut / oring (2) SRX2 |
| 500184 | Shock bleeding oring (4) SRX2 |
| 500185 | Shock oring bottom (4) SRX2 |

OPTIONALS

| | |
|--------|---------------------------------------|
| 500180 | Shock membrane (4) SRX2 |
| 500199 | Shock top bushing delrin (4) SRX2 |
| 500201 | Shock shaft fr TiN coated (2) SRX2 |
| 500202 | Shock shaft rr TiN coated (2) SRX2 |
| 500238 | Shock piston conical 2 holes (4) SRX2 |
| 500239 | Shock piston conical 3 holes (4) SRX3 |
| 500240 | Shock piston conical 4 holes (4) SRX4 |

SPRINGS

| | |
|--------|---|
| 500222 | Shock spring silver 2.5lbs fr (2) SRX2 |
| 500223 | Shock spring black 2.65 fr (2) SRX2 |
| 500224 | Shock spring orange 2.87lbs fr (2) SRX2 |
| 500225 | Shock spring red 3.0lbs fr (2) SRX2 |
| 500226 | Shock spring pink 3.15lbs fr (2) SRX2 |
| 500227 | Shock spring blue 3.4lbs fr (2) SRX2 |
| 500228 | Shock spring purple 3.5lbs fr (2) SRX2 |

FRONT SECTION

| | |
|--------|--|
| 411187 | Pivotball with shaft (2) |
| 500103 | 1/10 buggy rim fr 2wd white (2) |
| 500110 | Front bulkhead-insert SRX2 |
| 500111 | Front bulkhead top SRX2 |
| 500113 | Wishbone fr L+R SRX2 |
| 500115 | C-hub L+R SRX2 |
| 500116 | Steeringblock L+R SRX2 |
| 500117 | Steeringarms L+R (3) SRX2 |
| 500118 | Servomount (2) SRX2 |
| 500119 | Servomount spacers (8) SRX2 |
| 500120 | Steeringlever (3) SRX2 |
| 500121 | Steeringrack (3) SRX2 |
| 500128 | Front bumper SRX2 |
| 500132 | C-hub insert (6) SRX2 |
| 500133 | Steeringrack bold (4) SRX2 |
| 500138 | Balljoint set (14) SRX2 |
| 500139 | Shocktower fr SRX2 |
| 500144 | Hinge pin fr inner / rr outer (2) SRX2 |
| 500145 | Hinge pin fr outer (2) SRX2 |
| 500146 | Shock mount (4) SRX2 |
| 500147 | Pivotball shim conical (10) SRX2 |
| 500148 | Pivotball with shaft low (4) SRX2 |
| 500149 | Pivotball with shaft med (5) SRX2 |
| 500150 | Pivotball with shaft high (4) SRX2 |
| 500151 | Casterblock bushing (4) SRX2 |
| 500155 | Wheel axle fr (2) SRX2 |
| 500162 | Track rod M3x50 (2) SRX2 |
| 500163 | Hinge pin brace 25 deg fr SRX2 |

Optionals

| | |
|--------|---|
| 500104 | 1/10 buggy rim fr 2wd yellow (2) |
| 500193 | Front wing set SRX2 |
| 500194 | Antiroll bar set fr SRX2 |
| 500198 | Pivotball with shaft short (4) SRX2 |
| 500200 | Front bulkhead inserts alu (6) SRX2 |
| 500203 | Pivot pin brace 20 deg fr SRX2 |
| 500204 | Pivot pin brace 30 deg fr SRX2 |
| 500208 | Antiroll bar fr 0.9 SRX2 |
| 500209 | Antiroll bar fr 1.0 SRX2 |
| 500210 | Antiroll bar fr 1.1 SRX2 |
| 500237 | C-hub L+R alu SRX2 |
| 500241 | Front wing SRX2 |
| 500243 | Front bulkhead alu SRX2 |
| 500250 | Front bulkhead brass SRX2 |
| 500258 | Antirollbar balljoints (2+2) SRX2 |
| 500262 | Pivot pin fr inner / rr outer TiN coated (2) SRX2 |
| 500263 | Pivot pin fr outer TiN coated (2) SRX2 |

MIDDLE SECTION

| | |
|--------|-----------------------------|
| 500165 | Battery plate nut (4) SRX2 |
| 500264 | Chassis SRX2 MM |
| 500267 | Transmission brace SRX2 MM |
| 500278 | Batteryplate carbon SRX2 MM |
| 500279 | Battery holders (4) SRX2 MM |
| 500280 | Battery plate foam SRX2 MM |

Optionals

| | |
|--------|---------------------------------------|
| 500284 | Battery case inserts foam (3) SRX2 MM |
| 500285 | Ballast weight SRX2 MM |

REAR SECTION

| | |
|--------|--|
| 401381 | CVD insert (2) |
| 401387 | Wheelhexagon (2) |
| 500105 | 1/10 buggy rim rr white (2) |
| 500114 | Upright L+R SRX2 |
| 500134 | Rear suspension insert (24) SRX2 |
| 500135 | Upright inserts (10) SRX2 |
| 500138 | Balljoint set (14) SRX2 |
| 500144 | Hinge pin fr inner / rr outer (2) SRX2 |
| 500147 | Pivotball shim conical (10) SRX2 |
| 500149 | Pivotball with shaft med (5) SRX2 |
| 500150 | Pivotball with shaft high (4) SRX2 |
| 500156 | Wheel axle rr (2) SRX2 |
| 500161 | Wing brace alu SRX2 |
| 500162 | Track rod M3x50 (2) SRX2 |
| 500189 | Rear wing 6.5" SRX2 |
| 500190 | Driveshaft rr (2) SRX2 |
| 500191 | Driveshaft rr set (2) SRX2 |
| 500265 | Skidplate SRX2 MM |
| 500266 | Bulkhead rear SRX2 MM |
| 500270 | Wishbone rr L+R SRX2 MM |
| 500271 | Bumper rear SRX2 MM |
| 500272 | Wingmount-set SRX2 MM |
| 500273 | Pivot pin rr inner (2) SRX2 MM |
| 500274 | Suspension bracket rr fr SRX2 MM |
| 500275 | Shocktower carbon rr SRX2 MM |
| 500276 | Shock mount rr (2) SRX2 MM |

Optionals

| | |
|--------|---|
| 500106 | 1/10 buggy rim rr yellow (2) |
| 500196 | Upright L+R alu SRX2 |
| 500198 | Pivotball with shaft short (4) SRX2 |
| 500205 | Antiroll bar rr 1.1 SRX2 |
| 500206 | Antiroll bar rr 1.3 SRX2 |
| 500207 | Antiroll bar rr 1.5 SRX2 |
| 500211 | Wheelhexagon +0.75mm offset (2) |
| 500212 | Wheelhexagon -0.75mm offset (2) |
| 500244 | Rear bulkhead weight SRX2 |
| 500251 | Rear wing 6.0" SRX2 |
| 500252 | Rear wing 7.0" SRX2 |
| 500255 | Suspension insert rr 3deg alu (2) SRX2 |
| 500258 | Antirollbar balljoints (2+2) SRX2 |
| 500262 | Pivot pin fr inner / rr outer TiN coated (2) SRX2 |
| 500281 | Antiroll bar set rr SRX2 MM |
| 500282 | Wingmount low SRX2 MM |
| 500283 | Suspension bracket rr fr brass SRX2 MM |
| 500286 | Bumper rear brass SRX2 MM |

TRANSMISSION

| | |
|--------|-------------------------------------|
| 411069 | Differential balls steel 1/8" (12) |
| 500123 | Diffheight insert (4) SRX2 |
| 500127 | Gear cover SRX2 |
| 500153 | Top shaft 21T SRX2 |
| 500154 | Idler gear shaft SRX2 |
| 500157 | Slipper plate alu (3) SRX2 |
| 500158 | Slipper pad yellow (3) SRX2 |
| 500159 | Slipper spring (2) SRX2 |
| 500160 | Slipper bolt topshaft (2) SRX2 |
| 500166 | Idler gear 27T SRX2 |
| 500167 | Diff pully balldiff 51T (1) SRX2 |
| 500168 | Diff ring balldiff (2) SRX2 |
| 500169 | Balldiff outdrive male SRX2 |
| 500170 | Balldiff outdrive female SRX2 |
| 500171 | Balldiff spring (2) SRX2 |
| 500172 | Balldiff bolt (2) SRX2 |
| 500173 | Balldiff thrustbearing SRX2 |
| 500186 | Balldiff set SRX2 |
| 500187 | Balldiff T-nut (2) SRX2 |
| 500268 | Transmissioncase SRX2 MM |
| 500269 | Transmissioncase insert (6) SRX2 MM |

| | |
|--------|---------------------|
| 500277 | Motor plate SRX2 MM |
| 600116 | O-ring tank (4) |

OPTIONALS

| | |
|--------|--------------------------------------|
| 411107 | Diff balls. 1/8 ceramic (12) |
| 500192 | Geardiff set SRX2 |
| 500242 | Slipper plates vented alu (3) SRX2 |
| 500246 | Geardiff gears 14T(4)+28T(2) SRX2 |
| 500247 | Diff pin 14T (2) SRX2 |
| 500248 | Geardiff o-ring (4) SRX2 |
| 500249 | Geardiff outdrive (2) SRX2 |
| 500253 | Geardiff cap L+R SRX2 |
| 500254 | Geardiff housing 51T SRX2 |
| 500256 | Thrustbearing carbide balldiff SRX2 |
| 500257 | Geardiff nut (4) SRX2 |
| 500259 | Differential balls carbide 1/8" (12) |
| 500260 | Idler gear 27T alu SRX2 |

BODY AND WING

| | |
|--------|-------------------------|
| 500189 | Rear wing 6.5" SRX2 |
| 500300 | Body Spyder 2wd MM 1/10 |

Optionals

| | |
|--------|---------------------|
| 500241 | Front wing SRX2 |
| 500251 | Rear wing 6.0" SRX2 |
| 500252 | Rear wing 7.0" SRX2 |

SPURGEAR

| | |
|--------|--------------------|
| 500213 | Spur gear 70T SRX2 |
| 500214 | Spur gear 72T SRX2 |
| 500215 | Spur gear 76T SRX2 |
| 500216 | Spur gear 78T SRX2 |
| 500217 | Spur gear 80T SRX2 |
| 500218 | Spur gear 82T SRX2 |
| 500219 | Spur gear 84T SRX2 |
| 500220 | Spur gear 86T SRX2 |
| 500221 | Spur gear 88T SRX2 |

PINIONS

| | |
|--------|---------------------------------|
| 120156 | Motor-pinion alu hard 48P / 18T |
| 120157 | Motor-pinion alu hard 48P / 19T |
| 120158 | Motor-pinion alu hard 48P / 20T |
| 120159 | Motor-pinion alu hard 48P / 21T |
| 120160 | Motor-pinion alu hard 48P / 22T |
| 120161 | Motor-pinion alu hard 48P / 23T |
| 120162 | Motor-pinion alu hard 48P / 24T |
| 120163 | Motor-pinion alu hard 48P / 25T |
| 120164 | Motor-pinion alu hard 48P / 26T |
| 120165 | Motor-pinion alu hard 48P / 27T |
| 120166 | Motor-pinion alu hard 48P / 28T |
| 120167 | Motor-pinion alu hard 48P / 29T |
| 120168 | Motor-pinion alu hard 48P / 30T |

BALL-BEARINGS

| | |
|--------|-----------------------------|
| 1340 | Ball-bearing 5x13 hs (2) |
| 1311 | Ballbearing 5x8x2.5 (2) |
| 1315 | Ballbearing 5x10x4 (2) |
| 1344 | Ball-bearing 10x15x4 hs (2) |
| 401133 | Ballbearing 4x8 (2) |
| 500173 | Balldiff thrustbearing SRX2 |

TOOLS

| | |
|--------|--|
| 190506 | Toolset for onroad (17pcs) with tools bag |
| 190507 | Toolset for ep (16pcs) with tools bag |
| 190508 | Toolset for offroad (20pcs) with tools bag |
| 190509 | Allen wrench 1.5 x 120mm |
| 190510 | Allen wrench 2.0 x 120mm |
| 190511 | Allen wrench 2.5 x 120mm |
| 190512 | Allen wrench 3.0 x 120mm |
| 190513 | Ball driver hex wrench 2.0 x120mm |
| 190514 | Ball driver hex wrench 2.5 x 120mm |

| | | | |
|--------|---|--------|--|
| 190515 | Ball driver hex wrench 3.0 x 120mm | 110145 | Screw allen roundhead flanged M3x12 (10) |
| 190516 | Tool tip allen wrench 1.5 x 120mm | 110146 | Screw allen roundhead flanged M3x16 (10) |
| 190517 | Tool tip allen wrench 2.0 x 120mm | 110147 | Screw ph roundhead M2.5x5 (10) |
| 190518 | Tool tip allen wrench 2.5 x 120mm | 110148 | Setscrew allen M5x4 (10) |
| 190519 | Tool tip allen wrench 3.0 x 120mm | 110149 | Screw allen countersunk M2x10 (10) |
| 190520 | Tool tip ball driver hex wrench 2.0 x 120mm | 110150 | Screw M6x12 nylon black (2) |
| 190521 | Tool tip ball driver hex wrench 2.5 x 120mm | 110151 | Screw allen cilinderhead M4x10 (10) |
| 190522 | Tool tip ball driver hex wrench 3.0 x 120mm | 110152 | Screw allen cilinderhead M3x8 (10) |
| 190523 | Turnbuckle wrench 3mm | 110153 | Screw allen roundhead M2.3x4(10) |
| 190524 | Turnbuckle wrench 4mm | 110154 | Setscrew allen M3x10 (10) |
| 190525 | Turnbuckle wrench 5mm | 110155 | Setscrew allen M3x5 (10) |
| 190526 | Flat head screwdriver 3.0 x 150mm | 110156 | Screw allen countersunk M2.2x6 (10) |
| 190527 | Flat head screwdriver 4.0 x 150mm | 110157 | Screw allen countersunk M3x5 (10) |
| 190528 | Phillips screwdriver 2.0 x 45mm | 110158 | Screw allen countersunk M3x15 (10) |
| 190529 | Phillips screwdriver 3.5 x 120mm | 110159 | Screw allen countersunk M3x18 (10) |
| 190530 | Phillips screwdriver 5.8 x 120mm | 110160 | Screw allen cilinderhead M2.2x12 (10) |
| 190539 | Nut driver 4.5 x 100mm | 110161 | Screw allen cilinderhead M2x6 (10) |
| 190531 | Nut driver 5.0 x 100mm | 110162 | Setscrew allen M3x2.5 (10) |
| 190532 | Nut driver 5.5 x 100mm | 110163 | Setscrew allen M3x2 (10) |
| 190533 | Nut driver 7.0 x 100mm | 110164 | Screw allen roundhead M3x4 (10) |
| 190534 | Reamer with end cap for lexan body | 110165 | Screw allen cilinderhead M2x5 (10) |
| | | 110166 | Screw allen countersunk M2.5x5 (10) |
| | | 110167 | Screw allen roundhead flanged M3x18 (10) |

FASTNERS

| | | | |
|--------|--|--------|---|
| 110101 | Screw allen countersunk m4x8 (10) | 110168 | Screw allen roundhead flanged M3.5x10 (10) |
| 110102 | Screw allen countersunk m4x10 (10) | 110169 | Screw allen roundhead flanged M4x10 (10) |
| 110103 | Screw allen countersunk m4x16 (10) | 110170 | Screw allen roundhead flanged M3x28 (10) |
| 110104 | Screw allen countersunk m3x8 (10) | 110171 | Screw ph roundhead widethread 2.5x6 (10) |
| 110105 | Screw allen countersunk m4x12 (10) | 110172 | Screw allen roundhead flanged M3X6 (10) |
| 110106 | Screw allen flanged roundhead m5x12 (10) | 110173 | Screw ph countersunk widethread 2.5x12 (10) |
| 110107 | Screw allen cilinderhead m3x16 (10) | 110174 | Screw allen countersunk M4x6 (10) |
| 110108 | Screw allen roundhead m3x6 (10) | 110175 | Screw allen cilinderhead M3x40 (10) |
| 110109 | Screw allen roundhead m3x10 (10) | 110176 | Screw allen cilinderhead M3x18 (10) |
| 110110 | Screw allen roundhead m3x16 (10) | 110177 | Screw allen roundhead M4x12 (10) |
| 110111 | Screw allen roundhead m3x14 (10) | 110178 | Screw allen cilinderhead M3x14 (10) |
| 110112 | Screw allen roundhead m3x12 (10) | 110179 | Screw allen roundhead M2.5x8 (10) |
| 110113 | Screw allen roundhead m4x8 (10) | 110180 | Setscrew allen M5x10 (10) |
| 110114 | Setscrew allen m3x8 (10) | 110181 | Screw M5x10 + Nut nylon black (4+4) |
| 110115 | Setscrew allen m3x4 (10) | 110182 | Screw allen roundhead M2x4 (10) |
| 110116 | Setscrew allen m3x3 (10) | 110183 | Screw allen countersunk M3x10 (10) |
| 110117 | Setscrew allen m3x12 (10) | 110184 | Screw allen countersunk M3x14 (10) |
| 110118 | Setscrew allen m4x4 (10) | 110185 | Screw allen cilinderhead M3x30 (10) |
| 110119 | Setscrew allen m4x6 (10) | 110186 | Screw allen cilinderhead M3x35 (10) |
| 110120 | Setscrew allen m4x10 (10) | 110187 | Setscrew allen M3x16 (10) |
| 110121 | Setscrew allen m5x6 (10) | 110200 | Pin 2.5x8 (10) |
| 110122 | Screw allen countersunk m3x6 (10) | 110201 | Pin 3x12 (10) |
| 110123 | Screw philips roundhead 3.5x13 (10) | 110202 | Pin 5x5 (10) |
| 110124 | Screw allen roundhead m3x8 (10) | 110203 | Pin 3x14 (10) |
| 110125 | Screw allen countersunk m3x20 (10) | 110204 | Pin 3x20 (10) |
| 110126 | Screw allen countersunk m2.5x12 (10) | 110205 | Pin 3x22 (10) |
| 110127 | Screw allen countersunk m3x12 (10) | 110206 | Pin 2.5x22 (10) |
| 110128 | Screw allen roundhead m3x5 (10) | 110207 | Pin 2.5x12 (10) |
| 110129 | Screw allen cilinderhead m3x10 (10) | 110208 | Pin nra 2x9.8 (4) |
| 110130 | Screw allen roundhead m2.5x6 (10) | 110209 | Pin nra 2x18 (4) |
| 110131 | Screw allen roundhead m2.5x10 (10) | 110210 | Pin 3x13 (10) |
| 110132 | Screw allen countersunk m3x16 (10) | 110211 | Pin 2.5x13 (10) |
| 110133 | Screw philipshead countersunk 2.5x8 wide (10) | 110212 | Pin 2.5x17 (10) |
| 110134 | Screw philipshead countersunk 2.5x10 wide (10) | 110213 | Pin 2.5x10 (10) |
| 110135 | Screw allen countersunk M2.5x10 (10) | 110214 | Pin 3x15 (10) |
| 110136 | Screw allen countersunk M2.5x8 (10) | 110215 | Pin 2x12 (10) |
| 110137 | Setscrew allen M3x6 (10) | 110216 | Pin 2.5x15 (10) |
| 110138 | Screw allen countersunk M4x14 (10) | 110217 | Pin 2x9 (10) |
| 110139 | Screw allen countersunk M3x40 (10) | 110218 | Pin 3x10 (10) |
| 110140 | Screw allen roundhead M3x20 (10) | | |
| 110141 | Screw allen roundhead M3x22 (10) | | |
| 110142 | Screw allen roundhead M3x25 (10) | | |
| 110143 | Screw allen roundhead M4x18 (10) | | |
| 110144 | Screw allen roundhead M3x18 (10) | | |

| | | | |
|--------|--------------------------------|--------|---|
| 110219 | Pin 2x14 (10) | 190175 | Winter jacket Serpent black-orange hooded (2XL) |
| 110220 | Pin 1.5x8 (10) | 190176 | Winter jacket Serpent black-orange hooded (3XL) |
| 110300 | E-clip 2.3 (10) | 190208 | Winter jacket Serpent black-orange hooded (4XL) |
| 110301 | E-clip 3.2 (10) | 190156 | Polo shirt Serpent black (S) |
| 110302 | E-clip 4.0 (10) | 190157 | Polo shirt Serpent black (M) |
| 110303 | E-clip 5.0 (10) | 190158 | Polo shirt Serpent black (L) |
| 110304 | E-clip 7.0 (10) | 190159 | Polo shirt Serpent black (XL) |
| 110305 | Seeger clip 12x1.0 (10) | 190160 | Polo shirt Serpent black (XXL) |
| 110306 | E-clip 6.0 (10) | 190161 | Polo shirt Serpent black (XXXL) |
| 110307 | E-clip 9.0 (10) | 190182 | T-shirt Serpent Splash white (S) |
| 110400 | Shim 6.0x10x0.2(10) | 190183 | T-shirt Serpent Splash white (M) |
| 110401 | Shim 3.2x7x0.5 (10) | 190184 | T-shirt Serpent Splash white (L) |
| 110402 | Nut nylock M3 (10) | 190185 | T-shirt Serpent Splash white (XL) |
| 110403 | Nut nylock M4 (10) | 190186 | T-shirt Serpent Splash white (XXL) |
| 110404 | Shim 6x8x0.3 (10) | 190187 | T-shirt Serpent Splash white (XXXL) |
| 110405 | Nut nylock M4 flanged (10) | 190188 | T-shirt Serpent Splash orange (S) |
| 110406 | Nut nylock M2.2 (10) | 190189 | T-shirt Serpent Splash orange (M) |
| 110407 | Nut M3 (10) | 190190 | T-shirt Serpent Splash orange (L) |
| 110408 | Shim 3X5X0.3 (10) | 190191 | T-shirt Serpent Splash orange (XL) |
| 110409 | Shim 3X5X1 (10) | 190192 | T-shirt Serpent Splash orange (XXL) |
| 110410 | Shim 3X5X2 (10) | 190193 | T-shirt Serpent Splash orange (XXXL) |
| 110411 | Shim 3X5X4 (10) | 190194 | T-shirt Serpent Splash black (S) |
| 110412 | Shim 3.5X8X1 (10) | 190195 | T-shirt Serpent Splash black (M) |
| 110413 | Shim 3.5X12X0.2 (10) | 190196 | T-shirt Serpent Splash black (L) |
| 110414 | Shim 3X6X0.1 (10) | 190197 | T-shirt Serpent Splash black (XL) |
| 110415 | Shim 3X6X0.5 (10) | 190198 | T-shirt Serpent Splash black (XXL) |
| 110416 | Shim 3X6X0.8 (10) | 190199 | T-shirt Serpent Splash black (XXXL) |
| 110417 | Shim 3X6X3 (10) | 190201 | Hoody sweater Serpent black-zip (S) |
| 110418 | Shim 4X8X0.1 (10) | 190202 | Hoody sweater Serpent black-zip (M) |
| 110419 | Shim 4X9.5X1 (10) | 190203 | Hoody sweater Serpent black-zip (L) |
| 110420 | Shim 4X9.5X2(10) | 190204 | Hoody sweater Serpent black-zip (XL) |
| 110421 | Shim 4X9.5X4(10) | 190205 | Hoody sweater Serpent black-zip (2XL) |
| 110422 | Shim 4X10X0.3 (10) | 190206 | Hoody sweater Serpent black-zip (3XL) |
| 110423 | Shim 5X8X0.1 (10) | 190207 | Hoody sweater Serpent black-zip (4XL) |
| 110424 | Shim 5X8X0.3 (10) | 190502 | Pit-bag medium. 3 drawers |
| 110425 | Shim 5X10X0.3 (10) | | |
| 110426 | Shim 5X10X0.5 (10) | | |
| 110427 | Shim 5X15X0.3 (10) | | |
| 110428 | Shim 6.5X8X0.25 (10) | | |
| 110429 | Shim 6X11.75X0.2 (10) | | |
| 110431 | Shim 8X11X0.1 (10) | | |
| 110432 | Shim 8X11X0.2 (10) | | |
| 110433 | Shim 12X15X0.25 (10) | | |
| 110434 | Shim 12X18X0.3 (10) | | |
| 110435 | Shim 13X16X0.2 (10) | | |
| 110436 | Shim 3x5x3 (10) | | |
| 110437 | Nut M2.5 (10) | | |
| 110438 | Shim 2.5x6x0.5 (10) | | |
| 110439 | Shim 3x7.5x1 (10) | | |
| 110440 | Shim 2.5x5x0.4 (10) | | |
| 110441 | Nut nylock M3 flanged (10) | | |
| 110442 | Shim 4x8x0.6 (10) | | |
| 110443 | Shim 5x15x0.2 (10) | | |
| 110444 | Nut M4 nylon (10) | | |
| 110445 | Shim 4x10x0.2 (10) | | |
| 110446 | Shim 5x15x0.2 (10) | | |
| 110447 | Shim 3x7x7 (10) | | |
| 110448 | Shim 3x6x6 (10) | | |
| 110449 | Shim 3x6x1 (10) | | |
| 110450 | Nut M2 (10) | | |
| 110451 | Nylock nut M4 flanged alu (10) | | |
| 110452 | Nut M4 flanged knurled (10) | | |

MERCHANDISING

| | |
|--------|--|
| 1896 | Cap serpent black-orange |
| 190172 | Winter jacket Serpent black-orange hooded (M) |
| 190173 | Winter jacket Serpent black-orange hooded (L) |
| 190174 | Winter jacket Serpent black-orange hooded (XL) |



SPYDER SRX2MID



www.serpent.com - info@serpent.com



Manual / ref guide SRX2 RM version 1